

STATE OF CALIFORNIA
STATE WATER RESOURCES CONTROL BOARD

ORDER WQ 2013-0050-UST

In the Matter of Underground Storage Tank Case Closure

**Pursuant to Health and Safety Code Section 25299.39.2 and the Low Threat
Underground Storage Tank Case Closure Policy**

BY THE EXECUTIVE DIRECTOR¹:

Pursuant to Health and Safety Code section 25299.39.2, the Manager of the Underground Storage Tank Cleanup Fund (Fund) recommends closure of the underground storage tank (UST) case at the site listed below.² The name of the Fund claimant, the Fund claim number, the site name and the applicable site address are as follows:

Moller Investments Group, Inc.

Claim No. 6093

US Petroleum #141

14600 Edwards Street, Westminster

Orange County Health Care Agency

I. STATUTORY AND PROCEDURAL BACKGROUND

Section 25299.39.2 directs the Fund manager to review the case history of claims that have been active for five years or more (five-year review), unless there is an objection from the UST owner or operator. This section further authorizes the Fund Manager to make recommendations to the State Water Resources Control Board (State Water Board) for closure of a five-year-review case if the UST owner or operator approves. In response to a recommendation by the Fund Manager, the State Water Board, or in certain cases the State Water Board Executive Director, may close a case or require the closure of a UST case. Closure of a UST case is appropriate where the corrective action ensures the protection of

¹ State Water Board Resolution No. (2012-0061) delegates to the Executive Director the authority to close or require the closure of any UST case if the case meets the criteria found in the State Water Board's Low Threat Underground Storage Tank Case Closure Policy adopted by State Water Board Resolution No. 2012-0016.

² Unless otherwise noted, all references are to the Health and Safety Code.

human health, safety, and the environment and where the corrective action is consistent with:

- 1) Chapter 6.7 of Division 20 of the Health and Safety Code and implementing regulations;
- 2) Any applicable waste discharge requirements or other orders issued pursuant to Division 7 of the Water Code; 3) All applicable state policies for water quality control; and 4) All applicable water quality control plans.

The Fund Manager has completed a five-year review of the UST case identified above, and recommends that this case be closed. The recommendation is based upon the facts and circumstances of this particular UST case. A UST Case Closure Review Summary Report has been prepared for the case identified above and the bases for determining compliance with the Water Quality Control Policy for Low-Threat Underground Storage Tank Case Closures (Low-Threat Closure Policy or Policy) are explained in the Case Closure Review Summary Report.

A. Low-Threat Closure Policy

In State Water Board Resolution No. 2012-0016, the State Water Board adopted the Low Threat Closure Policy. The Policy became effective on August 17, 2012. The Policy establishes consistent statewide case closure criteria for certain low-threat petroleum UST sites. In the absence of unique attributes or site-specific conditions that demonstrably increase the risk associated with residual petroleum constituents, cases that meet the general and media-specific criteria in the Low-Threat Closure Policy pose a low threat to human health, safety and the environment and are appropriate for closure under Health and Safety Code section 25296.10. The Policy provides that if a regulatory agency determines that a case meets the general and media-specific criteria of the Policy, then the regulatory agency shall notify responsible parties and other specified interested persons that the case is eligible for case closure. Unless the regulatory agency revises its determination based on comments received on the proposed case closure, the Policy provides that the agency shall issue a closure letter as specified in Health and Safety Code section 25296.10. The closure letter may only be issued after the expiration of the 60-day comment period, proper destruction or maintenance of monitoring wells or borings, and removal of waste associated with investigation and remediation of the site.

Health and Safety Code section 25299.57, subdivision (1)(1) provides that claims for reimbursement of corrective action costs that are received by the Fund more than 365 days after the date of a closure letter or a Letter of Commitment, whichever occurs later, shall not be reimbursed unless specified conditions are satisfied. A Letter of Commitment has already been issued on the claim subject to this order and the respective Fund claimant, so the 365-day

timeframe for the submittal of claims for corrective action costs will start upon the issuance of the closure letter.

II. FINDINGS

Based upon the UST Case Closure Review Summary Report prepared for the case attached hereto, the State Water Board finds that corrective action taken to address the unauthorized release of petroleum at the UST release site identified as:

Claim No. 6093

US Petroleum #141

ensures protection of human health, safety and the environment and is consistent with Chapter 6.7 of Division 20 of the Health and Safety Code and implementing regulations, the Low-Threat Closure Policy and other water quality control policies and applicable water quality control plans.

Pursuant to the Low-Threat Closure Policy, notification has been provided to all entities that are required to receive notice of the proposed case closure, a 60-day comment period has been provided to notified parties, and any comments received have been considered by the Board in determining that the case should be closed.

The UST case identified above may be the subject of orders issued by the Regional Water Quality Control Water Board (Regional Water Board) pursuant to Division 7 of the Water Code. Any orders that have been issued by the Regional Water Board pursuant to Division 7 of the Water Code, or directives issued by a Local Oversight Program agency for this case should be rescinded to the extent they are inconsistent with this Order.

III. ORDER

IT IS THEREFORE ORDERED that:

- A. The UST case identified in Section II of this Order, meeting the general and media-specific criteria established in the Low-Threat Closure Policy, be closed in accordance with the following conditions and after the following actions are complete. Prior to the issuance of a closure letter, the Fund claimant is ordered to:

1. Properly destroy monitoring wells and borings unless the owner of real property on which the well or boring is located certifies that the wells or borings will be maintained in accordance with local or state requirements;

2. Properly remove from the site and manage all waste piles, drums, debris, and other investigation and remediation derived materials in accordance with local or state requirements; and

3. Within six months of the date of this Order, submit documentation to the regulatory agency overseeing the UST case identified in Section II of this Order that the tasks in subparagraphs (1) and (2) have been completed.

- B. The tasks in subparagraphs (1) and (2) of paragraph (A) are ordered pursuant to Health and Safety Code section 25296.10 and failure to comply with these requirements may result in the imposition of civil penalties pursuant to Health and Safety Code section 25299, subdivision (d)(1). Penalties may be imposed administratively by the State Water Board or Regional Water Board.
- C. Within 30 days of receipt of proper documentation from the Fund claimant that requirements in subparagraphs (1) and (2) of paragraph (A) are complete, the regulatory agency that is responsible for oversight of the UST case identified in Section II of this Order shall notify the State Water Board that the tasks have been satisfactorily completed.
- D. Within 30 days of notification from the regulatory agency that the tasks are complete pursuant to paragraph (C), the Deputy Director of the Division of Financial Assistance shall issue a closure letter consistent with Health and Safety Code section 25296.10, subdivision (g) and upload the closure letter and UST Case Closure Review Summary Report to GeoTracker.
- E. As specified in Health and Safety Code section 25299.39.2, subdivision (a) (2), corrective action costs incurred after a recommendation of closure shall be limited to \$10,000 per year unless the Board or its delegated representative agrees that corrective action in excess of that amount is necessary to meet closure requirements, or additional corrective actions are necessary pursuant to section 25296.10, subdivisions (a) and (b). Pursuant to section 25299.57, subdivision (l) (1), and except in specified circumstances,

all claims for reimbursement of corrective action costs must be received by the Fund within 365 days of issuance of the closure letter in order for the costs to be considered.

- F. Any Regional Water Board or Local Oversight Program Agency directive or order that directs corrective action or other action inconsistent with case closure for the UST case identified in Section II is rescinded, but only to the extent the Regional Water Board order or Local Oversight Program Agency directive is inconsistent with this Order.

Thomas Howard

Executive Director

7/18/13

Date

State Water Resources Control Board

UST CASE CLOSURE REVIEW SUMMARY REPORT

Agency Information

Agency Name: Orange County Health Care Agency (County)	Address: 1241 East Dyer Road, Suite 120 Santa Ana, CA 92705
Agency Caseworker: Julie Wozencraft	Case No.: 86UT018

Case Information

USTCF Claim No.: 6093	Global ID: T0605900462
Site Name: US Petroleum #141	Site Address: 14600 Edwards Street Westminster, CA 92683
Responsible Party: 1. Moller Investments Group Inc. Attn: Charles Miller	Address: 1. 6591 Collins Drive, Suite E-11 Moorpark, CA 93021
2. Retail Property Trust	2. 1025 Westminster Mall Westminster CA 92683
USTCF Expenditures to Date: \$931,290	Number of Years Case Open: 26

URL: http://geotracker.waterboards.ca.gov/profile_report.asp?global_id=T0605900462

Summary

The Low-Threat Underground Storage Tank (UST) Case Closure Policy (Policy) contains general and media-specific criteria, and cases that meet those criteria are appropriate for closure pursuant to the Policy. This case meets all of the required criteria of the Policy. A summary evaluation of compliance with the Policy is shown in **Attachment 1: Compliance with State Water Board Policies and State Law**. The Conceptual Site Model upon which the evaluation of the case has been made is described in **Attachment 2: Summary of Basic Case Information (Conceptual Site Model)**. Highlights of the case follow:

An unauthorized leak was reported in February 1986. In February 2012, three 10,000-gallon USTs were removed and the Site was redeveloped into a parking lot. Soil vapor extraction was operated between March 1985 and July 1998, which reportedly removed approximately 15,230 pounds of total petroleum hydrocarbons (TPHg). Groundwater extraction was conducted intermittently between August 1986 and September 1991, which removed 85,000 gallons of contaminated groundwater. Dual phase extraction was conducted intermittently between June 2001 and March 2009, which removed 2,708 pounds of TPHg and 159,000 gallons of contaminated groundwater. Nineteen monitoring wells have been installed since 1985 and monitored regularly. According to groundwater data, water quality objectives have been achieved or nearly achieved for all constituents except benzene and methyl tert-butyl ether (MTBE).

The petroleum release is limited to the shallow soil and groundwater. According to data available in GeoTracker, there are no California Department of Public Health regulated supply wells or surface water bodies within 250 feet of the defined plume boundary. No other water supply wells have been identified within 250 feet of the defined plume boundary in files reviewed. Water is provided to water users near the Site by the City of Westminster Water Division.

The affected groundwater is not currently being used as a source of drinking water and it is highly unlikely that the affected groundwater will be used as a source of drinking water in the foreseeable future. Other designated beneficial uses of impacted groundwater are not threatened and it is highly unlikely that they will be, considering these factors in the context of the site setting. Remaining petroleum hydrocarbon constituents are limited, stable and concentrations declining. Corrective actions have been implemented and additional corrective actions are not necessary. Any remaining petroleum hydrocarbon constituents do not pose a significant risk to human health, safety or the environment.

Rationale for Closure under the Policy

- General Criteria: The case meets all eight Policy general criteria.
- Groundwater Specific Criteria: The case meets Policy Criterion 1 by Class 1. The contaminant plume that exceeds water quality objectives is less than 100 feet in length. There is no free product. The nearest water supply well or surface water body is greater than 250 feet from the defined plume boundary.
- Vapor Intrusion to Indoor Air: The case meets Policy Criterion 2a by Scenario 3a. The maximum benzene concentration in groundwater is less than 100 µg/L. The minimum depth to groundwater is greater than 5 feet, overlain by soil containing less than 100 mg/kg of TPH.
- Direct Contact and Outdoor Air Exposure: The case meets Policy Criterion 3a. Maximum concentrations in soil are less than those in Policy Table 1 for Commercial/Industrial use and the concentration limits for a Utility Worker are not exceeded. There are no soil sample results in the case record for naphthalene at 5-10 feet below ground surface (bgs). However, the relative concentration of naphthalene in soil can be conservatively estimated using the published relative concentrations of naphthalene and benzene in gasoline. Taken from Potter and Simmons (1998), gasoline mixtures contain approximately 2 percent benzene and 0.25 percent naphthalene. Therefore, benzene can be directly substituted for naphthalene concentrations with a safety factor of eight. Benzene concentrations from the Site are below the naphthalene thresholds in Policy Table 1. Therefore, the estimated naphthalene concentrations meet the thresholds in Table 1 and the Policy criteria for direct contact by a factor of eight. It is highly unlikely that naphthalene concentrations in the soil at 5-10 feet bgs, if any, exceed the threshold.

Objections to Closure and Responses

The County has not yet responded to the Responsible Party's 2012 closure request.

RESPONSE: Readily available information about current conditions at the Site shows that the case satisfies all of the criteria in the Policy.

Determination

Based on the review performed in accordance with Health & Safety Code Section 25299.39.2 subdivision (a), the Fund Manager has determined that closure of the case is appropriate.

USA Petroleum # 141
14600 Edwards, Westminster
Claim No: 6093

April 2013

Recommendation for Closure

Based on available information, residual petroleum hydrocarbons at the Site do not pose a significant risk to human health, safety, or the environment, and the case meets the requirements of the Policy. Accordingly, the Fund Manager recommends that the case be closed. The State Water Board is conducting public notification as required by the Policy. Orange County has the regulatory responsibility to supervise the abandonment of monitoring wells.

Lisa Babcock

Lisa Babcock, P.G. 3939, C.E.G. 1235

5/2/13

Date

Prepared by: Ramesh Sundareswaran

ATTACHMENT 1: COMPLIANCE WITH STATE WATER BOARD POLICIES AND STATE LAW

The case complies with the State Water Resources Control Board policies and state law. Section 25296.10 of the Health and Safety Code requires that sites be cleaned up to protect human health, safety, and the environment. Based on available information, any residual petroleum constituents at the site do not pose significant risk to human health, safety, or the environment.

The case complies with the requirements of the Low-Threat Underground Storage Tank (UST) Case Closure Policy as described below.¹

<p>Is corrective action consistent with Chapter 6.7 of the Health and Safety Code and implementing regulations? The corrective action provisions contained in Chapter 6.7 of the Health and Safety Code and the implementing regulations govern the entire corrective action process at leaking UST sites. If it is determined, at any stage in the corrective action process, that UST site closure is appropriate, further compliance with corrective action requirements is not necessary. Corrective action at this site has been consistent with Chapter 6.7 of the Health and Safety Code and implementing regulations and, since this case meets applicable case-closure requirements, further corrective action is not necessary, unless the activity is necessary for case closure.</p>	<p><input checked="" type="checkbox"/> Yes <input type="checkbox"/> No</p>
<p>Have waste discharge requirements or any other orders issued pursuant to Division 7 of the Water Code been issued at this case?</p>	<p><input type="checkbox"/> Yes <input checked="" type="checkbox"/> No</p>
<p>If so, was the corrective action performed consistent with any order?</p>	<p><input type="checkbox"/> Yes <input type="checkbox"/> No <input checked="" type="checkbox"/> NA</p>
<p><u>General Criteria</u> General criteria that must be satisfied by all candidate sites:</p> <p>Is the unauthorized release located within the service area of a public water system?</p> <p>Does the unauthorized release consist only of petroleum?</p> <p>Has the unauthorized (“primary”) release from the UST system been stopped?</p> <p>Has free product been removed to the maximum extent practicable?</p> <p>Has a conceptual site model that assesses the nature, extent, and mobility of the release been developed?</p>	<p><input checked="" type="checkbox"/> Yes <input type="checkbox"/> No</p> <p><input checked="" type="checkbox"/> Yes <input type="checkbox"/> No</p> <p><input checked="" type="checkbox"/> Yes <input type="checkbox"/> No</p> <p><input type="checkbox"/> Yes <input type="checkbox"/> No <input checked="" type="checkbox"/> NA</p> <p><input checked="" type="checkbox"/> Yes <input type="checkbox"/> No</p>

¹ Refer to the Low-Threat Underground Storage Tank Case Closure Policy for closure criteria for low-threat petroleum UST sites.
http://www.waterboards.ca.gov/board_decisions/adopted_orders/resolutions/2012/rs2012_0016atta.pdf

<p>Has secondary source been removed to the extent practicable?</p> <p>Has soil or groundwater been tested for MTBE and results reported in accordance with Health and Safety Code Section 25296.15?</p> <p>Nuisance as defined by Water Code section 13050 does not exist at the site?</p> <p>Are there unique site attributes or site-specific conditions that demonstrably increase the risk associated with residual petroleum constituents?</p>	<p><input checked="" type="checkbox"/> Yes <input type="checkbox"/> No</p> <p><input checked="" type="checkbox"/> Yes <input type="checkbox"/> No</p> <p><input checked="" type="checkbox"/> Yes <input type="checkbox"/> No</p> <p><input type="checkbox"/> Yes <input checked="" type="checkbox"/> No</p>
<p><u>Media-Specific Criteria</u> Candidate sites must satisfy all three of these media-specific criteria:</p> <p>1. Groundwater: To satisfy the media-specific criteria for groundwater, the contaminant plume that exceeds water quality objectives must be stable or decreasing in areal extent, and meet all of the additional characteristics of one of the five classes of sites:</p> <p>Is the contaminant plume that exceeds water quality objectives stable or decreasing in areal extent?</p> <p>Does the contaminant plume that exceeds water quality objectives meet all of the additional characteristics of one of the five classes of sites?</p> <p>If YES, check applicable class: <input checked="" type="checkbox"/> 1 <input type="checkbox"/> 2 <input type="checkbox"/> 3 <input type="checkbox"/> 4 <input type="checkbox"/> 5</p> <p>For sites with releases that have not affected groundwater, do mobile constituents (leachate, vapors, or light non-aqueous phase liquids) contain sufficient mobile constituents to cause groundwater to exceed the groundwater criteria?</p>	<p><input checked="" type="checkbox"/> Yes <input type="checkbox"/> No <input type="checkbox"/> NA</p> <p><input checked="" type="checkbox"/> Yes <input type="checkbox"/> No <input type="checkbox"/> NA</p> <p><input type="checkbox"/> Yes <input type="checkbox"/> No <input checked="" type="checkbox"/> NA</p>
<p>2. Petroleum Vapor Intrusion to Indoor Air: The site is considered low-threat for vapor intrusion to indoor air if site-specific conditions satisfy all of the characteristics of one of the three classes of sites (a through c) or if the exception for active commercial fueling facilities applies.</p> <p>Is the site an active commercial petroleum fueling facility? Exception: Satisfaction of the media-specific criteria for petroleum vapor intrusion to indoor air is not required at active commercial petroleum fueling facilities, except in cases where release characteristics can be reasonably believed to pose an unacceptable health risk.</p> <p>a. Do site-specific conditions at the release site satisfy all of the applicable characteristics and criteria of scenarios 1 through 3 or all of the applicable characteristics and criteria of scenario 4? If YES, check applicable scenarios: <input type="checkbox"/> 1 <input type="checkbox"/> 2 <input checked="" type="checkbox"/> 3 <input type="checkbox"/> 4</p>	<p><input type="checkbox"/> Yes <input checked="" type="checkbox"/> No</p> <p><input checked="" type="checkbox"/> Yes <input type="checkbox"/> No <input type="checkbox"/> NA</p>

<p>b. Has a site-specific risk assessment for the vapor intrusion pathway been conducted and demonstrates that human health is protected to the satisfaction of the regulatory agency?</p> <p>c. As a result of controlling exposure through the use of mitigation measures or through the use of institutional or engineering controls, has the regulatory agency determined that petroleum vapors migrating from soil or groundwater will have no significant risk of adversely affecting human health?</p>	<p><input type="checkbox"/> Yes <input type="checkbox"/> No <input checked="" type="checkbox"/> NA</p> <p><input type="checkbox"/> Yes <input type="checkbox"/> No <input checked="" type="checkbox"/> NA</p>
<p>3. Direct Contact and Outdoor Air Exposure: The site is considered low-threat for direct contact and outdoor air exposure if site-specific conditions satisfy one of the three classes of sites (a through c).</p> <p>a. Are maximum concentrations of petroleum constituents in soil less than or equal to those listed in Table 1 for the specified depth below ground surface (bgs)?</p> <p>b. Are maximum concentrations of petroleum constituents in soil less than levels that a site specific risk assessment demonstrates will have no significant risk of adversely affecting human health?</p> <p>c. As a result of controlling exposure through the use of mitigation measures or through the use of institutional or engineering controls, has the regulatory agency determined that the concentrations of petroleum constituents in soil will have no significant risk of adversely affecting human health?</p>	<p><input checked="" type="checkbox"/> Yes <input type="checkbox"/> No <input type="checkbox"/> NA</p> <p><input type="checkbox"/> Yes <input type="checkbox"/> No <input checked="" type="checkbox"/> NA</p> <p><input type="checkbox"/> Yes <input type="checkbox"/> No <input checked="" type="checkbox"/> NA</p>

ATTACHMENT 2: SUMMARY OF BASIC CASE INFORMATION (Conceptual Site Model)

Site Location/History

- This case is located on the northeast corner of Edwards Street and Royal Oak Drive and is currently used as a parking lot.
- The Site is bounded by residences across Edwards Street to the west, a commercial building across West Drive to the south, and a mall and associated parking lot to the north and east.
- Site maps showing the location of the former USTs, monitoring wells and benzene concentrations are provided at the end of this closure review summary (Environ Strategy Consultants, Inc [ES], 2012).
- Nature of Contaminants of Concern: Petroleum hydrocarbons only.
- Source: UST system.
- Date reported: February 1986.
- Status of Release: USTs removed.
- Free Product: None reported.

Tank Information

Tank No.	Size in Gallons	Contents	Closed in Place/Removed/Active	Date
1-3	10,000	Gasoline	Removed	February 2012
4	10,000	Diesel	Removed	February 2012

Receptors

- GW Basin: Coastal Plain of Orange County.
- Beneficial Uses: Municipal and Domestic Supply.
- Land Use Designation: Commercial.
- Public Water System: City of Westminster Water Division.
- Distance to Nearest Supply Well: According to data available in GeoTracker, there are no known public supply wells regulated by California Department of Public Health within 250 feet of the defined plume boundary. No other water supply wells were identified within 250 feet of the defined plume boundary in the files reviewed.
- Distance to Nearest Surface Water: There is no identified surface water within 250 feet of the defined plume boundary.

Geology/Hydrogeology

- Stratigraphy: The Site is underlain by silty clays, clayey silt, sandy silts and silty sands.
- Maximum Sample Depth: 25 feet below ground surface (bgs).
- Minimum Groundwater Depth: 5.51 feet bgs at monitoring well PVX-4.
- Maximum Groundwater Depth: 20.48 feet bgs at monitoring well MW-11P.
- Current Average Depth to Groundwater: Approximately 10 feet bgs.
- Saturated Zones(s) Studied: Approximately 3 - 23 feet bgs.
- Appropriate Screen Interval: One well is currently submerged.
- Groundwater Flow Direction: Generally west with an average gradient of 0.008 feet/foot.

Monitoring Well Information

Well Designation	Date Installed	Screen Interval (feet bgs)	Depth to Water (feet bgs) (10/23/2012)
MW-1	December 1985	13-18	10.21
MW-4	February 1986	10-20	NM
MW-5	February 1986	10-20	NM
MW-6	February 1986	10-20	10.42
MW-7	February 1986	10-20	10.56
MW-8	February 1986	10-20	10.74
MW-9	March 1997	3-23	NM
MW-10P	March 1993	3-23	NM
MW-11P	March 1993	3-23	11.21
MW-12P	March 1993	5-20	10.02
MW-13P	March 1993	5-20	9.67
MW-14P	March 1993	5-20	NM
MW-15P	December 1997	5-20	10.96
MW-16	September 2008	5-20	10.74
PVX-1	March 1995	4-14	10.22
PVX-2	March 1995	4-14	NM
PVX-3	March 1995	4-14	NM
PVX-4	March 1995	4-14	10.25
PVX-5	March 1995	4-14	9.77

NM: Not measured

Remediation Summary

- Free Product: None reported in GeoTracker.
- Soil Excavation: Approximately 90 tons of contaminated soil were excavated and disposed offsite following the removal of USTs in 2012.
- In-Situ Soil/Groundwater Remediation: Soil vapor extraction was conducted between March 1985 and July 1998, which reportedly removed approximately 15,230 pounds of TPHg. Groundwater extraction was conducted intermittently between August 1986 and September 1991, which removed 85,000 gallons of contaminated groundwater. Dual phase extraction was conducted intermittently between June 2001 and March 2009, which removed 2,708 pound of TPHg and 159,000 gallons of contaminated groundwater.

Most Recent Concentrations of Petroleum Constituents in Soil

Constituent	Maximum 0-5 feet bgs [mg/kg and (date)]	Maximum 5-10 feet bgs [mg/kg and (date)]
Benzene	<0.0488 (2/22/12)	0.565 (2/1/08)
Ethylbenzene	0.054 (2/22/12)	9.81 (2/1/08)
Naphthalene	<0.005 (2/22/12)	NA
PAHs	NA	NA

NA: Not Analyzed, Not Applicable or Data Not Available
 mg/kg: Milligrams per kilogram, parts per million
 <: Not detected at or above stated reporting limit
 PAHs: Polycyclic aromatic hydrocarbons

Most Recent Concentrations of Petroleum Constituents in Groundwater

Sample	Sample Date	TPHg (µg/L)	Benzene (µg/L)	Toluene (µg/L)	Ethyl-Benzene (µg/L)	Xylenes (µg/L)	MTBE (µg/L)	TBA (µg/L)
MW-1	10/23/12	<50	<1	<5	<5	<5	2.1	<10
MW-4	01/15/07	<100	<1	<1	<1	<1	<1	<5
MW-5	01/15/07	260	<1	<1	3.28	4.15	15.7	47.5
MW-6	10/23/12	70.5	<1	<5	<5	<5	29	<10
MW-7	09/22/10	<50	<1	<5	<5	<5	1.4	<10
MW-8	10/23/12	700	<1	<5	7.3	<5	<1	<10
MW-9	01/15/07	<100	<1	<1	<1	<1	<1	<5
MW-10P	01/15/07	<100	<1	<1	<1	<1	<1	<5
MW-11P	10/23/12	<50	<1	<5	<5	<5	1.2	95
MW-12P	10/23/12	<50	<1	<5	<5	<5	<1	<10
MW-13P	01/15/07	<100	<1	<1	<1	<1	<1	<5
MW-14P	01/15/07	<100	<1	<1	<1	<1	<1	<5
MW-15P	10/23/12	<50	<1	<5	<5	<5	<1	<10
MW-16	10/23/12	123	3	<5	<5	45	12	<10
PVX-1	01/15/07	<50	<1	<1	<1	<1	<1	<5
PVX-2	09/22/10	91	<1	<5	<5	<5	7.5	<10
PVX-3	09/14/11	<50	<1	<5	<5	<5	<1	<10
PVX-4	09/14/11	<50	<1	<5	<5	<5	<1	<10
PVX-5	10/23/12	<100	<1	<5	<5	<5	2.5	54
WQOs	-	--	1	150	300	1,750	5^a	1,200^b

NA: Not Analyzed, Not Applicable or Data Not Available

µg/L: Micrograms per liter, parts per billion

<: Not detected at or above stated reporting limit

TPHg: Total petroleum hydrocarbons as gasoline

MTBE: Methyl tert-butyl ether

TBA: Tert-butyl alcohol

WQOs: Water Quality Objectives, Santa Ana Regional Water Quality Control Board (Regional Water Board) Basin Plan

--: Regional Water Board Basin Plan has no numeric water quality objective for TPHg

^a: Secondary maximum contaminant level (MCL)

^b: California Department of Public Health, Response Level

Groundwater Trends

- There are more than 26 years of groundwater monitoring data for this case. Four onsite monitoring wells (MW-5, MW-6, MW-16 and PVX-2) slightly exceed water quality objectives for MTBE, and one monitoring well (MW-16) slightly exceeds the water quality objective for benzene. MTBE trends are shown below: Source Area (MW-6). Downgradient wells MW-12P and MW-15P have reached water quality objectives and have contained no MTBE since 2003.

Source Area Well

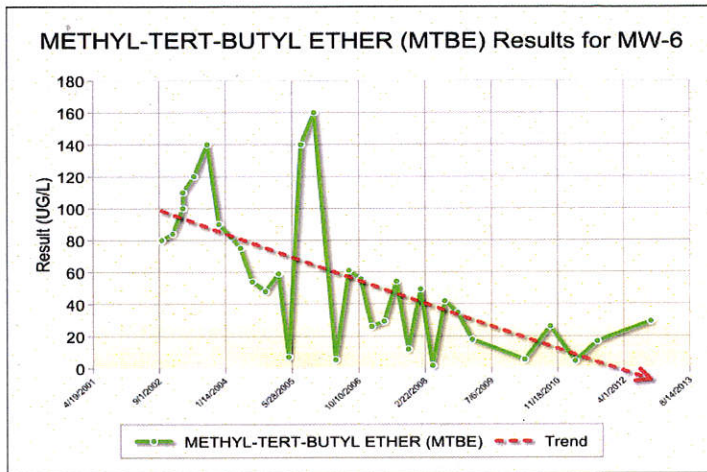

Evaluation of Current Risk

- Estimate of Hydrocarbon Mass in Soil: None reported.
- Soil/Groundwater tested for MTBE: Yes, see table above.
- Oxygen Concentrations in Soil Vapor: None reported.
- Plume Length: <100 feet long.
- Plume Stable or Decreasing: Yes.
- Contaminated Zone(s) Used for Drinking Water: No.
- Groundwater Risk from Residual Petroleum Hydrocarbons: The case meets Policy Criterion 1 by Class 1. The plume that exceeds water quality objective is less than 100 feet in length. There is no free product. The nearest water supply well or surface water body is greater than 250 feet from the defined plume boundary.
- Indoor Vapor Risk from Residual Petroleum Hydrocarbons: The case meets Policy Criterion 2a. by Scenario 3a. The maximum benzene concentration in groundwater is less than 100 µg/L. The minimum depth to groundwater is greater than 5 feet, overlain by soil containing less than 100 mg/kg of TPH.
- Direct Contact Risk from Residual Petroleum Hydrocarbons: The case meets Policy Criterion 3a. Maximum concentrations in soil are less than those in Policy Table 1 for Commercial/Industrial use and the concentration limits for a Utility Worker are not exceeded. There are no soil sample results in the case record for naphthalene at 5-10 feet bgs. However, the relative concentration of naphthalene in soil can be conservatively estimated using the published relative concentrations of naphthalene and benzene in gasoline. Taken from Potter and Simmons (1998), gasoline mixtures contain approximately 2 percent benzene and 0.25 percent naphthalene. Therefore, benzene can be directly substituted for naphthalene concentrations with a safety factor of eight. Benzene concentrations from the Site are below the naphthalene thresholds in Policy Table 1. Therefore, the estimated naphthalene concentrations meet the thresholds in Table 1 and the Policy criteria for direct contact by a factor of eight. It is highly unlikely that naphthalene concentrations in the soil at 5-10 feet bgs, if any, exceed the threshold.

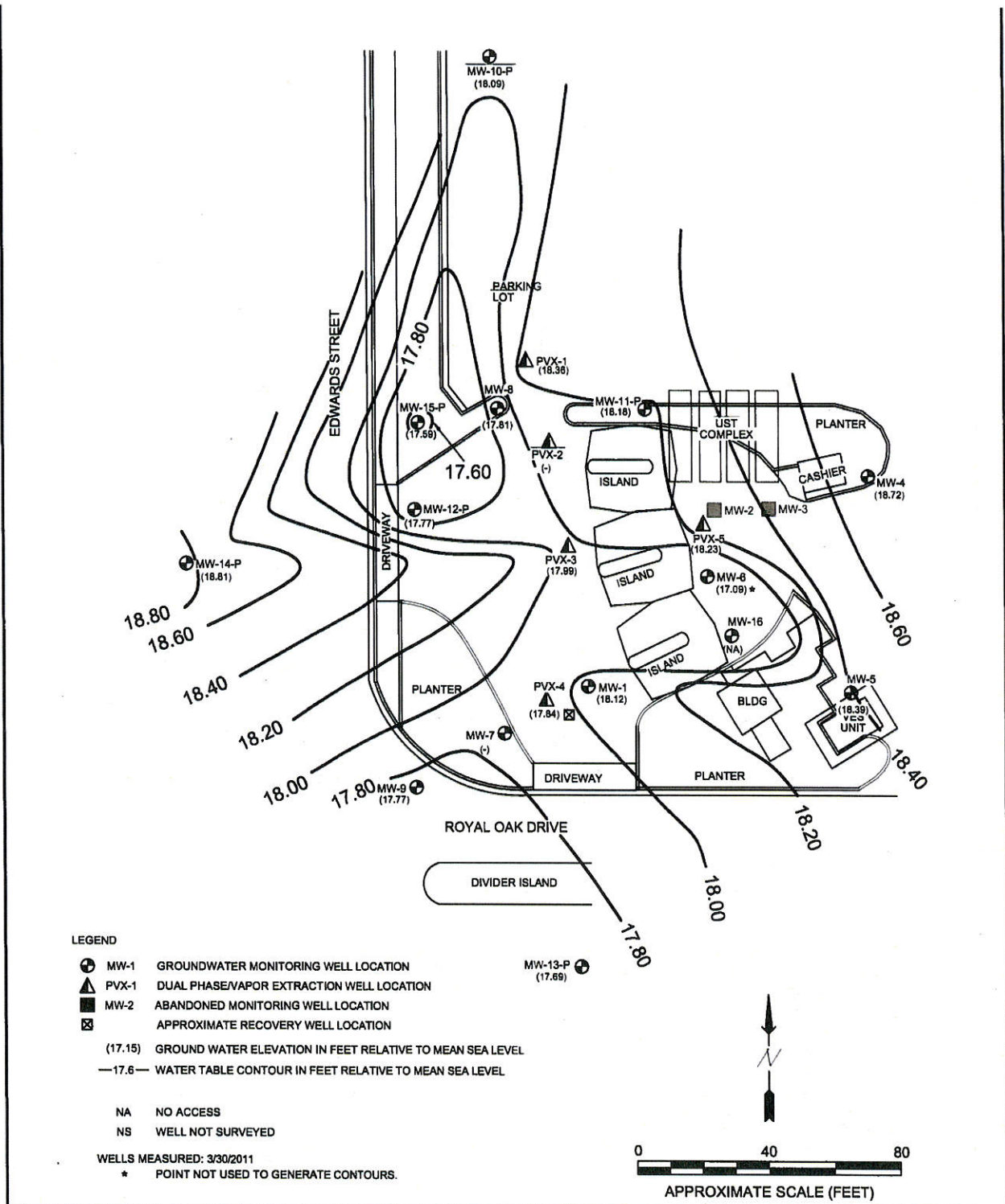

STRATUS
 ENVIRONMENTAL, INC.

5412 BOLSA AVENUE, SUITE G
 HUNTINGTON BEACH, CALIFORNIA
 PHONE: (714) 230-2495

FOR:
 FORMER USA SERVICE STATION
 STATION NO. 141
 14600 EDWARDS STREET
 WESTMINSTER, CALIFORNIA

JOB NUMBER: 1007-1460
 DRAWN BY: R. ERDMAN

GROUNDWATER ELEVATION
 CONTOUR MAP
 1st HALF 2011

CHECKED BY: S. KALINA
 APPROVED BY: S. KALINA

FIGURE:
3

DATE: 4/1/11

