

STATE OF CALIFORNIA
CALIFORNIA REGIONAL WATER QUALITY CONTROL BOARD
CENTRAL COAST REGION
81 Higuera Street, Suite 200
San Luis Obispo, California 93401-5427

WASTE DISCHARGE REQUIREMENTS ORDER NO. 98-02
WDID NO. 3 279706001

For

KENDALL-JACKSON WINERY, SOLEDAD
Monterey County

The California Regional Water Quality Control Board, Central Coast Region (Board), finds;

1. Mr. Stephen von Raesfield, submitted a Report of Waste Discharge for Kendall-Jackson Winery (hereafter Discharger) on June 26, 1997 (updated on September 2, 1997), in accordance with Section 13260 of the California Water Code. The report was filed for authorization to discharge wine processing wastewater generated at a new winery facility to be located at 36200 Doud Road, Soledad, CA, Monterey County.
2. The Discharger proposes to discharge an average of 42,000 gallons-per-day (gpd) of processing wastewater from its facility. Average process wastewater discharged during the peak season (September and October) will be 79,900 gpd. Plans call for an ultimate annual 3,784,000 gallons of wine production with 9,175 tons of grapes crushed on site.
3. Process wastewater is generated from bottling, tank, equipment and floor cleaning. Treatment will consist of initial screening, pH control, provision for chemical additions, and biological stabilization in two lined aeration ponds. Treated wastewater will be reused by irrigation of 75 acres (minimum) of vineyard.
4. Solid wastes generated from the winery will be primarily pomace, seeds, and stems. The annual volume of solid wastes generated will be approximately 6,000 cubic yards. Solid wastes will be applied to 195 acres of vineyard as soil

amendment. Solids will also accumulate in the ponds and require periodic removal every 5-10 years. These highly decomposed solids could be either dried, spread, and disked in a vineyard or pasture area or transported to a solid waste disposal site. Sanitary wastewater is discharged to a separate septic tank/leachfield system regulated by Monterey County.

5. The Water Quality Control Plan, Central Coast Basin (Basin Plan) was adopted by the Board on November 17, 1989. The Basin Plan incorporates statewide plans and policies by reference and contains a strategy for protecting beneficial uses of State waters.
6. Ground water objectives specified in the Basin Plan for the vicinity of the discharge, are as follows:

Constituent	Objective
Total Dissolved Solids	1500 mg/l
Sodium	150 mg/l
Chloride	250 mg/l
Nitrate (as N)	8.0 mg/l
Sulfate	150 mg/l

7. Present and anticipated beneficial uses of ground water in the vicinity of the discharge include: Domestic, Municipal, Agricultural and Industrial Supply.
8. Ground water analysis of the vineyard's main water supply well reveals the following quality:

Constituent	Concentration, mg/l
Total Dissolved Solids	190 mg/l
Sodium	12 mg/l
Chloride	6.7 mg/l
Nitrate (NO ₃)	2 mg/l
Nitrite Nitrogen	<0.4 mg/l
Sulfate	64 mg/l

9. Discharge of Waste is a privilege, not a right, and authorization to discharge is conditional upon the discharge complying with provisions of Division 7 of the California Water Code and any more stringent effluent limitations necessary to implement water quality control plans, to protect beneficial uses, and to prevent nuisance. Compliance with this Order should assume this and mitigate any potential adverse changes in water quality due to discharge
10. The Discharger applied for a Negative Declaration for their use permit on July 30, 1997. Monterey County adopted the Negative Declaration on August 28, 1997.
11. On September 8, 1997, the Board notified the Discharger and interested agencies and person of its intent to issue waste discharge requirements for the discharge and has provided them with a copy of the proposed Order and an opportunity to submit written views and comments.
12. After considering all comments pertaining to this discharge during a public hearing on January 30, 1998, this Order was found consistent with the above findings.

IT IS HEREBY ORDERED, pursuant to authority in Section 13263 of the California Water Code, Kendall Jackson Winery, their agents, successors, and assigns, may discharge wastewater, providing compliance is maintained with the following:

(Note: Other prohibitions and conditions, definitions, and the method of determining compliance are contained in the attached "Standard Provisions and Reporting Requirements for Waste Discharge Requirements" dated January 1984.)

Throughout these requirements footnotes are listed to indicate the source of requirements specified. Requirement footnotes are as follows:

A = Basin Plan

B = Administrative Procedures Manual

Requirements not referenced are based on Staff's professional judgment.

A. PROHIBITIONS

1. Discharge to areas other than the holding ponds or vineyards shown on attachment "A" is prohibited.
2. Discharge of any wastes including overflow, bypass, overspray and runoff from transport, treatment, or disposal systems to adjacent drainageways or adjacent properties is prohibited.
3. Discharge of sanitary wastes, or any wastes other than from wine processing, is prohibited.
4. Discharge of salt brines to the process wastewater is prohibited.
5. Discharge of uncontaminated storm waters to the treatment facilities is prohibited unless adequate capacity is available.

B. DISCHARGE SPECIFICATIONS

1. Peak seasonal process wastewater discharge during crush periods shall not exceed a monthly average of 87,000 gpd. Annual average flows shall not exceed 42,000 gpd.
2. Wastewater discharged from the ponds shall not have pH less than 6.5 or greater than 8.4.
3. The dissolved oxygen level in the wastewater treatment and holding ponds shall not be less than 1.0 mg/l at any time.
4. Wastewater applied to the disposal area shall not become anaerobic, as evidenced by

malodorous gas production or by black sulfide slimes on the surface of the ground.

5. Wastewater applied to the vineyard shall not exceed the following limits:

Constituent	Max. limitation
Total Dissolved Solids	1000 mg/l
Total Nitrogen (as N)	8 mg/l
Sulfate	150 mg/l

C. GROUND WATER LIMITATIONS

1. The discharge shall not cause a significant increase of mineral constituent concentrations in underlying ground waters.
2. The discharge shall not cause concentrations of chemicals and radionuclides in ground water to exceed limits set forth in Title 22 of the California Code of Regulations.^A

D. PROVISIONS

1. Discharger shall comply with "Monitoring and Reporting Program No. 98-02", as specified by the Executive Officer.
2. Discharger shall comply with the attached "Standard Provisions and Reporting Requirements for Waste Discharge Requirements" dated January, 1984.
3. Pursuant to Title 23, Division 3, Subchapter 9, of the California Code of Regulations, the Discharger must submit a written report to the Executive Officer not later than February 6, 2003 addressing:^B
 - a. Whether there will be changes in the continuity, character, location, or volume of the discharge; and,
 - b. Whether, in their opinion, there is any portion of the Order that is incorrect, obsolete, or otherwise in need of revision.

I, Roger W. Briggs, Executive Officer, do hereby certify the foregoing is a full, true, and correct copy of an Order adopted by the California Regional Water Quality Control Board, Central Coast Region, on January 30, 1998.

 for Roger W. Briggs, Executive Officer

KEN ALL-JACKSON WINE...Y
ORDER NO. 98-02

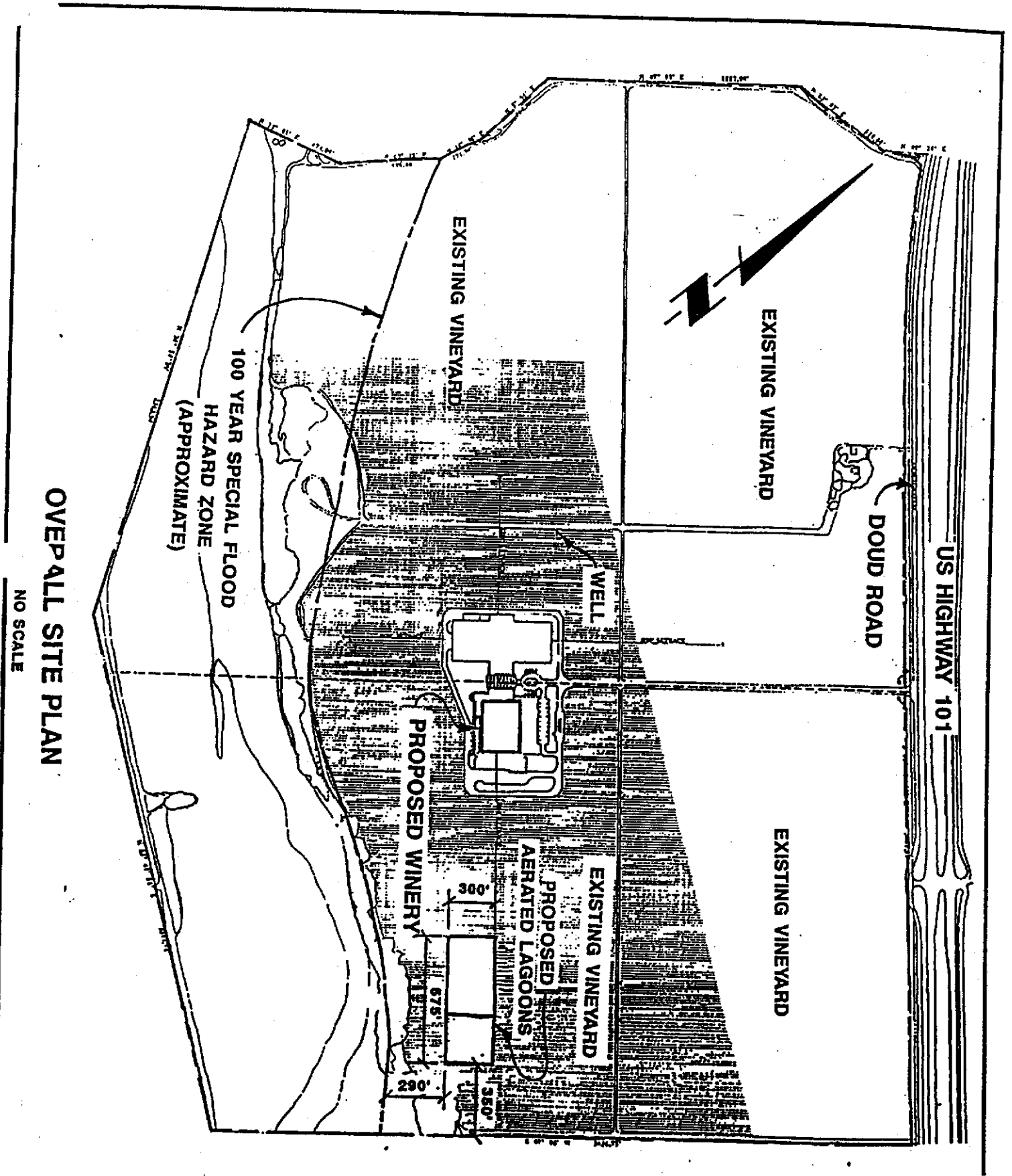

OVERALL SITE PLAN

NO SCALE

ATTACHMENT "A"

KEI ALL-JACKSON WINERY
ORDER NO. 98-02

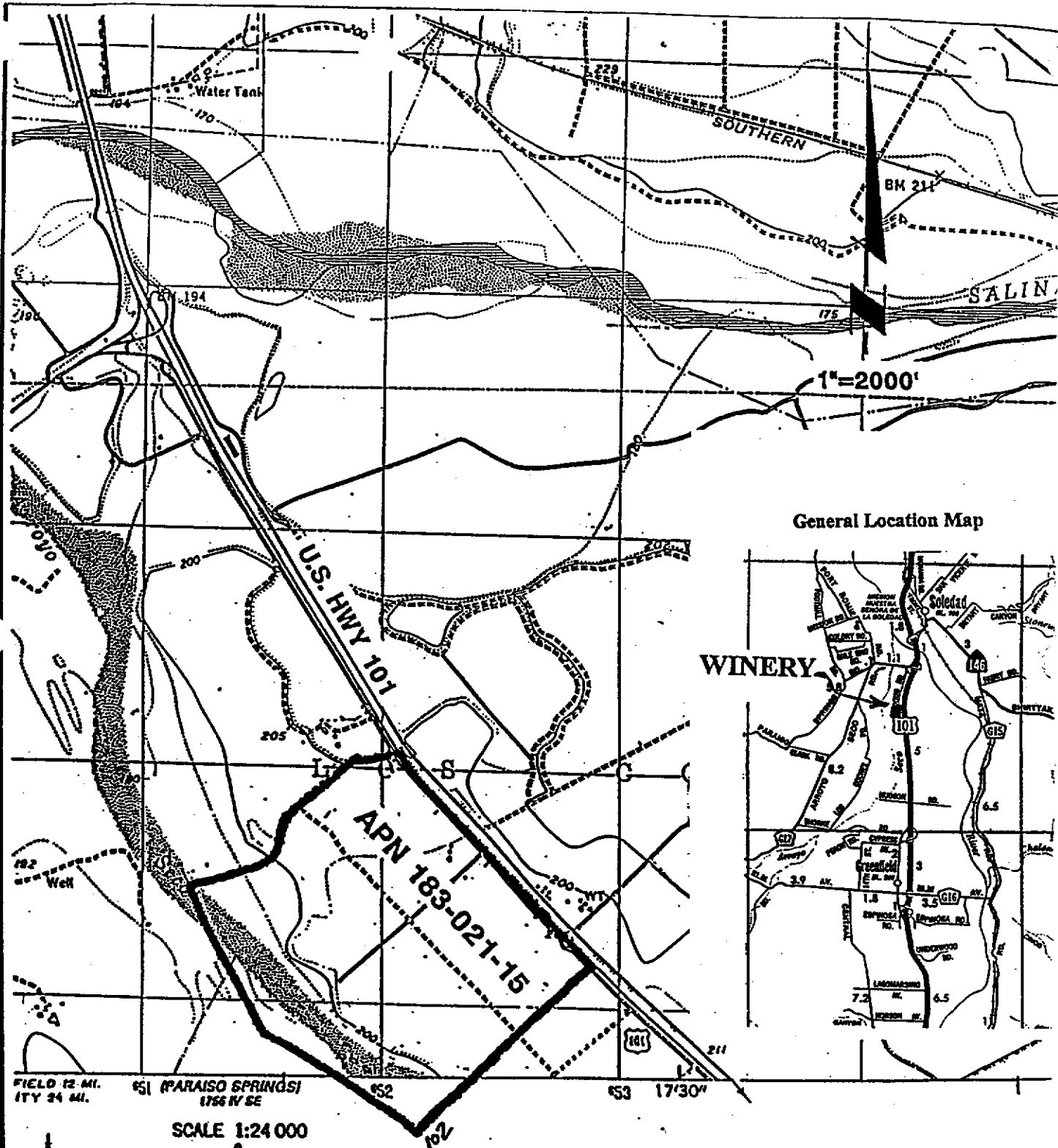

General Location Map

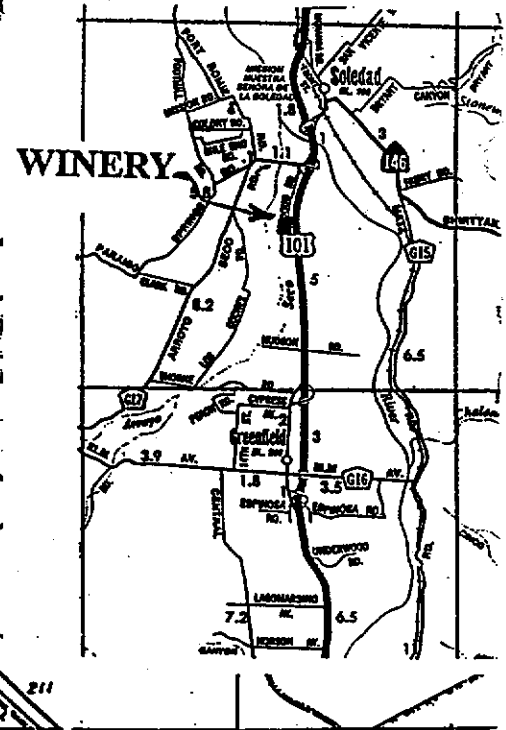

LOCATION MAP

OBTAINED FROM U.S.G.S. 7.5 MIN QUADRANGLE MAPS:
SOLEDAD QUADRANGLE

ATTACHMENT "B"

970455C1

**STATE OF CALIFORNIA
CALIFORNIA REGIONAL WATER QUALITY CONTROL BOARD
CENTRAL COAST REGION**

**MONITORING AND REPORTING PROGRAM NO. 98-02
WDID NO. 3 279706001**

FOR

**KENDALL-JACKSON WINERY
Monterey County**

WATER SUPPLY MONITORING

Representative samples of the water supply shall be collected and analyzed as follows:

Table 1

Constituent	Units	Sample Type	Minimum Sampling and Analyzing Frequency *
Total Dissolved Solids	mg/l	Grab	Semi-Annually
Total Nitrogen (as N)	mg/l	Grab	Semi-Annually

EFFLUENT MONITORING

Representative samples of the wine processing discharge from the aeration ponds shall be collected and analyzed as follows:

Table 2

Constituent	Units	Sample Type	Minimum Frequency and Analyzing Frequency
Daily Flow	gpd	Metered	Daily
Average Flow	gpd	Calculated	Monthly/Annually
pH	pH units	Grab	Quarterly
Total Dissolved Solids	mg/l	Grab	Quarterly
Total Nitrogen (as N)	mg/l	Grab	Quarterly

* During periods of discharge

POND MONITORING

Table 3

Constituent	Units	Sample Type	Minimum Sampling and Analyzing Frequency
Dissolved Oxygen	mg/l	Grab	Monthly

DISPOSAL AREA MONITORING

Wastewater ponds shall be inspected weekly for freeboard and available storage. Freeboard and available storage shall be presented in tabular form in each quarterly report. Wastewater facilities shall also be inspected weekly for evidence of any nuisance condition (odors, vector, etc.). Conditions of this nature shall be reported to the Executive Officer or his representative and to the County Department of Environmental Health within 24 hours of

knowing of such conditions. The incident shall be promptly investigated and remedied. A record shall be kept of dates and nature of observations and remedies.

REPORTING

Reports shall be prepared for each calendar quarter with the reports due by the 30th of January and July. Reports shall contain all data collected or calculated, and all observations made during the previous two quarters. It shall also contain a narrative summary of any exceptions to Waste Discharge Requirements.

Ordered By Paul J. [Signature]
for Roger W. Briggs, Executive Officer

Date