

**CALIFORNIA REGIONAL WATER QUALITY CONTROL BOARD
CENTRAL COAST REGION
81 Higuera Street, Suite 200
San Luis Obispo, California 93401**

**WASTE DISCHARGE REQUIREMENTS ORDER NO. 98-04
WDID # 3 409708001**

FOR

**WILD HORSE WINERY
TEMPLETON
SAN LUIS OBISPO COUNTY, CA**

The California Regional Water Quality Control Board, Central Coast Region (Board), finds;

1. Mr. Kenneth Q. Volk III, President, submitted a Report of Waste Discharge for Wild Horse Winery (hereafter Discharger) on August 14, 1997 (updated on October 6 and December 17, 1997), in accordance with Section 13260 of the California Water Code. The report was filed for authorization to discharge wine processing wastewater generated from an existing winery facility located at 1437 Wild Horse Court in Templeton, San Luis Obispo County, California.
2. Wild Horse Winery has been processing grapes and making wine at this location since 1983. Wastewater produced during the process had been discharged to a settling tank and subsurface disposal facility. Currently, the Discharger has an interim wastewater management system which incorporates conversion of an existing 6.2 acre-ft. irrigation reservoir into an aerated treatment lagoon and reuse on their vineyard.
3. The Discharger is expanding its current production of 70,000 cases of wine per year to 100,000 cases per year. The wastewater treatment and disposal facilities are designed for 120,000 cases per year. Average process wastewater discharged during the peak season (September and October) will be 11,500 gpd with peak daily flows of 12,800 gpd. Annual average flows will be 4,750 gpd.
4. Process wastewater is generated from bottling, tank, equipment and floor cleaning. Crushing occurs at this facility. No distillation occurs so there will be no stillage waste. Treatment will consist of initial screening, pH control (if needed), settling tanks, and biological stabilization in two lined aeration ponds. Treated wastewater will be reclaimed on a minimum of 50 acres of existing vineyard. Driller well logs indicate the upper 10 - 15 feet of soil consists of sand and gravel followed by layers of clay and gravel.
5. Solid wastes generated from the winery will be primarily grape skins, pomace, seeds, and stems. The annual volume of solid wastes generated will be approximately 1175 cubic yards. Solid wastes will be applied to 50 acres of vineyard as soil amendment or be used as animal feed. Solids will also accumulate in the ponds and require periodic removal every 5-10 years. These highly decomposed solids could be either dried, spread, and disked in a vineyard or pasture area or transported to a solid waste disposal site.
6. Sanitary wastewater is discharged to a separate septic tank/leachfield system regulated by San Luis Obispo County.
7. The Water Quality Control Plan, Central Coast Basin (Basin Plan) was adopted by the Board on November 17, 1989. The Basin Plan incorporates statewide plans and policies by

**Item No. 19, Attachment 1
Wild Horse Winery
September 8-9, 2005 Meeting**

reference and contains a strategy for protecting beneficial uses of State waters.

8. Ground water objectives specified in the Basin Plan for the vicinity of the discharge are as follows:

Atascadero sub-area:

Constituent	Objective
Total Dissolved Solids	550 mg/l
Sodium Chloride	65 mg/l
Nitrogen (as N)	70 mg/l
Sulfate	2.3 mg/l
	85 mg/l

Templeton sub-area:

Constituent	Objective
Total Dissolved Solids	730 mg/l
Sodium Chloride	75 mg/l
Nitrogen (as N)	100 mg/l
Sulfate	2.7 mg/l
	120 mg/l

9. Present and anticipated beneficial uses of ground water in the vicinity of the discharge include: Domestic, Municipal, Agricultural and Industrial Supply.

10. Static groundwater in the vicinity was reported to be 131 feet deep. Ground water analysis of the vineyard's main water supply well (500 feet deep) reveals the following quality:

Constituent	Concentration, mg/l
Total Dissolved Solids	450 mg/l
Sodium Chloride	21 mg/l
Nitrate (as N)	69 mg/l
Sulfate	1.7 mg/l
	12 mg/l

11. Discharge of Waste is a privilege, not a right, and authorization to discharge is conditional upon the discharge complying with provisions of Division 7 of the California Water Code and any more stringent effluent limitations necessary to implement water quality control plans, to protect beneficial uses, and to prevent nuisance. Compliance with this Order should assure

conditions are met and mitigate any potential adverse changes in water quality due to discharge.

12. The Discharger received a Negative Declaration for their use permit on June 26, 1997, from San Luis Obispo County.

13. On November 3, 1997, the Board notified the Discharger and interested agencies and persons of its intent to issue waste discharge requirements for the discharge and has provided them with a copy of the proposed Order and an opportunity to submit written views and comments.

14. After considering all comments pertaining to this discharge during a public hearing on April 2, 1998, this Order was found consistent with the above findings.

IT IS HEREBY ORDERED, pursuant to authority in Section 13263 of the California Water Code, Wild Horse Winery, their agents, successors, and assigns, may discharge wastewater, providing compliance is maintained with the following:

(Note: Other prohibitions and conditions, definitions, and the method of determining compliance are contained in the attached "Standard Provisions and Reporting Requirements for Waste Discharge Requirements" dated January 1984.)

Throughout these requirements footnotes are listed to indicate the source of requirements specified. Requirement footnotes are as follows:

- A = Basin Plan
- B = Administrative Procedures Manual

Requirements not referenced are based on staff's professional judgment.

A. PROHIBITIONS

1. Discharge to areas other than the holding ponds or vineyards shown on attachment "B" is prohibited. Use of the leach field can only be used during emergency conditions.

2. Discharge of any wastes including overflow, bypass, overspray and runoff from transport, treatment, or disposal systems to adjacent drainageways or adjacent properties is prohibited.
3. Discharge of sanitary wastes, or any wastes other than from wine processing, is prohibited.
4. Discharge of uncontaminated storm waters to the treatment facilities is prohibited unless adequate capacity is proven.

B. DISCHARGE SPECIFICATIONS

1. Peak seasonal process wastewater discharge during crush periods shall not exceed a monthly average of 11,500 gpd. Annual average flows shall not exceed 4750 gpd.
2. Wastewater discharged from the lined treatment ponds shall not have pH less than 6.5 or greater than 8.4.^A
3. The dissolved oxygen level in the wastewater treatment and holding ponds shall not be less than 1.0 mg/l at any time.
4. Wastewater applied to the disposal area shall not become anaerobic, as evidenced by malodorous gas production or by black sulfide slimes on the surface of the ground.
5. Wastewater applied to the vineyard shall not exceed the following limits:

Constituent	Max. limitation
Total Dissolved Solids	650 mg/l
Total Nitrogen (as N)	2.5 mg/l
Sulfate	85 mg/l

I, **Roger W. Briggs, Executive Officer**, do hereby certify the foregoing is a full, true, and correct copy of an Order adopted by the California Regional Water Quality Control Board, Central Coast Region, on April 2, 1998.

C. GROUND WATER LIMITATIONS

1. The discharge shall not cause a significant increase of mineral constituent concentrations in underlying ground waters.
2. The discharge shall not cause concentrations of chemicals and radionuclides in ground water to exceed limits set forth in Title 22 of the California Code of Regulations.^A

D. PROVISIONS

1. Discharger shall comply with "Monitoring and Reporting Program No. 98-04", as specified by the Executive Officer.
2. Discharger shall comply with the attached "Standard Provisions and Reporting Requirements for Waste Discharge Requirements" dated January, 1984.
3. Pursuant to Title 23, Division 3, Subchapter 9, of the California Code of Regulations, the Discharger must submit a written report to the Executive Officer not later than July 30, 2003 addressing:^B
 - a. Whether there will be changes in the continuity, character, location, or volume of the discharge; and,
 - b. Whether, in their opinion, there is any portion of the Order that is incorrect, obsolete, or otherwise in need of revision.

Executive Officer

Wild Horse Winery Order No. 98-04

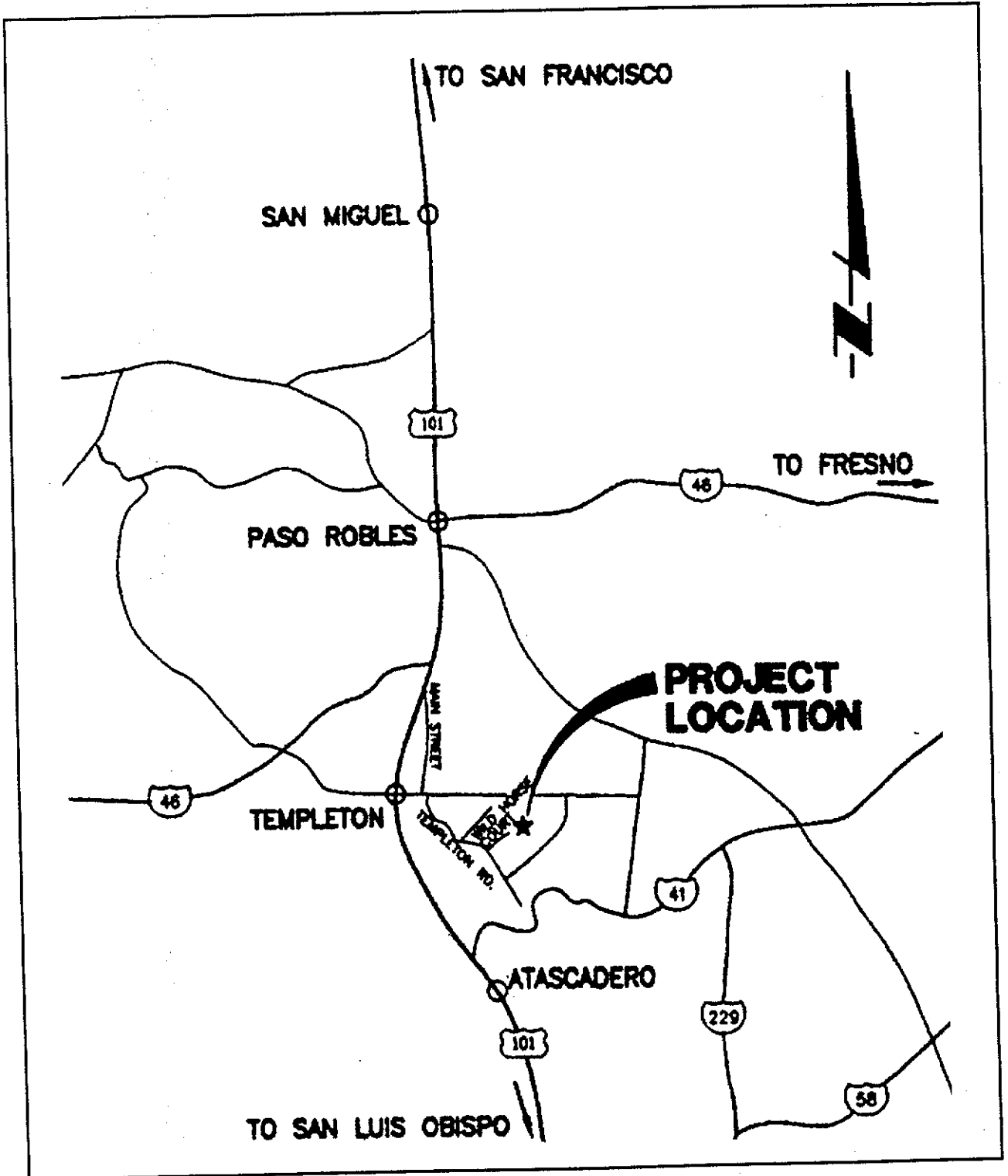

(Not to scale)
1" = approximately 3.5 miles

Attachment "A" - Location of Wild Horse Winery

Wild Horse Winery Order No. 98-04

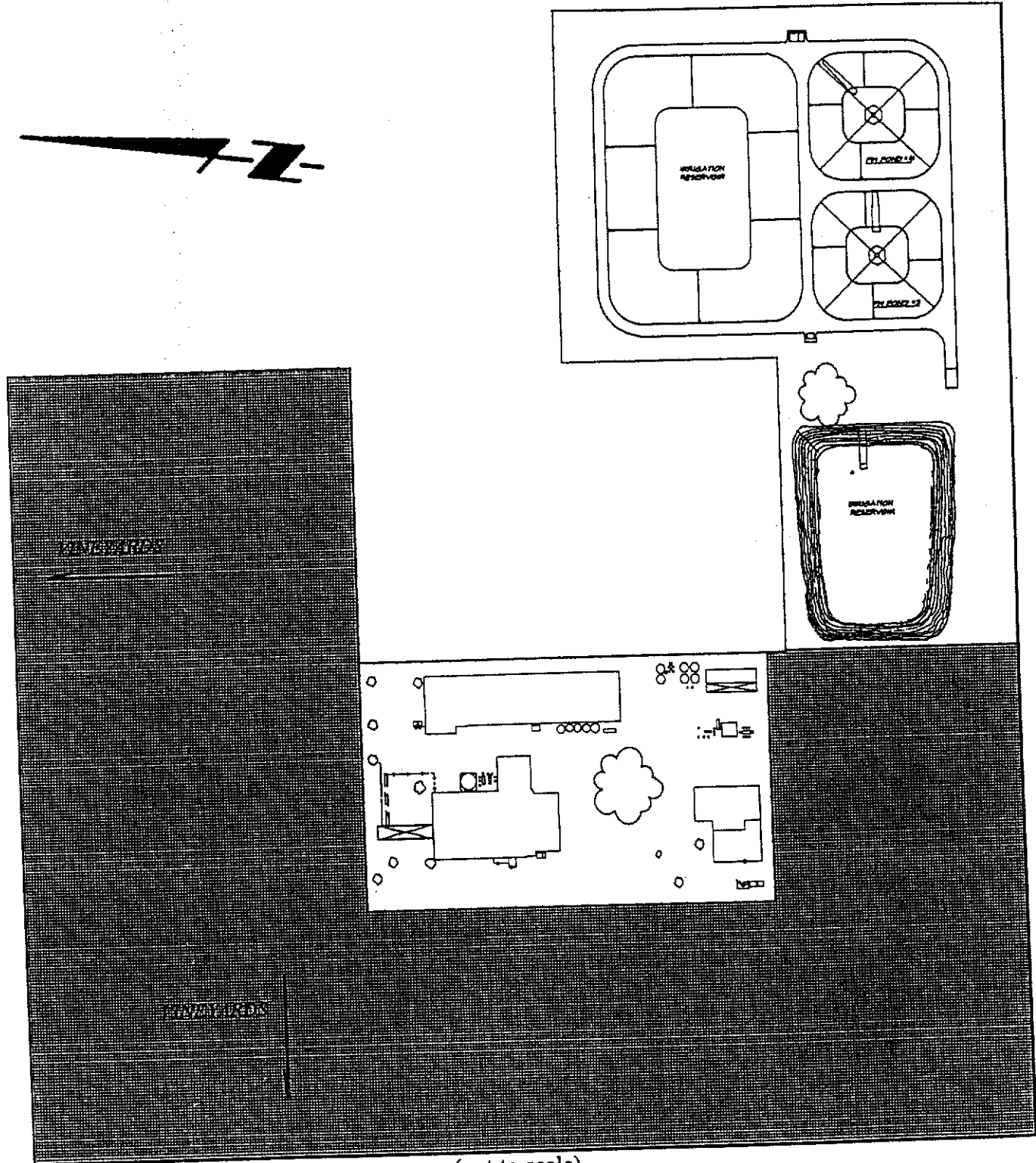

(not to scale)
Attachment "B" - Facility Map

**STATE OF CALIFORNIA
CALIFORNIA REGIONAL WATER QUALITY CONTROL BOARD
CENTRAL COAST REGION**

**MONITORING AND REPORTING PROGRAM NO. 98-04
WDID # 3 409708001**

**FOR
WILD HORSE WINERY
TEMPLETON
SAN LUIS OBISPO COUNTY**

WATER SUPPLY MONITORING

Representative samples of the water supply shall be collected and analyzed as follows:

Constituent	Units	Sample Type	Minimum Sampling and Analyzing Frequency
Total Dissolved Solids	mg/l	Grab	Annually (October)
Total Nitrogen (as N)	mg/l	Grab	Annually "

EFFLUENT MONITORING

Representative samples of the wine processing discharge from the aeration ponds shall be collected and analyzed as follows:

Constituent	Units	Sample Type	Minimum Sampling and Analyzing Frequency*
Daily Flow	gpd	Metered	Daily
Average Flow	gpd	calculated	Monthly/Annually
pH	pH units	Grab	Quarterly (Jan, Apr, July, Oct)
Sulfate	mg/l	Grab	Quarterly (Jan, Apr, July, Oct)
Total Dissolved Solids	mg/l	Grab	Quarterly (Jan, Apr, July, Oct)
Total Nitrogen (as N)	mg/l	Grab	Quarterly (Jan, Apr, July, Oct)

*During periods of discharge, samples should be collected of processing wastewater applied to vineyard.

POND MONITORING

Constituent	Units	Sample Type	Minimum Sampling and Analyzing Frequency
Dissolved Oxygen	mg/l	Grab	Monthly

TREATMENT AND DISPOSAL AREA MONITORING

Wastewater ponds shall be inspected weekly for freeboard and available storage. Freeboard and available storage shall be presented in tabular form in each semi-annual report. Wastewater facilities shall also be inspected weekly for evidence of any nuisance condition (odors, vector, etc.). Conditions of this nature shall be reported to the Executive Officer or his representative and to the County Department of Environmental Health within 24 hours of knowing of such conditions. The incident shall be promptly investigated and remedied. A record shall be kept of dates and nature of observations and remedies.

Use of the septic tank/leachfield will be allowed under emergency conditions. Prior to use, the Discharger must provide documentation of the systems capacity. Daily inspection of the leachfield must be made and use of the system stopped with the first indication of failure. A summary of the dates and times, along with the amount of water diverted to the leach field, must be tabulated and submitted with the Self-Monitoring Report.

REPORTING

Reports shall be prepared semi-annually with the reports due by the 30th of January and July. Reports shall contain all data collected or calculated, and all observations made during the previous two quarters. It shall also contain a narrative summary of any exceptions to Waste Discharge Requirements.

ORDERED BY _____



Executive Officer

April 2, 1998

Date