

**CCRWQCB MONITORING MAP**

**BSA Camp Lindblad**

Portions of

T9S, R2W, Sections 5 & 6, MDB&M

Santa Cruz County, CA

Castle Rock Ridge Quadrangle

Scale 1" = 550' CI = 40'

Attachment 3

|                             |          |                               |         |
|-----------------------------|----------|-------------------------------|---------|
| Property Boundary           |          | Watercourse Crossing          | X1 - X6 |
| Harvest Boundary            |          | WLPZ Road                     | W       |
| Seasonal Road (existing)    |          | ELZ Skid Trail                | E       |
| Permanent Road (existing)   |          | New Skid Trail                | A - G   |
| Road Mitigation Point       | R1 - R10 | Unstable Area                 |         |
| Landing                     |          | Cable Unit                    |         |
| Skid Trail                  |          | Tractor                       |         |
| Skid Trail on Steep Slope   | S        | Buildings                     |         |
| Skid Trail Mitigation Point | S1 - S12 | Class III Watercourse         |         |
| Class I Watercourse         |          | No Harvest Until Rezone to TP |         |
| Class II Watercourse        |          |                               |         |

Road re-construction (seasonal) NR1 (exceeds 15% grade for more than 200')

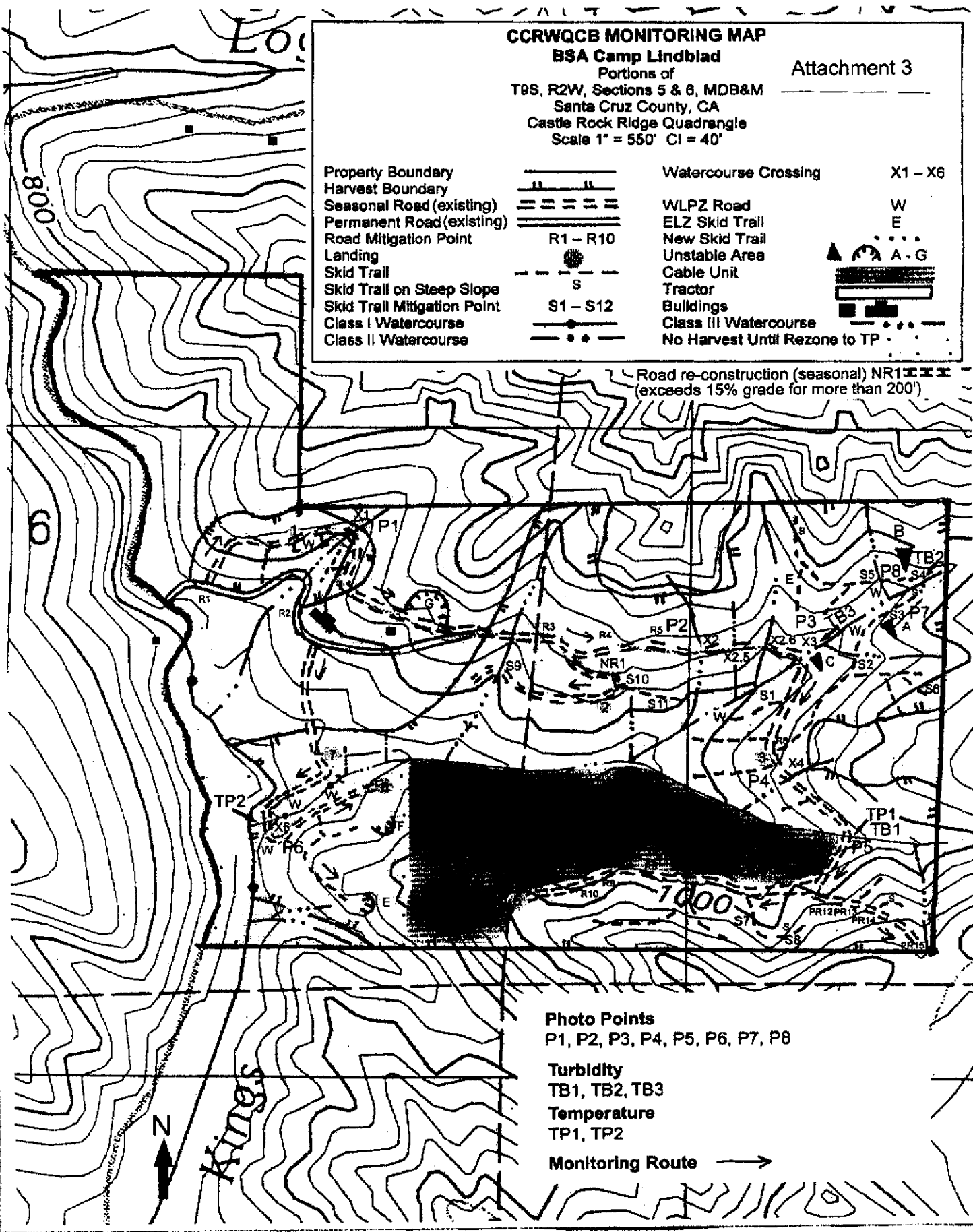

- Photo Points**  
P1, P2, P3, P4, P5, P6, P7, P8
- Turbidity**  
TB1, TB2, TB3
- Temperature**  
TP1, TP2
- Monitoring Route** →