



LEGEND

- MW-9  Monitoring Well with Dissolved-Phase MTBE Concentration ($\mu\text{g/l}$)
- SP-5  Sparge Well
- MW-3  Destroyed Well

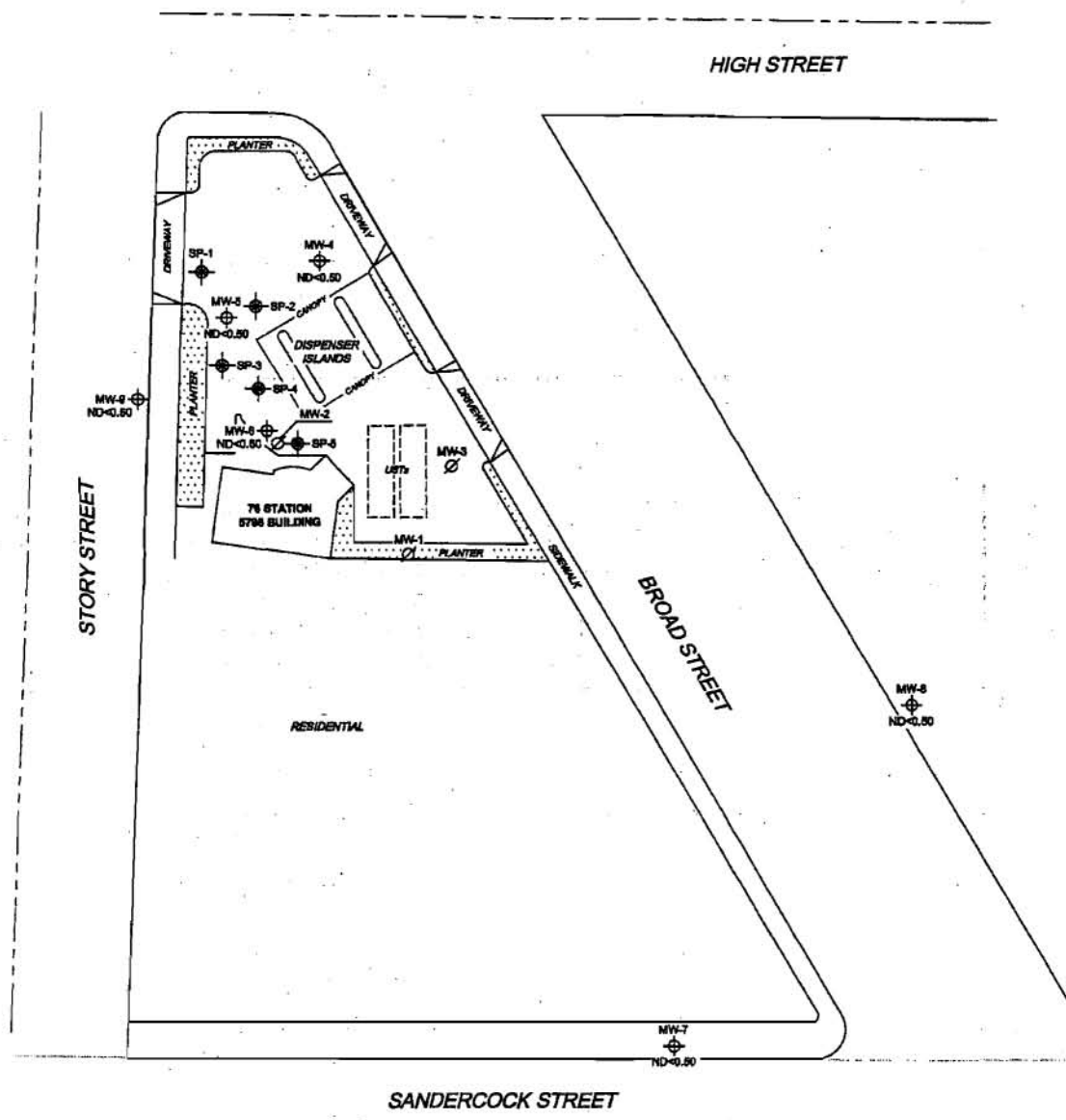

NOTES:

MTBE = methyl tertiary butyl ether. $\mu\text{g/l}$ = micrograms per liter. ND = not detected at limit indicated on official laboratory report. UST = underground storage tank. Results obtained using EPA Method 8260B.



PROJECT: 154770
FACILITY:
76 STATION 5798
2015 BROAD STREET
SAN LUIS OBISPO, CALIFORNIA

DISSOLVED-PHASE MTBE
CONCENTRATION MAP
October 6, 2008

FIGURE 5

Item No. 7
August 31, 2009 Meeting
Staff Closures
Attachment 1