

South Y PCE Contamination

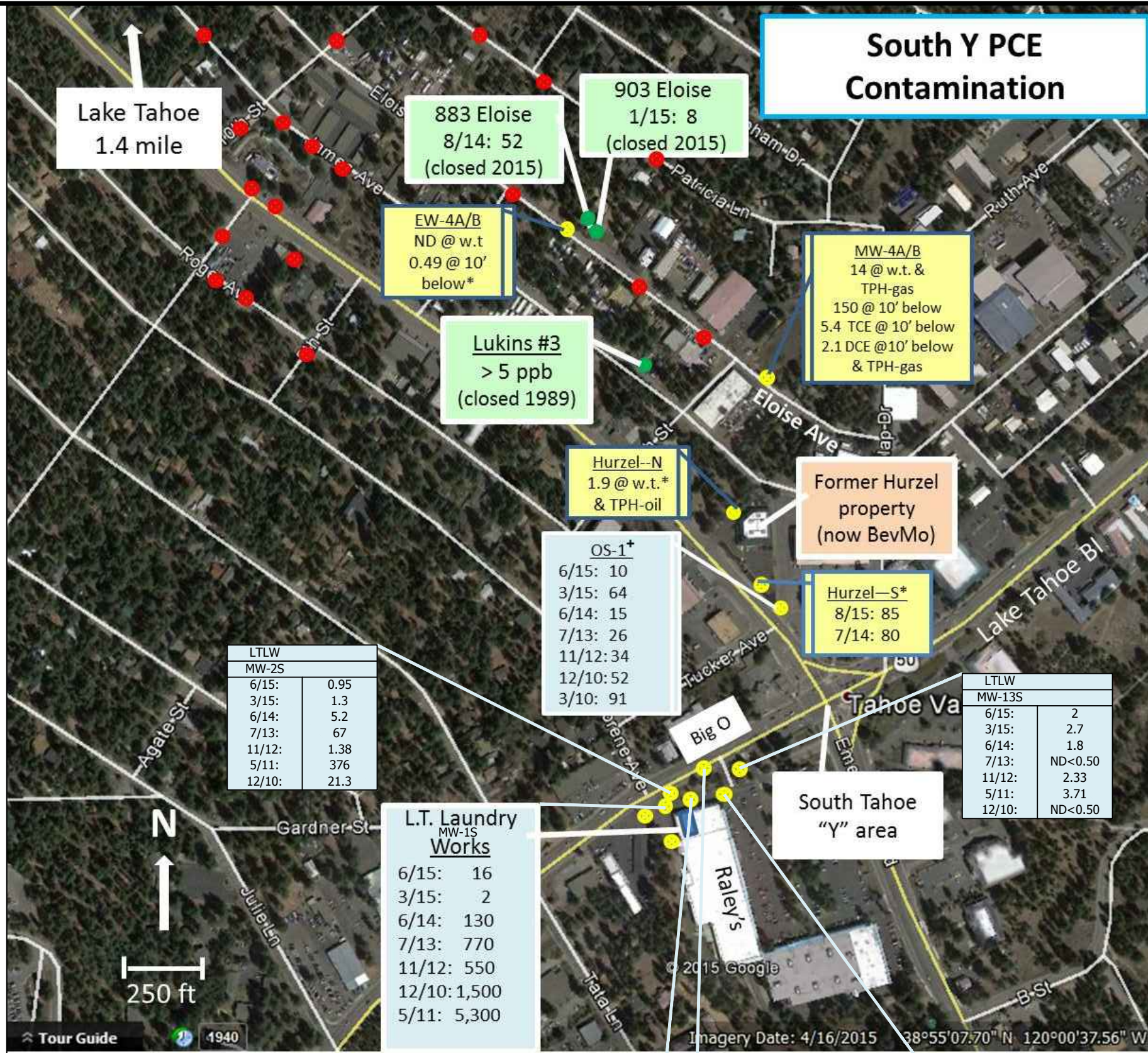

Legend

- 8/15: 10 Sample date: PCE in ppb
- 8/15: 10 Closed supply well
- 8/15: 10 Well sampled by Water Bd
- 8/15: 10 Lake Tahoe Laundry Works
- Former supply well
- Monitoring well
- PCE investigation boring (fall 2015)
- + = sampled by LTLW
- * = sampled by Water Bd

GROUNDWATER FLOW DIRECTION Second Quarter 2010 to Third Quarter 2015*

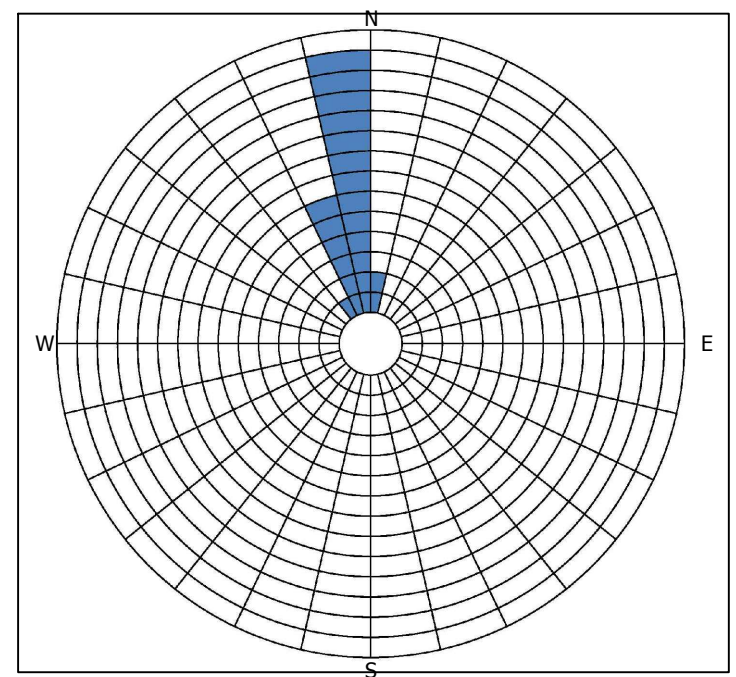

Each shaded area represents data from one groundwater monitoring event

Rose diagram showing groundwater gradient direction from Second Quarter 2010 measured at the Lake Tahoe Laundry Works site through Third Quarter 2015.

*with the exception of First Quarter 2011

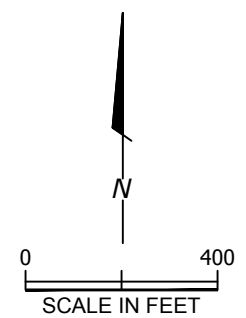

LTLW MW-2S	
6/15:	0.95
3/15:	1.3
6/14:	5.2
7/13:	67
11/12:	1.38
5/11:	376
12/10:	21.3

L.T. Laundry Works MW-1S	
6/15:	16
3/15:	2
6/14:	130
7/13:	770
11/12:	550
12/10:	1,500
5/11:	5,300

OS-1+	
6/15:	10
3/15:	64
6/14:	15
7/13:	26
11/12:	34
12/10:	52
3/10:	91

LTLW MW-13S	
6/15:	2
3/15:	2.7
6/14:	1.8
7/13:	ND<0.50
11/12:	2.33
5/11:	3.71
12/10:	ND<0.50

LTLW MW-9S	
6/15:	ND<0.50
3/15:	ND<0.50
6/14:	ND<0.50
7/13:	5.3
11/12:	ND<0.50
5/11:	30.6
12/10:	89.8

LTLW MW-5S	
6/15:	3.4
3/15:	1.4
6/14:	13
7/13:	59
11/12:	6.99
5/11:	625
12/10:	Not Sampled









LTLW MW-11S	
6/15:	0.89
3/15:	Not Sampled
6/14:	3.8
7/13:	4.5
11/12:	6.19
5/11:	1.33
12/10:	2.63

Reference: Basemap from RWQCB electronic correspondence dated December 2, 2015.



Lake Tahoe PCE Summary
Comments on Proposed Cleanup and Abatement Order No. R6T-2015-PROP
Lake Tahoe Laundry Works
South Lake Tahoe, California

Explanation

-  Approximate Property Boundary
- B-1  Shallow Zone (screen interval between 15 to 20 feet below ground surface (ft bgs)) Groundwater Sample Big O Tires (October 2001)
- B-14  Shallow Zone (screen interval between 5.6 to 8 ft bgs, except B-13b at 11.2 to 14 ft bgs) Groundwater Sample Big O Tires (October 2006)
- GP-1  Shallow Zone Groundwater Sample Lakeside Auto (January 2002)
- GP-16  Shallow Zone Groundwater Sample Lakeside Auto (November 2003)
- GW-10  Shallow Zone (screen intervals between 14 to 18 and 22 to 26 ft bgs) Groundwater Sample Lake Tahoe Laundry Works (October 2003, September 2004, and April 2005)
- LW-MW-8S  Shallow Zone (screen interval between 15 to 25 and 23.5 to 33.5 ft bgs) Groundwater Sample Lake Tahoe Laundry Works (September 2008)
- 720 PCE Concentration in micrograms per liter
- <2 Not detected at or above the indicated laboratory reporting limit
- * Data not used for contouring purposes
- NS Not sampled due to refusal
-  PCE Isoconcentration Contour (dashed where inferred, queried where unknown)
- 100
- All Locations Are Approximate

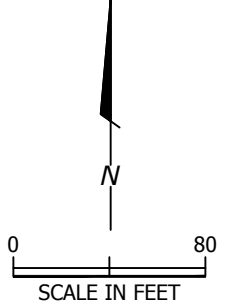

Approximate Groundwater Flow Direction

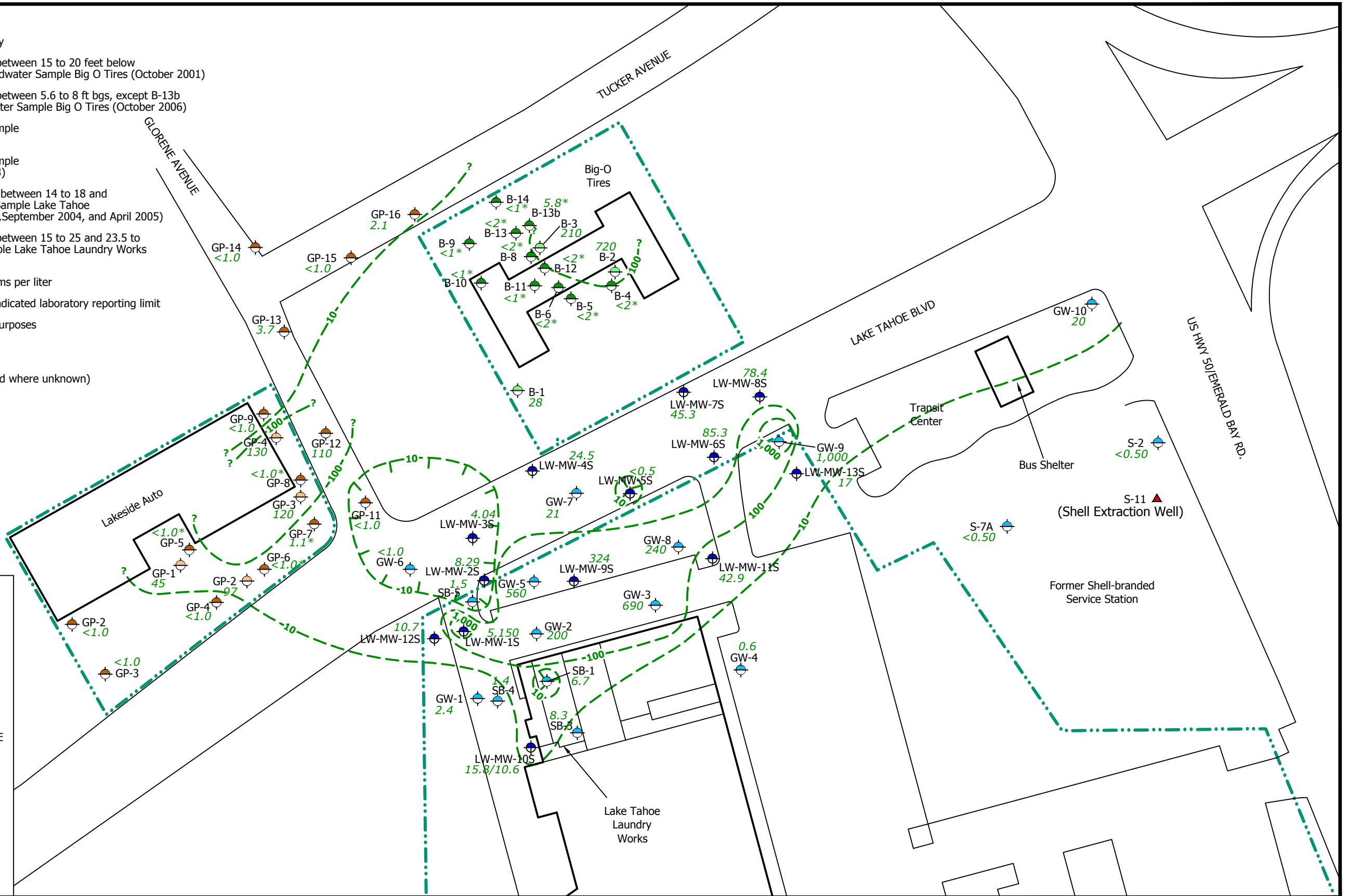
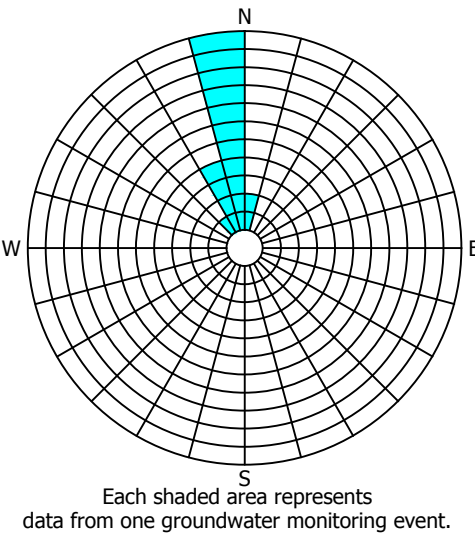







PCE Isoconcentration Contours of Analytical Results from Shallow Water-Bearing Zone (2001-2008)

Comments on Proposed Cleanup and Abatement Order No. R6T-2015-PROP
 Lake Tahoe Laundry Works
 South Lake Tahoe, California

PLATE
2

Explanation

-  Approximate Property Boundary
-  B-1 Middle Zone (screened from 47.5 to 50 ft bgs) Groundwater Sample Big O Tires (October 2001)
-  GP-1 Middle Zone Groundwater Sample Lakeside Auto (January 2002)
-  GP-16 Middle Zone Groundwater Sample Lakeside Auto (November 2003)
-  GW-2 Middle Zone Groundwater Sample Lake Tahoe Laundry Works (October 2003, September 2004, and April 2005)
-  LW-MW-8D Middle Zone Groundwater Sample Lake Tahoe Laundry Works (September 2008)
- 1,200 PCE Concentration in micrograms per liter
- * Data not used for contouring purposes
- NS Not sampled due to refusal
-  PCE Isoconcentration Contour (dashed where inferred, queried where unknown)
- 100 All Locations Are Approximate

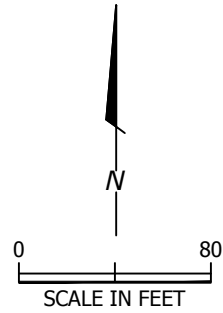

Approximate Groundwater Flow Direction
(Inferred from Shallow Water-Bearing Zone)

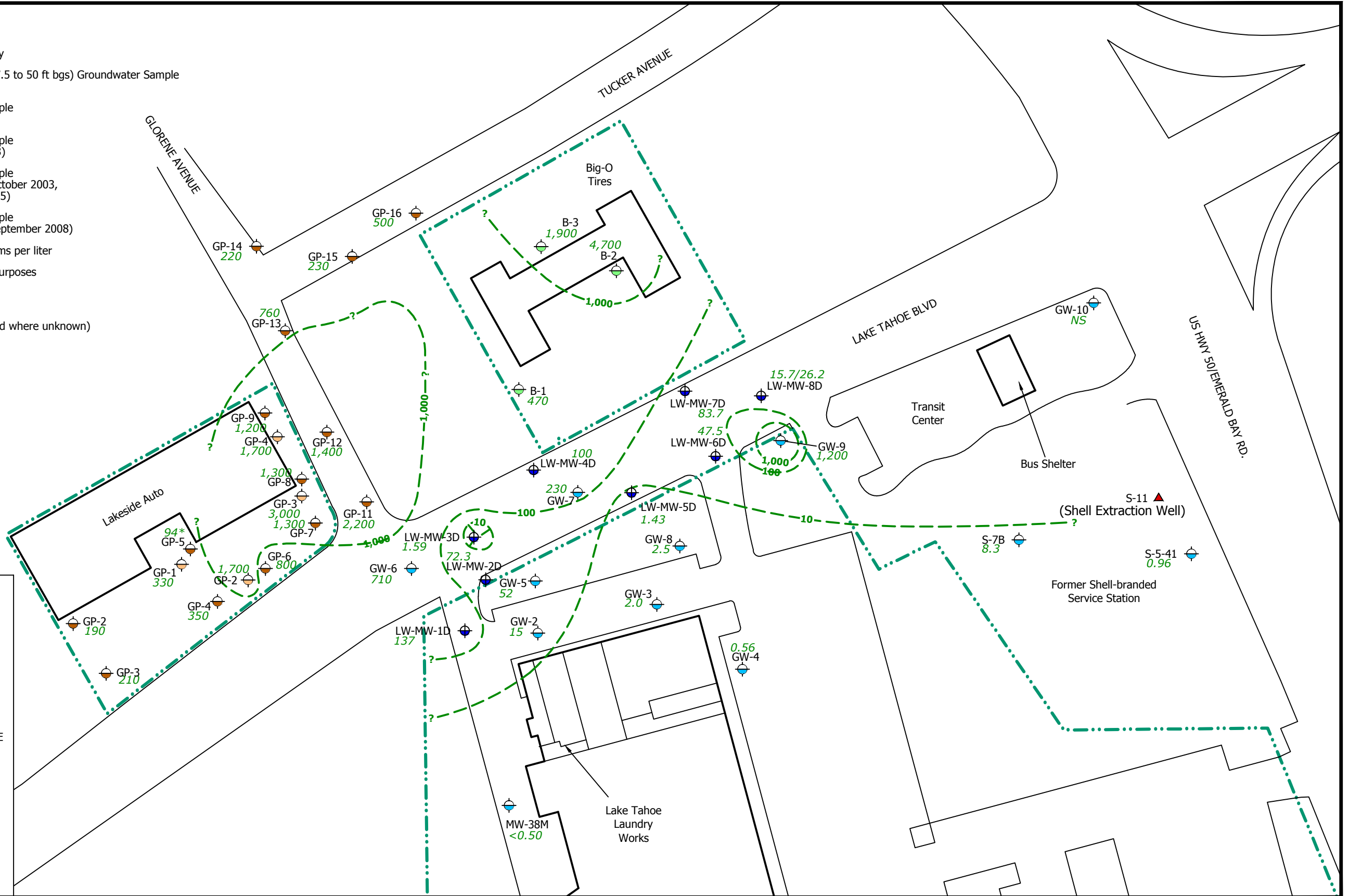
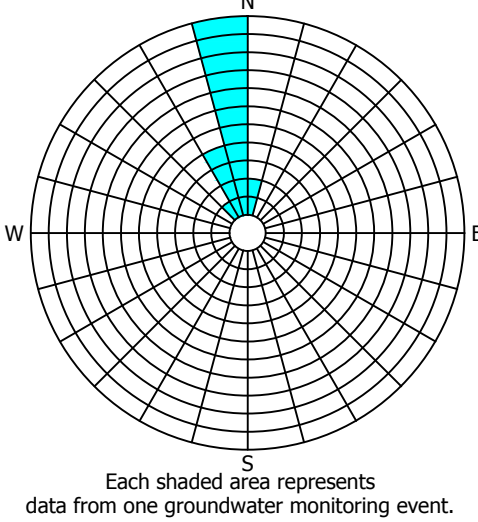

PCE Isoconcentration Contours of Analytical Results from Middle Water-Bearing Zone (2001-2008)
 Comments on Proposed Cleanup and Abatement Order
 No. R6T-2015-PROP
 Lake Tahoe Laundry Works
 South Lake Tahoe, California

