

EDMUND G. BROWN JR.  
GOVERNOR

MATTHEW RODRIGUEZ  
SECRETARY FOR  
ENVIRONMENTAL PROTECTION

**Los Angeles Regional Water Quality Control Board**

March 22, 2017

Albert Anidi  
County of Los Angeles Department of Public Works  
900 S. Fremont Ave  
Alhambra, CA 91803

VIA CERTIFIED MAIL  
RETURN RECEIPT REQUESTED  
No. 7016 2070 0000 9794 7496

Dear Mr. Anidi:

RE: CLEAN WATER ACT SECTION 401 WATER QUALITY CERTIFICATION AND ORDER  
FOR THE OCTOBER 2015 - STORM LAKE HUGHES ROAD (4WQC40116144)

Enclosed please find a CLEAN WATER ACT SECTION 401 WATER QUALITY  
CERTIFICATION AND ORDER, authorized by Los Angeles Regional Water Quality Control  
Board Executive Officer, Samuel Unger. This Order is issued to Albert Anidi, County of Los  
Angeles Department of Public Works for October 2015 Storm - Lake Hughes Road (Project).  
Attachments A through C of the Enclosure are also part of the Order.

This Order is issued in response to an application submitted by Albert Anidi of County of Los  
Angeles Department of Public Works for proposed Project discharge to waters of the state, to  
ensure that the water quality standards for all waters of the state impacted by the Project are  
met. You may proceed with your Project according to the terms and conditions of the enclosed  
Order.

If you require further assistance, please contact Valerie CarrilloZara by phone at (213) 576-6759  
or by email at [Valerie.CarrilloZara@waterboards.ca.gov](mailto:Valerie.CarrilloZara@waterboards.ca.gov). You may also contact me by phone at  
(213) 576-6785 or by email at [LB.Nye@waterboards.ca.gov](mailto:LB.Nye@waterboards.ca.gov).

Sincerely,

LB Nye, Senior Environmental Scientist  
Section 401 Certification and Wetlands Unit  
Los Angeles Water Quality Control Board

Enclosures (1): Order for October 2015 Storm – Lake Hughes Road, File No: 16-144

cc: [Via email only] (w/ enclosure):

Albert Anidi  
County of Los Angeles, Department of Public Works

Bill Orme  
CWA Section 401 WQC Program  
Division of Water Quality  
State Water Resources Control Board

Melissa Scianni  
U. S. Environmental Protection Agency, Region 9

Brock Warmuth  
California Department of Fish and Wildlife

Daniel P. Swenson  
Army Corps of Engineers

Johnathan Snyder  
U.S. Fish and Wildlife Service

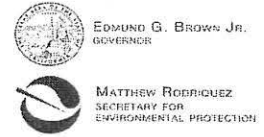

Los Angeles Regional Water Quality Control Board

CLEAN WATER ACT SECTION 401 WATER QUALITY CERTIFICATION AND ORDER

Effective Date: March 22, 2017

Program Type: Fill/Excavation

Reg. Meas. ID:	410239
Place ID:	829844
WDID:	4WQC40116144
NWP	3
USACOE#:	SPL-2016-00851-BLR
R4 File No	16-144

Project Type: Channel Construction and Maintenance

Project: October 2015 Storm – Lake Hughes Road (Project)

Applicant: County of Los Angeles Department of Public Works

Applicant Contact: Albert Anidi  
County of Los Angeles Department of Public Works  
900 S Freeman Ave.  
Alhambra, CA 91803  
Phone: [626] 458-5199  
Email: aanidi@dpw.lacounty.gov

Water Board Staff: Valerie Carrillo Zara  
Engineering Geologist  
320 W.th Street, Suite 200  
Los Angeles, CA 90013  
Phone: [213] 576-5759  
Email: Valerie.carrillozara@waterboards.ca.gov

Water Board Contact Person:

If you have any questions, please call Los Angeles Regional Water Quality Control Board (Los Angeles Water Board) Staff listed above or (213) 576-6600 and ask to speak with the Water Quality Certification and Wetlands Unit Program Manager.

**Table of Contents**

I. Order.....3

II. Public Notice .....3

III. Project Purpose.....3

IV. Project Description .....3

V. Project Location .....4

VI. Project Impact and Receiving Waters Information .....4

VII. Description of Direct Impacts to Waters of the State.....4

VIII. Avoidance and Minimization.....5

IX. Compensatory Mitigation.....5

X. California Environmental Quality Act (CEQA).....5

XI. Petitions for Reconsideration.....5

XII. Fees Received .....6

XIII. Conditions .....6

- Attachment A** Signatory Requirements
- Attachment B** Map
- Attachment C** Report and Notification Requirements

**I. Order**

This Clean Water Act (CWA) section 401 Water Quality Certification action and Order (Order) is issued at the request of County of Los Angeles Department of Public Works (herein after Permittee) for the Project. This Order is for the purpose described in application submitted by the Permittee. The application was received on October 28, 2016. The application was deemed complete on December 16, 2016.

**II. Public Notice**

The Los Angeles Water Board provided public notice of the application pursuant to California Code of Regulations, title 23, section 3858 from November 3, 2016 until issuance of this order. The Los Angeles Water Board did not receive any comments during the comment period.

**III. Project Purpose**

The purpose of the project is to provide necessary safety measures to maintain flows and prevent road embankment erosion from future storm events; thereby providing human and vehicular safety along Lake Hughes Road.

**IV. Project Description**

The project consists of repairs to drainage crossings of Lake Hughes Road which were damaged by an October 2015 storm, and includes headwall removal/reconstruction, corrugated metal pipe (CMP) extension, and rip-rap installation from Mile Markers (MM) 0.65 to 2.32; and bank stabilization at MMs 6.80 and 9.24.

At MM 0.65, a 17 ft headwall will be constructed and 10 tons of 2-ton rip-rap will be installed.

At MM 1.36, a 21 ft headwall will be constructed.

At MM1.48, a 21 ft headwall will be constructed.

At MM 1.85, a 21 ft headwall will be constructed.

At MM 2.24, a 21 ft headwall will be constructed.

At MM 2.32, 10 tons rip-rap will be installed, a 36" by 20 ft CMP will be extended by 15 ft. and the road shoulder will be reconstructed with 10 tons of 2-ton rip-rap.

At MM 2.47, 150 tons rip-rap will be installed; in addition, 60 tons of Asphalt Concrete (AC) will be used to repair the road.

At MM 6.8, a 200 ft boardwall will be reinforced with rip-rap to protect the road embankment. This requires removing approximately 100 cy of debris; excavating approximately 400 cy materials; replacing approximately 1800 tons of 2-ton rip rap; as well as, filling and compacting approximately 800 cy of material. The proposed project also requires constructing a 20-foot-wide access road down to the edge of the streambed.

At MM 9.24, a 300 ft boardwall will be reinforced with rip-rap to protect the road embankment. This requires removing approximately 100 cy of debris; excavating approximately 350 cy

materials; replacing approximately 2800 tons of 2-ton rip rap; as well as, filling and compacting approximately 200 cy of material.

**V. Project Location**

The proposed project is located in the unincorporated community of Santa Clarita, in Los Angeles County. The areas where the project repairs will be conducted are specifically located along Lake Hughes Road between Mile Marker 0.65 and 2.47 at: 0.65, 1.36, 1.48, 1.85, 2.13, 2.24, 2.32, and 2.47. Bank stabilization/protection repairs will be located at Mile Markers 6.80 and 9.24. A map showing the Project locations is found in Attachment B of this Order.

<u>MM</u>	<u>Latitude</u>	<u>Longitude</u>
0.65	34.670944	-118.455111
1.36	34.661972	-118.458083
1.48	34.660444	-118.459917
1.85	34.656361	-118.463139
2.24	34.654889	-118.467917
2.32	34.654694	-118.469028
6.80	34.634383	-118.530417
9.24	34.618100	-118.561361

**VI. Project Impact and Receiving Waters Information**

The Project is located within the jurisdiction of Los Angeles Regional Water Quality Control Board. Receiving waters and groundwater potentially impacted by this Project are protected in accordance with the applicable water quality control plan (Basin Plan) for the region and other plans and policies which may be accessed online at:

[http://www.waterboards.ca.gov/plans\\_policies/](http://www.waterboards.ca.gov/plans_policies/). The Basin Plan includes water quality standards, which consist of existing and potential beneficial uses of waters of the state, water quality objectives to protect those uses, and the state and federal antidegradation policies.

It is the policy of the State of California that every human being has the right to safe, clean, affordable, and accessible water adequate for human consumption, cooking, and sanitary purposes. This Order promotes that policy by requiring discharges to meet maximum contaminant levels designed to protect human health and ensure that water is safe for domestic use.

Receiving Water: Tributaries to Lake Hughes  
(Hydrologic Unit Code: 180701020301)

Designated Beneficial Uses: MUN, IND, PROC, AGR, GWR, FRSH, REC-1, REC-2, WARM, WILD

**VII. Description of Direct Impacts to Waters of the State**

The project consists of repairs to Lake Hughes Road at eight (8) locations. Temporary project impacts are from removal of stream sediments and some sparse vegetation; permanent impacts are from the extension of a CMP replacing the streambed.

Total Project fill/excavation quantities for all impacts are summarized in Table 1. Permanent impacts are categorized as those resulting in a physical loss in area and also those degrading ecological condition only.

Table 1: Total Project Fill/Excavation Quantity									
Aquatic Resource Type	Temporary Impact <sup>1</sup>			Permanent Impact					
				Physical Loss of Area			Degradation of Ecological Condition Only		
	Acres	CY <sup>2</sup>	LF	Acres	CY	LF	Acres	CY	LF
Stream Channel	0.35			0.17					

**VIII. Avoidance and Minimization**

The Applicant has proposed to implement several Best Management Practices, including, but not limited to, the following:

- No construction-related materials shall be discharged from the project site to receiving waters.
- Non-storm water runoff from equipment, vehicle washing, or any other activity shall be contained within the project site using appropriate BMPs.
- Construction activities will only occur during dry weather conditions.

**IX. Compensatory Mitigation**

The Permittee is required to provide a total of 0.34 acres of compensatory mitigation at a 2:1 ratio for 0.17 acres of permanent direct impacts, described in section VII for permanent impacts. The Permittee has not submitted a draft compensatory mitigation plan for permanent impacts as part of the application. The Permittee is also required to provide a total of 0.35 acres of compensatory mitigating at a 1:1 ratio for temporary direct impacts. Mitigation for the temporary direct impacts will include restoration and enhancement within the vicinity of the proposed project areas.

**X. California Environmental Quality Act (CEQA)**

The Los Angeles Water Board has determined that the Project is exempt from review under CEQA pursuant to California Water Code of Regulations, title 14, section 15061. Specifically, the issuance of this Order and the activities described herein meet the exemption criteria under California Code of Regulations title 14, section(s) 15302 Replacement or reconstruction. Additionally, the Los Angeles Water Board concludes that no exceptions to the CEQA exemption apply to the activities approved by this Order.

**XI. Petitions for Reconsideration**

Any person aggrieved by this action may petition the State Water Board to reconsider this Order in accordance with California Code of Regulations, title 23, section 3867. A petition for

<sup>1</sup> Includes only temporary direct impacts to waters of the state and does not include upland areas of temporary disturbance which could result in a discharge to waters of the state.

<sup>2</sup> Cubic Yards (CY); Linear Feet (LF)



reconsideration must be submitted in writing and received within 30 calendar days of the issuance of this Order.

## **XII. Fees Received**

A fee of \$7,155.00 was received on October 28, 2016. The fee amount was determined as required by California Code of Regulations, title 23, sections 3833(b)(3) and 2200(a)(3), and was calculated as category A - Fill & Excavation Discharges (fee code 84) with the dredge and fill fee calculator.

## **XIII. Conditions**

The Los Angeles Water Board has independently reviewed the record of the Project to analyze impacts to water quality and designated beneficial uses within the watershed of the Project. In accordance with this Order, the Permittee may proceed with the Project under the following terms and conditions:

### **A. Authorization**

Impacts to waters of the state shall not exceed quantities shown in Table 1.

### **B. Reporting and Notification Requirements**

The following section details the reporting and notification types and timing of submittals. Requirements for the content of these reporting and notification types are detailed in Attachment C, including specifications for photo and map documentation during the Project. Written reports and notifications must be submitted using the Reporting and Notification Cover Sheet located in Attachment C, which must be signed by the Permittee or an authorized representative.

#### **1. Project Reporting**

- a. Annual Reporting:** The Permittee shall submit an Annual Report each year on the anniversary of Project effective date of the year following project completion. Annual reporting shall continue until a Notice of Project Complete Letter is issued to the Permittee.

#### **2. Project Status Notifications**

- a. Request for Notice of Completion of Discharges Letter:** The Permittee shall submit a Request for Notice of Completion of Discharges Letter following completion of active Project construction activities, including any required restoration and permittee-responsible mitigation. This request shall be submitted to the Los Angeles Water Board staff within thirty (30) days following completion of all Project construction activities. Upon acceptance of the request, Los Angeles Water Board staff shall issue a Notice of Completion of Discharges Letter to the Permittee which will end the active discharge period and associated annual fees.
- b. Request for Notice of Project Complete Letter:** The Permittee shall submit a Request for Notice of Project Complete Letter when construction and/or any post-



construction monitoring is complete,<sup>3</sup> and no further Project activities will occur. This request shall be submitted to Los Angeles Water Board staff within thirty (30) days following completion of all Project activities. Upon approval of the request, the Los Angeles Water Board staff shall issue a Notice of Project Complete Letter to the Permittee which will end the post discharge monitoring period and associated annual fees.

**3. Conditional Notifications and Reports:** The following notifications and reports are required as appropriate.

**a. Accidental Discharges of Hazardous Materials<sup>4</sup>**

Following an accidental discharge of a reportable quantity of a hazardous material, sewage, or an unknown material, the following applies (Wat. Code, § 13271):

- i. As soon as (A) Permittee has knowledge of the discharge or noncompliance, (B) notification is possible, and (C) notification can be provided without substantially impeding cleanup or other emergency measures then:
  - first call – 911 (to notify local response agency)
  - then call – Office of Emergency Services (OES) State Warning Center at: (800) 852-7550 or (916) 845-8911
  - Lastly follow the required OES procedures as set forth in:  
[http://www.caloes.ca.gov/FireRescueSite/Documents/CalOES-Spill Booklet Feb2014 FINAL BW Acc.pdf](http://www.caloes.ca.gov/FireRescueSite/Documents/CalOES-Spill%20Booklet%20Feb2014%20FINAL%20BW%20Acc.pdf)
- ii. Following notification to OES, the Permittee shall notify Los Angeles Water Board, as soon as practicable (ideally within 24 hours). Notification may be via telephone, e-mail, delivered written notice, or other verifiable means.
- iii. Within five (5) working days of notification to the Los Angeles Water Board, the Permittee must submit an Accidental Discharge of Hazardous Material Report.

**b. Violation of Compliance with Water Quality Standards:** The Permittee shall notify the Los Angeles Water Board of any event causing a violation of compliance with water quality standards. Notification may be via telephone, e-mail, delivered written notice, or other verifiable means.

- i. Examples of noncompliance events include: lack of storm water treatment following a rain event, discharges causing a visible plume in a water of the state, and water contact with uncured concrete.

---

<sup>3</sup> Completion of post-construction monitoring shall be determined by Los Angeles Water Board staff and shall be contingent on successful attainment of restoration and mitigation performance criteria.

<sup>4</sup> "Hazardous material" means any material that, because of its quantity, concentration, or physical or chemical characteristics, poses a significant present or potential hazard to human health and safety or to the environment if released into the workplace or the environment. "Hazardous materials" include, but are not limited to, hazardous substances, hazardous waste, and any material that a handler or the administering agency has a reasonable basis for believing that it would be injurious to the health and safety of persons or harmful to the environment if released into the workplace or the environment. (Health & Saf. Code, § 25501.)

- ii. This notification must be followed within three (3) working days by submission of a Violation of Compliance with Water Quality Standards Report.

**c. In-Water Work**

- i. If stream diversion will be necessary, the Permittee shall submit to the Los Angeles Water Board staff a Stream Diversion Plan, with a diagram and a narrative description of the method to divert the stream and associated BMPs for acceptance at least 30 days in advance of any stream diversion.
- ii. During stream diversion, water quality monitoring shall be conducted. Requirements for water quality monitoring are in Section XIII, C, 3.
- iii. The Permittee shall notify the Los Angeles Water Board at least forty-eight (48) hours prior to initiating work in water or stream diversions. Notification may be via telephone, e-mail, delivered written notice, or other verifiable means.
- iv. Within three (3) working days following completion of work in water or stream diversions, an In-Water Work/Diversions Water Quality Monitoring Report must be submitted to Los Angeles Water Board staff.

**d. Modifications to Project**

Project modifications may require an amendment of this Order. The Permittee shall give advance notice to Los Angeles Water Board staff if Project implementation as described in the application materials is altered in any way or by the imposition of subsequent permit conditions by any local, state or federal regulatory authority by submitting a Modifications to Project Report. The Permittee shall inform Los Angeles Water Board staff of any Project modifications that will interfere with the Permittee's compliance with this Order.

**e. Transfer of Property Ownership:** This Order is not transferable in its entirety or in part to any person or organization except after notice to the Los Angeles Water Board in accordance with the following terms:

- i. The Permittee must notify the Los Angeles Water Board of any change in ownership or interest in ownership of the Project area by submitting a Transfer of Property Ownership Report. The Permittee and purchaser must sign and date the notification and provide such notification to the Los Angeles Water Board at least 10 days prior to the transfer of ownership. The purchaser must also submit a written request to the Los Angeles Water Board to be named as the permittee in a revised order.
- ii. Until such time as this Order has been modified to name the purchaser as the permittee, the Permittee shall continue to be responsible for all requirements set forth in this Order.

### C. Water Quality Monitoring

1. **General:** If surface water is present, continuous visual surface water monitoring shall be conducted to detect accidental discharge of construction related pollutants (e.g. oil and grease, turbidity plume, or uncured concrete).
2. **Accidental Discharges/Noncompliance:** Upon occurrence of an accidental discharge of hazardous materials or a violation of compliance with a water quality standard, Los Angeles Water Board staff may require water quality monitoring based on the discharge constituents and/or related water quality objectives and beneficial uses.
3. **In-Water Work or Diversions:**

For projects involving planned work in water or stream diversions, a water quality monitoring plan shall be submitted to Los Angeles Water Board staff for acceptance at least 30 days in advance of any discharge to the affected water body. Water quality monitoring shall be conducted in accordance with the approved plan.

During planned work in water or stream diversions any discharge(s) to waters of the state shall conform to the following water quality standards:

- a. **Oil and Grease.** Waters shall not contain oils, greases, waxes or other materials in concentrations that result in a visible film or coating on the surface of the water or on objects in the water, that cause nuisance, or that otherwise adversely affect beneficial uses.
- b. **Dissolved Oxygen.** At a minimum, the mean annual dissolved oxygen concentration of all waters shall be greater than 7 mg/L, and no single determination shall be less than 5.0 mg/L, except when natural conditions cause lesser concentrations.

The dissolved oxygen content of all surface waters designated as WARM shall not be depressed below 5 mg/L as a result of waste discharges.

- c. **pH.** The pH of inland surface waters shall not be depressed below 6.5 or raised above 8.5 as a result of waste discharges. Ambient pH levels shall not be changed more than 0.5 units from natural conditions as a result of waste discharge.
- d. **Turbidity.** Downstream TSS shall be maintained at ambient levels. Where natural turbidity is between 0 and 50 Nephelometric Turbidity Units (NTU), increases shall not exceed 20%. Where natural turbidity is greater than 50 NTU, increases shall not exceed 10%.

Sampling shall be conducted in accordance with Table 2 sampling parameters.<sup>5</sup>

---

<sup>5</sup> Pollutants shall be analyzed using the analytical methods described in 40 Code of Federal Regulations Part 136; where no methods are specified for a given pollutant, the method shall be approved by Los Angeles Water Board staff. Grab samples shall be taken between the surface and mid-depth and not be collected at the same time each day to get a complete representation of variations in the receiving water. A hand-held field meter may be used, provided the meter utilizes a U.S. EPA-approved algorithm/method  
*(footnote continued on next page)*

Parameter	Unit of Measurement	Type of Sample	Minimum Frequency
Oil and Grease	N/A	Visual	Continuous
Dissolved Oxygen	mg/L & % saturation	Grab	Daily
pH	Standard Units	Grab	Daily
Turbidity	NTU	Grab	Daily
Temperature	°F (or as °C)	Grab	Daily

4. **Post-Construction:** Visually inspect the Project site during the rainy season for one (1) year to ensure excessive erosion, stream instability, or other water quality pollution is not occurring in or downstream of the Project site. If water quality pollution is occurring, contact the Los Angeles Water Board staff member overseeing the Project within three (3) working days. The Los Angeles Water Board may require the submission of a Violation of Compliance with Water Quality Standards Report. Additional permits may be required to carry out any necessary site remediation.

**D. Standard**

1. This Order is subject to modification or revocation upon administrative or judicial review, including review and amendment pursuant to Water Code section 13330, and California Code of Regulations, title 23, chapter 28, Article 6 commencing with sections 3867-3869, inclusive. Additionally, the Los Angeles Water Board reserves the right to suspend, cancel, or modify and reissue this Order, after providing notice to the Permittee, if the Los Angeles Water Board determines that: the Project fails to comply with any of the conditions of this Order; or, when necessary to implement any new or revised water quality standards and implementation plans adopted or approved pursuant to the Porter-Cologne Water Quality Control Act (Wat. Code, § 13000 et seq.) or federal Clean Water Act section 303 (33 U.S.C. § 1313). For purposes of Clean Water Act section 401(d), the condition constitutes a limitation necessary to assure compliance with water quality standards and appropriate requirements of state law.
2. This Order is not intended and shall not be construed to apply to any activity involving a hydroelectric facility requiring a Federal Energy Regulatory Commission (FERC) license or an amendment to a FERC license, unless the pertinent certification application was filed pursuant to subsection 3855(b) of chapter 28, title 23 of the California Code of Regulations, and that application specifically identified that a FERC license or amendment to a FERC license for a hydroelectric facility was being sought.
3. This Order is conditioned upon total payment of any fee required under title 23 of the California Code of Regulations and owed by the Permittee.

---

*(footnote continued from previous page)*

and is calibrated and maintained in accordance with the manufacturer's instructions. A calibration and maintenance log for each meter used for monitoring shall be maintained onsite.

4. In the event of any violation or threatened violation of the conditions of this Order, the violation or threatened violation shall be subject to any remedies, penalties, process, or sanctions as provided for under state and federal law. For purposes of Clean Water Act, section 401(d), the applicability of any state law authorizing remedies, penalties, processes, or sanctions for the violation or threatened violation constitutes a limitation necessary to assure compliance with the water quality standards and other pertinent requirements incorporated into this Order.

#### **E. General Compliance**

1. Failure to comply with any condition of this Order shall constitute a violation of the Porter-Cologne Water Quality Control Act and the Clean Water Act. The Permittee and/or discharger may then be subject to administrative and/or civil liability pursuant to Water Code section 13385.
2. Permitted actions must not cause a violation of any applicable water quality standards, including impairment of designated beneficial uses for receiving waters as adopted in the Basin Plans by any applicable Los Angeles Water Board or any applicable State Water Board (collectively Water Boards) water quality control plan or policy. The source of any such discharge must be eliminated as soon as practicable.
3. In response to a suspected violation of any condition of this Order, the Los Angeles Water Board may require the holder of this Order to furnish, under penalty of perjury, any technical or monitoring reports the Water Boards deem appropriate, provide that the burden, including costs, of the reports shall bear a reasonable relationship to the need for the reports and the benefits to be obtained from the reports. The additional monitoring requirements ensure that permitted discharges and activities comport with any applicable effluent limitations, water quality standards, and/or other appropriate requirement of state law.
4. The Permittee must, at all times, fully comply with engineering plans, specifications, and technical reports submitted to support this Order; and all subsequent submittals required as part of this Order. The conditions within this Order and Attachments supersede conflicting provisions within Permittee submittals.
5. This Order and all of its conditions contained herein continue to have full force and effect regardless of the expiration or revocation of any federal license or permit issued for the Project. For purposes of Clean Water Act, section 401(d), this condition constitutes a limitation necessary to assure compliance with the water quality standards and other pertinent requirements of state law.

#### **F. Administrative**

1. Signatory requirements for all document submittals required by this Order are presented in Attachment A of this Order.
2. This Order does not authorize any act which results in the taking of a threatened, endangered or candidate species or any act, which is now prohibited, or becomes prohibited in the future, under either the California Endangered Species Act (Fish & G. Code, §§ 2050-2097) or the federal Endangered Species Act (16 U.S.C. §§ 1531-1544). If a "take" will result from any act authorized under this Order held by the Permittee, the



Permittee must obtain authorization for the take prior to any construction or operation of the portion of the Project that may result in a take. The Permittee is responsible for meeting all requirements of the applicable endangered species act for the Project authorized under this Order.

3. The Permittee shall grant Los Angeles Water Board staff, or an authorized representative (including an authorized contractor acting as a Water Board representative), upon presentation of credentials and other documents as may be required by law, permission to:
  - a. Enter upon the Project or compensatory mitigation site(s) premises where a regulated facility or activity is located or conducted, or where records are kept.
  - b. Have access to and copy any records that are kept and are relevant to the Project or the requirements of this Order.
  - c. Inspect any facilities, equipment (including monitoring and control equipment), practices, or operations regulated or required under this Order.
  - d. Sample or monitor for the purposes of assuring Order compliance.
4. A copy of this Order shall be provided to any consultants, contractors, and subcontractors working on the Project. Copies of this Order shall remain at the Project site for the duration of this Order. The Permittee shall be responsible for work conducted by its consultants, contractors, and any subcontractors.
5. A copy of this Order must be available at the Project site(s) during construction for review by site personnel and agencies. All personnel performing work on the Project shall be familiar with the content of this Order and its posted location at the Project site.
6. Lake and Streambed Alteration Agreement – The Permittee shall submit a signed copy of the Department of Fish and Wildlife's lake and streambed alteration agreement to the Los Angeles Water Board immediately upon execution and prior to any discharge to waters of the state.

## **G. Construction**

### **Good Site Management “Housekeeping”**

1. The Permittee is not authorized to discharge water that has contacted uncured concrete or cement, or related washout to surface waters, ground waters, or land.
2. Fueling, lubrication, maintenance, storage and staging of vehicles and equipment shall not result in a discharge or a threatened discharge to any waters of the state. The Permittee shall not use leaking vehicles or equipment within waters of the state or where leaking materials may discharge to waters of the state.
3. BMPs for erosion, sediment and turbidity control shall be implemented and in place at commencement of, during and after any ground-clearing activities or any other project activities that could result in erosion or sediment discharges to surface water.

4. The project shall comply with the local regulations associated with the Los Angeles Water Board’s Municipal Stormwater Permit issued to Los Angeles County and co-permittees under NPDES No. CAS004001 and Waste Discharge Requirements Order No. R4-2012-0175.

**Post-Construction Storm Water Management**

5. Culverts or other structures shall be installed so that water flow is not impaired. Bottoms of temporary culverts shall be placed at water body grade and bottoms of permanent culverts shall be placed at or below water body grade.
6. Storm drain lines/culverts, outfall structure, and other water body crossing structures shall be properly aligned within the water body and otherwise engineered, installed, and maintained, to assure resistance to washout, and to prevent erosion and/or fill of the water body. Water velocity shall be dissipated at outfalls to reduce erosion.

**H. Mitigation for Temporary Impacts**

1. The Permittee shall restore all areas of temporary impacts to waters of the state. The restoration plan shall be submitted for written acceptance by Los Angeles Water Board staff within ninety days (90) of issuance of this Order. The restoration plan shall provide the following: a schedule; plans for grading of disturbed areas to pre-project contours; planting palette with plant species native to the Project area; invasive species management; performance standards; and maintenance requirements (e.g. watering, weeding, and replanting) and mitigation monitoring.
2. The Los Angeles Water Board may extend the monitoring period beyond requirements of the restoration plan upon a determination by Los Angeles Water Board Executive Officer that the performance standards have not been met or are not likely to be met within the monitoring period.

Table 3: Required Project Mitigation Quantity for Temporary Impacts								
Aquatic Resource Type	Mit. Type <sup>6</sup>	Units	Method <sup>7</sup>					
			Est.	Re-est.	Reh.	Enh.	Pres.	Unknown
Stream Channel	PR	Acres			0.35			

**I. Compensatory Mitigation for Permanent Impacts<sup>8</sup>**

<sup>6</sup> Mitigation type for onsite restoration of temporary impacts is Permittee Responsible (PR).

<sup>7</sup> Methods: establishment (Est.), reestablishment (Re-est.), rehabilitation (Reh.), enhancement (Enh.), preservation (Pres.). Unknown applies to advance credits with an unknown method and or location.



## 1. Compensatory Mitigation Plan

- a. The Permittee has not submitted a draft compensatory mitigation plan as part of the application. The Permittee shall provide a final compensatory mitigation plan for written acceptance by Los Angeles Water Board staff. Impacts to waters of the state are not authorized and shall not occur until a compensatory mitigation plan has been approved by Los Angeles Water Board staff. Upon approval by Los Angeles Water Board staff, the Permittee shall implement the approved plan.
- b. If the Permittee fulfills their compensatory mitigation obligations by Permittee-Responsible Compensatory Mitigation, the final compensatory mitigation plan shall include all plan elements as outlined in 40 CFR § 230.94(c)
- c. If the Permittee fulfills their compensatory mitigation obligations by securing credits from an approved mitigation bank or in-lieu fee program, need only include the items described in 40 CFR § 230.94(c)(5)-(6), and the name of the specific mitigation bank or in-lieu fee program to be used. This information shall be submitted to this Regional Board for approval prior to any project activities which take place within waters of the United States and shall include copies of all agreements made between the Applicant and a third-party organization regarding compensatory mitigation efforts.

## 2. Permittee-Responsible Compensatory Mitigation Responsibility

- a. Permittee responsible compensatory mitigation installation shall be completed by January 1, 2018, unless otherwise approved by the Regional Board.
- b. The Permittee is responsible for the required compensatory mitigation in perpetuity. However, the Permittee may transfer the compensatory mitigation requirements associated with long-term management when the following conditions have been met:
  - i. Performance standards are met.
  - ii. A Transfer Agreement to a third party has been approved by Los Angeles Water Board staff.
  - iii. An endowment fund has been provided by the Permittee to a third party for management in perpetuity of the mitigation site.
  - iv. A conservation easement, deed restriction, or other appropriate restrictive covenant for the mitigation site has been recorded and approved by Los Angeles Water Board staff.
- c. Transfer of Long-Term Permittee-Responsible Compensatory Mitigation and Management Responsibility

---

*(footnote continued from previous page)*

<sup>8</sup> Compensatory Mitigation is for permanent physical loss and permanent ecological degradation of a water of the state.

- i. A transfer agreement shall be submitted from an authorized representative of the new party (transferee) for acceptance by Los Angeles Water Board staff. This agreement shall demonstrate acceptance and understanding of the responsibility to comply with and fully satisfy the required compensatory mitigation and long-term management conditions. Failure to comply with the mitigation conditions and associated requirements may subject the transferee to enforcement by the Los Angeles Water Board under Water Code section 13385, subdivision (a).
- ii. Notification of transfer of responsibilities meeting the above condition must be provided to the Los Angeles Water Board staff. A draft transfer agreement is due to Los Angeles Water Board staff no less than thirty (30) days prior to the transfer of the mitigation responsibility. A final transfer agreement is due to Los Angeles Water Board staff within 30 days of the completion of the transfer.

**3. Total Required Compensatory Mitigation**

- a. The Permittee is required to provide compensatory mitigation for the authorized impacts within waters of the State by providing mitigation at a ratio of 2:1, for a total of 0.34 acres.
- b. Total required Project compensatory mitigation information for permanent physical loss of area is summarized in Table 4.

<b>Table 4: Required Project Compensatory Mitigation Quantity for Permanent Physical Loss of Area</b>									
Aquatic Resource Type	Comp Mit. Type <sup>9</sup>	Units	Method <sup>10</sup>						
			Est.	Re-est.	Reh.	Enh.	Pres.	Unknown	
Stream Channel	PR	Acres			0.34				

**J. Water Quality Certification**

I hereby issue the Order 4WQC40116144 for the October 2015 Storm- Lake Hughes Road Project Repairs, certifying that as long as all of the conditions listed in this Order are met, any discharge from the referenced Project will comply with the applicable provisions of Clean Water Act sections 301 (Effluent Limitations), 302 (Water Quality Related Effluent Limitations), 303 (Water Quality Standards and Implementation Plans), 306 (National Standards of Performance), and 307 (Toxic and Pretreatment Effluent Standards).

<sup>9</sup> Compensatory mitigation type may be: In-Lieu-Fee (ILF); Mitigation Bank (MB); Permittee-Responsible (PR)

<sup>10</sup> Methods: establishment (Est.), reestablishment (Re-est.), rehabilitation (Reh.), enhancement (Enh.), preservation (Pres.). Unknown applies to advance credits with an unknown method and or location.

Except insofar as may be modified by any preceding conditions, all Order actions are contingent on: (a) the discharge being limited and all proposed mitigation being completed in strict compliance with the conditions of this Order and the attachments to this Order; and, (b) compliance with all applicable requirements of Statewide Water Quality Control Plans and Policies, the Regional Water Boards' Water Quality Control Plans and Policies.



Samuel Unger, PE  
Executive Officer  
Los Angeles Water Quality Control Board

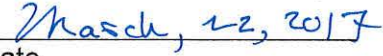

Date

- Attachment A** Signatory Requirements
- Attachment B** Map
- Attachment C** Report and Notification Requirements

Attachment A  
Signatory Requirements

---

(This page intentionally left blank)

## SIGNATORY REQUIREMENTS

*All Documents Submitted In Compliance With This Order  
Shall Meet The Following Signatory Requirements:*

1. All applications, reports, or information submitted to the Los Angeles Water Quality Control Board (Los Angeles Water Board) must be signed and certified as follows:
  - a) For a corporation, by a responsible corporate officer of at least the level of vice-president.
  - b) For a partnership or sole proprietorship, by a general partner or proprietor, respectively.
  - c) For a municipality, or a state, federal, or other public agency, by either a principal executive officer or ranking elected official.
2. A duly authorized representative of a person designated in items 1.a through 1.c above may sign documents if:
  - a) The authorization is made in writing by a person described in items 1.a through 1.c above.
  - b) The authorization specifies either an individual or position having responsibility for the overall operation of the regulated activity.
  - c) The written authorization is submitted to the State Water Board Staff Contact prior to submitting any documents listed in item 1 above.
3. Any person signing a document under this section shall make the following certification:

"I certify under penalty of law that I have personally examined and am familiar with the information submitted in this document and all attachments and that, based on my inquiry of those individuals immediately responsible for obtaining the information, I believe that the information is true, accurate, and complete. I am aware that there are significant penalties for submitting false information, including the possibility of fine and imprisonment."





(This page intentionally left blank)

RBS-LACO-007-0  
LA County Public Works  
Page 3 of 26

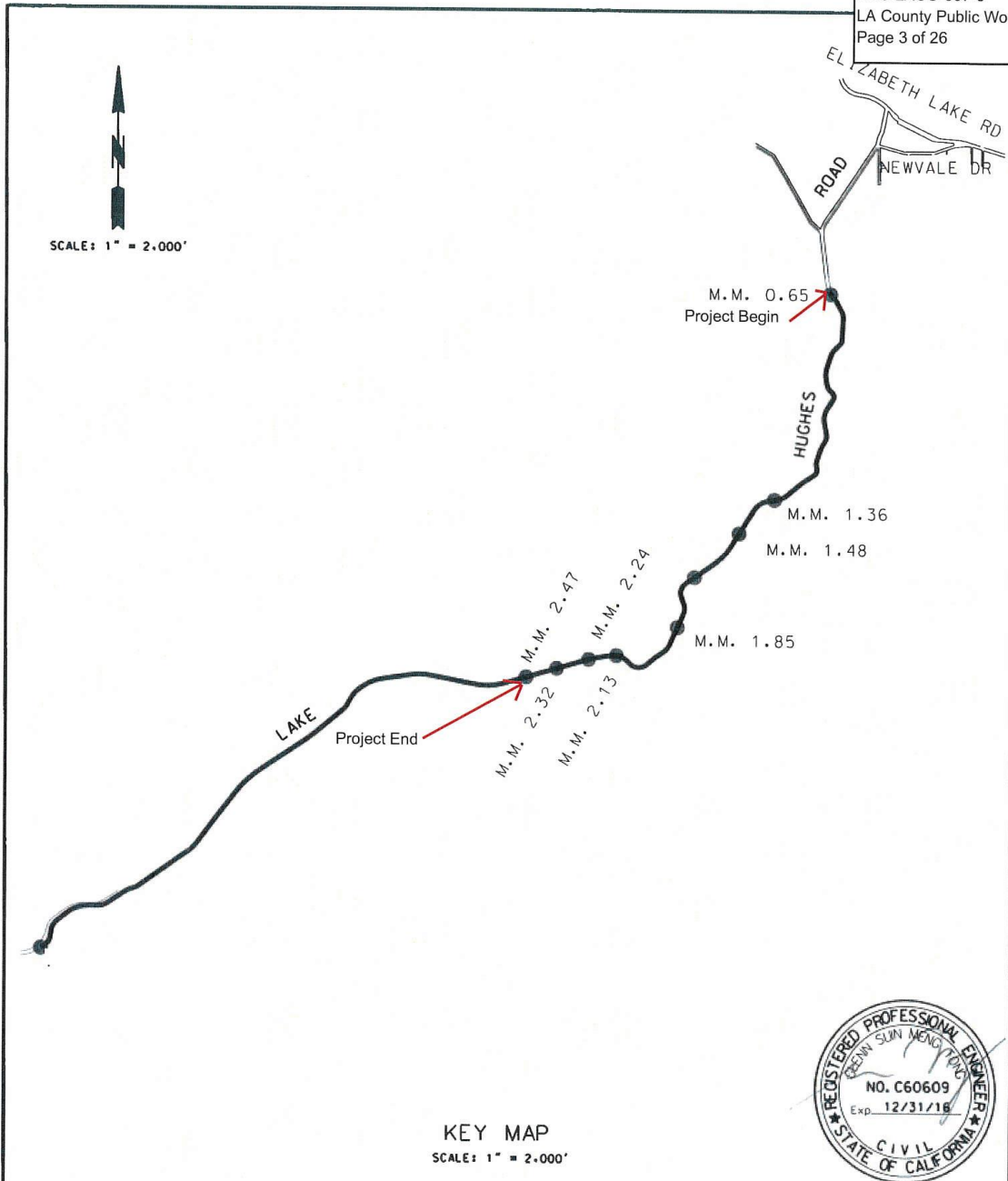

KEY MAP  
SCALE: 1" = 2,000'

PROJECT NAME LAKE HUGHES RD - M.M. 4.62 / M.M. 0.65		PROJECT NO. R8H556011	
DRAWN BY G. TONG	DATE 10/15/2015	APPROVED BY <i>Jeffrey S. Hawkins</i>	DATE 3-11-16
PROJECT ENGINEER G. TONG	C.E. NO. C 60609	LOS ANGELES COUNTY DEPT OF PUBLIC WORKS ROAD MAINTENANCE DIVISION - DISTRICT 5	T.G. 4101 F5
SCALE 1" = 2,000'	FILENAME	SHEET 1 OF 11	

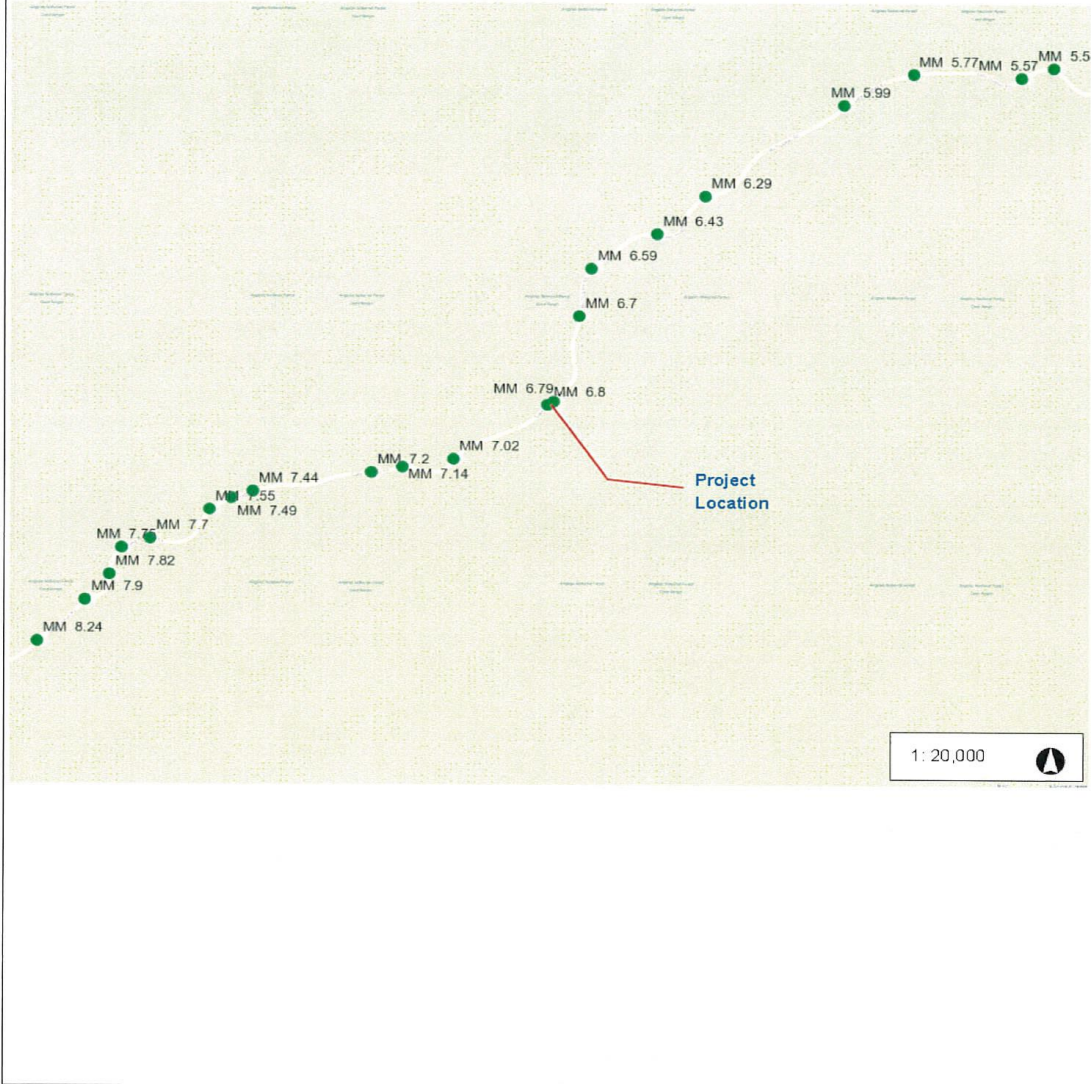
U.S. Department of Transportation Federal Highway Administration- California Division- Title 23 Damage Assessment Form (DAF)	DAF # <u>RBS</u> - <u>LACO</u> - <u>009</u> - <u>0</u> Sheet # <u>3</u> of <u>8</u> Applicant <u>LA Co. Dept of Public Works</u>																						
<u>Photos, Sketches and/or Narrative</u>																							
Please refer to the sketch for additional details Photo description:																							
 <p>The map displays a road alignment with mile markers (MM) ranging from 5.5 to 8.24. A red line segment between MM 6.8 and 6.79 is labeled 'Project Location'. The markers are as follows:</p> <table border="1"><thead><tr><th>Mile Marker (MM)</th></tr></thead><tbody><tr><td>5.5</td></tr><tr><td>5.57</td></tr><tr><td>5.77</td></tr><tr><td>5.99</td></tr><tr><td>6.29</td></tr><tr><td>6.43</td></tr><tr><td>6.59</td></tr><tr><td>6.7</td></tr><tr><td>6.79</td></tr><tr><td>6.8</td></tr><tr><td>7.02</td></tr><tr><td>7.14</td></tr><tr><td>7.2</td></tr><tr><td>7.44</td></tr><tr><td>7.49</td></tr><tr><td>7.55</td></tr><tr><td>7.7</td></tr><tr><td>7.72</td></tr><tr><td>7.82</td></tr><tr><td>7.9</td></tr><tr><td>8.24</td></tr></tbody></table> <p>Scale: 1:20,000</p>		Mile Marker (MM)	5.5	5.57	5.77	5.99	6.29	6.43	6.59	6.7	6.79	6.8	7.02	7.14	7.2	7.44	7.49	7.55	7.7	7.72	7.82	7.9	8.24
Mile Marker (MM)																							
5.5																							
5.57																							
5.77																							
5.99																							
6.29																							
6.43																							
6.59																							
6.7																							
6.79																							
6.8																							
7.02																							
7.14																							
7.2																							
7.44																							
7.49																							
7.55																							
7.7																							
7.72																							
7.82																							
7.9																							
8.24																							

U.S. Department of Transportation Federal Highway Administration- California Division- Title 23 Damage Assessment Form (DAF)	DAF # <u>RBS</u> - <u>LACO</u> - <u>008</u> - <u>0</u> Sheet # <u>3</u> of <u>7</u> Applicant <u>LA Co. Dept of Public Works</u>
Photos, Sketches and/or Narrative	
Photo description:	<div style="text-align: center;">                     Location Map  </div>



(This page intentionally left blank)

## Copies of this Form

In order to identify your project, it is necessary to include a copy of the Project specific Cover Sheet below with your report: please retain for your records

## Report Submittal Instructions

1. Check the box on the Report and Notification Cover Sheet next to the report or notification you are submitting.
  - **Part A (Annual Report):** This report will be submitted annually from the anniversary of Project effective date until a Notice of Project Complete Letter is issued.
  - **Part B (Project Status Notifications):** Used to notify the Los Angeles Water Board of the status of the Project schedule that may affect Project billing.
  - **Part C (Conditional Notifications and Reports):** Required on a case by case basis for accidental discharges of hazardous materials, violation of compliance with water quality standards, notification of in-water work, or other reports.
2. Sign the Report and Notification Cover Sheet and attach all information requested for the Report Type.
3. **Electronic Report Submittal Instructions:**
  - Submit signed Report and Notification Cover Sheet and required information via email to: [Valerie.CarrilloZara@waterboards.ca.gov](mailto:Valerie.CarrilloZara@waterboards.ca.gov)
  - Include in the subject line of the email:  
Subject: ATTN: Valerie CarrilloZara; File No: 16-144, Reg. Measure ID: 410239\_Report

## Definition of Reporting Terms

1. **Active Discharge Period:** The active discharge period begins with the effective date of this Order and ends on the date that the Permittee receives a Notice of Completion of Discharges Letter or, if no post-construction monitoring is required, a Notice of Project Complete Letter. The Active Discharge Period includes all elements of the Project including site construction and restoration, and any Permittee responsible compensatory mitigation construction.
2. **Request for Notice of Completion of Discharges Letter:** This request by the Permittee to the Los Angeles Water Board staff pertains to projects that have post construction monitoring requirements, e.g. if site restoration was required to be monitored for 5 years following construction. Los Angeles Water Board staff will review the request and send a Completion of Discharges Letter to the Permittee upon approval. This letter will initiate the post-discharge monitoring period and a change in fees from the annual active discharge fee to the annual post-discharge monitoring fee.
3. **Request for Notice of Project Complete Letter:** This request by the Permittee to the Los Angeles Water Board staff pertains to projects that either have completed post-construction monitoring and achieved performance standards or have no post-construction monitoring requirements, and no further Project activities are planned. Los Angeles Water Board staff will review the request and send a Project Complete



Letter to the Permittee upon approval. Termination of annual invoicing of fees will correspond with the date of this letter.

4. **Post-Discharge Monitoring Period:** The post-discharge monitoring period begins on the date of the Notice of Completion of Discharges Letter and ends on the date of the Notice of Project Complete Letter issued by the Los Angeles Water Board staff. The Post-Discharge Monitoring Period includes continued water quality monitoring or compensatory mitigation monitoring.
5. **Effective Date:** Date of Order issuance.

### Map/Photo Documentation Information

When submitting maps or photos, please use the following formats.

#### 1. **Map Format Information:**

Preferred map formats of at least 1:24000 (1" = 2000') detail (listed in order of preference):

- **GIS shapefiles:** The shapefiles must depict the boundaries of all project areas and extent of aquatic resources impacted. Each shape should be attributed with the extent/type of aquatic resources impacted. Features and boundaries should be accurate to within 33 feet (10 meters). Identify datum/projection used and if possible, provide map with a North American Datum of 1983 (NAD38) in the California Teale Albers projection in feet.
- **Google KML files** saved from Google Maps: My Maps or Google Earth Pro. Maps must show the boundaries of all project areas and extent/type of aquatic resources impacted. Include URL(s) of maps. If this format is used include a spreadsheet with the object ID and attributed with the extent/type of aquatic resources impacted.
- **Other electronic format** (CAD or illustration format) that provides a context for location (inclusion of landmarks, known structures, geographic coordinates, or USGS DRG or DOQQ). Maps must show the boundaries of all project areas and extent/type of aquatic resources impacted. If this format is used include a spreadsheet with the object ID and attributed with the extent/type of aquatic resources impacted.
- Aquatic resource maps marked on paper **USGS 7.5 minute topographic maps** or **Digital Orthophoto Quarter Quads (DOQQ)** printouts. Maps must show the boundaries of all project areas and extent/type of aquatic resources impacted. If this format is used include a spreadsheet with the object ID and attributed with the extent/type of aquatic resources impacted.

2. **Photo-Documentation:** Include a unique identifier, date stamp, written description of photo details, and latitude/longitude (in decimal degrees) or map indicating location of photo. Successive photos should be taken from the same vantage point to compare pre/post construction conditions.

**REPORT AND NOTIFICATION COVER SHEET**

**Project:** October 2015 Storm – Lake Hughes Road  
**Permittee:** Los Angeles County, Department of Public Works, Albert Anidi  
**Reg. Meas. ID:** 410239                      **Place ID:** 829844  
**File No:** 16-144

**Report Type Submitted**

**Part A – Project Reporting**

**Report Type**                       **Annual Report**

**Part B - Project Status Notifications**

**Report Type**                       **Commencement of Construction**

**Report Type**                       **Request for Notice of Completion of Discharges Letter**

**Report Type**                       **Request for Notice of Project Complete Letter**

**Part C - Conditional Notifications and Reports**

**Report Type**                       **Accidental Discharge of Hazardous Material Report**

**Report Type**                       **Violation of Compliance with Water Quality Standards Report**

**Report Type**                       **In-Water Work/Diversions Water Quality Monitoring Report**

**Report Type**                       **Modifications to Project Report**

**Report Type**                       **Transfer of Property Ownership Report**

**Report Type**                       **Transfer of Long-Term BMP Maintenance Report**

"I certify under penalty of law that I have personally examined and am familiar with the information submitted in this document and all attachments and that, based on my inquiry of those individuals immediately responsible for obtaining the information, I believe that the information is true, accurate, and complete. I am aware that there are significant penalties for submitting false information, including the possibility of fine and imprisonment."

Print Name <sup>1</sup>

Affiliation and Job Title

Signature

Date

**<sup>1</sup>STATEMENT OF AUTHORIZATION (include if authorization has changed since application was submitted)**

I hereby authorize \_\_\_\_\_ to act in my behalf as my representative in the submittal of this report, and to furnish upon request, supplemental information in support of this submittal.

\_\_\_\_\_  
Permittee's Signature

\_\_\_\_\_  
Date

**\*This Report and Notification Cover Sheet must be signed by the Permittee or a duly authorized representative and included with all written submittals.**

**Part A – Project Reporting**

<b>Report Type</b>	<b>Annual Report</b>
<b>Report Purpose</b>	Notify the Los Angeles Water Board staff of Project status during both the active discharge and post-discharge monitoring periods.
<b>When to Submit</b>	Annual reports shall be submitted each year on the anniversary of the effective date. Annual reports shall continue until a Notice of Project Complete Letter is issued to the Permittee.
<b>Report Contents</b>	<p>The contents of the annual report shall include the topics indicated below for each project period. Report contents are outlined in Annual Report Topics below.</p> <p><b><u>During the Active Discharge Period</u></b></p> <ul style="list-style-type: none"> <li>• <b>Topic 1: Construction Summary</b></li> <li>• <b>Topic 2: Mitigation for Temporary Impacts Status</b></li> <li>• <b>Topic 3: Compensatory Mitigation for Permanent Impacts Status</b></li> </ul> <p><b><u>During the Post-Discharge Monitoring Period</u></b></p> <ul style="list-style-type: none"> <li>• <b>Topic 2: Mitigation for Temporary Impacts Status</b></li> <li>• <b>Topic 3: Compensatory Mitigation for Permanent Impacts Status</b></li> </ul>
<b>Annual Report Topics (1-3)</b>	
<b>Annual Report Topic 1</b>	<b>Construction Summary</b>
<b>When to Submit</b>	With the annual report during the Active Discharge Period.
<b>Report Contents</b>	<ol style="list-style-type: none"> <li>1. Project progress and schedule including initial ground disturbance, site clearing and grubbing, road construction, site construction, and the implementation status of construction storm water best management practices (BMPs). If construction has not started, provide estimated start date and reasons for delay.</li> <li>2. Map showing general Project progress.</li> <li>3. If applicable: <ol style="list-style-type: none"> <li>a. Summary of Conditional Notification and Report Types 6 and 7 (Part C below).</li> <li>b. Summary of Certification Deviations. See Certification Deviation Attachment for further information.</li> </ol> </li> </ol>
<b>Annual Report Topic 2</b>	<b>Mitigation for Temporary Impacts Status</b>
<b>When to Submit</b>	With the annual report during both the Active Discharge Period and Post-Discharge Monitoring Period.

<b>Report Contents</b>	<ol style="list-style-type: none"> <li>1. Planned date of initiation and map showing locations of mitigation for temporary impacts to waters of the state and all upland areas of temporary disturbance which could result in a discharge to waters of the state.</li> <li>2. If mitigation for temporary impacts has already commenced, provide a map and information concerning attainment of performance standards contained in the restoration plan.</li> </ol>
<b>Annual Report Topic 3</b>	<b>Compensatory Mitigation for Permanent Impacts Status</b>
<b>When to Submit</b>	With the annual report during both the Active Discharge Period and Post-Discharge Monitoring Period.
<b>Report Contents</b>	<p><b>*If not applicable report N/A.</b></p> <p><b>Part A. Permittee Responsible</b></p> <ol style="list-style-type: none"> <li>1. Planned date of initiation of compensatory mitigation site installation.</li> <li>2. If installation is in progress, a map of what has been completed to date.</li> <li>3. If the compensatory mitigation site has been installed, provide a final map and information concerning attainment of performance standards contained in the compensatory mitigation plan.</li> </ol> <p><b>Part B. Mitigation Bank or In-Lieu Fee</b></p> <ol style="list-style-type: none"> <li>1. Status or proof of purchase of credit types and quantities.</li> <li>2. Include the name of bank/ILF Program and contact information.</li> <li>3. If ILF, location of project and type if known.</li> </ol>

**Part B – Project Status Notifications**

<b>Report Type</b>	<b>Commencement of Construction</b>
<b>Report Purpose</b>	Notify Los Angeles Water Board staff prior to the start of construction.
<b>When to Submit</b>	Must be received at least seven (7) days prior to start of initial ground disturbance activities.
<b>Report Contents</b>	<ol style="list-style-type: none"> <li>1. Date of commencement of construction.</li> <li>2. Anticipated date when discharges to waters of the state will occur.</li> <li>3. Project schedule milestones including a schedule for onsite compensatory mitigation, if applicable.</li> </ol>

<b>Report Type</b>	<b>Request for Notice of Completion of Discharges Letter</b>
<b>Report Purpose</b>	Notify Los Angeles Water Board staff that post-construction monitoring is required and that active Project construction, including any mitigation and permittee responsible compensatory mitigation, is complete.
<b>When to Submit</b>	Must be received by Los Angeles Water Board staff within thirty (30) days following completion of all Project construction activities.
<b>Report Contents</b>	<ol style="list-style-type: none"> <li>1. Status of storm water Notice of Termination(s), if applicable.</li> <li>2. Status of post-construction storm water BMP installation.</li> <li>3. Pre- and post-photo documentation of all Project activity sites where the discharge of dredge and/or fill/excavation was authorized.</li> <li>4. Summary of Certification Deviation discharge quantities compared to initial authorized impacts to waters of the state, if applicable.</li> <li>5. An updated monitoring schedule for mitigation for temporary impacts to waters of the state and permittee responsible compensatory mitigation during the post-discharge monitoring period, if applicable.</li> </ol>

<b>Report Type</b>	<b>Request for Notice of Project Complete Letter</b>
<b>Report Purpose</b>	Notify Los Angeles Water Board staff that construction and/or any post-construction monitoring is complete, or is not required, and no further Project activity is planned.
<b>When to Submit</b>	Must be received by Los Angeles Water Board staff within thirty (30) days following completion of all Project activities.
<b>Report Contents</b>	<p><b>Part A: Mitigation for Temporary Impacts</b></p> <ol style="list-style-type: none"> <li>1. A report establishing that the performance standards outlined in the restoration plan have been met for Project site upland areas of temporary disturbance which could result in a discharge to waters of the state.</li> <li>2. A report establishing that the performance standards outlined in the restoration plan have been met for restored areas of temporary impacts to waters of the state. Pre- and post-photo documentation of all restoration sites.</li> </ol>

**Part B: Permittee Responsible Compensatory Mitigation**

3. A report establishing that the performance standards outlined in the compensatory mitigation plan have been met.
4. Status on the implementation of the long-term maintenance and management plan and funding of endowment.
5. Pre- and post-photo documentation of all compensatory mitigation sites.
6. Final maps of all compensatory mitigation areas (including buffers).

**Part C: Post-Construction Storm Water BMPs**

7. Date of storm water Notice of Termination(s), if applicable.
8. Report status and functionality of all post-construction BMPs.



**Part C – Conditional Notifications and Reports**

<b>Report Type</b>	<b>Accidental Discharge of Hazardous Material Report</b>
<b>Report Purpose</b>	Notifies Los Angeles Water Board staff that an accidental discharge of hazardous material has occurred.
<b>When to Submit</b>	Within five (5) working days following the date of an accidental discharge. Continue reporting as required by Los Angeles Water Board staff.
<b>Report Contents</b>	<ol style="list-style-type: none"> <li>1. The report shall include the OES Incident/Assessment Form, a full description and map of the accidental discharge incident (i.e. location, time and date, source, discharge constituent and quantity, aerial extent, and photo documentation). If applicable, the OES Written Follow-Up Report may be substituted.</li> <li>2. If applicable, any required sampling data, a full description of the sampling methods including frequency/dates and times of sampling, equipment, locations of sampling sites.</li> <li>3. Locations and construction specifications of any barriers, including silt curtains or diverting structures, and any associated trenching or anchoring.</li> </ol>

<b>Report Type</b>	<b>Violation of Compliance with Water Quality Standards Report</b>
<b>Report Purpose</b>	Notifies Los Angeles Water Board staff that a violation of compliance with water quality standards has occurred.
<b>When to Submit</b>	The Permittee shall report any event that causes a violation of water quality standards within three (3) working days of the noncompliance event notification to Los Angeles Water Board staff.
<b>Report Contents</b>	The report shall include: the cause; the location shown on a map; and the period of the noncompliance including exact dates and times. If the noncompliance has not been corrected, include: the anticipated time it is expected to continue; the steps taken or planned to reduce, eliminate, and prevent reoccurrence of the noncompliance; and any monitoring results if required by Los Angeles Water Board staff.

<b>Report Type</b>	<b>In-Water Work and Diversions Water Quality Monitoring Report</b>
<b>Report Purpose</b>	Notifies Los Angeles Water Board staff of the completion of in-water work.
<b>When to Submit</b>	Within three (3) working days following the completion of in-water work. Continue reporting in accordance with the approved water quality monitoring plan.
<b>Report Contents</b>	As required by the approved water quality monitoring plan.

<b>Report Type</b>	<b>Modifications to Project Report</b>
--------------------	--

<b>Report Purpose</b>	Notifies Los Angeles Water Board staff if the Project, as described in the application materials, is altered in any way or by the imposition of subsequent permit conditions by any local, state or federal regulatory authority.
<b>When to Submit</b>	If Project implementation as described in the application materials is altered in any way or by the imposition of subsequent permit conditions by any local, state or federal regulatory authority.
<b>Report Contents</b>	A description and location of any alterations to Project implementation. Identification of any Project modifications that will interfere with the Permittee's compliance with the Order.

<b>Report Type</b>	<b>Transfer of Property Ownership Report</b>
<b>Report Purpose</b>	Notifies Los Angeles Water Board staff of change in ownership of the Project or Permittee-responsible mitigation area.
<b>When to Submit</b>	At least 10 working days prior to the transfer of ownership.
<b>Report Contents</b>	<ol style="list-style-type: none"> <li>1. A statement that the Permittee has provided the purchaser with a copy of this Order and that the purchaser understands and accepts: <ol style="list-style-type: none"> <li>a. the Order's requirements and the obligation to implement them or be subject to administrative and/or civil liability for failure to do so; and</li> <li>b. responsibility for compliance with any long-term BMP<sup>2</sup> maintenance plan requirements in this Order.</li> </ol> </li> <li>2. A statement that the Permittee has informed the purchaser to submit a written request to the Los Angeles Water Board to be named as the permittee in a revised order.</li> </ol>

<b>Report Type</b>	<b>Transfer of Long-Term BMP Maintenance Report</b>
<b>Report Purpose</b>	Notifies Los Angeles Water Board staff of transfer of long-term BMP maintenance responsibility.
<b>When to Submit</b>	At least 10 working days prior to the transfer of BMP maintenance responsibility.
<b>Report Contents</b>	A copy of the legal document transferring maintenance responsibility of post-construction BMPs.

<sup>2</sup> Best Management Practices (BMPs) is a term used to describe a type of water pollution or environmental control.