

Materials Management Unit

Land Disposal Program

December 12, 2018



Brianna St. Pierre, P.G.

State Water Resources Control Board – Division of Water Quality

OUTLINE

- Programs
- Priority Projects
- Regional Board Support
- Examples



PROGRAMS

- Agriculture (ILRP)
- Biosolids
- Composting
- Land Disposal



PRIORITY PROJECTS

- Administrative Procedures Manuals
- Revising California Code of Regulations, title 27
- Revising the Composting General Order
- Statewide Investigative Order for CECs
- Statewide Order for Disaster Debris
- Manure Research Contract



ROUTINE PROJECTS

- Coordinating Roundtables
- Meeting with Stakeholders
- Interagency Collaboration
- Developing Reports
- Guidance Documents
- Technical Library
- Coordinating Training
- Technical Support for Regional Board Staff



Example – Sycamore Landfill

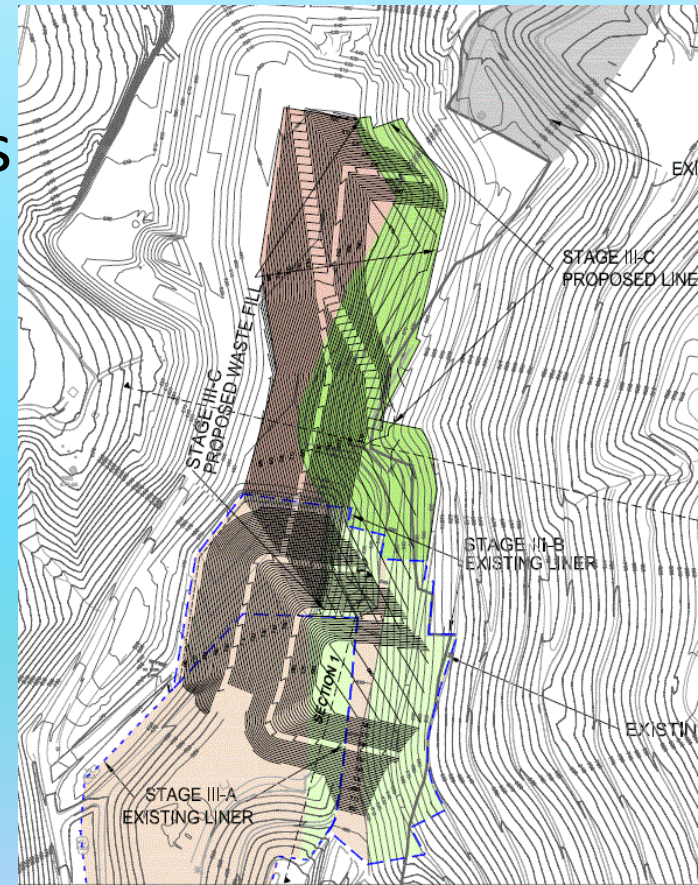

- Concurrent ROWD/JTD Review
- Liner and Cover Designs
 - Material Interface properties
- Seismic and Static Stability Analysis
- Construction Quality Assurance



GUIDANCE TOOLS

Tier Determination (SWRCB & CalRecycle)

 What is the maximum volume on-site at any given time at your facility (cubic yards)?

  Which of the following feedstocks are composted at your facility?

- Agricultural Materials
 - Biosolids
 - Food Materials
 - Residentially co-collected or self-hauled food and green materials
 - Paper Materials
 - Vegetative Food Materials
 - Green Materials
 - Anaerobic Digestate
 - Herbivore Manure
 - Non-Herbivore Manure (up to 30% of your facilities total compost material)
 - Mixed Material
 - Other
- Yes | No

 Is the facility located on a Publicly Owned Treatment Works (POTW)?

Close

COMPLIANCE GUIDANCE

GEOTRACKER ESI
[Electronic Submittal of Information]

**ESI BEGINNER'S GUIDE FOR
CONTRACTORS**
(Composting Facility Owner/Operator
Contractors & Consultants)

Version 1.0

FEBRUARY 2018

STATE WATER RESOURCES CONTROL BOARD
GEOTRACKER

ESI Homepage:

https://www.waterboards.ca.gov/water_issues/programs/ust/electronic_submittal/

GEOTRACKER ESI
[Electronic Submittal of Information]

**ESI BEGINNER'S GUIDE FOR
AUTHORIZED RP AGENTS**
(Consultants to Composting Facility
Owners/Operators)

Version 1.0

FEBRUARY 2018

STATE WATER RESOURCES CONTROL BOARD
GEOTRACKER

ESI Homepage:

https://www.waterboards.ca.gov/water_issues/programs/ust/electronic_submittal/

GEOTRACKER ESI
[Electronic Submittal of Information]

**ESI BEGINNER'S GUIDE FOR
RESPONSIBLE PARTIES**
(Composting Facility Owners/Operators)

Version 1.0

FEBRUARY 2018

STATE WATER RESOURCES CONTROL BOARD
GEOTRACKER

ESI Homepage:

https://www.waterboards.ca.gov/water_issues/programs/ust/electronic_submittal/

COMPLIANCE GUIDANCE

- ii) Hover the cursor over the Facility Management tab to the right of the Main Menu tool bar, and then click on Request Additional Facs.

1. Hover cursor pointer over "Facility Management" to view and select "Request Additional Facs" option.



2. Click

Facility Management Download / Upload

Associated Facilities Denied Facilities **Request Additional Facs**

TOOLS

- Upload EDD
- Check EDD
- VVL Search Tool
- Edit Field Points
- Other Tools
- Add Program
- Logout

REQUEST ADDITIONAL FACILITIES

1 RECORDS FOUND PAGE 1 OF 1

Global ID	Facility Name	Status	Street Name	City	County
<input type="text"/>	<input type="text"/>	<input type="text"/>	<input type="text"/>	<input type="text"/>	<input type="text"/>

<input type="checkbox"/>	GLOBAL ID	FACILITY NAME	STATUS	ADDRESS	CITY	COUNTY
<input type="button" value="Request Checked Facilities"/>						

- iii) Search for a site by entering the site address, name, or Global ID number issued by Regional Water Board Staff and then click the Search button.

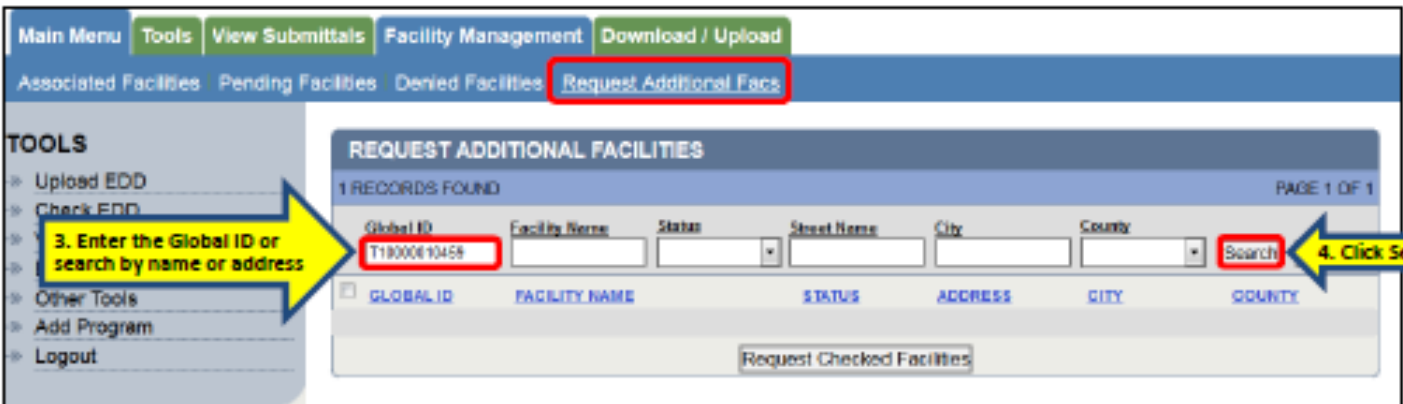

3. Enter the Global ID or search by name or address

4. Click Search

Main Menu Tools View Submittals **Facility Management** Download / Upload

Associated Facilities Pending Facilities Denied Facilities **Request Additional Facs**

TOOLS

- Upload EDD
- Check EDD
- VVL Search Tool
- Edit Field Points
- Other Tools
- Add Program
- Logout

REQUEST ADDITIONAL FACILITIES

1 RECORDS FOUND PAGE 1 OF 1

Global ID	Facility Name	Status	Street Name	City	County
<input type="text" value="T19000610458"/>	<input type="text"/>	<input type="text"/>	<input type="text"/>	<input type="text"/>	<input type="text"/>

<input type="checkbox"/>	GLOBAL ID	FACILITY NAME	STATUS	ADDRESS	CITY	COUNTY
<input type="button" value="Request Checked Facilities"/>						

Questions/Comments?

Brianna St. Pierre

Brianna.St.Pierre@waterboards.ca.gov

(916) 341-5810