

I, NICHOLAS F. BONSIGNORE, OF 444 N. THIRD STREET, SUITE 325, SACRAMENTO, CA, DO HEREBY CERTIFY THAT THIS MAP WAS PREPARED UNDER MY DIRECT SUPERVISION BASED ON USGS 7.5-MINUTE QUADRANGLE MAPS FOR WARM SPRINGS DAM AND GEYSERVILLE, CA, AND AN AERIAL PHOTOGRAPH DATED MAY 8, 2006 OBTAINED FROM THE USDA FSA AERIAL PHOTOGRAPHY FIELD OFFICE, AND FROM A MAP ENTITLED "THE LANDS OF MERLO RANCH" PREPARED BY CURTIS & ASSOCIATES DATED MAY 1998, AND THAT IT CORRECTLY REPRESENTS THE PROJECT DESCRIBED IN THE ACCOMPANYING APPLICATION AND PETITIONS FOR CHANGE, AND SHOWS THE LOCATION OF STREAMS IN THE IMMEDIATELY VICINITY TO THE BEST OF MY KNOWLEDGE AND BELIEF.

*Nicholas F. Bonsignore* 11-14-08  
 NICHOLAS F. BONSIGNORE DATE  
 RCE #39422  
 EXPIRES DECEMBER 31, 2009

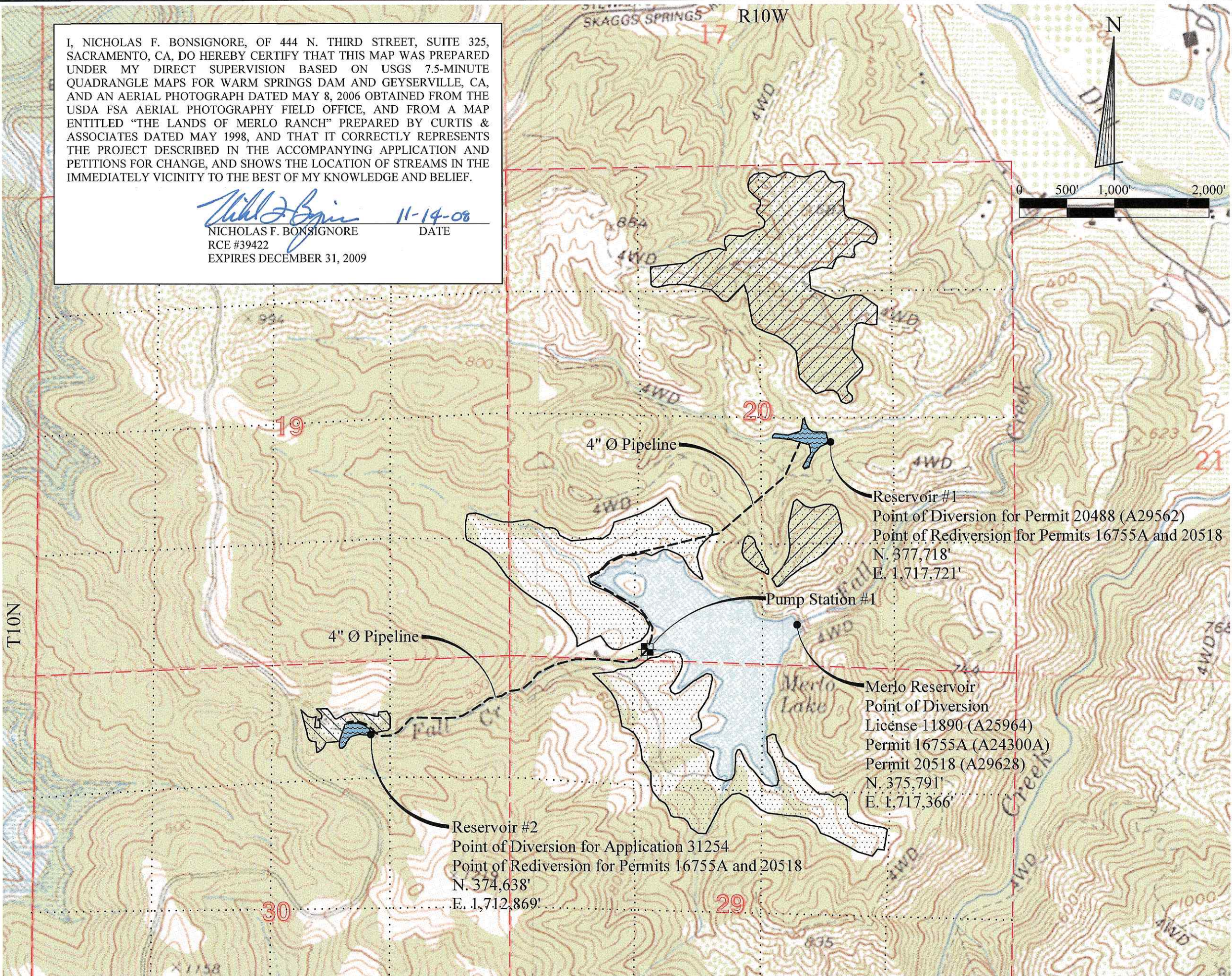
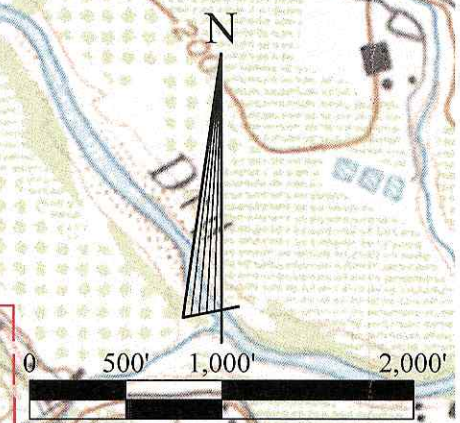

**Place of Use:**

Irrigation Under Permits 16755A and 20518						Previously Cultivated
Use is Within	Section	Township	Range	B.&M.	Acres	
NE¼ of SE¼	19	T10N	R10W	M.D.	2.1	Yes
SE¼ of SE¼	19	T10N	R10W	M.D.	3.0	Yes
NE¼ of NW¼	20	T10N	R10W	M.D.	11.5	Yes
NW¼ of NE¼	20	T10N	R10W	M.D.	25.7	Yes
SE¼ of NW¼	20	T10N	R10W	M.D.	1.4	Yes
SW¼ of NE¼	20	T10N	R10W	M.D.	21.0	Yes
NW¼ of SW¼	20	T10N	R10W	M.D.	2.4	Yes
NE¼ of SW¼	20	T10N	R10W	M.D.	4.2	Partial
NW¼ of SE¼	20	T10N	R10W	M.D.	5.1	Yes
SW¼ of SW¼	20	T10N	R10W	M.D.	25.3	Yes
SE¼ of SW¼	20	T10N	R10W	M.D.	6.2	Partial
SW¼ of SE¼	20	T10N	R10W	M.D.	2.9	Partial
NW¼ of NW¼	29	T10N	R10W	M.D.	3.8	Yes
NE¼ of NE¼	29	T10N	R10W	M.D.	22.9	Yes
NW¼ of NE¼	29	T10N	R10W	M.D.	3.0	Yes
SE¼ of NW¼	29	T10N	R10W	M.D.	8.0	Yes
SW¼ of NE¼	29	T10N	R10W	M.D.	10.8	Yes
NW¼ of NE¼	30	T10N	R10W	M.D.	4.3	Yes
<b>Total:</b>					<b>163.6</b>	

Irrigation Under Permit 20488						Previously Cultivated
Use is Within	Section	Township	Range	B.&M.	Acres	
NE¼ of NW¼	20	T10N	R10W	M.D.	11.5	Yes
NW¼ of NE¼	20	T10N	R10W	M.D.	25.7	Yes
SE¼ of NW¼	20	T10N	R10W	M.D.	1.4	Yes
SW¼ of NE¼	20	T10N	R10W	M.D.	21.0	Yes
NE¼ of SW¼	20	T10N	R10W	M.D.	0.2	No
NW¼ of SE¼	20	T10N	R10W	M.D.	5.1	Yes
SE¼ of SW¼	20	T10N	R10W	M.D.	0.9	No
SW¼ of SE¼	20	T10N	R10W	M.D.	2.9	Partial
<b>Total:</b>					<b>68.7</b>	

Irrigation Under Application 31254						Previously Cultivated
Use is Within	Section	Township	Range	B.&M.	Acres	
NW¼ of NE¼	30	T10N	R10W	M.D.	4.3	Yes
<b>Total:</b>					<b>4.3</b>	

At Merlo Reservoir for Stock and Rec Under Permit 16755A:					
Use is Within	Section	Township	Range	B.&M.	
SW¼ of SW¼	20	10N	10W	MD	
SE¼ of SW¼	20	10N	10W	MD	
SW ¼ of SE ¼	20	10N	10W	MD	
NE ¼ of NW ¼	29	10N	10W	MD	
NW¼ of NE¼	29	10N	10W	MD	

**Legend**

- Place of Use for Permits 16755A and 20518
- Place of Use for Permit 20488
- Place of Use for Application 31254

Amended Map to Accompany  
 Application 31254  
 and  
 Petitions for Change on  
 Permits 16755A (A24300A),  
 20488 (A29562) and 20518 (A29628)  
 of  
 Merlo Corporation  
 Sonoma County, California  
 Wagner & Bonsignore  
 Consulting Civil Engineers, A Corporation