



Twenty (20) North half (1/2) and South West quarter (1/4)  
 of Section Twenty Nine (29) Twp. 23 N. R. 10 W. S. 10 E. and  
 Thirty One (31) West half (1/2) of South West quarter (1/4)  
 and South West quarter (1/4) of Section Thirty One (31) Twp. 23 N.  
 R. 10 W. S. 10 E. and South West quarter (1/4)  
 of Section Five (5) North half (1/2) and South West quarter (1/4)  
 and West half (1/2) of South East quarter (1/4) of Section Six  
 (6); a strip of land fronting on the San Joaquin River and  
 running easterly, the terms of which are with fractions  
 Eighty (80) acres being parts of the following tracts to-wit: fractions  
 South East quarter (1/4) of Section Four (4) South East quarter  
 (1/4) and East half (1/2) of South West quarter (1/4) of Section Five  
 (5); Whole Section Six (6) and Eighteen (18) West half (1/2) of  
 Section Eight (8) North of Section Seventeen (17) those portions  
 of Section Thirteen (13) and of West half (1/2) of West half (1/2)  
 of Section Twenty (20) lying north of the Paradise Street line.  
 The same being of Abner D. White and others. Together  
 with all and singular the tenements, hereditaments and  
 appurtenances thereto belonging in any wise apper-  
 taining, and the revenues and profits, revenues and  
 emoluments, rents, issues and profits thereof and also all  
 the whole, right, title, interest, property, franchises, claims,  
 and whatsoever, as well in law as in equity of the  
 said parts of the said tracts, in or to the above described land,  
 together with the said parts thereof, with the appurtenances  
 thereunto in all and singular the above mentioned  
 and to be held, used, enjoyed, with the appurtenances, with  
 the said parts of the said land, together with the said  
 appurtenances thereof, the said parts of the said land, has been  
 its estate, land, and all the same, together with the said parts  
 thereof, sold and delivered by J. S. Whitney (Seal)  
 in presence of  
 Wm. H. ...  
 (The seal of the said J. S. Whitney)

A. D. One Thousand Eight Hundred and Seventy seven  
 before me James S. King a Notary Public in and for said  
 City and County, exhibiting to me a duly authenticated and  
 sworn, powerfully executed, and signed by John A. Whitman, known to  
 be the person whose name is subscribed to the several  
 Instruments and heretofore acknowledged to me, that he re-  
 ceived the same, and that he has duly acknowledged the same at my office in  
 the City and County of San Francisco, the day and date  
 last before written.

 James S. King  
 Notary Public

Recorded at the request of J. C. Fisher Junr of A. D. 1877 & on  
 on record's book of the County of San Francisco.

George Callaghan  
 James C. Carter

This Instrument, made the 27th  
 day of December in the year of our Lord  
 one thousand eight hundred and sev-  
 enty seven, between George Callaghan  
 of the County of San Joaquin State of California party of the  
 first part and James C. Carter of same place the party of  
 the second part, it is hereby certified that the said party of the first part  
 for and in consideration of the sum of One Thousand Dollars  
 of the United States & American to him in hand paid by the  
 said party of the second part, the receipt whereof is hereby at-  
 testified, hath given, sold, conveyed and well conveyed and con-  
 veyed, and by these presents doth give, bargain, sell, con-  
 vey and confirm unto the said party of the second part,  
 and to his heirs and assigns forever all that certain lot five  
 and a half of block 26 being now being in the County of  
 San Joaquin State of California and bounded and part  
 bounded as follows to wit: The North East part  
 Section 36 of T. 20 N. R. 12 E. S. 34  
 and also all other lands and buildings thereon  
 and also all other lands and buildings thereon

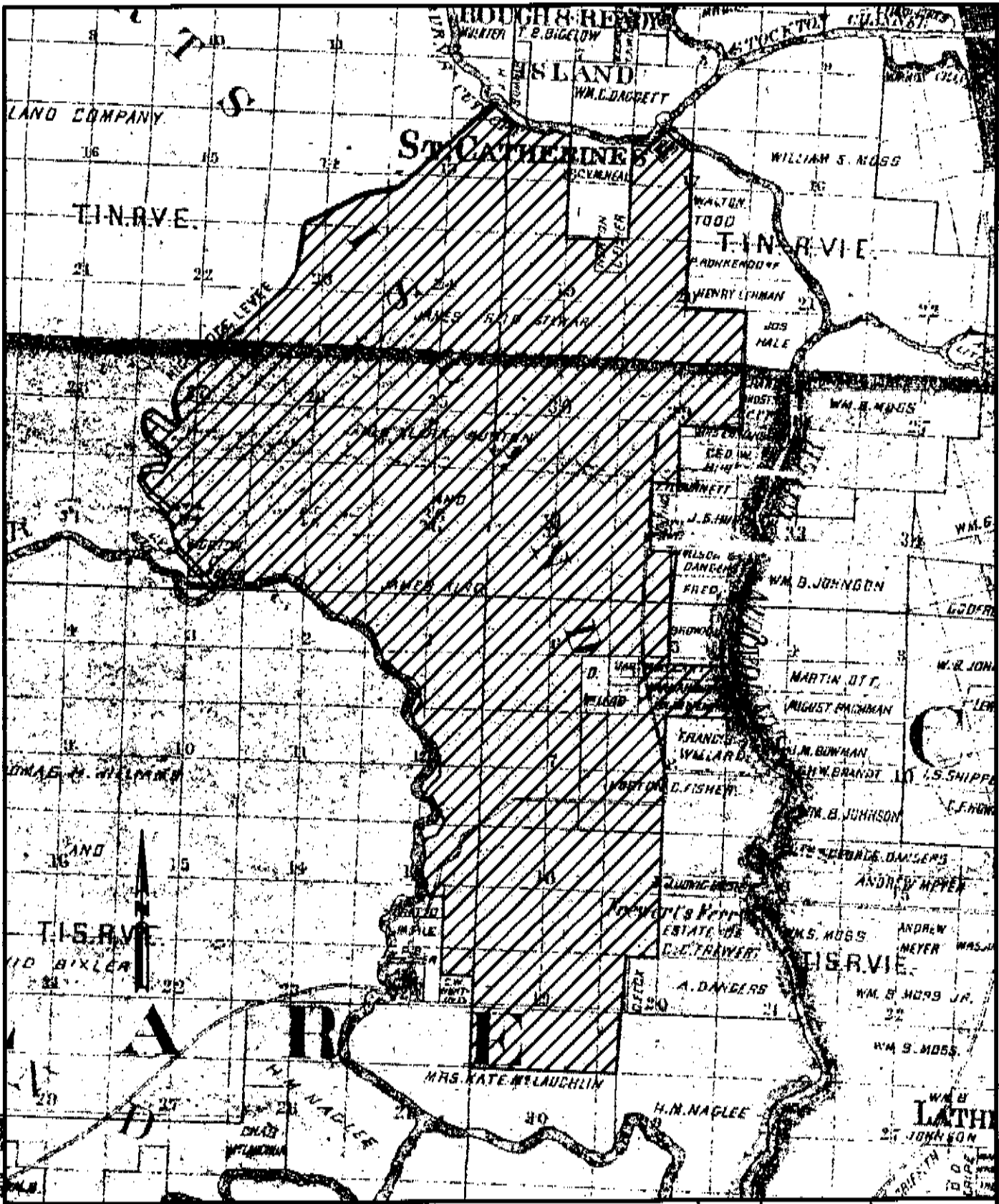

FILE SPEC: P:\1732\_S200\1070\_Historical\_Mapping\Survey\Mapas\Exhibit\CA0\B\_Whitney\_To\_Fisher.dwg  
 PLOT DATE: Mar 31 2010 8:45am

**KJENSEN SINNOCK NEUDECK INC.**  
 Civil Engineers and Land Surveyors  
 Post Office Box 644  
 711 N. Parading Avenue  
 Stockton, CA 95201-0644  
 Office: (209) 948-0288  
 Fax: (209) 948-0286  
 E-mail: KJENSEN@earthlink.net

**MUSSE CHAIN OF TITLE**  
**GRANTOR: JP WHITNEY**  
**GRANTEE: M.C. FISHER**  
**JANUARY 17TH, 1877**

Design	Scale
Drawn	1" = 5000
CSM	Original Drawing Scale
Check	0 1/4" 1/2"
SLB	

Date	3/30/10
Sheet Number	Of
Project File No.	1732-0070