

7/15/10

# PLAT

Showing the subdivision of the

**TWO BODIES OF LAND  
"NOTORIOUSLY SWAMPY & OVERFLOWED"**

located in the Township of

East of the Mount Diablo Meridian in Townships 22N + 23N  
North and Township 15 South of Mount Diablo Base Line.

containing

lots of 107 acres of swampy and overflowed

land in the Township of

containing

**PLAT**

**TWO BODIES OF LAND**

**NOTORIOUS SWAMPY & OVERFLOWED**

Part of the Mound District, Monticello Township, District 1, 23-4-85  
 North and Township (See Part of Mountain District)

Mountains, Mississippi  
 All rights reserved by the owner  
 Approved by the Surveyor General of the State of Mississippi  
 November 12, 1853

Scale - 1 inch = 1 mile

No.	Acres	Area	Value
1	100	100	100
2	100	100	100
3	100	100	100
4	100	100	100
5	100	100	100
6	100	100	100
7	100	100	100
8	100	100	100
9	100	100	100
10	100	100	100
11	100	100	100
12	100	100	100
13	100	100	100
14	100	100	100
15	100	100	100
16	100	100	100
17	100	100	100
18	100	100	100
19	100	100	100
20	100	100	100
21	100	100	100
22	100	100	100
23	100	100	100
24	100	100	100
25	100	100	100
26	100	100	100
27	100	100	100
28	100	100	100
29	100	100	100
30	100	100	100
31	100	100	100
32	100	100	100
33	100	100	100
34	100	100	100
35	100	100	100
36	100	100	100
37	100	100	100
38	100	100	100
39	100	100	100
40	100	100	100
41	100	100	100
42	100	100	100
43	100	100	100
44	100	100	100
45	100	100	100
46	100	100	100
47	100	100	100
48	100	100	100
49	100	100	100
50	100	100	100
51	100	100	100
52	100	100	100
53	100	100	100
54	100	100	100
55	100	100	100
56	100	100	100
57	100	100	100
58	100	100	100
59	100	100	100
60	100	100	100
61	100	100	100
62	100	100	100
63	100	100	100
64	100	100	100
65	100	100	100
66	100	100	100
67	100	100	100
68	100	100	100
69	100	100	100
70	100	100	100
71	100	100	100
72	100	100	100
73	100	100	100
74	100	100	100
75	100	100	100
76	100	100	100
77	100	100	100
78	100	100	100
79	100	100	100
80	100	100	100
81	100	100	100
82	100	100	100
83	100	100	100
84	100	100	100
85	100	100	100
86	100	100	100
87	100	100	100
88	100	100	100
89	100	100	100
90	100	100	100
91	100	100	100
92	100	100	100
93	100	100	100
94	100	100	100
95	100	100	100
96	100	100	100
97	100	100	100
98	100	100	100
99	100	100	100
100	100	100	100

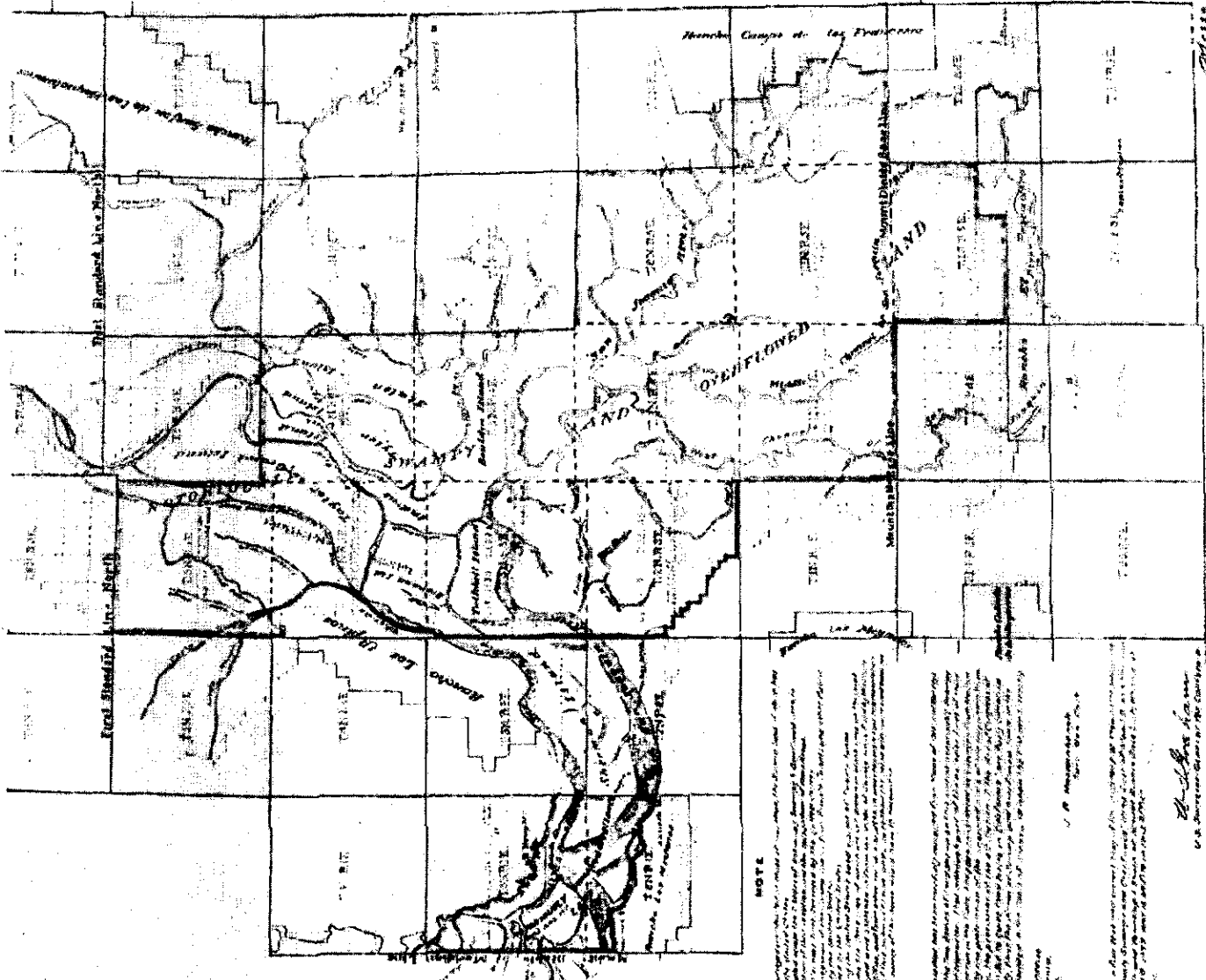

**NOTE**

The above plat shows the location of the land described in the title hereof, and is for the purpose of showing the location of the land described in the title hereof, and is for the purpose of showing the location of the land described in the title hereof...

Any person who wishes to purchase the land described in the title hereof, may do so by paying the purchase price to the landowner, or to the landowner's attorney, or to the landowner's agent, or to the landowner's representative, or to the landowner's authorized agent, or to the landowner's authorized representative, or to the landowner's authorized agent, or to the landowner's authorized representative, or to the landowner's authorized agent, or to the landowner's authorized representative...

Witness my hand and seal this 12th day of February, 1853.  
 A. A. McComb  
 Surveyor General of the State of Mississippi

**EXHIBIT 19A**

MSS-2-19A-19A

12

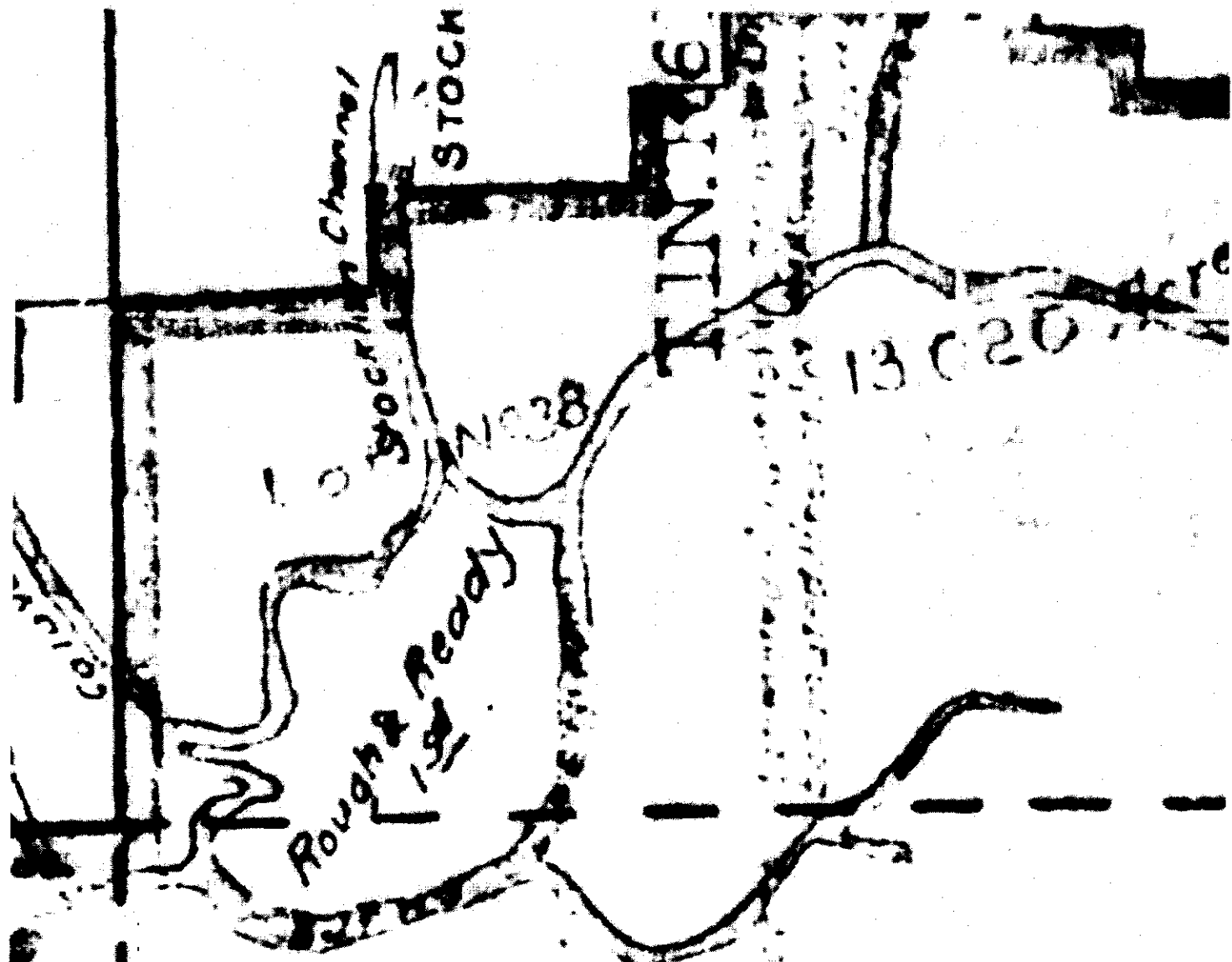

**ETW. R. SE.**

ETW. R. SE. 13020  
 1938