

Swamp Land District No. 282

Report and Estimate

Reclamation District
No 282.

Chief Engineer
Plans & Estimates

Filed by the Board of
Superior

December 20. 1896

J. W. W. W. W. W.

By George J. Kelly
Deputy

To the Board of Trustees of
Swamp Land District No 282
Union Island San Joaquin County
California

Gentlemen

They leave to report
to you that I have surveyed and located
the lines of levee necessary to the reclamation
of the lands embraced within your
district, and I herewith submit a
Map of the same, with the following
plan of the form and size of the
proposed levees

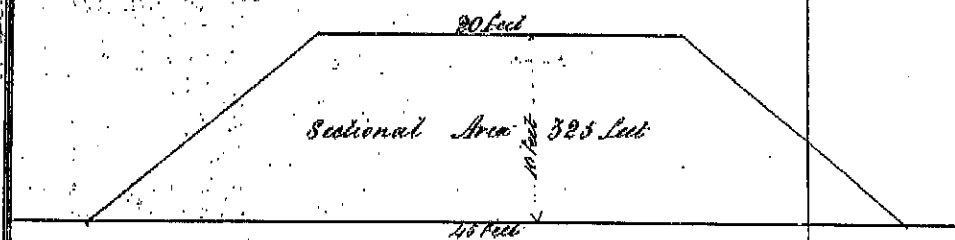

Section of Tule Sod Levee

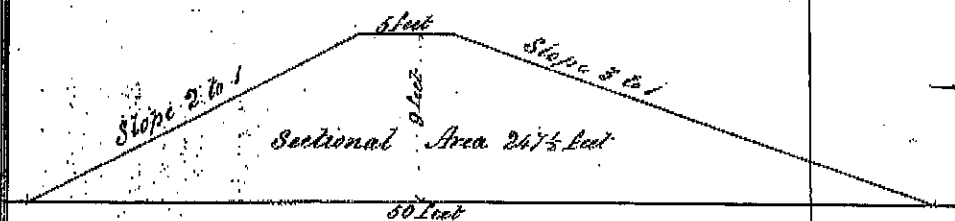

Section of Dry Earth Levee

The plan contemplates joining the levee of District No 62 at each end thereof, as I am informed you have arranged with the owners of the lands in that District to make such union -

On the general line of the Levees of your District I found twenty one sloughs, besides a number of cuts and depressions, which it is necessary shall be dammed and filled up, to make the reclamation complete; it is also intended to place flood gates at most of these sloughs.

I submit the following estimate of the cost of the reclamation of said District on the plan heretofore mentioned as adopted by the board of Trustees -

Description and Location	No of Yards	Price per Yard	\$	cts
Crest Levee on the North boundary of the District				
2 Miles and 1940 feet of Levee	130,363	20cts	30,072	60
Add 30 per cent for shrinkage	45,109	" "	9,021	80
			39,094	40

Swamp Land District No. 282

Description and Location	No. of yards	Price per yard	\$	cts
<u>Division No 1</u>				
On Old River from the Croft Levee to the Northern boundary of the Recadero Rancho				
13 Miles of Levee	727,090	20 cts	145,418	
Add 30 per cent. for shrinkage	218,127	" "	43,625	40
16 Dams	24,696	25 "	6,174	
4 Large flood gates			2,289	
14 Smaller flood gates			5,802	
			203,308	40
<u>Division No 2</u>				
On Old River being the Southern boundary of the District				
18 Miles of Levee	422,388	15 cts	63,358	20
30 Dams	45,000	" "	6,750	
			70,108	20

Swamp Land District No. 282

Description and location	No of yards	Price per yard	\$	cts
Division No 3 on Middle River 4 Miles of Levee	503.370	20 cts	100.674	
Add 30 per cent for shrinkage	151.011	" "	30.202	20
5 Dams	28.868	25 "	7.217	
3 Large flood gates			1.741	
3 Smaller flood gates			1.298	
			141.132	20
<u>Recapitulation</u>				
Crest Levee			39.094	40
Division No 1			203.308	40
Division No 2			70.108	20
Division No 3			141.132	20
			453.643	20
Engineering Supervision and incidental expenses (10 per cent)			45.364	30
<u>Total</u>			499.007	50

All of which is respectfully submitted

John Wallace
Chief Engineer

Swamp Land District No. 282

San Joaquin County
California