

Exhibit “2”

PRIMARY [Amended]
APPLICATION FOR PERMISSION TO CHANGE POINT OF DIVERSION, MANNER
OF USE AND PLACE OF USE OF THE PUBLIC WATERS
OF THE STATE OF NEVADA HERETOFORE APPROPRIATED

THIS SPACE FOR OFFICE USE ONLY
Date of filing in State Engineer's Office... FEB 19 2009
Returned to applicant for correction...
Corrected application filed... Map filed FEB 26 2009

The applicant... CITY OF FERNLEY

595 SILVER LACE BLVD... of FERNLEY, NEVADA 89408
Street and No. Or P.O. Box No City or Town

hereby makes... application for permission to change the...

X Point of diversion [X] Place of use [X] Manner of use [] Of a portion

of water heretofore appropriated under Permit 56226
Identify existing right by Permit, Certificate, Proof or Claim Nos. If Decreed, give title of Decree identify right in Decree.

1. The source of water is... TRUCKEE RIVER
Name of stream, lake, underground, spring or other sources.

2. The amount of water to be changed... 207.67 ac-ft
feet, acre-feet. One second foot equals 448.83 gallons per minute.

3. The water to be used for... STORAGE WITH SECONDARY PERMITS FOR
BENEFICIAL USES ALLOWED BY THE TRUCKEE RIVER OPERATING
AGREEMENT
Irrigation, power, mining, commercial, etc. If for stock state number and kind of animals. Must limit to one major use.

4. The water heretofore used for... MUNICIPAL & DOMESTIC
If for stock state number and kind of animals.

5. The water is to be diverted at the following SEE ATTACHMENT "A"
Describe as being within a 40-acre subdivision of public survey and by course and distance to a section corner. If on unsurveyed land,
it should be stated.

6. The existing point of diversion is located within... Derby Dam being located in N1/2
SW1/4, Section 19, T.20N., R.23E., MDB&M...
If point of diversion is not changed, do not answer.

7. Proposed place of use... The beneficial place of use will be set forth in applications for
secondary permits consistent with the Truckee River Operating Agreement. The water
stored under this Primary Application will be in the Lake Tahoe, Boca Reservoir,
Donner Reservoir, Stampede Reservoir, Prosser Creek Reservoir, Derby Dam, and the
City of Fernley Water Treatment Facility...
Describe by legal subdivisions. If for irrigation state number of acres to be irrigated.

- 8. Existing place of use...**See Attachment "B" and map filed with application 56226**
Describe by legal subdivisions. If permit is for irrigation, state number of acres irrigated. If changing place of use and/or manner of use of irrigation permit, describe acreage to be removed from irrigation.
- 9. Use will be from.....**1/1**.....to.....**12/31**.....of each year.
Month and Day Month and Day
- 10. Use permitted from.....**1/1 to 12/31**.....
- 11. Description of proposed works. (Under the provision of NRS 535.010 you may be required to submit plans and specifications of your diversion or storage works.).... **The Reservoirs and Diversion Works for Lake Tahoe, Boca Reservoir, Donner Reservoir, Stampede Reservoir, Prosser Creek Reservoir and Derby Dam are Complete. The City of Fernley Water Treatment Facility is currently under Construction.**
State manner in which water is to be diverted, i.e. diversion structure, ditches, pipes and flumes or drilled well, pump and motor, etc.
- 12. Estimated cost of works.....**\$50,000,000**.....
- 13. Estimated time required to construct works.....**2.0 YEAR**.....
If well completed, describe well.
- 14. Estimated time required to complete the application of water to beneficial use...**N/A**...
- 15. Remarks: **SEE REMARKS IN ATTACHMENT "C"**.....

(775) 784-9920

Phone No.

By:.....**Lowell Patton, Director, City of Fernley Public Works Department**.....

Print of type name clearly

Signature, applicant or agent

.....**595 Silver Lace Blvd**.....

Street and No., or P.O. Box No.

.....**Fernley, NV 89408**.....

City, State, Zip Code

APPLICATION MUST BE SIGNED BY THE APPLICANT OR AGENT

\$150 FILING FEE MUST ACCOMPANY APPLICATION

2009 FEB 26 09:11:41
STATE ENGINEER'S OFFICE

Protested: May 5, 2009, by the Pyramid Lake Paiute Tribe of Indians; May 8, 2009, by Churchill County

Attachment "A"

The Proposed Points of Diversion are shown on the map filed with Application:

Lake Tahoe:

Within the NE $\frac{1}{4}$ of the NW $\frac{1}{4}$ of Section 7, T. 15N., R. 17E., M.D.M., or from the Dam the southwest corner of said Section 7 bears South $29^{\circ} 09' 30''$ West a distance of 5,182 feet, more or less. The capacity of Lake Tahoe is approximately 744,600 AF.

Donner Lake:

Within the SE $\frac{1}{4}$ of the NE $\frac{1}{4}$ of Section 18, T. 17N., R. 16E., M.D.M., or from the Dam the Southeast corner of said Section 18 bears South $04^{\circ} 07' 14''$ East a distance of 2,981 feet, more or less. The capacity of Donner Lake is 9,500 AF.

Prosser Creek Dam (Reservoir):

Within the NW $\frac{1}{4}$ of the SW $\frac{1}{4}$ of Section 30, T. 18N., R. 17E., M.D.M., or from the Dam the Southeast corner of said Section 30 bears South $22^{\circ} 58' 48''$ West a distance of 2,006 feet, more or less. The capacity of Prosser Creek Reservoir is approximately 29,840 AF.

Boca Dam (Reservoir):

Within the SE $\frac{1}{4}$ of the SW $\frac{1}{4}$ of Section 21, T. 18N., R. 17E., M.D.M., or from the Dam the Southwest corner of said Section 21 bears South $81^{\circ} 05' 07''$ West a distance of 2,647 feet, more or less. The capacity of Boca Reservoir is approximately 40,870 AF.

Stampede Dam (Reservoir)

Within the NW $\frac{1}{4}$ of the NW $\frac{1}{4}$ of Section 28, T. 19N., R. 17E., M.D.M., or from the Dam the Northwest corner of said Section 28 bears North $36^{\circ} 08' 27''$ West a distance of 636 feet, more or less. The capacity of Stampede Reservoir is approximately 226,500 AF.

Derby Dam:

Within the N $\frac{1}{2}$ of the SW $\frac{1}{4}$ of Section 19, T. 20N., R. 23E., M.D.M.

~~7. Proposed Place of Use~~ Existing Place of Use Permit 56226

T20N, R24E, N.D.B. & M.

Portion Sections 9 and 10, Sections 11, 12, 13, 14 and 15,
Portion Sections 16, 17 and 20, Sections 21, 22, 23, 24, 25,
26, 27 and 28, Portion Sections 29, 30 and 31, Sections 32,
33, 34, 35 and 36.

T20N, R25E, N.D.B. & M.

Sections 1, 2 and 3, Portion Sections 4 and 5, Sections 7
through 36.

T20N, R26E, N.D.B. & M.

Portion Section 5, Sections 6 and 7, Portion of Section 8 and
17, Sections 18 and 19, Portion Section 20 and 29, Sections
30 and 31, Portion Section 32.

T21N, R25E, N.D.B. & M.

Portion Sections 13, 23 and 24, Section 25, Portion Section
26, 27, 28 and 33, Sections 34, 35 and 36.

T21N, R26E, N.D.B. & M.

Portion Sections 5, 7 and 8, Section 17, Portion Section 18,
Section 19, 20, 29, 30, 31 and 32.

T22N, R26E, N.D.B. & M.

Portion of Sections 28, 32 and 33.

T19N, R25E, N.D.B. & M.

All Sections 1 through 36

T19N, R24E, N.D.B. & M.

Sections 1, 2, 3, 4, and 5, Portion Section 6, Sections 7
through 36.

T19N, R23E, N.D.B. & M.

Portion Sections 1, 12, 13, 14 and 23, Sections 24 and 25,
Portion Sections 26, 27 and 34, Sections 35 and 36.

Attachment "C"

15. Remarks

This application is filed pursuant to the provisions of N.R.S §533.515 in that it seeks to add the reservoirs described in Attachment "A" and as listed in Item 11 above as additional points of diversion for the water rights described herein. This application is also filed as part of the implementation of the operating agreement described in Section 205 (a) of Public Law 101-618. Because of the provisions of California Water Code section 1231 and 1232, California will recognize any permits issued by the Nevada State Engineer based upon this application. Therefore, it is within the jurisdiction of the Nevada State Engineer to approve this application allowing for the storage of the consumptive use component of these Nevada water rights in California.

Water diverted to storage under a permit issued hereunder will be and is the subject of applications for secondary permits for beneficial uses allowed by the Truckee River Operating Agreement at the places allowed by that Agreement. The amount of water diverted to storage under a permit issued hereunder in any one year will not be less than the full permitted duty of 4.5 AF per year. The amount of water under a permit issued hereunder which may be in storage at any one time and which may be released and used from storage in any one year will not exceed the amounts allowed by the Truckee River Operating Agreement.

If the water right described herein is not diverted to storage, the full duty of the water right will continue to be diverted at its allowed points of diversion for its manner of use.

**PRIMARY
APPLICATION FOR PERMISSION TO CHANGE POINT OF DIVERSION, MANNER
OF USE AND PLACE OF USE OF THE PUBLIC WATERS
OF THE STATE OF NEVADA HERETOFORE APPROPRIATED**

THIS SPACE FOR OFFICE USE ONLY

Date of filing in State Engineer's Office... **APR 20 2009**

Returned to applicant for correction.....

Corrected application filed..... Map filed **FEB 26 2009** under **78034**

The applicant..... **CITY OF FERNLEY**

..... **595 SILVER LACE BLVD** of **FERNLEY** .., NEVADA **89408**

Street and No. Or P.O. Box No

City or Town

hereby makes... application for permission to change the.....

Point of diversion Place of use Manner of use Of a portion

of water heretofore appropriated under **Permit 74503**.....
Identify existing right by Permit, Certificate, Proof or Claim Nos. If Decreed, give title of Decree identify right in Decree.

1. The source of water is..... **TRUCKEE RIVER**.....
Name of stream, lake, underground, spring or other sources.
2. The amount of water to be changed..... **93.83 ac-ft**.....
feet, acre-feet. One second foot equals 448.83 gallons per minute.
3. The water to be used for..... **STORAGE WITH SECONDARY PERMITS FOR BENEFICIAL USES ALLOWED BY THE TRUCKEE RIVER OPERATING AGREEMENT**
Irrigation, power, mining, commercial, etc. If for stock state number and kind of animals. Must limit to one major use.
4. The water heretofore used for..... **MUNICIPAL & DOMESTIC**.....
If for stock state number and kind of animals.
5. The water is to be diverted at the following **SEE ATTACHMENT "A"**.....
Describe as being within a 40-acre subdivision of public survey and by course and distance to a section corner. If on unsurveyed land, it should be stated.
6. The existing point of diversion is located within... **Derby Dam being located in N1/2 SW1/4, Section 19, T.20N., R.23E., MDB&M...**
If point of diversion is not changed, do not answer.
7. Proposed place of use..... **The beneficial place of use will be set forth in applications for secondary permits consistent with the Truckee River Operating Agreement. The water stored under this Primary Application will be in the Lake Tahoe, Boca Reservoir, Donner Reservoir, Stampede Reservoir, Prosser Creek Reservoir, Derby Dam, and the City of Fernley Water Treatment Facility**.....
Describe by legal subdivisions. If for irrigation state number of acres to be irrigated.

sk-w-a

78338
Map under
71382 mm
4/24/09
74503 okay

8. Existing place of use...**See Attachment "B" and map filed with application** 74503
Describe by legal subdivisions. If permit is for irrigation, state number of acres irrigated. If changing place of use and/or manner of use of irrigation permit, describe acreage to be removed from irrigation.

9. Use will be from.....**1/1**.....to.....**12/31**.....of each year.
Month and Day Month and Day

10. Use permitted from.....**1/1 to 12/31**.....

11. Description of proposed works. (Under the provision of NRS 535.010 you may be required to submit plans and specifications of your diversion or storage works.).... **The Reservoirs and Diversion Works for Lake Tahoe, Boca Reservoir, Donner Reservoir, Stampede Reservoir, Prosser Creek Reservoir and Derby Dam are Complete. The City of Fernley Water Treatment Facility is currently under Construction**.....
State manner in which water is to be diverted, i.e. diversion structure, ditches, pipes and flumes or drilled well, pump and motor, etc.

12. Estimated cost of works.....**\$50,000,000**.....

13. Estimated time required to construct works.....**2.0 YEAR**.....
If well completed, describe well.

14. Estimated time required to complete the application of water to beneficial use...N/A...

15. Remarks: **SEE REMARKS IN ATTACHMENT "C"**

(775) 784-9920

Phone No.

By:.....**Lowell Patton, Director, City of Fernley Public Works Department**.....

Print or type name clearly

.....
Signature, applicant or agent

.....**595 Silver Lace Blvd**.....

Street and No., or P.O. Box No.

.....**Fernley, NV 89408**

City, State, Zip Code

APPLICATION MUST BE SIGNED BY THE APPLICANT OR AGENT

\$150 FILING FEE MUST ACCOMPANY APPLICATION

RECEIVED
2009 APR 20 PM 1:40
STATE ENGINEERS OFFICE

Attachment "A"

The Proposed Points of Diversion are shown on the map filed with Application: 78034

Lake Tahoe:

Within the NE $\frac{1}{4}$ of the NW $\frac{1}{4}$ of Section 7, T. 15N., R. 17E., M.D.M., or from the Dam the southwest corner of said Section 7 bears South $29^{\circ} 09' 30''$ West a distance of 5,182 feet, more or less. The capacity of Lake Tahoe is approximately 744,600 AF.

Donner Lake:

Within the SE $\frac{1}{4}$ of the NE $\frac{1}{4}$ of Section 18, T. 17N., R. 16E., M.D.M., or from the Dam the Southeast corner of said Section 18 bears South $04^{\circ} 07' 14''$ East a distance of 2,981 feet, more or less. The capacity of Donner Lake is 9,500 AF.

Prosser Creek Dam (Reservoir):

Within the NW $\frac{1}{4}$ of the SW $\frac{1}{4}$ of Section 30, T. 18N., R. 17E., M.D.M., or from the Dam the Southeast corner of said Section 30 bears South $22^{\circ} 58' 48''$ West a distance of 2,006 feet, more or less. The capacity of Prosser Creek Reservoir is approximately 29,840 AF.

Boca Dam (Reservoir):

Within the SE $\frac{1}{4}$ of the SW $\frac{1}{4}$ of Section 21, T. 18N., R. 17E., M.D.M., or from the Dam the Southwest corner of said Section 21 bears South $81^{\circ} 05' 07''$ West a distance of 2,647 feet, more or less. The capacity of Boca Reservoir is approximately 40,870 AF.

Stampede Dam (Reservoir)

Within the NW $\frac{1}{4}$ of the NW $\frac{1}{4}$ of Section 28, T. 19N., R. 17E., M.D.M., or from the Dam the Northwest corner of said Section 28 bears North $36^{\circ} 08' 27''$ West a distance of 636 feet, more or less. The capacity of Stampede Reservoir is approximately 226,500 AF.

Derby Dam:

Within the N $\frac{1}{2}$ of the SW $\frac{1}{4}$ of Section 19, T. 20N., R. 23E., M.D.M.

ATTACHMENT B

PROPOSED PLACE OF USE:

T.19N, R.23E. M.D.B.&M.

Portion of sections 1, 12, 13, 14, and 23, sections 24 and 25;
Portions of sections 26, 27, and 34, sections 35 and 36.

T.19N, R.24E. M.D.B.&M.

Sections 1, 2, 3, 4, and 5.
Portion of section 6, sections 7 through 36.

T.19N, R.25E. M.D.B.&M.

All of sections 1 through 36.

T.20N, R.24E. M.D.B.&M.

Portion of sections 9 and 10, sections 11, 12, 13, 14, and 15;
Portion of sections 16, 17, and 20, sections 21, 22, 23, 24, 26, 27, and 28;
Portion of sections 29, 30, and 31, sections 32, 33, 34, 35, and 36.

T.20N, R.25E. M.D.B.&M.

Sections 1, 2, and 3;
Portion of sections 4 and 5, sections 7 through 36.

T.20N, R.26E. M.D.B.&M.

Portion of section 5, sections 6 and 7;
Portion of sections 8 and 17, sections 18 and 19;
Portions of sections 20 and 28, sections 30 and 31;
Portion of section 32.

T.21N, R.25E. M.D.B.&M.

Portion of sections 13, 23, and 24, section 25;
Portion of sections 26, 27, 28, and 33, sections 34, 35, and 36.

T.21N, R.26E. M.D.B.&M.

Portion of sections 6, 7, and 8, section 17;
Portion of section 18, sections 19, 20, 29, 30, 31, and 32.

T.22N, R.26E. M.D.B.&M.

Portion of sections 28, 32, and 33.

Attachment "C"**15. Remarks**

This application is filed pursuant to the provisions of N.R.S §533.515 in that it seeks to add the reservoirs described in Attachment "A" and as listed in Item 11 above as additional points of diversion for the water rights described herein. This application is also filed as part of the implementation of the operating agreement described in Section 205 (a) of Public Law 101-618. Because of the provisions of California Water Code section 1231 and 1232, California will recognize any permits issued by the Nevada State Engineer based upon this application. Therefore, it is within the jurisdiction of the Nevada State Engineer to approve this application allowing for the storage of the consumptive use component of these Nevada water rights in California.

Water diverted to storage under a permit issued hereunder will be and is the subject of applications for secondary permits for beneficial uses allowed by the Truckee River Operating Agreement at the places allowed by that Agreement. The amount of water diverted to storage under a permit issued hereunder in any one year will not be less than the full permitted duty of 4.5 AF per year. The amount of water under a permit issued hereunder which may be in storage at any one time and which may be released and used from storage in any one year will not exceed the amounts allowed by the Truckee River Operating Agreement.

If the water right described herein is not diverted to storage, the full duty of the water right will continue to be diverted at its allowed points of diversion for its manner of use.

**PRIMARY
APPLICATION FOR PERMISSION TO CHANGE POINT OF DIVERSION, MANNER
OF USE AND PLACE OF USE OF THE PUBLIC WATERS
OF THE STATE OF NEVADA HERETOFORE APPROPRIATED**

THIS SPACE FOR OFFICE USE ONLY

Date of filing in State Engineer's Office..... **APR 20 2009**

Returned to applicant for correction.....

Corrected application filed.....Map filed **FEB 26 2009** under **78034**

The applicant.....**CITY OF FERNLEY**.....

.....**595 SILVER LACE BLVD**.....of.....**FERNLEY**..., NEVADA **89408**.....
Street and No. Or P.O. Box No City or Town

hereby makes... application for permission to change the.....

Point of diversion Place of use Manner of use Of a portion

of water heretofore appropriated under **Permit 74482**.....
Identify existing right by Permit, Certificate, Proof or Claim Nos. If Decreed, give title of Decree identify right in Decree.

1. The source of water is.....**TRUCKEE RIVER**.....
Name of stream, lake, underground, spring or other sources.

2. The amount of water to be changed.....**52.47 ac-ft**.....
feet, acre-feet. One second foot equals 448.83 gallons per minute.

3. The water to be used for.....**STORAGE WITH SECONDARY PERMITS FOR
BENEFICIAL USES ALLOWED BY THE TRUCKEE RIVER OPERATING
AGREEMENT**
Irrigation, power, mining, commercial, etc. If for stock state number and kind of animals. Must limit to one major use.

4. The water heretofore used for.....**MUNICIPAL & DOMESTIC**.....
If for stock state number and kind of animals.

5. The water is to be diverted at the following **SEE ATTACHMENT "A"**.....
Describe as being within a 40-acre subdivision of public survey and by course and distance to a section corner. If on unsurveyed land, it should be stated.

6. The existing point of diversion is located within... **Derby Dam being located in N1/2
SW1/4, Section 19, T.20N., R.23E., MDB&M...**
If point of diversion is not changed, do not answer.

7. Proposed place of use.....**The beneficial place of use will be set forth in applications for
secondary permits consistent with the Truckee River Operating Agreement. The water
stored under this Primary Application will be in the Lake Tahoe, Boca Reservoir,
Donner Reservoir, Stampede Reservoir, Prosser Creek Reservoir, Derby Dam, and the
City of Fernley Water Treatment Facility**.....
Describe by legal subdivisions. If for irrigation state number of acres to be irrigated.

78339

(map 71382)

- 8. Existing place of use...**See Attachment "B" and map filed with application 74482** *OK*
Describe by legal subdivisions. If permit is for irrigation, state number of acres irrigated. If changing place of use and/or manner of use of irrigation permit, describe acreage to be removed from irrigation.
- 9. Use will be from.....1/1.....to.....12/31.....of each year.
Month and Day Month and Day
- 10. Use permitted from.....1/1 to 12/31.....
- 11. Description of proposed works. (Under the provision of NRS 535.010 you may be required to submit plans and specifications of your diversion or storage works.)... **The Reservoirs and Diversion Works for Lake Tahoe, Boca Reservoir, Donner Reservoir, Stampede Reservoir, Prosser Creek Reservoir and Derby Dam are Complete. The City of Fernley Water Treatment Facility is currently under Construction.**.....
State manner in which water is to be diverted, i.e. diversion structure, ditches, pipes and flumes or drilled well, pump and motor, etc.
- 12. Estimated cost of works.....**\$50,000,000**.....
- 13. Estimated time required to construct works.....**2.0 YEAR**.....
If well completed, describe well.
- 14. Estimated time required to complete the application of water to beneficial use...**N/A**...
- 15. Remarks: **SEE REMARKS IN ATTACHMENT "C"**

(775) 784-9920

Phone No.

By:.....**Lowell Patton, Director, City of Fernley**
Public Works Department.....

Print or type name clearly

.....
Signature, applicant or agent

.....**595 Silver Lace Blvd**.....
Street and No., or P.O. Box No.

.....**Fernley, NV 89408**.....
City, State, Zip Code

**APPLICATION MUST BE SIGNED
BY THE APPLICANT OR AGENT**

\$150 FILING FEE MUST ACCOMPANY APPLICATION

RECEIVED
2009 APR 20 PM 1:40
STATE ENGINEERS OFFICE

Attachment "A"

The Proposed Points of Diversion are shown on the map filed with Application: 78034

Lake Tahoe:

Within the NE $\frac{1}{4}$ of the NW $\frac{1}{4}$ of Section 7, T. 15N., R. 17E., M.D.M., or from the Dam the southwest corner of said Section 7 bears South $29^{\circ} 09' 30''$ West a distance of 5,182 feet, more or less. The capacity of Lake Tahoe is approximately 744,600 AF.

Donner Lake:

Within the SE $\frac{1}{4}$ of the NE $\frac{1}{4}$ of Section 18, T. 17N., R. 16E., M.D.M., or from the Dam the Southeast corner of said Section 18 bears South $04^{\circ} 07' 14''$ East a distance of 2,981 feet, more or less. The capacity of Donner Lake is 9,500 AF.

Prosser Creek Dam (Reservoir):

Within the NW $\frac{1}{4}$ of the SW $\frac{1}{4}$ of Section 30, T. 18N., R. 17E., M.D.M., or from the Dam the Southeast corner of said Section 30 bears South $22^{\circ} 58' 48''$ West a distance of 2,006 feet, more or less. The capacity of Prosser Creek Reservoir is approximately 29,840 AF.

Boca Dam (Reservoir):

Within the SE $\frac{1}{4}$ of the SW $\frac{1}{4}$ of Section 21, T. 18N., R. 17E., M.D.M., or from the Dam the Southwest corner of said Section 21 bears South $81^{\circ} 05' 07''$ West a distance of 2,647 feet, more or less. The capacity of Boca Reservoir is approximately 40,870 AF.

Stampede Dam (Reservoir)

Within the NW $\frac{1}{4}$ of the NW $\frac{1}{4}$ of Section 28, T. 19N., R. 17E., M.D.M., or from the Dam the Northwest corner of said Section 28 bears North $36^{\circ} 08' 27''$ West a distance of 636 feet, more or less. The capacity of Stampede Reservoir is approximately 226,500 AF.

Derby Dam:

Within the N $\frac{1}{2}$ of the SW $\frac{1}{4}$ of Section 19, T. 20N., R. 23E., M.D.M.

ATTACHMENT B

78339

78339

T. 20 N. E. 24 E. MDB. & M.

Portions of Sections 9 and 10; Sections 11, 12, 13, 14 and 15; Portions of Sections 16, 17 and 20, Section 21, 22, 23, 24, 25, 26, 27 and 28; Portions of Sections 29, 30, 31, Sections 32, 33, 34, 35 and 36.

T. 20 N. E. 25 E. MDB. & M.

Sections 1, 2 and 3; Portions of Sections 4 and 5, Sections 7 through 36

T. 20 N. E. 26 E. MDB. & M.

Portion of Section 5, Sections 6 and 7; Portion of Sections 8 and 17, Sections 18 and 19; Portion of Sections 20 and 29, Sections 30 and 31; Portions of Section 32.

T. 21 N. E. 25 E. MDB. & M.

Portion of Sections 13, 23 and 24, Section 25; Portion of Sections 26, 27, 28 and 33, Sections 34, 35 and 36.

T. 21 N. E. 26 E. MDB. & M.

Portions of Sections 5, 7 and 8, Section 17; Portion of Section 18, Sections 19, 20, 29, 30, 31 and 32.

T. 22 N. E. 26 E. MDB. & M.

Portions of Sections 28, 32 and 33.

T. 19 N. E. 25 E. MDB. & M.

All of Sections 1 through 36

T. 19 N. E. 24 E. MDB. & M.

Sections 1, 2, 3, 4 and 5; Portion of Section 6, Sections 7 through 36.

T. 19 N. E. 23 E. MDB. & M.

Portions of Sections 1, 12, 13, 14 and 23, Sections 24 and 25; Portion of Sections 26, 27 and 34, Sections 35 and 36.

2005 JUL -6 11:30 AM

Attachment "C"

15. Remarks

This application is filed pursuant to the provisions of N.R.S §533.515 in that it seeks to add the reservoirs described in Attachment "A" and as listed in Item 11 above as additional points of diversion for the water rights described herein. This application is also filed as part of the implementation of the operating agreement described in Section 205 (a) of Public Law 101-618. Because of the provisions of California Water Code section 1231 and 1232, California will recognize any permits issued by the Nevada State Engineer based upon this application. Therefore, it is within the jurisdiction of the Nevada State Engineer to approve this application allowing for the storage of the consumptive use component of these Nevada water rights in California.

Water diverted to storage under a permit issued hereunder will be and is the subject of applications for secondary permits for beneficial uses allowed by the Truckee River Operating Agreement at the places allowed by that Agreement. The amount of water diverted to storage under a permit issued hereunder in any one year will not be less than the full permitted duty of 4.5 AF per year. The amount of water under a permit issued hereunder which may be in storage at any one time and which may be released and used from storage in any one year will not exceed the amounts allowed by the Truckee River Operating Agreement.

If the water right described herein is not diverted to storage, the full duty of the water right will continue to be diverted at its allowed points of diversion for its manner of use.

**PRIMARY
APPLICATION FOR PERMISSION TO CHANGE POINT OF DIVERSION, MANNER
OF USE AND PLACE OF USE OF THE PUBLIC WATERS
OF THE STATE OF NEVADA HERETOFORE APPROPRIATED**

THIS SPACE FOR OFFICE USE ONLY	
Date of filing in State Engineer's Office.....	APR 20 2009
Returned to applicant for correction.....	
Corrected application filed.....	Map filed FEB 26 2009 under 78034

The applicant.....**CITY OF FERNLEY**.....

.....**595 SILVER LACE BLVD**.....of.....**FERNLEY**....., NEVADA **89408**.....
Street and No. Or P.O. Box No City or Town

hereby makes... application for permission to change the.....

Point of diversion Place of use Manner of use Of a portion

of water heretofore appropriated under **..Permit 74481**.....
Identify existing right by Permit, Certificate, Proof or Claim Nos. If Decreed, give title of Decree identify right in Decree.

- The source of water is.....**TRUCKEE RIVER**.....
Name of stream, lake, underground, spring or other sources.
- The amount of water to be changed.....**328.32 ac-ft**.....
feet, acre-feet. One second foot equals 448.83 gallons per minute.
- The water to be used for.....**STORAGE WITH SECONDARY PERMITS FOR BENEFICIAL USES ALLOWED BY THE TRUCKEE RIVER OPERATING AGREEMENT**
Irrigation, power, mining, commercial, etc. If for stock state number and kind of animals. Must limit to one major use.
- The water heretofore used for.....**MUNICIPAL & DOMESTIC**.....
If for stock state number and kind of animals.
- The water is to be diverted at the following **SEE ATTACHMENT "A"**.....
Describe as being within a 40-acre subdivision of public survey and by course and distance to a section corner. If on unsurveyed land, it should be stated.
- The existing point of diversion is located within... **Derby Dam being located in N1/2 SW1/4, Section 19, T.20N., R.23E., MDB&M...**
If point of diversion is not changed, do not answer.
- Proposed place of use.....**The beneficial place of use will be set forth in applications for secondary permits consistent with the Truckee River Operating Agreement. The water stored under this Primary Application will be in the Lake Tahoe, Boca Reservoir, Donner Reservoir, Stampede Reservoir, Prosser Creek Reservoir, Derby Dam, and the City of Fernley Water Treatment Facility.**.....
Describe by legal subdivisions. If for irrigation state number of acres to be irrigated.

8. Existing place of use...**See Attachment "B" and map filed with application 74481**
Describe by legal subdivisions. If permit is for irrigation, state number of acres irrigated. If changing place of use and/or manner of use of irrigation permit, describe acreage to be removed from irrigation. (See Map 71382)

9. Use will be from.....1/1.....to.....12/31.....of each year.
Month and Day Month and Day

10. Use permitted from.....1/1 to 12/31.....

11. Description of proposed works. (Under the provision of NRS 535.010 you may be required to submit plans and specifications of your diversion or storage works.).... **The Reservoirs and Diversion Works for Lake Tahoe, Boca Reservoir, Donner Reservoir, Stampede Reservoir, Prosser Creek Reservoir and Derby Dam are Complete. The City of Fernley Water Treatment Facility is currently under Construction.**
State manner in which water is to be diverted, i.e. diversion structure, ditches, pipes and flumes or drilled well, pump and motor, etc.

12. Estimated cost of works.....\$50,000,000.....

13. Estimated time required to construct works.....2.0 YEAR.....
If well completed, describe well.

14. Estimated time required to complete the application of water to beneficial use...N/A...

15. Remarks: **SEE REMARKS IN ATTACHMENT "C"**

(775) 784-9920

Phone No.

By:.....**Lowell Patton, Director, City of Fernley Public Works Department**.....
Print or type name clearly

.....
Signature, applicant or agent

.....**595 Silver Lace Blvd**.....
Street and No., or P.O. Box No.

.....**Fernley, NV 89408**.....
City, State, Zip Code

APPLICATION MUST BE SIGNED BY THE APPLICANT OR AGENT

RECEIVED
2009 APR 20 PM 1:41
STATE ENGINEERS OFFICE

\$150 FILING FEE MUST ACCOMPANY APPLICATION

Attachment "A"

The Proposed Points of Diversion are shown on the map filed with Application: 78034

Lake Tahoe:

Within the NE $\frac{1}{4}$ of the NW $\frac{1}{4}$ of Section 7, T. 15N., R. 17E., M.D.M., or from the Dam the southwest corner of said Section 7 bears South $29^{\circ} 09' 30''$ West a distance of 5,182 feet, more or less. The capacity of Lake Tahoe is approximately 744,600 AF.

Donner Lake:

Within the SE $\frac{1}{4}$ of the NE $\frac{1}{4}$ of Section 18, T. 17N., R. 16E., M.D.M., or from the Dam the Southeast corner of said Section 18 bears South $04^{\circ} 07' 14''$ East a distance of 2,981 feet, more or less. The capacity of Donner Lake is 9,500 AF.

Prosser Creek Dam (Reservoir):

Within the NW $\frac{1}{4}$ of the SW $\frac{1}{4}$ of Section 30, T. 18N., R. 17E., M.D.M., or from the Dam the Southeast corner of said Section 30 bears South $22^{\circ} 58' 48''$ West a distance of 2,006 feet, more or less. The capacity of Prosser Creek Reservoir is approximately 29,840 AF.

Boca Dam (Reservoir):

Within the SE $\frac{1}{4}$ of the SW $\frac{1}{4}$ of Section 21, T. 18N., R. 17E., M.D.M., or from the Dam the Southwest corner of said Section 21 bears South $81^{\circ} 05' 07''$ West a distance of 2,647 feet, more or less. The capacity of Boca Reservoir is approximately 40,870 AF.

Stampede Dam (Reservoir)

Within the NW $\frac{1}{4}$ of the NW $\frac{1}{4}$ of Section 28, T. 19N., R. 17E., M.D.M., or from the Dam the Northwest corner of said Section 28 bears North $36^{\circ} 08' 27''$ West a distance of 636 feet, more or less. The capacity of Stampede Reservoir is approximately 226,500 AF.

Derby Dam:

Within the N $\frac{1}{2}$ of the SW $\frac{1}{4}$ of Section 19, T. 20N., R. 23E., M.D.M.

ATTACHMENT B

78340

T. 20 N. E. 24 E. M.D.B. & M.

Portions of Sections 9 and 10, Sections 11, 12, 13, 14 and 15; Portion of Sections 16, 17 and 20, Section 21, 22, 23, 24, 25, 26, 27 and 28; Portions of Sections 29, 30, 31, Sections 32, 33, 34, 35 and 36.

T. 20 N. E. 25 E. M.D.B. & M.

Sections 1, 2 and 3; Portions of Sections 4 and 5, Sections 7 through 36

T. 20 N. E. 26 E. M.D.B. & M.

Portion of Section 5, Sections 6 and 7; Portion of Sections 8 and 17, Sections 18 and 19; Portion of Sections 20 and 29, Sections 30 and 31; Portions of Section 32.

T. 21 N. E. 25 E. M.D.B. & M.

Portion of Sections 13, 23 and 24, Section 25; Portion of Sections 26, 27, 28 and 33, Sections 34, 35 and 36.

T. 21 N. E. 26 E. M.D.B. & M.

Portions of Sections 5, 7 and 8, Section 17; Portion of Section 18, Sections 19, 20, 29, 30, 31 and 32.

T. 22 N. E. 26 E. M.D.B. & M.

Portions of Sections 28, 32 and 33.

T. 19 N. E. 24 E. M.D.B. & M.

All of Sections 1 through 36

T. 19 N. E. 24 E. M.D.B. & M.

Sections 1, 2, 3, 4 and 5; Portion of Section 6, Sections 7 through 36.

T. 19 N. E. 23 E. M.D.B. & M.

Portions of Sections 1, 12, 13, 14 and 23, Sections 24 and 25; Portion of Sections 26, 27 and 34, Sections 35 and 36.

2006 JUL -6 PM 3:34
STATE OF MICHIGAN

Attachment "C"

15. Remarks

This application is filed pursuant to the provisions of N.R.S §533.515 in that it seeks to add the reservoirs described in Attachment "A" and as listed in Item 11 above as additional points of diversion for the water rights described herein. This application is also filed as part of the implementation of the operating agreement described in Section 205 (a) of Public Law 101-618. Because of the provisions of California Water Code section 1231 and 1232, California will recognize any permits issued by the Nevada State Engineer based upon this application. Therefore, it is within the jurisdiction of the Nevada State Engineer to approve this application allowing for the storage of the consumptive use component of these Nevada water rights in California.

Water diverted to storage under a permit issued hereunder will be and is the subject of applications for secondary permits for beneficial uses allowed by the Truckee River Operating Agreement at the places allowed by that Agreement. The amount of water diverted to storage under a permit issued hereunder in any one year will not be less than the full permitted duty of 4.5 AF per year. The amount of water under a permit issued hereunder which may be in storage at any one time and which may be released and used from storage in any one year will not exceed the amounts allowed by the Truckee River Operating Agreement.

If the water right described herein is not diverted to storage, the full duty of the water right will continue to be diverted at its allowed points of diversion for its manner of use.

**PRIMARY
APPLICATION FOR PERMISSION TO CHANGE POINT OF DIVERSION, MANNER
OF USE AND PLACE OF USE OF THE PUBLIC WATERS
OF THE STATE OF NEVADA HERETOFORE APPROPRIATED**

THIS SPACE FOR OFFICE USE ONLY
APR 20 2009
Date of filing in State Engineer's Office.....
Returned to applicant for correction.....
Corrected application filed..... Map filed **FEB 26 2009** under
78034

The applicant.....**CITY OF FERNLEY**.....
.....**595 SILVER LACE BLVD**.....of.....**FERNLEY**..., NEVADA 89408.....
Street and No. Or P.O. Box No City or Town

hereby makes... application for permission to change the.....

Point of diversion Place of use Manner of use Of a portion

of water heretofore appropriated under **Permit 73846**.....
Identify existing right by Permit, Certificate, Proof or Claim Nos. If Decreed, give title of Decree identify right in Decree.

1. The source of water is.....**TRUCKEE RIVER**.....
Name of stream, lake, underground, spring or other sources.

2. The amount of water to be changed.....**68.63 ac-ft**.....
feet, acre-feet. One second foot equals 448.83 gallons per minute.

3. The water to be used for.....**STORAGE WITH SECONDARY PERMITS FOR
BENEFICIAL USES ALLOWED BY THE TRUCKEE RIVER OPERATING
AGREEMENT**
Irrigation, power, mining, commercial, etc. If for stock state number and kind of animals. Must limit to one major use.

4. The water heretofore used for.....**MUNICIPAL & DOMESTIC**.....
If for stock state number and kind of animals.

5. The water is to be diverted at the following **SEE ATTACHMENT "A"**.....
Describe as being within a 40-acre subdivision of public survey and by course and distance to a section corner. If on unsurveyed land, it should be stated.

6. The existing point of diversion is located within... **Derby Dam being located in N1/2
SW1/4, Section 19, T.20N., R.23E., MDB&M...**
If point of diversion is not changed, do not answer.

7. Proposed place of use.....**The beneficial place of use will be set forth in applications for
secondary permits consistent with the Truckee River Operating Agreement. The water
stored under this Primary Application will be in the Lake Tahoe, Boca Reservoir,
Donner Reservoir, Stampede Reservoir, Prosser Creek Reservoir, Derby Dam, and the
City of Fernley Water Treatment Facility**.....
Describe by legal subdivisions. If for irrigation state number of acres to be irrigated.

78341

- 8. Existing place of use...**See Attachment "B" and map filed with application 73846**
Describe by legal subdivisions. If permit is for irrigation, state number of acres irrigated. If changing place of use and/or manner of use of irrigation permit, describe acreage to be removed from irrigation. (SEE MAP 71382) mm 4/22/09 SAN
- 9. Use will be from.....1/1.....to.....12/31.....of each year.
Month and Day Month and Day
- 10. Use permitted from.....1/1 to 12/31.....
- 11. Description of proposed works. (Under the provision of NRS 535.010 you may be required to submit plans and specifications of your diversion or storage works.)... **The Reservoirs and Diversion Works for Lake Tahoe, Boca Reservoir, Donner Reservoir, Stampede Reservoir, Prosser Creek Reservoir and Derby Dam are Complete. The City of Fernley Water Treatment Facility is currently under Construction.**.....
State manner in which water is to be diverted, i.e. diversion structure, ditches, pipes and flumes or drilled well, pump and motor, etc.
- 12. Estimated cost of works.....**\$50,000,000**.....
- 13. Estimated time required to construct works.....**2.0 YEAR**.....
If well completed, describe well.
- 14. Estimated time required to complete the application of water to beneficial use...N/A...
- 15. Remarks: **SEE REMARKS IN ATTACHMENT "C"**.....

(775) 784-9920

Phone No.

By:.....**Lowell Patton, Director, City of Fernley Public Works Department**.....

Print or type name clearly

..........
Signature, applicant or agent

.....**595 Silver Lace Blvd**.....
Street and No., or P.O. Box No.

.....**Fernley, NV 89408**.....
City, State, Zip Code

APPLICATION MUST BE SIGNED BY THE APPLICANT OR AGENT

RECEIVED
2009 APR 20 PM 1:41
STATE ENGINEERS OFFICE

\$150 FILING FEE MUST ACCOMPANY APPLICATION

Attachment "A"

The Proposed Points of Diversion are shown on the map filed with Application: 78034

Lake Tahoe:

Within the NE $\frac{1}{4}$ of the NW $\frac{1}{4}$ of Section 7, T. 15N., R. 17E., M.D.M., or from the Dam the southwest corner of said Section 7 bears South 29° 09' 30" West a distance of 5,182 feet, more or less. The capacity of Lake Tahoe is approximately 744,600 AF.

Donner Lake:

Within the SE $\frac{1}{4}$ of the NE $\frac{1}{4}$ of Section 18, T. 17N., R. 16E., M.D.M., or from the Dam the Southeast corner of said Section 18 bears South 04° 07' 14" East a distance of 2,981 feet, more or less. The capacity of Donner Lake is 9,500 AF.

Prosser Creek Dam (Reservoir):

Within the NW $\frac{1}{4}$ of the SW $\frac{1}{4}$ of Section 30, T. 18N., R. 17E., M.D.M., or from the Dam the Southeast corner of said Section 30 bears South 22° 58' 48" West a distance of 2,006 feet, more or less. The capacity of Prosser Creek Reservoir is approximately 29,840 AF.

Boca Dam (Reservoir):

Within the SE $\frac{1}{4}$ of the SW $\frac{1}{4}$ of Section 21, T. 18N., R. 17E., M.D.M., or from the Dam the Southwest corner of said Section 21 bears South 81° 05' 07" West a distance of 2,647 feet, more or less. The capacity of Boca Reservoir is approximately 40,870 AF.

Stampede Dam (Reservoir)

Within the NW $\frac{1}{4}$ of the NW $\frac{1}{4}$ of Section 28, T. 19N., R. 17E., M.D.M., or from the Dam the Northwest corner of said Section 28 bears North 36° 08' 27" West a distance of 636 feet, more or less. The capacity of Stampede Reservoir is approximately 226,500 AF.

Derby Dam:

Within the N $\frac{1}{2}$ of the SW $\frac{1}{4}$ of Section 19, T. 20N., R. 23E., M.D.M.

ATTACHMENT B

78341

Proposed Place of Use of Change Application

T. 20 N. E. 24 E. M.D.R. & M.

Portions of Sections 9 and 10, Sections 11, 12, 13, 14 and 15; Portion of Sections 16, 17 and 20, Sections 21, 22, 23, 24, 25, 26, 27 and 28; Portions of Sections 29, 30, 31, Sections 32, 33, 34, 35 and 36.

T. 20 N. E. 25 E. M.D.R. & M.

Sections 1, 2 and 3; Portions of Sections 4 and 5, Sections 7 through 36

T. 20 N. E. 26 E. M.D.R. & M.

Portion of Section 3, Sections 6 and 7; Portion of Sections 8 and 17, Sections 18 and 19; Portion of Sections 20 and 29, Sections 30 and 31; Portion of Section 32.

T. 21 N. E. 21 E. M.D.R. & M.

Portion of Sections 13, 23 and 24, Section 25; Portion of Sections 26, 27, 28 and 33, Sections 34, 35 and 36.

T. 21 N. E. 26 E. M.D.R. & M.

Portions of Sections 5, 7 and 8, Section 17; Portion of Section 18, Sections 19, 20, 29, 30, 31 and 32.

T. 22 N. E. 26 E. M.D.R. & M.

Portions of Sections 29, 32 and 33.

T. 18 N. E. 25 E. M.D.R. & M.

All of Sections 1 through 36

T. 19 N. E. 24 E. M.D.R. & M.

Sections 1, 2, 3, 4 and 5; Portion of Section 6, Sections 7 through 36.

T. 19 N. E. 23 E. M.D.R. & M.

Portions of Sections 1, 12, 13, 14 and 23, Sections 24 and 25; Portion of Sections 26, 27 and 34, Sections 35 and 36.

COPY SENT TO: 07/23

RECEIVED
JUL 27 13 PM '14
ST. JOHNS COUNTY

Attachment "C"

15. Remarks

This application is filed pursuant to the provisions of N.R.S §533.515 in that it seeks to add the reservoirs described in Attachment "A" and as listed in Item 11 above as additional points of diversion for the water rights described herein. This application is also filed as part of the implementation of the operating agreement described in Section 205 (a) of Public Law 101-618. Because of the provisions of California Water Code section 1231 and 1232, California will recognize any permits issued by the Nevada State Engineer based upon this application. Therefore, it is within the jurisdiction of the Nevada State Engineer to approve this application allowing for the storage of the consumptive use component of these Nevada water rights in California.

Water diverted to storage under a permit issued hereunder will be and is the subject of applications for secondary permits for beneficial uses allowed by the Truckee River Operating Agreement at the places allowed by that Agreement. The amount of water diverted to storage under a permit issued hereunder in any one year will not be less than the full permitted duty of 4.5 AF per year. The amount of water under a permit issued hereunder which may be in storage at any one time and which may be released and used from storage in any one year will not exceed the amounts allowed by the Truckee River Operating Agreement.

If the water right described herein is not diverted to storage, the full duty of the water right will continue to be diverted at its allowed points of diversion for its manner of use.

**PRIMARY
APPLICATION FOR PERMISSION TO CHANGE POINT OF DIVERSION, MANNER
OF USE AND PLACE OF USE OF THE PUBLIC WATERS
OF THE STATE OF NEVADA HERETOFORE APPROPRIATED**

THIS SPACE FOR OFFICE USE ONLY
Date of filing in State Engineer's Office... **APR 20 2009**
Returned to applicant for correction.....
Corrected application filed.....Map filed **FEB 26 2009** under
78034

The applicant.....**CITY OF FERNLEY**.....
.....**595 SILVER LACE BLVD**.....of.....**FERNLEY**..., NEVADA **89408**.....
Street and No. Or P.O. Box No City or Town

hereby makes... application for permission to change the.....

Point of diversion Place of use Manner of use Of a portion

of water heretofore appropriated under **Permit 73758**.....
Identify existing right by Permit, Certificate, Proof or Claim Nos. If Decreed, give title of Decree identify right in Decree.

1. The source of water is.....**TRUCKEE RIVER**.....
Name of stream, lake, underground, spring or other sources.
2. The amount of water to be changed.....**728.1 ac-ft**.....
feet, acre-feet. One second foot equals 448.83 gallons per minute.
3. The water to be used for.....**STORAGE WITH SECONDARY PERMITS FOR
BENEFICAL USES ALLOWED BY THE TRUCKEE RIVER OPERATING
AGREEMENT**
Irrigation, power, mining, commercial, etc. If for stock state number and kind of animals. Must limit to one major use.
4. The water heretofore used for.....**MUNICIPAL & DOMESTIC**.....
If for stock state number and kind of animals.
5. The water is to be diverted at the following **SEE ATTACHMENT "A"**.....
Describe as being within a 40-acre subdivision of public survey and by course and distance to a section corner. If on unsurveyed land, it should be stated.
6. The existing point of diversion is located within... **Derby Dam being located in N1/2
SW1/4, Section 19, T.20N., R.23E., MDB&M...**
If point of diversion is not changed, do not answer.
7. Proposed place of use.....**The beneficial place of use will be set forth in applications for
secondary permits consistent with the Truckee River Operating Agreement. The water
stored under this Primary Application will be in the Lake Tahoe, Boca Reservoir,
Donner Reservoir, Stampede Reservoir, Prosser Creek Reservoir, Derby Dam, and the
City of Fernley Water Treatment Facility**.....
Describe by legal subdivisions. If for irrigation state number of acres to be irrigated.

- 8. Existing place of use...**See Attachment "B" and map filed with application 73758**
Describe by legal subdivisions. If permit is for irrigation, state number of acres irrigated. If changing place of use and/or manner of use of irrigation permit, describe acreage to be removed from irrigation. *(See Map 71382) mm 412409*
- 9. Use will be from.....**1/1**.....to.....**12/31**.....of each year.
Month and Day Month and Day
- 10. Use permitted from.....**1/1 to 12/31**.....
- 11. Description of proposed works. (Under the provision of NRS 535.010 you may be required to submit plans and specifications of your diversion or storage works.)... **The Reservoirs and Diversion Works for Lake Tahoe, Boca Reservoir, Donner Reservoir, Stampede Reservoir, Prosser Creek Reservoir and Derby Dam are Complete. The City of Fernley Water Treatment Facility is currently under construction**.....
State manner in which water is to be diverted, i.e. diversion structure, ditches, pipes and flumes or drilled well, pump and motor, etc.
- 12. Estimated cost of works.....**\$50,000,000**.....
- 13. Estimated time required to construct works.....**2.0 YEAR**.....
If well completed, describe well.
- 14. Estimated time required to complete the application of water to beneficial use...**N/A**...
- 15. Remarks: **SEE REMARKS IN ATTACHMENT "C"**

(775) 784-9920

Phone No.

By:.....**Lowell Patton, Director, City of Fernley Public Works Department**.....

Print of type name clearly

.....
Signature, applicant or agent

.....**595 Silver Lace Blvd.**.....

Street and No., or P.O. Box No.

.....**Fernley, NV 89408**

City, State, Zip Code

APPLICATION MUST BE SIGNED BY THE APPLICANT OR AGENT

RECEIVED
2009 APR 20 PM 1:41
STATE ENGINEERS OFFICE

\$150 FILING FEE MUST ACCOMPANY APPLICATION

Attachment "A"

The Proposed Points of Diversion are shown on the map filed with Application: 78034

Lake Tahoe:

Within the NE $\frac{1}{4}$ of the NW $\frac{1}{4}$ of Section 7, T. 15N., R. 17E., M.D.M., or from the Dam the southwest corner of said Section 7 bears South $29^{\circ} 09' 30''$ West a distance of 5,182 feet, more or less. The capacity of Lake Tahoe is approximately 744,600 AF.

Donner Lake:

Within the SE $\frac{1}{4}$ of the NE $\frac{1}{4}$ of Section 18, T. 17N., R. 16E., M.D.M., or from the Dam the Southeast corner of said Section 18 bears South $04^{\circ} 07' 14''$ East a distance of 2,981 feet, more or less. The capacity of Donner Lake is 9,500 AF.

Prosser Creek Dam (Reservoir):

Within the NW $\frac{1}{4}$ of the SW $\frac{1}{4}$ of Section 30, T. 18N., R. 17E., M.D.M., or from the Dam the Southeast corner of said Section 30 bears South $22^{\circ} 58' 48''$ West a distance of 2,006 feet, more or less. The capacity of Prosser Creek Reservoir is approximately 29,840 AF.

Boca Dam (Reservoir):

Within the SE $\frac{1}{4}$ of the SW $\frac{1}{4}$ of Section 21, T. 18N., R. 17E., M.D.M., or from the Dam the Southwest corner of said Section 21 bears South $81^{\circ} 05' 07''$ West a distance of 2,647 feet, more or less. The capacity of Boca Reservoir is approximately 40,870 AF.

Stampede Dam (Reservoir)

Within the NW $\frac{1}{4}$ of the NW $\frac{1}{4}$ of Section 28, T. 19N., R. 17E., M.D.M., or from the Dam the Northwest corner of said Section 28 bears North $36^{\circ} 08' 27''$ West a distance of 636 feet, more or less. The capacity of Stampede Reservoir is approximately 226,500 AF.

Derby Dam:

Within the N $\frac{1}{2}$ of the SW $\frac{1}{4}$ of Section 19, T. 20N., R. 23E., M.D.M.

~~78342~~

78342

Proposed Place of Use of Charge Application

T. 20 N. E. 24 E. M.D.R. & M.

Portions of Sections 9 and 10, Sections 11, 12, 13, 14 and 15; Portion of Sections 16, 17 and 20, Section 21, 22, 23, 24, 25, 26, 27 and 28; Portions of Sections 29, 30, 31, Sections 32, 33, 34, 35 and 36.

T. 20 N. E. 25 E. M.D.R. & M.

Sections 1, 2 and 3; Portions of Sections 4 and 5, Sections 7 through 36

T. 20 N. E. 26 E. M.D.R. & M.

Portion of Section 5, Sections 6 and 7; Portion of Sections 8 and 17, Sections 18 and 19; Portion of Sections 20 and 29, Sections 30 and 31; Portions of Section 32.

T. 21 N. E. 24 E. M.D.R. & M.

Portion of Sections 13, 23 and 24, Section 25; Portion of Sections 26, 27, 28 and 33, Sections 34, 35 and 36.

T. 21 N. E. 26 E. M.D.R. & M.

Portions of Sections 5, 7 and 8, Section 17; Portion of Section 18, Sections 19, 20, 29, 30, 31 and 32.

T. 22 N. E. 26 E. M.D.R. & M.

Portions of Sections 28, 32 and 33.

T. 19 N. E. 25 E. M.D.R. & M.

All of Sections 1 through 36

T. 19 N. E. 24 E. M.D.R. & M.

Sections 1, 2, 3, 4 and 5; Portion of Section 6, Sections 7 through 36.

T. 19 N. E. 23 E. M.D.R. & M.

Portions of Sections 1, 12, 13, 14 and 23, Sections 24 and 25; Portion of Sections 26, 27 and 34, Sections 35 and 36.

2006 JUN 26 10 21 AM '06

RECEIVED
JUN 27 10 21 AM '06
ST. JOHNS COUNTY OFFICE

Attachment "C"**15. Remarks**

This application is filed pursuant to the provisions of N.R.S §533.515 in that it seeks to add the reservoirs described in Attachment "A" and as listed in Item 11 above as additional points of diversion for the water rights described herein. This application is also filed as part of the implementation of the operating agreement described in Section 205 (a) of Public Law 101-618. Because of the provisions of California Water Code section 1231 and 1232, California will recognize any permits issued by the Nevada State Engineer based upon this application. Therefore, it is within the jurisdiction of the Nevada State Engineer to approve this application allowing for the storage of the consumptive use component of these Nevada water rights in California.

Water diverted to storage under a permit issued hereunder will be and is the subject of applications for secondary permits for beneficial uses allowed by the Truckee River Operating Agreement at the places allowed by that Agreement. The amount of water diverted to storage under a permit issued hereunder in any one year will not be less than the full permitted duty of 4.5 AF per year. The amount of water under a permit issued hereunder which may be in storage at any one time and which may be released and used from storage in any one year will not exceed the amounts allowed by the Truckee River Operating Agreement.

If the water right described herein is not diverted to storage, the full duty of the water right will continue to be diverted at its allowed points of diversion for its manner of use.

**PRIMARY
APPLICATION FOR PERMISSION TO CHANGE POINT OF DIVERSION, MANNER
OF USE AND PLACE OF USE OF THE PUBLIC WATERS
OF THE STATE OF NEVADA HERETOFORE APPROPRIATED**

THIS SPACE FOR OFFICE USE ONLY

Date of filing in State Engineer's Office... **APR 20 2009**.....

Returned to applicant for correction.....

Corrected application filed..... Map filed **FEB 26 2009** under
78034

The applicant..... **CITY OF FERNLEY**.....

..... **595 SILVER LACE BLVD**..... of..... **FERNLEY**....., NEVADA **89408**.....
Street and No. Or P.O. Box No City or Town

hereby makes... application for permission to change the.....

Point of diversion Place of use Manner of use Of a portion

of water heretofore appropriated under .. **Permit 73704**.....
Identify existing right by Permit, Certificate, Proof or Claim Nos. If Decreed, give title of Decree identify right in Decree.

1. The source of water is..... **TRUCKEE RIVER**.....
Name of stream, lake, underground, spring or other sources.

2. The amount of water to be changed..... **89.33 ac-ft**.....
feet, acre-feet. One second foot equals 448.83 gallons per minute.

3. The water to be used for..... **STORAGE WITH SECONDARY PERMITS FOR
BENEFICIAL USES ALLOWED BY THE TRUCKEE RIVER OPERATING
AGREEMENT**
Irrigation, power, mining, commercial, etc. If for stock state number and kind of animals. Must limit to one major use.

4. The water heretofore used for..... **MUNICIPAL & DOMESTIC**.....
If for stock state number and kind of animals.

5. The water is to be diverted at the following **SEE ATTACHMENT "A"**.....
Describe as being within a 40-acre subdivision of public survey and by course and distance to a section corner. If on unsurveyed land, it should be stated.

6. The existing point of diversion is located within... **Derby Dam being located in N1/2
SW1/4, Section 19, T.20N., R.23E., MDB&M...**
If point of diversion is not changed, do not answer.

7. Proposed place of use..... **The beneficial place of use will be set forth in applications for
secondary permits consistent with the Truckee River Operating Agreement. The water
stored under this Primary Application will be in the Lake Tahoe, Boca Reservoir,
Donner Reservoir, Stampede Reservoir, Prosser Creek Reservoir, Derby Dam, and the
City of Fernley Water Treatment Facility**.....
Describe by legal subdivisions. If for irrigation state number of acres to be irrigated.

78343

8. Existing place of use...**See Attachment "B" and map filed with application 73704**
Describe by legal subdivisions. If permit is for irrigation, state number of acres irrigated. If changing place of use and/or manner of use of irrigation permit, describe acreage to be removed from irrigation. (map 71382) mm 4/24/09

9. Use will be from.....1/1.....to.....12/31.....of each year.
Month and Day Month and Day

10. Use permitted from.....1/1 to 12/31.....

11. Description of proposed works. (Under the provision of NRS 535.010 you may be required to submit plans and specifications of your diversion or storage works.)... **The Reservoirs and Diversion Works for Lake Tahoe, Boca Reservoir, Donner Reservoir, Stampede Reservoir, Prosser Creek Reservoir and Derby Dam are Complete. The City of Fernley Water Treatment Facility is currently under construction.**.....
State manner in which water is to be diverted, i.e. diversion structure, ditches, pipes and flumes or drilled well, pump and motor, etc.

12. Estimated cost of works.....\$50,000,000.....

13. Estimated time required to construct works.....2.0 YEAR.....
If well completed, describe well.

14. Estimated time required to complete the application of water to beneficial use...N/A...

15. Remarks: **SEE REMARKS IN ATTACHMENT "C"**.....

(775) 784-9920

Phone No.

By:.....**Lowell Patton, Director, City of Fernley**

Public Works Department.....

Print or type name clearly

.....
Signature, applicant or agent

.....**595 Silver Lace Blvd**.....

Street and No., or P.O. Box No.

.....**Fernley, NV 89408**.....

City, State, Zip Code

**APPLICATION MUST BE SIGNED
BY THE APPLICANT OR AGENT**

RECEIVED
2009 APR 20 PM 1:41
STATE ENGINEERS OFFICE

\$150 FILING FEE MUST ACCOMPANY APPLICATION

Attachment "A"

The Proposed Points of Diversion are shown on the map filed with Application: 78034

Lake Tahoe:

Within the NE $\frac{1}{4}$ of the NW $\frac{1}{4}$ of Section 7, T. 15N., R. 17E., M.D.M., or from the Dam the southwest corner of said Section 7 bears South $29^{\circ} 09' 30''$ West a distance of 5,182 feet, more or less. The capacity of Lake Tahoe is approximately 744,600 AF.

Donner Lake:

Within the SE $\frac{1}{4}$ of the NE $\frac{1}{4}$ of Section 18, T. 17N., R. 16E., M.D.M., or from the Dam the Southeast corner of said Section 18 bears South $04^{\circ} 07' 14''$ East a distance of 2,981 feet, more or less. The capacity of Donner Lake is 9,500 AF.

Prosser Creek Dam (Reservoir):

Within the NW $\frac{1}{4}$ of the SW $\frac{1}{4}$ of Section 30, T. 18N., R. 17E., M.D.M., or from the Dam the Southeast corner of said Section 30 bears South $22^{\circ} 58' 48''$ West a distance of 2,006 feet, more or less. The capacity of Prosser Creek Reservoir is approximately 29,840 AF.

Boca Dam (Reservoir):

Within the SE $\frac{1}{4}$ of the SW $\frac{1}{4}$ of Section 21, T. 18N., R. 17E., M.D.M., or from the Dam the Southwest corner of said Section 21 bears South $81^{\circ} 05' 07''$ West a distance of 2,647 feet, more or less. The capacity of Boca Reservoir is approximately 40,870 AF.

Stampede Dam (Reservoir)

Within the NW $\frac{1}{4}$ of the NW $\frac{1}{4}$ of Section 28, T. 19N., R. 17E., M.D.M., or from the Dam the Northwest corner of said Section 28 bears North $36^{\circ} 08' 27''$ West a distance of 636 feet, more or less. The capacity of Stampede Reservoir is approximately 226,500 AF.

Derby Dam:

Within the N $\frac{1}{2}$ of the SW $\frac{1}{4}$ of Section 19, T. 20N., R. 23E., M.D.M.

Proposed Place of Use of Change Application

T. 20N., R. 24E., M.D.R. & M.

Portions of Sections 9 and 10, Sections 11, 12, 13, 14 and 15; Portion of Sections 16, 17 and 20, Section 21, 22, 23, 24, 25, 26, 27 and 28; Portions of Sections 29, 30, 31, Sections 32, 33, 34, 35 and 36.

T. 20N., R. 25E., M.D.R. & M.

Sections 1, 2 and 3; Portions of Sections 4 and 5, Sections 7 through 36

T. 20N., R. 26E., M.D.R. & M.

Portion of Section 5, Sections 6 and 7; Portions of Sections 8 and 17, Sections 18 and 19; Portion of Sections 20 and 29, Sections 30 and 31; Portions of Section 32.

T. 21N., R. 25E., M.D.R. & M.

Portion of Sections 13, 23 and 24, Section 25; Portions of Sections 26, 27, 28 and 33, Sections 34, 35 and 36.

T. 21N., R. 26E., M.D.R. & M.

Portions of Sections 5, 7 and 8, Section 17; Portion of Section 18, Sections 19, 20, 29, 30, 31 and 32.

T. 22N., R. 26E., M.D.R. & M.

Portions of Sections 28, 32 and 33.

T. 19N., R. 25E., M.D.R. & M.

All of Sections 1 through 36

T. 19N., R. 24E., M.D.R. & M.

Sections 1, 2, 3, 4 and 5; Portion of Section 6, Sections 7 through 36.

T. 19N., R. 23E., M.D.R. & M.

Portions of Sections 1, 12, 13, 14 and 23, Sections 24 and 25; Portion of Sections 26, 27 and 34, Sections 35 and 36.

Attachment "C"

15. Remarks

This application is filed pursuant to the provisions of N.R.S §533.515 in that it seeks to add the reservoirs described in Attachment "A" and as listed in Item 11 above as additional points of diversion for the water rights described herein. This application is also filed as part of the implementation of the operating agreement described in Section 205 (a) of Public Law 101-618. Because of the provisions of California Water Code section 1231 and 1232, California will recognize any permits issued by the Nevada State Engineer based upon this application. Therefore, it is within the jurisdiction of the Nevada State Engineer to approve this application allowing for the storage of the consumptive use component of these Nevada water rights in California.

Water diverted to storage under a permit issued hereunder will be and is the subject of applications for secondary permits for beneficial uses allowed by the Truckee River Operating Agreement at the places allowed by that Agreement. The amount of water diverted to storage under a permit issued hereunder in any one year will not be less than the full permitted duty of 4.5 AF per year. The amount of water under a permit issued hereunder which may be in storage at any one time and which may be released and used from storage in any one year will not exceed the amounts allowed by the Truckee River Operating Agreement.

If the water right described herein is not diverted to storage, the full duty of the water right will continue to be diverted at its allowed points of diversion for its manner of use.

**PRIMARY
APPLICATION FOR PERMISSION TO CHANGE POINT OF DIVERSION, MANNER
OF USE AND PLACE OF USE OF THE PUBLIC WATERS
OF THE STATE OF NEVADA HERETOFORE APPROPRIATED**

THIS SPACE FOR OFFICE USE ONLY	
Date of filing in State Engineer's Office.....	APR 20 2009
Returned to applicant for correction.....	
Corrected application filed.....	Map filed FEB 26 2009 under 78034

The applicant.....**CITY OF FERNLEY**.....

.....**595 SILVER LACE BLVD.**.....of.....**FERNLEY**..., NEVADA 89408.....
Street and No. Or P.O. Box No City or Town

hereby makes... application for permission to change the.....

X Point of diversion Place of use Manner of use Of a portion

of water heretofore appropriated under ..**Permit 73703**.....
Identify existing right by Permit, Certificate, Proof or Claim Nos. If Decreed, give title of Decree identify right in Decree.

1. The source of water is.....**TRUCKEE RIVER**.....
Name of stream, lake, underground, spring or other sources.

2. The amount of water to be changed.....**62.10 ac-ft.**.....
feet, acre-feet. One second foot equals 448.83 gallons per minute.

3. The water to be used for.....**STORAGE WITH SECONDARY PERMITS FOR
BENEFICAL USES ALLOWED BY THE TRUCKEE RIVER OPERATING
AGREEMENT**
Irrigation, power, mining, commercial, etc. If for stock state number and kind of animals. Must limit to one major use.

4. The water heretofore used for.....**MUNICIPAL & DOMESTIC**.....
If for stock state number and kind of animals.

5. The water is to be diverted at the following **SEE ATTACHMENT "A"**.....
Describe as being within a 40-acre subdivision of public survey and by course and distance to a section corner. If on unsurveyed land, it should be stated.

6. The existing point of diversion is located within... **Derby Dam being located in N1/2
SW1/4, Section 19, T.20N., R.23E., MDB&M...**
If point of diversion is not changed, do not answer.

7. Proposed place of use.....**The beneficial place of use will be set forth in applications for
secondary permits consistent with the Truckee River Operating Agreement. The water
stored under this Primary Application will be in the Lake Tahoe, Boca Reservoir,
Donner Reservoir, Stampede Reservoir, Prosser Creek Reservoir, Derby Dam, and the
City of Fernley Water Treatment Facility**.....
Describe by legal subdivisions. If for irrigation state number of acres to be irrigated.

- 8. Existing place of use...**See Attachment "B" and map filed with application 73703**
Describe by legal subdivisions. If permit is for irrigation, state number of acres irrigated. If changing place of use and/or manner of use of irrigation permit, describe acreage to be removed from irrigation. *(see map 71382) mm 4/14/09*
- 9. Use will be from.....1/1.....to.....12/31.....of each year.
Month and Day Month and Day
- 10. Use permitted from.....1/1 to 12/31.....
- 11. Description of proposed works. (Under the provision of NRS 535.010 you may be required to submit plans and specifications of your diversion or storage works.)... **The Reservoirs and Diversion Works for Lake Tahoe, Boca Reservoir, Donner Reservoir, Stampede Reservoir, Prosser Creek Reservoir and Derby Dam are Complete. The City of Fernley Water Treatment Facility is currently under Construction.**
State manner in which water is to be diverted, i.e. diversion structure, ditches, pipes and flumes or drilled well, pump and motor, etc.
- 12. Estimated cost of works.....**\$50,000,000**.....
- 13. Estimated time required to construct works.....**2.0 YEAR**.....
If well completed, describe well.
- 14. Estimated time required to complete the application of water to beneficial use...N/A...
- 15. Remarks: **SEE REMARKS IN ATTACHMENT "C"**.....

(775) 784-9920

Phone No.

By:.....**Lowell Patton, Director, City of Fernley Public Works Department**.....

Print or type name clearly

.....
Signature, applicant or agent

.....**595 Silver Lace Blvd**.....

Street and No., or P.O. Box No.

.....**Fernley, NV 89408**.....

City, State, Zip Code

APPLICATION MUST BE SIGNED BY THE APPLICANT OR AGENT

RECEIVED
2009 APR 20 PM 1:41
STATE ENGINEERS OFFICE

\$150 FILING FEE MUST ACCOMPANY APPLICATION

Attachment "A"

The Proposed Points of Diversion are shown on the map filed with Application: **78034**

Lake Tahoe:

Within the NE $\frac{1}{4}$ of the NW $\frac{1}{4}$ of Section 7, T. 15N., R. 17E., M.D.M., or from the Dam the southwest corner of said Section 7 bears South $29^{\circ} 09' 30''$ West a distance of 5,182 feet, more or less. The capacity of Lake Tahoe is approximately 744,600 AF.

Donner Lake:

Within the SE $\frac{1}{4}$ of the NE $\frac{1}{4}$ of Section 18, T. 17N., R. 16E., M.D.M., or from the Dam the Southeast corner of said Section 18 bears South $04^{\circ} 07' 14''$ East a distance of 2,981 feet, more or less. The capacity of Donner Lake is 9,500 AF.

Prosser Creek Dam (Reservoir):

Within the NW $\frac{1}{4}$ of the SW $\frac{1}{4}$ of Section 30, T. 18N., R. 17E., M.D.M., or from the Dam the Southeast corner of said Section 30 bears South $22^{\circ} 58' 48''$ West a distance of 2,006 feet, more or less. The capacity of Prosser Creek Reservoir is approximately 29,840 AF.

Boca Dam (Reservoir):

Within the SE $\frac{1}{4}$ of the SW $\frac{1}{4}$ of Section 21, T. 18N., R. 17E., M.D.M., or from the Dam the Southwest corner of said Section 21 bears South $81^{\circ} 05' 07''$ West a distance of 2,647 feet, more or less. The capacity of Boca Reservoir is approximately 40,870 AF.

Stampede Dam (Reservoir)

Within the NW $\frac{1}{4}$ of the NW $\frac{1}{4}$ of Section 28, T. 19N., R. 17E., M.D.M., or from the Dam the Northwest corner of said Section 28 bears North $36^{\circ} 08' 27''$ West a distance of 636 feet, more or less. The capacity of Stampede Reservoir is approximately 226,500 AF.

Derby Dam:

Within the N $\frac{1}{2}$ of the SW $\frac{1}{4}$ of Section 19, T. 20N., R. 23E., M.D.M.

ATTACHMENT B

~~FRONT~~

78344

Proposed Place of Use of Change Application

T. 20 N. R. 24 E. M.D.B. & M.

Portions of Sections 9 and 10, Sections 11, 12, 13, 14 and 15; Portion of Sections 16, 17 and 20, Section 21, 22, 23, 24, 25, 26, 27 and 28; Portions of Sections 29, 30, 31, Sections 32, 33, 34, 35 and 36.

T. 20 N. R. 25 E. M.D.B. & M.

Sections 1, 2 and 3; Portions of Sections 4 and 5, Sections 7 through 36

T. 20 N. R. 26 E. M.D.B. & M.

Portion of Section 5, Sections 6 and 7; Portion of Sections 8 and 17, Sections 18 and 19; Portion of Sections 20 and 29, Sections 30 and 31; Portions of Section 32.

T. 21 N. R. 25 E. M.D.B. & M.

Portion of Sections 13, 23 and 24, Section 25; Portion of Sections 26, 27, 28 and 33, Sections 34, 35 and 36.

T. 21 N. R. 26 E. M.D.B. & M.

Portions of Sections 5, 7 and 8, Section 17; Portion of Section 18, Sections 19, 20, 29, 30, 31 and 32.

T. 22 N. R. 26 E. M.D.B. & M.

Portions of Sections 28, 32 and 33.

T. 19 N. R. 25 E. M.D.B. & M.

All of Sections 1 through 36

T. 19 N. R. 24 E. M.D.B. & M.

Sections 1, 2, 3, 4 and 5; Portion of Section 6, Sections 7 through 36.

T. 19 N. R. 23 E. M.D.B. & M.

Portions of Sections 1, 12, 13, 14 and 23, Sections 24 and 25; Portion of Sections 26, 27 and 34, Sections 35 and 36.

Attachment "C"

15. Remarks

This application is filed pursuant to the provisions of N.R.S §533.515 in that it seeks to add the reservoirs described in Attachment "A" and as listed in Item 11 above as additional points of diversion for the water rights described herein. This application is also filed as part of the implementation of the operating agreement described in Section 205 (a) of Public Law 101-618. Because of the provisions of California Water Code section 1231 and 1232, California will recognize any permits issued by the Nevada State Engineer based upon this application. Therefore, it is within the jurisdiction of the Nevada State Engineer to approve this application allowing for the storage of the consumptive use component of these Nevada water rights in California.

Water diverted to storage under a permit issued hereunder will be and is the subject of applications for secondary permits for beneficial uses allowed by the Truckee River Operating Agreement at the places allowed by that Agreement. The amount of water diverted to storage under a permit issued hereunder in any one year will not be less than the full permitted duty of 4.5 AF per year. The amount of water under a permit issued hereunder which may be in storage at any one time and which may be released and used from storage in any one year will not exceed the amounts allowed by the Truckee River Operating Agreement.

If the water right described herein is not diverted to storage, the full duty of the water right will continue to be diverted at its allowed points of diversion for its manner of use.

**PRIMARY
APPLICATION FOR PERMISSION TO CHANGE POINT OF DIVERSION, MANNER
OF USE AND PLACE OF USE OF THE PUBLIC WATERS
OF THE STATE OF NEVADA HERETOFORE APPROPRIATED**

THIS SPACE FOR OFFICE USE ONLY
Date of filing in State Engineer's Office..... **APR 20 2009**
Returned to applicant for correction.....
Corrected application filed..... Map filed **FEB 26 2009** under **78034**

The applicant.....**CITY OF FERNLEY**.....
.....**595 SILVER LACE BLVD**.....of.....**FERNLEY**..., NEVADA **89408**.....
Street and No. Or P.O. Box No City or Town

hereby makes... application for permission to change the.....

Point of diversion Place of use Manner of use Of a portion

of water heretofore appropriated under **Permit 73255**.....
Identify existing right by Permit, Certificate, Proof or Claim Nos. If Decreed, give title of Decree identify right in Decree.

1. The source of water is.....**TRUCKEE RIVER**.....
Name of stream, lake, underground, spring or other sources.

2. The amount of water to be changed.....**104.63 ac-ft**.....
feet, acre-feet. One second foot equals 448.83 gallons per minute.

3. The water to be used for.....**STORAGE WITH SECONDARY PERMITS FOR
BENEFICAL USES ALLOWED BY THE TRUCKEE RIVER OPERATING
AGREEMENT**
Irrigation, power, mining, commercial, etc. If for stock state number and kind of animals. Must limit to one major use.

4. The water heretofore used for.....**MUNICIPAL & DOMESTIC**.....
If for stock state number and kind of animals.

5. The water is to be diverted at the following **SEE ATTACHMENT "A"**.....
Describe as being within a 40-acre subdivision of public survey and by course and distance to a section corner. If on unsurveyed land, it should be stated.

6. The existing point of diversion is located within... **Derby Dam being located in N1/2
SW1/4, Section 19, T.20N., R.23E., MDB&M...**
If point of diversion is not changed, do not answer.

7. Proposed place of use.....**The beneficial place of use will be set forth in applications for
secondary permits consistent with the Truckee River Operating Agreement. The water
stored under this Primary Application will be in the Lake Tahoe, Boca Reservoir,
Donner Reservoir, Stampede Reservoir, Prosser Creek Reservoir, Derby Dam, and the
City of Fernley Water Treatment Facility**.....
Describe by legal subdivisions. If for irrigation state number of acres to be irrigated.

- 8. Existing place of use...**See Attachment "B" and map filed with application 73255**
Describe by legal subdivisions. If permit is for irrigation, state number of acres irrigated. If changing place of use and/or manner of use of irrigation permit, describe acreage to be removed from irrigation. (See map 71382) mm4/24/09
- 9. Use will be from.....1/1.....to.....12/31.....of each year.
Month and Day Month and Day
- 10. Use permitted from.....1/1 to 12/31.....
- 11. Description of proposed works. (Under the provision of NRS 535.010 you may be required to submit plans and specifications of your diversion or storage works.)... **The Reservoirs and Diversion Works for Lake Tahoe, Boca Reservoir, Donner Reservoir, Stampede Reservoir, Prosser Creek Reservoir and Derby Dam are Complete. The City of Fernley Water Treatment Facility is currently under Construction.**
State manner in which water is to be diverted, i.e. diversion structure, ditches, pipes and flumes or drilled well, pump and motor, etc.
- 12. Estimated cost of works.....**\$50,000,000**.....
- 13. Estimated time required to construct works.....**2.0 YEAR**.....
If well completed, describe well.
- 14. Estimated time required to complete the application of water to beneficial use...N/A...
- 15. Remarks: **SEE REMARKS IN ATTACHMENT "C"**.....

(775) 784-9920

Phone No.

By:.....**Lowell Patton, Director, City of Fernley Public Works Department**.....

Print or type name clearly

.....
Signature, applicant or agent

.....**595 Silver Lace Blvd**.....
Street and No., or P.O. Box No.

.....**Fernley, NV 89408**.....
City, State, Zip Code

APPLICATION MUST BE SIGNED BY THE APPLICANT OR AGENT

RECEIVED
2009 APR 20 PM 1:42
STATE ENGINEERS OFFICE

\$150 FILING FEE MUST ACCOMPANY APPLICATION

Attachment "A"

The Proposed Points of Diversion are shown on the map filed with Application: **78034**

Lake Tahoe:

Within the NE $\frac{1}{4}$ of the NW $\frac{1}{4}$ of Section 7, T. 15N., R. 17E., M.D.M., or from the Dam the southwest corner of said Section 7 bears South $29^{\circ} 09' 30''$ West a distance of 5,182 feet, more or less. The capacity of Lake Tahoe is approximately 744,600 AF.

Donner Lake:

Within the SE $\frac{1}{4}$ of the NE $\frac{1}{4}$ of Section 18, T. 17N., R. 16E., M.D.M., or from the Dam the Southeast corner of said Section 18 bears South $04^{\circ} 07' 14''$ East a distance of 2,981 feet, more or less. The capacity of Donner Lake is 9,500 AF.

Prosser Creek Dam (Reservoir):

Within the NW $\frac{1}{4}$ of the SW $\frac{1}{4}$ of Section 30, T. 18N., R. 17E., M.D.M., or from the Dam the Southeast corner of said Section 30 bears South $22^{\circ} 58' 48''$ West a distance of 2,006 feet, more or less. The capacity of Prosser Creek Reservoir is approximately 29,840 AF.

Boca Dam (Reservoir):

Within the SE $\frac{1}{4}$ of the SW $\frac{1}{4}$ of Section 21, T. 18N., R. 17E., M.D.M., or from the Dam the Southwest corner of said Section 21 bears South $81^{\circ} 05' 07''$ West a distance of 2,647 feet, more or less. The capacity of Boca Reservoir is approximately 40,870 AF.

Stampede Dam (Reservoir)

Within the NW $\frac{1}{4}$ of the NW $\frac{1}{4}$ of Section 28, T. 19N., R. 17E., M.D.M., or from the Dam the Northwest corner of said Section 28 bears North $36^{\circ} 08' 27''$ West a distance of 636 feet, more or less. The capacity of Stampede Reservoir is approximately 226,500 AF.

Derby Dam:

Within the N $\frac{1}{2}$ of the SW $\frac{1}{4}$ of Section 19, T. 20N., R. 23E., M.D.M.

Proposed Place of Use of Change Application

T. 20 N., R. 24 E., M.D.B. & M.

Portions of Sections 9 and 10, Sections 11, 12, 13, 14 and 15; Portion of Sections 16, 17 and 20, Section 21, 22, 23, 24, 25, 26, 27 and 28; Portions of Sections 29, 30, 31, Sections 32, 33, 34, 35 and 36.

T. 20 N., R. 25 E., M.D.B. & M.

Sections 1, 2 and 3; Portions of Sections 4 and 5, Sections 7 through 36

T. 20 N., R. 26 E., M.D.B. & M.

Portion of Section 5, Sections 6 and 7; Portion of Sections 8 and 17, Sections 18 and 19; Portion of Sections 20 and 29, Sections 30 and 31; Portions of Section 32.

T. 21 N., R. 25 E., M.D.B. & M.

Portion of Sections 13, 23 and 24, Section 25; Portion of Sections 26, 27, 28 and 33, Sections 34, 35 and 36.

T. 21 N., R. 26 E., M.D.B. & M.

Portions of Sections 5, 7 and 8, Section 17; Portion of Section 18, Sections 19, 20, 29, 30, 31 and 32.

T. 22 N., R. 26 E., M.D.B. & M.

Portions of Sections 28, 32 and 33.

T. 19 N., R. 25 E., M.D.B. & M.

All of Sections 1 through 36

T. 19 N., R. 24 E., M.D.B. & M.

Sections 1, 2, 3, 4 and 5; Portion of Section 6, Sections 7 through 36.

T. 19 N., R. 23 E., M.D.B. & M.

Portions of Sections 1, 12, 13, 14 and 23, Sections 24 and 25; Portion of Sections 26, 27 and 34, Sections 35 and 36.

Attachment "C"**15. Remarks**

This application is filed pursuant to the provisions of N.R.S §533.515 in that it seeks to add the reservoirs described in Attachment "A" and as listed in Item 11 above as additional points of diversion for the water rights described herein. This application is also filed as part of the implementation of the operating agreement described in Section 205 (a) of Public Law 101-618. Because of the provisions of California Water Code section 1231 and 1232, California will recognize any permits issued by the Nevada State Engineer based upon this application. Therefore, it is within the jurisdiction of the Nevada State Engineer to approve this application allowing for the storage of the consumptive use component of these Nevada water rights in California.

Water diverted to storage under a permit issued hereunder will be and is the subject of applications for secondary permits for beneficial uses allowed by the Truckee River Operating Agreement at the places allowed by that Agreement. The amount of water diverted to storage under a permit issued hereunder in any one year will not be less than the full permitted duty of 4.5 AF per year. The amount of water under a permit issued hereunder which may be in storage at any one time and which may be released and used from storage in any one year will not exceed the amounts allowed by the Truckee River Operating Agreement.

If the water right described herein is not diverted to storage, the full duty of the water right will continue to be diverted at its allowed points of diversion for its manner of use.

**PRIMARY
APPLICATION FOR PERMISSION TO CHANGE POINT OF DIVERSION, MANNER
OF USE AND PLACE OF USE OF THE PUBLIC WATERS
OF THE STATE OF NEVADA HERETOFORE APPROPRIATED**

THIS SPACE FOR OFFICE USE ONLY
Date of filing in State Engineer's Office..... **APR 20 2009**
Returned to applicant for correction.....
Corrected application filed..... Map filed **FEB 26 2009** under **78034**

The applicant..... **CITY OF FERNLEY**.....

..... **595 SILVER LACE BLVD**..... of..... **FERNLEY**..., **NEVADA 89408**.....
Street and No. Or P.O. Box No City or Town

hereby makes... application for permission to change the.....

Point of diversion Place of use Manner of use Of a portion

of water heretofore appropriated under ..**Permit 73245**.....
Identify existing right by Permit, Certificate, Proof or Claim Nos. If Decreed, give title of Decree identify right in Decree.

1. The source of water is..... **TRUCKEE RIVER**.....
Name of stream, lake, underground, spring or other sources.

2. The amount of water to be changed..... **159.3 ac-ft**.....
feet, acre-feet. One second foot equals 448.83 gallons per minute.

3. The water to be used for..... **STORAGE WITH SECONDARY PERMITS FOR
BENEFICIAL USES ALLOWED BY THE TRUCKEE RIVER OPERATING
AGREEMENT**
Irrigation, power, mining, commercial, etc. If for stock state number and kind of animals. Must limit to one major use.

4. The water heretofore used for..... **MUNICIPAL & DOMESTIC**.....
If for stock state number and kind of animals.

5. The water is to be diverted at the following **SEE ATTACHMENT "A"**.....
Describe as being within a 40-acre subdivision of public survey and by course and distance to a section corner. If on unsurveyed land, it should be stated.

6. The existing point of diversion is located within... **Derby Dam being located in N1/2
SW1/4, Section 19, T.20N., R.23E., MDB&M...**
If point of diversion is not changed, do not answer.

7. Proposed place of use.... **The beneficial place of use will be set forth in applications for
secondary permits consistent with the Truckee River Operating Agreement. The water
stored under this Primary Application will be in the Lake Tahoe, Boca Reservoir,
Donner Reservoir, Stampede Reservoir, Prosser Creek Reservoir, Derby Dam, and the
City of Fernley Water Treatment Facility**.....
Describe by legal subdivisions. If for irrigation state number of acres to be irrigated.

- 8. Existing place of use...**See Attachment "B" and map filed with application 73245**
Describe by legal subdivisions. If permit is for irrigation, state number of acres irrigated. If changing place of use and/or manner of use of irrigation permit, describe acreage to be removed from irrigation. (see Map 71382) mm 4/24/09
- 9. Use will be from.....1/1.....to.....12/31.....of each year.
Month and Day Month and Day
- 10. Use permitted from.....1/1 to 12/31.....
- 11. Description of proposed works. (Under the provision of NRS 535.010 you may be required to submit plans and specifications of your diversion or storage works.)... **The Reservoirs and Diversion Works for Lake Tahoe, Boca Reservoir, Donner Reservoir, Stampede Reservoir, Prosser Creek Reservoir and Derby Dam are Complete. The City of Fernley Water Treatment Facility is currently under Construction.**.....
State manner in which water is to be diverted, i.e. diversion structure, ditches, pipes and flumes or drilled well, pump and motor, etc.
- 12. Estimated cost of works.....**\$50,000,000**.....
- 13. Estimated time required to construct works.....**2.0 YEAR**.....
If well completed, describe well.
- 14. Estimated time required to complete the application of water to beneficial use...N/A...
- 15. Remarks: **SEE REMARKS IN ATTACHMENT "C"**.....

(775) 784-9920

Phone No.

By:.....**Lowell Patton, Director, City of Fernley Public Works Department**.....

Print or type name clearly



Signature, applicant or agent

.....**595 Silver Lace Blvd**.....
Street and No., or P.O. Box No.

.....**Fernley, NV 89408**.....
City, State, Zip Code

APPLICATION MUST BE SIGNED BY THE APPLICANT OR AGENT

RECEIVED
2009 APR 20 PM 1:42
STATE ENGINEERS OFFICE

\$150 FILING FEE MUST ACCOMPANY APPLICATION

Attachment "A"

The Proposed Points of Diversion are shown on the map filed with Application: 78034

Lake Tahoe:

Within the NE $\frac{1}{4}$ of the NW $\frac{1}{4}$ of Section 7, T. 15N., R. 17E., M.D.M., or from the Dam the southwest corner of said Section 7 bears South $29^{\circ} 09' 30''$ West a distance of 5,182 feet, more or less. The capacity of Lake Tahoe is approximately 744,600 AF.

Donner Lake:

Within the SE $\frac{1}{4}$ of the NE $\frac{1}{4}$ of Section 18, T. 17N., R. 16E., M.D.M., or from the Dam the Southeast corner of said Section 18 bears South $04^{\circ} 07' 14''$ East a distance of 2,981 feet, more or less. The capacity of Donner Lake is 9,500 AF.

Prosser Creek Dam (Reservoir):

Within the NW $\frac{1}{4}$ of the SW $\frac{1}{4}$ of Section 30, T. 18N., R. 17E., M.D.M., or from the Dam the Southeast corner of said Section 30 bears South $22^{\circ} 58' 48''$ West a distance of 2,006 feet, more or less. The capacity of Prosser Creek Reservoir is approximately 29,840 AF.

Boca Dam (Reservoir):

Within the SE $\frac{1}{4}$ of the SW $\frac{1}{4}$ of Section 21, T. 18N., R. 17E., M.D.M., or from the Dam the Southwest corner of said Section 21 bears South $81^{\circ} 05' 07''$ West a distance of 2,647 feet, more or less. The capacity of Boca Reservoir is approximately 40,870 AF.

Stampede Dam (Reservoir)

Within the NW $\frac{1}{4}$ of the NW $\frac{1}{4}$ of Section 28, T. 19N., R. 17E., M.D.M., or from the Dam the Northwest corner of said Section 28 bears North $36^{\circ} 08' 27''$ West a distance of 636 feet, more or less. The capacity of Stampede Reservoir is approximately 226,500 AF.

Derby Dam:

Within the N $\frac{1}{2}$ of the SW $\frac{1}{4}$ of Section 19, T. 20N., R. 23E., M.D.M.

ATTACHMENT B

~~71275~~

78346

Proposed Place of Use of Change Application

T. 20 N. E. 24 E. MDB & M.

Portions of Sections 9 and 10, Sections 11, 12, 13, 14 and 15; Portion of Sections 16, 17 and 20, Section 21, 22, 23, 24, 25, 26, 27 and 28; Portions of Sections 29, 30, 31, Sections 32, 33, 34, 35 and 36.

T. 20 N. E. 25 E. MDB & M.

Sections 1, 2 and 3; Portions of Sections 4 and 5, Sections 7 through 36

T. 20 N. E. 26 E. MDB & M.

Portion of Section 5, Sections 6 and 7; Portion of Sections 8 and 17, Sections 18 and 19; Portion of Sections 20 and 29, Sections 30 and 31; Portion of Section 32.

T. 21 N. E. 25 E. MDB & M.

Portion of Sections 13, 23 and 24, Section 25; Portion of Sections 26, 27, 28 and 33, Sections 34, 35 and 36.

T. 21 N. E. 26 E. MDB & M.

Portions of Sections 5, 7 and 8, Section 17; Portion of Section 18, Sections 19, 20, 29, 30, 31 and 32.

T. 22 N. E. 26 E. MDB & M.

Portions of Sections 28, 32 and 33.

T. 19 N. E. 25 E. MDB & M.

All of Sections 1 through 36

T. 19 N. E. 24 E. MDB & M.

Sections 1, 2, 3, 4 and 5; Portion of Section 6, Sections 7 through 36.

T. 19 N. E. 23 E. MDB & M.

Portions of Sections 1, 12, 13, 14 and 23, Sections 24 and 25; Portion of Sections 26, 27 and 34, Sections 35 and 36.

RECEIVED
05 SEP 13 PM 1:07
STATE ENGINEERS OFFICE

Attachment "C"**15. Remarks**

This application is filed pursuant to the provisions of N.R.S §533.515 in that it seeks to add the reservoirs described in Attachment "A" and as listed in Item 11 above as additional points of diversion for the water rights described herein. This application is also filed as part of the implementation of the operating agreement described in Section 205 (a) of Public Law 101-618. Because of the provisions of California Water Code section 1231 and 1232, California will recognize any permits issued by the Nevada State Engineer based upon this application. Therefore, it is within the jurisdiction of the Nevada State Engineer to approve this application allowing for the storage of the consumptive use component of these Nevada water rights in California.

Water diverted to storage under a permit issued hereunder will be and is the subject of applications for secondary permits for beneficial uses allowed by the Truckee River Operating Agreement at the places allowed by that Agreement. The amount of water diverted to storage under a permit issued hereunder in any one year will not be less than the full permitted duty of 4.5 AF per year. The amount of water under a permit issued hereunder which may be in storage at any one time and which may be released and used from storage in any one year will not exceed the amounts allowed by the Truckee River Operating Agreement.

If the water right described herein is not diverted to storage, the full duty of the water right will continue to be diverted at its allowed points of diversion for its manner of use.

**PRIMARY
APPLICATION FOR PERMISSION TO CHANGE POINT OF DIVERSION, MANNER
OF USE AND PLACE OF USE OF THE PUBLIC WATERS
OF THE STATE OF NEVADA HERETOFORE APPROPRIATED**

THIS SPACE FOR OFFICE USE ONLY	
Date of filing in State Engineer's Office.....	APR 20 2009
Returned to applicant for correction.....	
Corrected application filed.....	Map filed FEB 26 2009 under
	78034

The applicant.....**CITY OF FERNLEY**.....

.....**595 SILVER LACE BLVD**.....of.....**FERNLEY**..., **NEVADA 89408**.....
Street and No. Or P.O. Box No City or Town

hereby makes... application for permission to change the.....

X Point of diversion Place of use Manner of use Of a portion

of water heretofore appropriated under ..**Permit 73244**.....
Identify existing right by Permit, Certificate, Proof or Claim Nos. If Decreed, give title of Decree identify right in Decree.

1. The source of water is.....**TRUCKEE RIVER**.....
Name of stream, lake, underground, spring or other sources.
2. The amount of water to be changed.....**60.30 ac-ft**.....
feet, acre-feet. One second foot equals 448.83 gallons per minute.
3. The water to be used for.....**STORAGE WITH SECONDARY PERMITS FOR
BENEFICAL USES ALLOWED BY THE TRUCKEE RIVER OPERATING
AGREEMENT**
Irrigation, power, mining, commercial, etc. If for stock state number and kind of animals. Must limit to one major use.
4. The water heretofore used for.....**MUNICIPAL & DOMESTIC**.....
If for stock state number and kind of animals.
5. The water is to be diverted at the following **SEE ATTACHMENT "A"**.....
Describe as being within a 40-acre subdivision of public survey and by course and distance to a section corner. If on unsurveyed land, it should be stated.
6. The existing point of diversion is located within... **Derby Dam being located in N1/2
SW1/4, Section 19, T.20N., R.23E., MDB&M...**
If point of diversion is not changed, do not answer.
7. Proposed place of use.....**The beneficial place of use will be set forth in applications for
secondary permits consistent with the Truckee River Operating Agreement. The water
stored under this Primary Application will be in the Lake Tahoe, Boca Reservoir,
Donner Reservoir, Stampede Reservoir, Prosser Creek Reservoir, Derby Dam, and the
City of Fernley Water Treatment Facility**.....
Describe by legal subdivisions. If for irrigation state number of acres to be irrigated.

8. Existing place of use...**See Attachment "B" and map filed with application 73244**
Describe by legal subdivisions. If permit is for irrigation, state number of acres irrigated. If changing place of use and/or manner of use of irrigation permit, describe acreage to be removed from irrigation. (see map 71382) mm 4/24/09

9. Use will be from.....1/1.....to.....12/31.....of each year.
Month and Day Month and Day

10. Use permitted from.....1/1 to 12/31.....

11. Description of proposed works. (Under the provision of NRS 535.010 you may be required to submit plans and specifications of your diversion or storage works.)... **The Reservoirs and Diversion Works for Lake Tahoe, Boca Reservoir, Donner Reservoir, Stampede Reservoir, Prosser Creek Reservoir and Derby Dam are Complete. The City of Fernley Water Treatment Facility is currently under Construction.**
State manner in which water is to be diverted, i.e. diversion structure, ditches, pipes and flumes or drilled well, pump and motor, etc.

12. Estimated cost of works.....\$50,000,000.....

13. Estimated time required to construct works.....2.0 YEAR.....
If well completed, describe well.

14. Estimated time required to complete the application of water to beneficial use...N/A...

15. Remarks: **SEE REMARKS IN ATTACHMENT "C"**.....

(775) 784-9920

Phone No.

By:.....**Lowell Patton, Director, City of Fernley**
Public Works Department.....

Print or type name clearly

.....
Signature, applicant or agent

.....**595 Silver Lace Blvd**.....
Street and No., or P.O. Box No.

.....**Fernley, NV 89408**.....
City, State, Zip Code

APPLICATION MUST BE SIGNED
BY THE APPLICANT OR AGENT

RECEIVED
2009 APR 20 PM 1:42
STATE ENGINEERS OFFICE

\$150 FILING FEE MUST ACCOMPANY APPLICATION

Attachment "A"

The Proposed Points of Diversion are shown on the map filed with Application: **78034**

Lake Tahoe:

Within the NE $\frac{1}{4}$ of the NW $\frac{1}{4}$ of Section 7, T. 15N., R. 17E., M.D.M., or from the Dam the southwest corner of said Section 7 bears South $29^{\circ} 09' 30''$ West a distance of 5,182 feet, more or less. The capacity of Lake Tahoe is approximately 744,600 AF.

Donner Lake:

Within the SE $\frac{1}{4}$ of the NE $\frac{1}{4}$ of Section 18, T. 17N., R. 16E., M.D.M., or from the Dam the Southeast corner of said Section 18 bears South $04^{\circ} 07' 14''$ East a distance of 2,981 feet, more or less. The capacity of Donner Lake is 9,500 AF.

Prosser Creek Dam (Reservoir):

Within the NW $\frac{1}{4}$ of the SW $\frac{1}{4}$ of Section 30, T. 18N., R. 17E., M.D.M., or from the Dam the Southeast corner of said Section 30 bears South $22^{\circ} 58' 48''$ West a distance of 2,006 feet, more or less. The capacity of Prosser Creek Reservoir is approximately 29,840 AF.

Boca Dam (Reservoir):

Within the SE $\frac{1}{4}$ of the SW $\frac{1}{4}$ of Section 21, T. 18N., R. 17E., M.D.M., or from the Dam the Southwest corner of said Section 21 bears South $81^{\circ} 05' 07''$ West a distance of 2,647 feet, more or less. The capacity of Boca Reservoir is approximately 40,870 AF.

Stampede Dam (Reservoir)

Within the NW $\frac{1}{4}$ of the NW $\frac{1}{4}$ of Section 28, T. 19N., R. 17E., M.D.M., or from the Dam the Northwest corner of said Section 28 bears North $36^{\circ} 08' 27''$ West a distance of 636 feet, more or less. The capacity of Stampede Reservoir is approximately 226,500 AF.

Derby Dam:

Within the N $\frac{1}{2}$ of the SW $\frac{1}{4}$ of Section 19, T. 20N., R. 23E., M.D.M.

Proposed Piece of Use of Change Application

T. 20 N. E. 24 E. M.D.B. & M.

Portions of Sections 9 and 10, Sections 11, 12, 13, 14 and 15; Portion of Sections 16, 17 and 20, Section 21, 22, 23, 24, 25, 26, 27 and 28; Portions of Sections 29, 30, 31, Sections 32, 33, 34, 35 and 36.

T. 20 N. E. 25 E. M.D.B. & M.

Sections 1, 2 and 3; Portions of Sections 4 and 5, Sections 7 through 36

T. 20 N. E. 26 E. M.D.B. & M.

Portion of Section 5, Sections 6 and 7; Portion of Sections 8 and 17, Sections 18 and 19; Portion of Sections 20 and 29, Sections 30 and 31; Portions of Section 32.

T. 21 N. E. 25 E. M.D.B. & M.

Portion of Sections 13, 23 and 24, Section 25; Portion of Sections 26, 27, 28 and 33, Sections 34, 35 and 36.

T. 21 N. E. 26 E. M.D.B. & M.

Portions of Sections 3, 7 and 8, Section 17; Portion of Section 18, Sections 19, 20, 29, 30, 31 and 32.

T. 22 N. E. 26 E. M.D.B. & M.

Portions of Sections 28, 32 and 33.

T. 19 N. E. 25 E. M.D.B. & M.

All of Sections 1 through 36

T. 19 N. E. 24 E. M.D.B. & M.

Sections 1, 2, 3, 4 and 5; Portion of Section 6, Sections 7 through 36.

T. 19 N. E. 23 E. M.D.B. & M.

Portions of Sections 1, 12, 13, 14 and 23, Sections 24 and 25; Portion of Sections 26, 27 and 34, Sections 35 and 36.

RECEIVED
SEP 13 PM 1:21
STATIONERS OFFICE

Attachment "C"**15. Remarks**

This application is filed pursuant to the provisions of N.R.S §533.515 in that it seeks to add the reservoirs described in Attachment "A" and as listed in Item 11 above as additional points of diversion for the water rights described herein. This application is also filed as part of the implementation of the operating agreement described in Section 205 (a) of Public Law 101-618. Because of the provisions of California Water Code section 1231 and 1232, California will recognize any permits issued by the Nevada State Engineer based upon this application. Therefore, it is within the jurisdiction of the Nevada State Engineer to approve this application allowing for the storage of the consumptive use component of these Nevada water rights in California.

Water diverted to storage under a permit issued hereunder will be and is the subject of applications for secondary permits for beneficial uses allowed by the Truckee River Operating Agreement at the places allowed by that Agreement. The amount of water diverted to storage under a permit issued hereunder in any one year will not be less than the full permitted duty of 4.5 AF per year. The amount of water under a permit issued hereunder which may be in storage at any one time and which may be released and used from storage in any one year will not exceed the amounts allowed by the Truckee River Operating Agreement.

If the water right described herein is not diverted to storage, the full duty of the water right will continue to be diverted at its allowed points of diversion for its manner of use.

**PRIMARY
APPLICATION FOR PERMISSION TO CHANGE POINT OF DIVERSION, MANNER
OF USE AND PLACE OF USE OF THE PUBLIC WATERS
OF THE STATE OF NEVADA HERETOFORE APPROPRIATED**

THIS SPACE FOR OFFICE USE ONLY
Date of filing in State Engineer's Office..... **APR 20 2009**
Returned to applicant for correction.....
Corrected application filed..... Map filed **FEB 26 2009** under **78034**

The applicant..... **CITY OF FERNLEY**.....

..... **595 SILVER LACE BLVD**..... of..... **FERNLEY**..., **NEVADA 89408**.....
Street and No. Or P.O. Box No City or Town

hereby makes... application for permission to change the.....

Point of diversion Place of use Manner of use Of a portion

of water heretofore appropriated under .. **Permit 73243**.....
Identify existing right by Permit, Certificate, Proof or Claim Nos. If Decreed, give title of Decree identify right in Decree.

1. The source of water is..... **TRUCKEE RIVER**.....
Name of stream, lake, underground, spring or other sources.
2. The amount of water to be changed..... **590.4 ac-ft**.....
feet, acre-feet. One second foot equals 448.83 gallons per minute.
3. The water to be used for..... **STORAGE WITH SECONDARY PERMITS FOR BENEFICIAL USES ALLOWED BY THE TRUCKEE RIVER OPERATING AGREEMENT**
Irrigation, power, mining, commercial, etc. If for stock state number and kind of animals. Must limit to one major use.
4. The water heretofore used for..... **MUNICIPAL & DOMESTIC**.....
If for stock state number and kind of animals.
5. The water is to be diverted at the following **SEE ATTACHMENT "A"**.....
Describe as being within a 40-acre subdivision of public survey and by course and distance to a section corner. If on unsurveyed land, it should be stated.
6. The existing point of diversion is located within... **Derby Dam being located in N1/2 SW1/4, Section 19, T.20N., R.23E., MDB&M...**
If point of diversion is not changed, do not answer.
7. Proposed place of use..... **The beneficial place of use will be set forth in applications for secondary permits consistent with the Truckee River Operating Agreement. The water stored under this Primary Application will be in the Lake Tahoe, Boca Reservoir, Donner Reservoir, Stampede Reservoir, Prosser Creek Reservoir, Derby Dam, and the City of Fernley Water Treatment Facility**.....
Describe by legal subdivisions. If for irrigation state number of acres to be irrigated.

8. Existing place of use...**See Attachment "B" and map filed with application 73243**
Describe by legal subdivisions. If permit is for irrigation, state number of acres irrigated. If changing place of use and/or manner of use of irrigation permit, describe acreage to be removed from irrigation.

9. Use will be from.....**1/1**.....to.....**12/31**.....of each year.
Month and Day Month and Day

10. Use permitted from.....**1/1 to 12/31**.....

11. Description of proposed works. (Under the provision of NRS 535.010 you may be required to submit plans and specifications of your diversion or storage works.)... **The Reservoirs and Diversion Works for Lake Tahoe, Boca Reservoir, Donner Reservoir, Stampede Reservoir, Prosser Creek Reservoir and Derby Dam are Complete. The City of Fernley Water Treatment Facility is currently under Construction**.....
State manner in which water is to be diverted, i.e. diversion structure, ditches, pipes and flumes or drilled well, pump and motor, etc.

12. Estimated cost of works.....**\$50,000,000**.....

13. Estimated time required to construct works.....**2.0 YEAR**.....
If well completed, describe well.

14. Estimated time required to complete the application of water to beneficial use...**N/A**...

15. Remarks: **SEE REMARKS IN ATTACHMENT "C"**.....

(775) 784-9920

Phone No.

By:.....**Lowell Patton, Director, City of Fernley**
Public Works Department.....
Print or type name clearly

.....
Signature, applicant or agent

.....**595 Silver Lace Blvd**.....
Street and No., or P.O. Box No.

.....**Fernley, NV 89408**.....
City, State, Zip Code

**APPLICATION MUST BE SIGNED
BY THE APPLICANT OR AGENT**

RECEIVED
2009 APR 20 PM 1:42
STATE ENGINEERS OFFICE

\$150 FILING FEE MUST ACCOMPANY APPLICATION

Attachment "A"

The Proposed Points of Diversion are shown on the map filed with Application: **78034**

Lake Tahoe:

Within the NE $\frac{1}{4}$ of the NW $\frac{1}{4}$ of Section 7, T. 15N., R. 17E., M.D.M., or from the Dam the southwest corner of said Section 7 bears South $29^{\circ} 09' 30''$ West a distance of 5,182 feet, more or less. The capacity of Lake Tahoe is approximately 744,600 AF.

Donner Lake:

Within the SE $\frac{1}{4}$ of the NE $\frac{1}{4}$ of Section 18, T. 17N., R. 16E., M.D.M., or from the Dam the Southeast corner of said Section 18 bears South $04^{\circ} 07' 14''$ East a distance of 2,981 feet, more or less. The capacity of Donner Lake is 9,500 AF.

Prosser Creek Dam (Reservoir):

Within the NW $\frac{1}{4}$ of the SW $\frac{1}{4}$ of Section 30, T. 18N., R. 17E., M.D.M., or from the Dam the Southeast corner of said Section 30 bears South $22^{\circ} 58' 48''$ West a distance of 2,006 feet, more or less. The capacity of Prosser Creek Reservoir is approximately 29,840 AF.

Boca Dam (Reservoir):

Within the SE $\frac{1}{4}$ of the SW $\frac{1}{4}$ of Section 21, T. 18N., R. 17E., M.D.M., or from the Dam the Southwest corner of said Section 21 bears South $81^{\circ} 05' 07''$ West a distance of 2,647 feet, more or less. The capacity of Boca Reservoir is approximately 40,870 AF.

Stampede Dam (Reservoir)

Within the NW $\frac{1}{4}$ of the NW $\frac{1}{4}$ of Section 28, T. 19N., R. 17E., M.D.M., or from the Dam the Northwest corner of said Section 28 bears North $36^{\circ} 08' 27''$ West a distance of 636 feet, more or less. The capacity of Stampede Reservoir is approximately 226,500 AF.

Derby Dam:

Within the N $\frac{1}{2}$ of the SW $\frac{1}{4}$ of Section 19, T. 20N., R. 23E., M.D.M.

Proposed Place of Use of Change Application

T. 20 N., E. 24 E., M.D.B. & M.

Portions of Sections 9 and 10, Sections 11, 12, 13, 14 and 15; Portion of Sections 16, 17 and 20, Section 21, 22, 23, 24, 25, 26, 27 and 28; Portions of Sections 29, 30, 31, Sections 32, 33, 34, 35 and 36.

T. 20 N., E. 25 E., M.D.B. & M.

Sections 1, 2 and 3; Portions of Sections 4 and 5, Sections 7 through 36

T. 20 N., E. 26 E., M.D.B. & M.

Portion of Section 5, Sections 6 and 7; Portion of Sections 8 and 17, Sections 18 and 19; Portion of Sections 20 and 29, Sections 30 and 31; Portion of Section 32.

T. 21 N., E. 25 E., M.D.B. & M.

Portion of Sections 13, 23 and 24, Section 25; Portion of Sections 26, 27, 28 and 33, Sections 34, 35 and 36.

T. 21 N., E. 26 E., M.D.B. & M.

Portions of Sections 5, 7 and 8, Section 17; Portion of Section 18, Sections 19, 20, 29, 30, 31 and 32.

T. 22 N., E. 26 E., M.D.B. & M.

Portions of Sections 28, 32 and 33.

T. 19 N., E. 25 E., M.D.B. & M.

All of Sections 1 through 36

T. 19 N., E. 24 E., M.D.B. & M.

Sections 1, 2, 3, 4 and 5; Portion of Section 6, Sections 7 through 36.

T. 19 N., E. 23 E., M.D.B. & M.

Portions of Sections 1, 12, 13, 14 and 23, Sections 24 and 25; Portion of Sections 26, 27 and 34, Sections 35 and 36.

RECEIVED
05 SEP 13 PM 1:21
STATE LIGNERS OFFICE

Attachment "C"**15. Remarks**

This application is filed pursuant to the provisions of N.R.S §533.515 in that it seeks to add the reservoirs described in Attachment "A" and as listed in Item 11 above as additional points of diversion for the water rights described herein. This application is also filed as part of the implementation of the operating agreement described in Section 205 (a) of Public Law 101-618. Because of the provisions of California Water Code section 1231 and 1232, California will recognize any permits issued by the Nevada State Engineer based upon this application. Therefore, it is within the jurisdiction of the Nevada State Engineer to approve this application allowing for the storage of the consumptive use component of these Nevada water rights in California.

Water diverted to storage under a permit issued hereunder will be and is the subject of applications for secondary permits for beneficial uses allowed by the Truckee River Operating Agreement at the places allowed by that Agreement. The amount of water diverted to storage under a permit issued hereunder in any one year will not be less than the full permitted duty of 4.5 AF per year. The amount of water under a permit issued hereunder which may be in storage at any one time and which may be released and used from storage in any one year will not exceed the amounts allowed by the Truckee River Operating Agreement.

If the water right described herein is not diverted to storage, the full duty of the water right will continue to be diverted at its allowed points of diversion for its manner of use.

**PRIMARY
APPLICATION FOR PERMISSION TO CHANGE POINT OF DIVERSION, MANNER
OF USE AND PLACE OF USE OF THE PUBLIC WATERS
OF THE STATE OF NEVADA HERETOFORE APPROPRIATED**

THIS SPACE FOR OFFICE USE ONLY

Date of filing in State Engineer's Office..... **APR 20 2009**

Returned to applicant for correction.....

Corrected application filed..... Map filed **FEB 26 2009** under
78034

The applicant..... **CITY OF FERNLEY**

..... **595 SILVER LACE BLVD** of **FERNLEY** .., NEVADA **89408**

Street and No. Or P.O. Box No

City or Town

hereby makes... application for permission to change the.....

Point of diversion Place of use Manner of use Of a portion

of water heretofore appropriated under .. **Permit 73164**

Identify existing right by Permit, Certificate, Proof or Claim Nos. If Decreed, give title of Decree identify right in Decree.

1. The source of water is..... **TRUCKEE RIVER**

Name of stream, lake, underground, spring or other sources.

2. The amount of water to be changed..... **144.0 ac-ft**

feet, acre-feet. One second foot equals 448.83 gallons per minute.

3. The water to be used for..... **STORAGE WITH SECONDARY PERMITS FOR
BENEFICAL USES ALLOWED BY THE TRUCKEE RIVER OPERATING
AGREEMENT**

Irrigation, power, mining, commercial, etc. If for stock state number and kind of animals. Must limit to one major use.

4. The water heretofore used for..... **MUNICIPAL & DOMESTIC**

If for stock state number and kind of animals.

5. The water is to be diverted at the following **SEE ATTACHMENT "A"**

Describe as being within a 40-acre subdivision of public survey and by course and distance to a section corner. If on unsurveyed land, it should be stated.

6. The existing point of diversion is located within... **Derby Dam being located in N1/2
SW1/4, Section 19, T.20N., R.23E., MDB&M...**

If point of diversion is not changed, do not answer.

7. Proposed place of use..... **The beneficial place of use will be set forth in applications for
secondary permits consistent with the Truckee River Operating Agreement. The water
stored under this Primary Application will be in the Lake Tahoe, Boca Reservoir,
Donner Reservoir, Stampede Reservoir, Prosser Creek Reservoir, Derby Dam, and the
City of Fernley Water Treatment Facility**

Describe by legal subdivisions. If for irrigation state number of acres to be irrigated.

8. Existing place of use...**See Attachment "B" and map filed with application 73164**
Describe by legal subdivisions. If permit is for irrigation, state number of acres irrigated. If changing place of use and/or manner of use of irrigation permit, describe acreage to be removed from irrigation. *(see map 7138E) mm*

9. Use will be from.....**1/1**.....to.....**12/31**.....of each year.
Month and Day Month and Day

10. Use permitted from.....**1/1 to 12/31**.....

11. Description of proposed works. (Under the provision of NRS 535.010 you may be required to submit plans and specifications of your diversion or storage works.).... **The Reservoirs and Diversion Works for Lake Tahoe, Boca Reservoir, Donner Reservoir, Stampede Reservoir, Prosser Creek Reservoir and Derby Dam are Complete. The City of Fernley Water Treatment Facility is currently under Construction.**.....
State manner in which water is to be diverted, i.e. diversion structure, ditches, pipes and flumes or drilled well, pump and motor, etc.

12. Estimated cost of works.....**\$50,000,000**.....

13. Estimated time required to construct works.....**2.0 YEAR**.....
If well completed, describe well.

14. Estimated time required to complete the application of water to beneficial use...**N/A**...

15. Remarks: **SEE REMARKS IN ATTACHMENT "C"**

(775) 784-9920

Phone No.

By:.....**Lowell Patton, Director, City of Fernley Public Works Department**.....
Print or type name clearly

.....
Signature, applicant or agent

.....**595 Silver Lace Blvd**.....
Street and No., or P.O. Box No.

.....**Fernley, NV 89408**

City, State, Zip Code

APPLICATION MUST BE SIGNED BY THE APPLICANT OR AGENT

RECEIVED
2009 APR 20 PM 1:43
STATE ENGINEERS OFFICE

\$150 FILING FEE MUST ACCOMPANY APPLICATION

Attachment "A"

The Proposed Points of Diversion are shown on the map filed with Application: **78034**

Lake Tahoe:

Within the NE $\frac{1}{4}$ of the NW $\frac{1}{4}$ of Section 7, T. 15N., R. 17E., M.D.M., or from the Dam the southwest corner of said Section 7 bears South $29^{\circ} 09' 30''$ West a distance of 5,182 feet, more or less. The capacity of Lake Tahoe is approximately 744,600 AF.

Donner Lake:

Within the SE $\frac{1}{4}$ of the NE $\frac{1}{4}$ of Section 18, T. 17N., R. 16E., M.D.M., or from the Dam the Southeast corner of said Section 18 bears South $04^{\circ} 07' 14''$ East a distance of 2,981 feet, more or less. The capacity of Donner Lake is 9,500 AF.

Prosser Creek Dam (Reservoir):

Within the NW $\frac{1}{4}$ of the SW $\frac{1}{4}$ of Section 30, T. 18N., R. 17E., M.D.M., or from the Dam the Southeast corner of said Section 30 bears South $22^{\circ} 58' 48''$ West a distance of 2,006 feet, more or less. The capacity of Prosser Creek Reservoir is approximately 29,840 AF.

Boca Dam (Reservoir):

Within the SE $\frac{1}{4}$ of the SW $\frac{1}{4}$ of Section 21, T. 18N., R. 17E., M.D.M., or from the Dam the Southwest corner of said Section 21 bears South $81^{\circ} 05' 07''$ West a distance of 2,647 feet, more or less. The capacity of Boca Reservoir is approximately 40,870 AF.

Stampede Dam (Reservoir)

Within the NW $\frac{1}{4}$ of the NW $\frac{1}{4}$ of Section 28, T. 19N., R. 17E., M.D.M., or from the Dam the Northwest corner of said Section 28 bears North $36^{\circ} 08' 27''$ West a distance of 636 feet, more or less. The capacity of Stampede Reservoir is approximately 226,500 AF.

Derby Dam:

Within the N $\frac{1}{2}$ of the SW $\frac{1}{4}$ of Section 19, T. 20N., R. 23E., M.D.M.

ATTACHMENT B

PROPOSED PLACE OF USE:

T.20 N., R. 24 E., M.D.B. & M.

Portion of Sections 9 and 10, Sections 11, 12, 13, 14 and 15;
Portion of Sections 16, 17, and 20, Sections 21, 22, 23, 24, 25, 26, 27 and 28;
Portion of Sections 29, 30, and 31, Sections 32, 33, 34, 35 and 36.

T.20 N., R. 25 E., M.D.B. & M.

Sections 1, 2 and 3;
Portion of Sections 4 and 5, Sections 7 through 36.

T.20 N., R. 26 E., M.D.B. & M.

Portion of Section 6, Sections 8 and 7; Portion of
Sections 8 and 17, Sections 18 and 19; Portion of
Sections 20 and 29, Sections 30 and 31; Portion of
Section 32.

T.21 N., R. 25 E., M.D.B. & M.

Portion of Sections 13, 23 and 24, Section 25;
Portion of Sections 26, 27, 28 and 33, Sections 34, 35 and 36

T.21 N., R. 26 E., M.D.B. & M.

Portion of Sections 5, 7 and 8, Section 17;
Portion of Section 18, Sections 19, 20, 29, 30, 31, and 32.

T.22 N., R. 26 E., M.D.B. & M.

Portion of Sections 28, 32 and 33.

T.19 N., R. 25 E., M.D.B. & M.

All of Sections 1 through 36.

T.19 N., R. 24 E., M.D.B. & M.

Sections 1, 2, 3, 4 and 5;
Portion of Section 6, Sections 7 through 36.

T.19 N., R. 23 E., M.D.B. & M.

Portion of Sections 1, 12, 13, 14 and 23, Sections 24 and 25;
Portion of Sections 26, 27 and 34, Sections 35 and 36.

For Proposed POU use map on file under Application No. 71982-78034

For Existing POU use map to accompany these 5 applications.

Attachment "C"**15. Remarks**

This application is filed pursuant to the provisions of N.R.S §533.515 in that it seeks to add the reservoirs described in Attachment "A" and as listed in Item 11 above as additional points of diversion for the water rights described herein. This application is also filed as part of the implementation of the operating agreement described in Section 205 (a) of Public Law 101-618. Because of the provisions of California Water Code section 1231 and 1232, California will recognize any permits issued by the Nevada State Engineer based upon this application. Therefore, it is within the jurisdiction of the Nevada State Engineer to approve this application allowing for the storage of the consumptive use component of these Nevada water rights in California.

Water diverted to storage under a permit issued hereunder will be and is the subject of applications for secondary permits for beneficial uses allowed by the Truckee River Operating Agreement at the places allowed by that Agreement. The amount of water diverted to storage under a permit issued hereunder in any one year will not be less than the full permitted duty of 4.5 AF per year. The amount of water under a permit issued hereunder which may be in storage at any one time and which may be released and used from storage in any one year will not exceed the amounts allowed by the Truckee River Operating Agreement.

If the water right described herein is not diverted to storage, the full duty of the water right will continue to be diverted at its allowed points of diversion for its manner of use.

- 8. Existing place of use...**See Attachment "B" and map filed with application 73163**
Describe by legal subdivisions. If permit is for irrigation, state number of acres irrigated. If changing place of use and/or manner of use of irrigation permit, describe acreage to be removed from irrigation. *(see map 71382) mm 4/21/09*
- 9. Use will be from.....**1/1**.....to.....**12/31**.....of each year.
Month and Day Month and Day
- 10. Use permitted from.....**1/1 to 12/31**.....
- 11. Description of proposed works. (Under the provision of NRS 535.010 you may be required to submit plans and specifications of your diversion or storage works.).... **The Reservoirs and Diversion Works for Lake Tahoe, Boca Reservoir, Donner Reservoir, Stampede Reservoir, Prosser Creek Reservoir and Derby Dam are Complete. The City of Fernley Water Treatment Facility is currently under construction**.....
State manner in which water is to be diverted, i.e. diversion structure, ditches, pipes and flumes or drilled well, pump and motor, etc.
- 12. Estimated cost of works.....**\$50,000,000**.....
- 13. Estimated time required to construct works.....**2.0 YEAR**.....
If well completed, describe well.
- 14. Estimated time required to complete the application of water to beneficial use...**N/A**...
- 15. Remarks: **SEE REMARKS IN ATTACHMENT "C"**.....

(775) 784-9920

Phone No.

By:.....**Lowell Patton, Director, City of Fernley Public Works Department**.....

Print or type name clearly

.....
Signature, applicant or agent

.....**595 Silver Lace Blvd.**.....

Street and No., or P.O. Box No.

.....**Fernley, NV 89408**.....

City, State, Zip Code

APPLICATION MUST BE SIGNED BY THE APPLICANT OR AGENT

**RECEIVED
2009 APR 20 PM 1:43
STATE ENGINEERS OFFICE**

\$150 FILING FEE MUST ACCOMPANY APPLICATION

Attachment "A"

The Proposed Points of Diversion are shown on the map filed with Application: **78034**

Lake Tahoe:

Within the NE $\frac{1}{4}$ of the NW $\frac{1}{4}$ of Section 7, T. 15N., R. 17E., M.D.M., or from the Dam the southwest corner of said Section 7 bears South $29^{\circ} 09' 30''$ West a distance of 5,182 feet, more or less. The capacity of Lake Tahoe is approximately 744,600 AF.

Donner Lake:

Within the SE $\frac{1}{4}$ of the NE $\frac{1}{4}$ of Section 18, T. 17N., R. 16E., M.D.M., or from the Dam the Southeast corner of said Section 18 bears South $04^{\circ} 07' 14''$ East a distance of 2,981 feet, more or less. The capacity of Donner Lake is 9,500 AF.

Prosser Creek Dam (Reservoir):

Within the NW $\frac{1}{4}$ of the SW $\frac{1}{4}$ of Section 30, T. 18N., R. 17E., M.D.M., or from the Dam the Southeast corner of said Section 30 bears South $22^{\circ} 58' 48''$ West a distance of 2,006 feet, more or less. The capacity of Prosser Creek Reservoir is approximately 29,840 AF.

Boca Dam (Reservoir):

Within the SE $\frac{1}{4}$ of the SW $\frac{1}{4}$ of Section 21, T. 18N., R. 17E., M.D.M., or from the Dam the Southwest corner of said Section 21 bears South $81^{\circ} 05' 07''$ West a distance of 2,647 feet, more or less. The capacity of Boca Reservoir is approximately 40,870 AF.

Stampede Dam (Reservoir)

Within the NW $\frac{1}{4}$ of the NW $\frac{1}{4}$ of Section 28, T. 19N., R. 17E., M.D.M., or from the Dam the Northwest corner of said Section 28 bears North $36^{\circ} 08' 27''$ West a distance of 636 feet, more or less. The capacity of Stampede Reservoir is approximately 226,500 AF.

Derby Dam:

Within the N $\frac{1}{2}$ of the SW $\frac{1}{4}$ of Section 19, T. 20N., R. 23E., M.D.M.

ATTACHMENT B

PROPOSED PLACE OF USE:

T.20 N., R. 24 E., M.D.B. & M.

Portion of Sections 9 and 10, Sections 11, 12, 13, 14 and 15;
Portion of Sections 16, 17, and 20, Sections 21, 22, 23, 24, 25, 26, 27 and 28;
Portion of Sections 29, 30, and 31, Sections 32, 33, 34, 35 and 36.

T.20 N., R. 25 E., M.D.B. & M.

Sections 1, 2 and 3;
Portion of Sections 4 and 5, Sections 7 through 36.

T.20 N., R. 26 E., M.D.B. & M.

Portion of Section 5, Sections 6 and 7; Portion of
Sections 8 and 17, Sections 18 and 19; Portion of
Sections 20 and 29, Sections 30 and 31; Portion of
Section 32.

T.21 N., R. 25 E., M.D.B. & M.

Portion of Sections 13, 23 and 24, Section 25;
Portion of Sections 26, 27, 28 and 33, Sections 34, 35 and 36

T.21 N., R. 26 E., M.D.B. & M.

Portion of Sections 5, 7 and 8, Section 17;
Portion of Section 18, Sections 19, 20, 29, 30, 31, and 32.

T.22 N., R. 26 E., M.D.B. & M.

Portion of Sections 28, 32 and 33.

T.19 N., R. 26 E., M.D.B. & M.

All of Sections 1 through 36.

T.19 N., R. 24 E., M.D.B. & M.

Sections 1, 2, 3, 4 and 5;
Portion of Section 8, Sections 7 through 36.

T.19 N., R. 23 E., M.D.B. & M.

Portion of Sections 1, 12, 13, 14 and 23, Sections 24 and 25;
Portion of Sections 26, 27 and 34, Sections 35 and 36.

For Proposed POU use map on file under Application No. ¹⁸⁰³⁻¹ 71902 mm

For Existing POU use map to accompany these 5 applications.

Attachment "C"**15. Remarks**

This application is filed pursuant to the provisions of N.R.S §533.515 in that it seeks to add the reservoirs described in Attachment "A" and as listed in Item 11 above as additional points of diversion for the water rights described herein. This application is also filed as part of the implementation of the operating agreement described in Section 205 (a) of Public Law 101-618. Because of the provisions of California Water Code section 1231 and 1232, California will recognize any permits issued by the Nevada State Engineer based upon this application. Therefore, it is within the jurisdiction of the Nevada State Engineer to approve this application allowing for the storage of the consumptive use component of these Nevada water rights in California.

Water diverted to storage under a permit issued hereunder will be and is the subject of applications for secondary permits for beneficial uses allowed by the Truckee River Operating Agreement at the places allowed by that Agreement. The amount of water diverted to storage under a permit issued hereunder in any one year will not be less than the full permitted duty of 4.5 AF per year. The amount of water under a permit issued hereunder which may be in storage at any one time and which may be released and used from storage in any one year will not exceed the amounts allowed by the Truckee River Operating Agreement.

If the water right described herein is not diverted to storage, the full duty of the water right will continue to be diverted at its allowed points of diversion for its manner of use.

**PRIMARY
APPLICATION FOR PERMISSION TO CHANGE POINT OF DIVERSION, MANNER
OF USE AND PLACE OF USE OF THE PUBLIC WATERS
OF THE STATE OF NEVADA HERETOFORE APPROPRIATED**

THIS SPACE FOR OFFICE USE ONLY	
APR 20 2009	
Date of filing in State Engineer's Office.....	
Returned to applicant for correction.....	
Corrected application filed.....	Map filed FEB 26 2009 under 78034

The applicant.....**CITY OF FERNLEY**.....

.....**595 SILVER LACE BLVD**.....of.....**FERNLEY**..., NEVADA **89408**.....
Street and No. Or P.O. Box No City or Town

hereby makes... application for permission to change the.....

Point of diversion Place of use Manner of use Of a portion

of water heretofore appropriated under **..Permit 73162**.....
Identify existing right by Permit, Certificate, Proof or Claim Nos. If Decreed, give title of Decree identify right in Decree.

1. The source of water is.....**TRUCKEE RIVER**.....
Name of stream, lake, underground, spring or other sources.

2. The amount of water to be changed.....**72.36 ac-ft**.....
feet, acre-feet. One second foot equals 448.83 gallons per minute.

3. The water to be used for.....**STORAGE WITH SECONDARY PERMITS FOR
BENEFICIAL USES ALLOWED BY THE TRUCKEE RIVER OPERATING
AGREEMENT**
Irrigation, power, mining, commercial, etc. If for stock state number and kind of animals. Must limit to one major use.

4. The water heretofore used for.....**MUNICIPAL & DOMESTIC**.....
If for stock state number and kind of animals.

5. The water is to be diverted at the following **SEE ATTACHMENT "A"**.....
Describe as being within a 40-acre subdivision of public survey and by course and distance to a section corner. If on unsurveyed land, it should be stated.

6. The existing point of diversion is located within... **Derby Dam being located in N1/2
SW1/4, Section 19, T.20N., R.23E., MDB&M...**
If point of diversion is not changed, do not answer.

7. Proposed place of use.....**The beneficial place of use will be set forth in applications for
secondary permits consistent with the Truckee River Operating Agreement. The water
stored under this Primary Application will be in the Lake Tahoe, Boca Reservoir,
Donner Reservoir, Stampede Reservoir, Prosser Creek Reservoir, Derby Dam, and the
City of Fernley Water Treatment Facility**.....
Describe by legal subdivisions. If for irrigation state number of acres to be irrigated.

- 8. Existing place of use...**See Attachment "B" and map filed with application 73162**
Describe by legal subdivisions. If permit is for irrigation, state number of acres irrigated. If changing place of use and/or manner of use of irrigation permit, describe acreage to be removed from irrigation.
- 9. Use will be from.....1/1.....to.....12/31.....of each year.
Month and Day Month and Day
- 10. Use permitted from.....1/1 to 12/31.....
- 11. Description of proposed works. (Under the provision of NRS 535.010 you may be required to submit plans and specifications of your diversion or storage works.)... **The Reservoirs and Diversion Works for Lake Tahoe, Boca Reservoir, Donner Reservoir, Stampede Reservoir, Prosser Creek Reservoir and Derby Dam are Complete. The City of Fernley Water Treatment Facility is currently under Construction.....**
State manner in which water is to be diverted, i.e. diversion structure, ditches, pipes and flumes or drilled well, pump and motor, etc.
- 12. Estimated cost of works.....**\$50,000,000**.....
- 13. Estimated time required to construct works.....**2.0 YEAR**.....
If well completed, describe well.
- 14. Estimated time required to complete the application of water to beneficial use...N/A...
- 15. Remarks: **SEE REMARKS IN ATTACHMENT "C"**.....

(775) 784-9920

Phone No.

By:.....**Lowell Patton, Director, City of Fernley Public Works Department**.....

Print or type name clearly

Signature, applicant or agent

.....**595 Silver Lace Blvd**.....

Street and No., or P.O. Box No.

.....**Fernley, NV 89408**.....

City, State, Zip Code

APPLICATION MUST BE SIGNED BY THE APPLICANT OR AGENT

STATE ENGINEERS OFFICE
2009 APR 20 PM 1:43
RECEIVED

\$150 FILING FEE MUST ACCOMPANY APPLICATION

Attachment "A"

The Proposed Points of Diversion are shown on the map filed with Application: **78034**

Lake Tahoe:

Within the NE $\frac{1}{4}$ of the NW $\frac{1}{4}$ of Section 7, T. 15N., R. 17E., M.D.M., or from the Dam the southwest corner of said Section 7 bears South $29^{\circ} 09' 30''$ West a distance of 5,182 feet, more or less. The capacity of Lake Tahoe is approximately 744,600 AF.

Donner Lake:

Within the SE $\frac{1}{4}$ of the NE $\frac{1}{4}$ of Section 18, T. 17N., R. 16E., M.D.M., or from the Dam the Southeast corner of said Section 18 bears South $04^{\circ} 07' 14''$ East a distance of 2,981 feet, more or less. The capacity of Donner Lake is 9,500 AF.

Prosser Creek Dam (Reservoir):

Within the NW $\frac{1}{4}$ of the SW $\frac{1}{4}$ of Section 30, T. 18N., R. 17E., M.D.M., or from the Dam the Southeast corner of said Section 30 bears South $22^{\circ} 58' 48''$ West a distance of 2,006 feet, more or less. The capacity of Prosser Creek Reservoir is approximately 29,840 AF.

Boca Dam (Reservoir):

Within the SE $\frac{1}{4}$ of the SW $\frac{1}{4}$ of Section 21, T. 18N., R. 17E., M.D.M., or from the Dam the Southwest corner of said Section 21 bears South $81^{\circ} 05' 07''$ West a distance of 2,647 feet, more or less. The capacity of Boca Reservoir is approximately 40,870 AF.

Stampede Dam (Reservoir)

Within the NW $\frac{1}{4}$ of the NW $\frac{1}{4}$ of Section 28, T. 19N., R. 17E., M.D.M., or from the Dam the Northwest corner of said Section 28 bears North $36^{\circ} 08' 27''$ West a distance of 636 feet, more or less. The capacity of Stampede Reservoir is approximately 226,500 AF.

Derby Dam:

Within the N $\frac{1}{2}$ of the SW $\frac{1}{4}$ of Section 19, T. 20N., R. 23E., M.D.M.

ATTACHMENT B

PROPOSED PLACE OF USE:

T.20 N., R. 24 E., M.D.B. & M.

Portion of Sections 9 and 10, Sections 11, 12, 13, 14 and 15;
Portion of Sections 16, 17, and 20, Sections 21, 22, 23, 24, 25, 26, 27 and 28;
Portion of Sections 29, 30, and 31, Sections 32, 33, 34, 35 and 36.

T.20 N., R. 25 E., M.D.B. & M.

Sections 1, 2 and 3;
Portion of Sections 4 and 5, Sections 7 through 36.

T.20 N., R. 26 E., M.D.B. & M.

Portion of Section 5, Sections 6 and 7; Portion of
Sections 8 and 17, Sections 18 and 19; Portion of
Sections 20 and 28, Sections 30 and 31; Portion of
Section 32.

T.21 N., R. 25 E., M.D.B. & M.

Portion of Sections 13, 23 and 24, Section 25;
Portion of Sections 26, 27, 28 and 33, Sections 34, 35 and 36

T.21 N., R. 26 E., M.D.B. & M.

Portion of Sections 5, 7 and 8, Section 17;
Portion of Section 18, Sections 19, 20, 29, 30, 31, and 32.

T.22 N., R. 26 E., M.D.B. & M.

Portion of Sections 28, 32 and 33.

T.19 N., R. 26 E., M.D.B. & M.

All of Sections 1 through 36.

T.19 N., R. 24 E., M.D.B. & M.

Sections 1, 2, 3, 4 and 5;
Portion of Section 6, Sections 7 through 36.

T.19 N., R. 23 E., M.D.B. & M.

Portion of Sections 1, 12, 13, 14 and 23, Sections 24 and 25;
Portion of Sections 26, 27 and 34, Sections 35 and 36.

For Proposed POU use map on file under Application No. 21382 78034 *mm*
For Existing POU use map to accompany these 5 applications.

Attachment "C"

15. Remarks

This application is filed pursuant to the provisions of N.R.S §533.515 in that it seeks to add the reservoirs described in Attachment "A" and as listed in Item 11 above as additional points of diversion for the water rights described herein. This application is also filed as part of the implementation of the operating agreement described in Section 205 (a) of Public Law 101-618. Because of the provisions of California Water Code section 1231 and 1232, California will recognize any permits issued by the Nevada State Engineer based upon this application. Therefore, it is within the jurisdiction of the Nevada State Engineer to approve this application allowing for the storage of the consumptive use component of these Nevada water rights in California.

Water diverted to storage under a permit issued hereunder will be and is the subject of applications for secondary permits for beneficial uses allowed by the Truckee River Operating Agreement at the places allowed by that Agreement. The amount of water diverted to storage under a permit issued hereunder in any one year will not be less than the full permitted duty of 4.5 AF per year. The amount of water under a permit issued hereunder which may be in storage at any one time and which may be released and used from storage in any one year will not exceed the amounts allowed by the Truckee River Operating Agreement.

If the water right described herein is not diverted to storage, the full duty of the water right will continue to be diverted at its allowed points of diversion for its manner of use.

**PRIMARY
APPLICATION FOR PERMISSION TO CHANGE POINT OF DIVERSION, MANNER
OF USE AND PLACE OF USE OF THE PUBLIC WATERS
OF THE STATE OF NEVADA HERETOFORE APPROPRIATED**

THIS SPACE FOR OFFICE USE ONLY

Date of filing in State Engineer's Office..... **APR 20 2009**

Returned to applicant for correction.....

Corrected application filed..... Map filed **FEB 26 2009** under **78034**

The applicant..... **CITY OF FERNLEY**

..... **595 SILVER LACE BLVD.**..... of..... **FERNLEY**....., **NEVADA 89408**.....
Street and No. Or P.O. Box No City or Town

hereby makes... application for permission to change the.....

Point of diversion Place of use Manner of use Of a portion

of water heretofore appropriated under **..Permit 73161**.....
Identify existing right by Permit, Certificate, Proof or Claim Nos. If Decreed, give title of Decree identify right in Decree.

1. The source of water is..... **TRUCKEE RIVER**.....
Name of stream, lake, underground, spring or other sources.
2. The amount of water to be changed..... **95.63 ac-ft**.....
feet, acre-feet. One second foot equals 448.83 gallons per minute.
3. The water to be used for..... **STORAGE WITH SECONDARY PERMITS FOR BENEFICIAL USES ALLOWED BY THE TRUCKEE RIVER OPERATING AGREEMENT**
Irrigation, power, mining, commercial, etc. If for stock state number and kind of animals. Must limit to one major use.
4. The water heretofore used for..... **MUNICIPAL & DOMESTIC**.....
If for stock state number and kind of animals.
5. The water is to be diverted at the following **SEE ATTACHMENT "A"**.....
Describe as being within a 40-acre subdivision of public survey and by course and distance to a section corner. If on unsurveyed land, it should be stated.
6. The existing point of diversion is located within... **Derby Dam being located in N1/2 SW1/4, Section 19, T.20N., R.23E., MDB&M...**
If point of diversion is not changed, do not answer.
7. Proposed place of use..... **The beneficial place of use will be set forth in applications for secondary permits consistent with the Truckee River Operating Agreement. The water stored under this Primary Application will be in the Lake Tahoe, Boca Reservoir, Donner Reservoir, Stampede Reservoir, Prosser Creek Reservoir, Derby Dam, and the City of Fernley Water Treatment Facility**.....
Describe by legal subdivisions. If for irrigation state number of acres to be irrigated.

- 8. Existing place of use...**See Attachment "B" and map filed with application 73161**
Describe by legal subdivisions. If permit is for irrigation, state number of acres irrigated. If changing place of use and/or manner of use of irrigation permit, describe acreage to be removed from irrigation.
- 9. Use will be from.....**1/1**.....to.....**12/31**.....of each year.
Month and Day Month and Day
- 10. Use permitted from.....**1/1 to 12/31**.....
- 11. Description of proposed works. (Under the provision of NRS 535.010 you may be required to submit plans and specifications of your diversion or storage works.).... **The Reservoirs and Diversion Works for Lake Tahoe, Boca Reservoir, Donner Reservoir, Stampede Reservoir, Prosser Creek Reservoir and Derby Dam are Complete. The City of Fernley Water Treatment Facility is currently under Construction**.....
State manner in which water is to be diverted, i.e. diversion structure, ditches, pipes and flumes or drilled well, pump and motor, etc.
- 12. Estimated cost of works.....**\$50,000,000**.....
- 13. Estimated time required to construct works.....**2.0 YEAR**.....
If well completed, describe well.
- 14. Estimated time required to complete the application of water to beneficial use...**N/A**...
- 15. Remarks: **SEE REMARKS IN ATTACHMENT "C"**.....

(775) 784-9920

Phone No.

By:.....**Lowell Patton, Director, City of Fernley**
Public Works Department.....

Print or type name clearly

.....
Signature, applicant or agent

.....**595 Silver Lace Blvd**.....

Street and No., or P.O. Box No.

.....**Fernley, NV 89408**.....

City, State, Zip Code

**APPLICATION MUST BE SIGNED
BY THE APPLICANT OR AGENT**

RECEIVED
2009 APR 20 PM 1:44
STATE ENGINEERS OFFICE

\$150 FILING FEE MUST ACCOMPANY APPLICATION

Attachment "A"

The Proposed Points of Diversion are shown on the map filed with Application: 78034

Lake Tahoe:

Within the NE $\frac{1}{4}$ of the NW $\frac{1}{4}$ of Section 7, T. 15N., R. 17E., M.D.M., or from the Dam the southwest corner of said Section 7 bears South $29^{\circ} 09' 30''$ West a distance of 5,182 feet, more or less. The capacity of Lake Tahoe is approximately 744,600 AF.

Donner Lake:

Within the SE $\frac{1}{4}$ of the NE $\frac{1}{4}$ of Section 18, T. 17N., R. 16E., M.D.M., or from the Dam the Southeast corner of said Section 18 bears South $04^{\circ} 07' 14''$ East a distance of 2,981 feet, more or less. The capacity of Donner Lake is 9,500 AF.

Prosser Creek Dam (Reservoir):

Within the NW $\frac{1}{4}$ of the SW $\frac{1}{4}$ of Section 30, T. 18N., R. 17E., M.D.M., or from the Dam the Southeast corner of said Section 30 bears South $22^{\circ} 58' 48''$ West a distance of 2,006 feet, more or less. The capacity of Prosser Creek Reservoir is approximately 29,840 AF.

Boca Dam (Reservoir):

Within the SE $\frac{1}{4}$ of the SW $\frac{1}{4}$ of Section 21, T. 18N., R. 17E., M.D.M., or from the Dam the Southwest corner of said Section 21 bears South $81^{\circ} 05' 07''$ West a distance of 2,647 feet, more or less. The capacity of Boca Reservoir is approximately 40,870 AF.

Stampede Dam (Reservoir)

Within the NW $\frac{1}{4}$ of the NW $\frac{1}{4}$ of Section 28, T. 19N., R. 17E., M.D.M., or from the Dam the Northwest corner of said Section 28 bears North $36^{\circ} 08' 27''$ West a distance of 636 feet, more or less. The capacity of Stampede Reservoir is approximately 226,500 AF.

Derby Dam:

Within the N $\frac{1}{2}$ of the SW $\frac{1}{4}$ of Section 19, T. 20N., R. 23E., M.D.M.

ATTACHMENT B

78352

PROPOSED PLACE OF USE:

T.20 N., R. 24 E., M.D.B. & M.

Portion of Sections 9 and 10, Sections 11, 12, 13, 14 and 15;
Portion of Sections 16, 17, and 20, Sections 21, 22, 23, 24, 25, 26, 27 and 28;
Portion of Sections 29, 30, and 31, Sections 32, 33, 34, 35 and 36.

T.20 N., R. 25 E., M.D.B. & M.

Sections 1, 2 and 3;
Portion of Sections 4 and 5, Sections 7 through 36.

T.20 N., R. 26 E., M.D.B. & M.

Portion of Section 5, Sections 6 and 7; Portion of
Sections 8 and 17, Sections 18 and 19; Portion of
Sections 20 and 29, Sections 30 and 31; Portion of
Section 32.

T.21 N., R. 26 E., M.D.B. & M.

Portion of Sections 13, 23 and 24, Section 25;
Portion of Sections 26, 27, 28 and 33, Sections 34, 35 and 36

T.21 N., R. 28 E., M.D.B. & M.

Portion of Sections 5, 7 and 8, Section 17;
Portion of Section 18, Sections 19, 20, 29, 30, 31, and 32.

T.22 N., R. 26 E., M.D.B. & M.

Portion of Sections 28, 32 and 33.

T.19 N., R. 25 E., M.D.B. & M.

All of Sections 1 through 36.

T.19 N., R. 24 E., M.D.B. & M.

Sections 1, 2, 3, 4 and 5;
Portion of Section 6, Sections 7 through 36.

T.19 N., R. 23 E., M.D.B. & M.

Portion of Sections 1, 12, 13, 14 and 23, Sections 24 and 25;
Portion of Sections 26, 27 and 34, Sections 35 and 36.

For Proposed POU use map on file under Application No. 91982-
78034 mm 4/21/09

For Existing POU use map to accompany these 5 applications.

Attachment "C"**15. Remarks**

This application is filed pursuant to the provisions of N.R.S §533.515 in that it seeks to add the reservoirs described in Attachment "A" and as listed in Item 11 above as additional points of diversion for the water rights described herein. This application is also filed as part of the implementation of the operating agreement described in Section 205 (a) of Public Law 101-618. Because of the provisions of California Water Code section 1231 and 1232, California will recognize any permits issued by the Nevada State Engineer based upon this application. Therefore, it is within the jurisdiction of the Nevada State Engineer to approve this application allowing for the storage of the consumptive use component of these Nevada water rights in California.

Water diverted to storage under a permit issued hereunder will be and is the subject of applications for secondary permits for beneficial uses allowed by the Truckee River Operating Agreement at the places allowed by that Agreement. The amount of water diverted to storage under a permit issued hereunder in any one year will not be less than the full permitted duty of 4.5 AF per year. The amount of water under a permit issued hereunder which may be in storage at any one time and which may be released and used from storage in any one year will not exceed the amounts allowed by the Truckee River Operating Agreement.

If the water right described herein is not diverted to storage, the full duty of the water right will continue to be diverted at its allowed points of diversion for its manner of use.

**PRIMARY
APPLICATION FOR PERMISSION TO CHANGE POINT OF DIVERSION, MANNER
OF USE AND PLACE OF USE OF THE PUBLIC WATERS
OF THE STATE OF NEVADA HERETOFORE APPROPRIATED**

THIS SPACE FOR OFFICE USE ONLY	
Date of filing in State Engineer's Office.....	APR 20 2009
Returned to applicant for correction.....	
Corrected application filed.....	Map filed FEB 26 2009 under 78034

The applicant.....**CITY OF FERNLEY**.....

.....**595 SILVER LACE BLVD**.....of.....**FERNLEY**..., NEVADA **89408**.....
Street and No. Or P.O. Box No City or Town

hereby makes... application for permission to change the.....

Point of diversion Place of use Manner of use Of a portion

of water heretofore appropriated under **Permit 73142**.....
Identify existing right by Permit, Certificate, Proof or Claim Nos. If Decreed, give title of Decree identify right in Decree.

1. The source of water is.....**TRUCKEE RIVER**.....
Name of stream, lake, underground, spring or other sources.
2. The amount of water to be changed.....**180.0 ac-ft**.....
feet, acre-feet. One second foot equals 448.83 gallons per minute.
3. The water to be used for.....**STORAGE WITH SECONDARY PERMITS FOR BENEFICIAL USES ALLOWED BY THE TRUCKEE RIVER OPERATING AGREEMENT**
Irrigation, power, mining, commercial, etc. If for stock state number and kind of animals. Must limit to one major use.
4. The water heretofore used for.....**MUNICIPAL & DOMESTIC**.....
If for stock state number and kind of animals.
5. The water is to be diverted at the following **SEE ATTACHMENT "A"**.....
Describe as being within a 40-acre subdivision of public survey and by course and distance to a section corner. If on unsurveyed land, it should be stated.
6. The existing point of diversion is located within... **Derby Dam being located in N1/2 SW1/4, Section 19, T.20N., R.23E., MDB&M...**
If point of diversion is not changed, do not answer.
7. Proposed place of use.....**The beneficial place of use will be set forth in applications for secondary permits consistent with the Truckee River Operating Agreement. The water stored under this Primary Application will be in the Lake Tahoe, Boca Reservoir, Donner Reservoir, Stampede Reservoir, Prosser Creek Reservoir, Derby Dam, and the City of Fernley Water Treatment Facility**.....
Describe by legal subdivisions. If for irrigation state number of acres to be irrigated.

- 8. Existing place of use...**See Attachment "B" and map filed with application 73142**
Describe by legal subdivisions. If permit is for irrigation, state number of acres irrigated. If changing place of use and/or manner of use of irrigation permit, describe acreage to be removed from irrigation. *(see map 7853 71382) mm 4/27/09*
- 9. Use will be from.....1/1.....to.....12/31.....of each year.
Month and Day Month and Day
- 10. Use permitted from.....1/1 to 12/31.....
- 11. Description of proposed works. (Under the provision of NRS 535.010 you may be required to submit plans and specifications of your diversion or storage works.).... **The Reservoirs and Diversion Works for Lake Tahoe, Boca Reservoir, Donner Reservoir, Stampede Reservoir, Prosser Creek Reservoir and Derby Dam are Complete. The City of Fernley Water Treatment Facility is currently under Construction.**.....
State manner in which water is to be diverted, i.e. diversion structure, ditches, pipes and flumes or drilled well, pump and motor, etc.
- 12. Estimated cost of works.....**\$50,000,000**.....
- 13. Estimated time required to construct works.....**2.0 YEAR**.....
If well completed, describe well.
- 14. Estimated time required to complete the application of water to beneficial use...**N/A**...
- 15. Remarks: **SEE REMARKS IN ATTACHMENT "C"**.....

(775) 784-9920

Phone No.

By:.....**Lowell Patton, Director, City of Fernley Public Works Department**.....

Print or type name clearly

.....
Signature, applicant or agent

.....**595 Silver Lace Blvd**.....

Street and No., or P.O. Box No.

.....**Fernley, NV 89408**.....

City, State, Zip Code

APPLICATION MUST BE SIGNED BY THE APPLICANT OR AGENT

RECEIVED
2009 APR 20 PM 1:44
STATE ENGINEERS OFFICE

\$150 FILING FEE MUST ACCOMPANY APPLICATION

Attachment "A"

The Proposed Points of Diversion are shown on the map filed with Application: **78034**

Lake Tahoe:

Within the NE $\frac{1}{4}$ of the NW $\frac{1}{4}$ of Section 7, T. 15N., R. 17E., M.D.M., or from the Dam the southwest corner of said Section 7 bears South $29^{\circ} 09' 30''$ West a distance of 5,182 feet, more or less. The capacity of Lake Tahoe is approximately 744,600 AF.

Donner Lake:

Within the SE $\frac{1}{4}$ of the NE $\frac{1}{4}$ of Section 18, T. 17N., R. 16E., M.D.M., or from the Dam the Southeast corner of said Section 18 bears South $04^{\circ} 07' 14''$ East a distance of 2,981 feet, more or less. The capacity of Donner Lake is 9,500 AF.

Prosser Creek Dam (Reservoir):

Within the NW $\frac{1}{4}$ of the SW $\frac{1}{4}$ of Section 30, T. 18N., R. 17E., M.D.M., or from the Dam the Southeast corner of said Section 30 bears South $22^{\circ} 58' 48''$ West a distance of 2,006 feet, more or less. The capacity of Prosser Creek Reservoir is approximately 29,840 AF.

Boca Dam (Reservoir):

Within the SE $\frac{1}{4}$ of the SW $\frac{1}{4}$ of Section 21, T. 18N., R. 17E., M.D.M., or from the Dam the Southwest corner of said Section 21 bears South $81^{\circ} 05' 07''$ West a distance of 2,647 feet, more or less. The capacity of Boca Reservoir is approximately 40,870 AF.

Stampede Dam (Reservoir)

Within the NW $\frac{1}{4}$ of the NW $\frac{1}{4}$ of Section 28, T. 19N., R. 17E., M.D.M., or from the Dam the Northwest corner of said Section 28 bears North $36^{\circ} 08' 27''$ West a distance of 636 feet, more or less. The capacity of Stampede Reservoir is approximately 226,500 AF.

Derby Dam:

Within the N $\frac{1}{2}$ of the SW $\frac{1}{4}$ of Section 19, T. 20N., R. 23E., M.D.M.

ATTACHMENT B

~~7342~~ 78353

PROPOSED PLACE OF USE:

T.20 N., R. 24 E., M.D.B. & M.

Portion of Sections 9 and 10, Sections 11, 12, 13, 14 and 15;
Portion of Sections 16, 17, and 20, Sections 21, 22, 23, 24, 25, 26, 27 and 28;
Portion of Sections 29, 30, and 31, Sections 32, 33, 34, 35 and 36.

T.20 N., R. 25 E., M.D.B. & M.

Sections 1, 2 and 3;
Portion of Sections 4 and 5, Sections 7 through 36.

T.20 N., R. 26 E., M.D.B. & M.

Portion of Section 5, Sections 6 and 7; Portion of
Sections 8 and 17, Sections 18 and 19; Portion of
Sections 20 and 29, Sections 30 and 31; Portion of
Section 32.

T.21 N., R. 25 E., M.D.B. & M.

Portion of Sections 13, 23 and 24, Section 25;
Portion of Sections 26, 27, 28 and 33, Sections 34, 35 and 36

T.21 N., R. 28 E., M.D.B. & M.

Portion of Sections 5, 7 and 8, Section 17;
Portion of Section 18, Sections 19, 20, 29, 30, 31, and 32.

T.22 N., R. 28 E., M.D.B. & M.

Portion of Sections 28, 32 and 33.

T.19 N., R. 25 E., M.D.B. & M.

All of Sections 1 through 36.

T.19 N., R. 24 E., M.D.B. & M.

Sections 1, 2, 3, 4 and 5;
Portion of Section 6, Sections 7 through 36.

T.19 N., R. 23 E., M.D.B. & M.

Portion of Sections 1, 12, 13, 14 and 23, Sections 24 and 25;
Portion of Sections 26, 27 and 34, Sections 35 and 36.

Refer to map on file under Application 74362

78034 9/12/09
mm

Attachment "C"

15. Remarks

This application is filed pursuant to the provisions of N.R.S §533.515 in that it seeks to add the reservoirs described in Attachment "A" and as listed in Item 11 above as additional points of diversion for the water rights described herein. This application is also filed as part of the implementation of the operating agreement described in Section 205 (a) of Public Law 101-618. Because of the provisions of California Water Code section 1231 and 1232, California will recognize any permits issued by the Nevada State Engineer based upon this application. Therefore, it is within the jurisdiction of the Nevada State Engineer to approve this application allowing for the storage of the consumptive use component of these Nevada water rights in California.

Water diverted to storage under a permit issued hereunder will be and is the subject of applications for secondary permits for beneficial uses allowed by the Truckee River Operating Agreement at the places allowed by that Agreement. The amount of water diverted to storage under a permit issued hereunder in any one year will not be less than the full permitted duty of 4.5 AF per year. The amount of water under a permit issued hereunder which may be in storage at any one time and which may be released and used from storage in any one year will not exceed the amounts allowed by the Truckee River Operating Agreement.

If the water right described herein is not diverted to storage, the full duty of the water right will continue to be diverted at its allowed points of diversion for its manner of use.

**PRIMARY
APPLICATION FOR PERMISSION TO CHANGE POINT OF DIVERSION, MANNER
OF USE AND PLACE OF USE OF THE PUBLIC WATERS
OF THE STATE OF NEVADA HERETOFORE APPROPRIATED**

THIS SPACE FOR OFFICE USE ONLY
Date of filing in State Engineer's Office APR 20 2009
Returned to applicant for correction.....
Corrected application filed..... Map filed FEB 26 2009 under 78034

The applicant.....**CITY OF FERNLEY**.....
.....**595 SILVER LACE BLVD**.....of.....**FERNLEY**..., NEVADA **89408**.....
Street and No. Or P.O. Box No City or Town

hereby makes... application for permission to change the.....

- X Point of diversion Place of use Manner of use Of a portion

of water heretofore appropriated under ..Permit 70130.....
Identify existing right by Permit, Certificate, Proof or Claim Nos. If Decreed, give title of Decree identify right in Decree.

1. The source of water is.....**TRUCKEE RIVER**.....
Name of stream, lake, underground, spring or other sources.
2. The amount of water to be changed.....**259.245 ac-ft**.....
feet, acre-feet. One second foot equals 448.83 gallons per minute.
3. The water to be used for.....**STORAGE WITH SECONDARY PERMITS FOR BENEFICIAL USES ALLOWED BY THE TRUCKEE RIVER OPERATING AGREEMENT**
Irrigation, power, mining, commercial, etc. If for stock state number and kind of animals. Must limit to one major use.
4. The water heretofore used for.....**MUNICIPAL & DOMESTIC**.....
If for stock state number and kind of animals.
5. The water is to be diverted at the following **SEE ATTACHMENT "A"**.....
Describe as being within a 40-acre subdivision of public survey and by course and distance to a section corner. If on unsurveyed land, it should be stated.
6. The existing point of diversion is located within... **Derby Dam being located in N1/2 SW1/4, Section 19, T.20N., R.23E., MDB&M...**
If point of diversion is not changed, do not answer.
7. Proposed place of use.....**The beneficial place of use will be set forth in applications for secondary permits consistent with the Truckee River Operating Agreement. The water stored under this Primary Application will be in the Lake Tahoe, Boca Reservoir, Donner Reservoir, Stampede Reservoir, Prosser Creek Reservoir, Derby Dam, and the City of Fernley Water Treatment Facility**.....
Describe by legal subdivisions. If for irrigation state number of acres to be irrigated.

8. Existing place of use...See Attachment "B" and map filed with application 70130
Describe by legal subdivisions. If permit is for irrigation, state number of acres irrigated. If changing place of use and/or manner of use of irrigation permit, describe acreage to be removed from irrigation.

9. Use will be from.....1/1.....to.....12/31.....of each year.
Month and Day Month and Day

10. Use permitted from.....1/1 to 12/31.....

11. Description of proposed works. (Under the provision of NRS 535.010 you may be required to submit plans and specifications of your diversion or storage works.)... **The Reservoirs and Diversion Works for Lake Tahoe, Boca Reservoir, Donner Reservoir, Stampede Reservoir, Prosser Creek Reservoir and Derby Dam are Complete. The City of Fernley Water Treatment Facility is currently under Construction.....**
State manner in which water is to be diverted, i.e. diversion structure, ditches, pipes and flumes or drilled well, pump and motor, etc.

12. Estimated cost of works.....\$50,000,000.....

13. Estimated time required to construct works.....2.0 YEAR.....
If well completed, describe well.

14. Estimated time required to complete the application of water to beneficial use...N/A...

15. Remarks: **SEE REMARKS IN ATTACHMENT "C"**

(775) 784-9920

Phone No.

By:.....Lowell Patton, Director, City of Fernley
Public Works Department.....
Print or type name clearly

.....
Signature, applicant or agent

.....595 Silver Lace Blvd.....
Street and No., or P.O. Box No.

.....Fernley, NV 89408

City, State, Zip Code

**APPLICATION MUST BE SIGNED
BY THE APPLICANT OR AGENT**

RECEIVED
2009 APR 20 PM 1:44
STATE ENGINEERS OFFICE

\$150 FILING FEE MUST ACCOMPANY APPLICATION

Attachment "A"

The Proposed Points of Diversion are shown on the map filed with Application: 78034

Lake Tahoe:

Within the NE $\frac{1}{4}$ of the NW $\frac{1}{4}$ of Section 7, T. 15N., R. 17E., M.D.M., or from the Dam the southwest corner of said Section 7 bears South $29^{\circ} 09' 30''$ West a distance of 5,182 feet, more or less. The capacity of Lake Tahoe is approximately 744,600 AF.

Donner Lake:

Within the SE $\frac{1}{4}$ of the NE $\frac{1}{4}$ of Section 18, T. 17N., R. 16E., M.D.M., or from the Dam the Southeast corner of said Section 18 bears South $04^{\circ} 07' 14''$ East a distance of 2,981 feet, more or less. The capacity of Donner Lake is 9,500 AF.

Prosser Creek Dam (Reservoir):

Within the NW $\frac{1}{4}$ of the SW $\frac{1}{4}$ of Section 30, T. 18N., R. 17E., M.D.M., or from the Dam the Southeast corner of said Section 30 bears South $22^{\circ} 58' 48''$ West a distance of 2,006 feet, more or less. The capacity of Prosser Creek Reservoir is approximately 29,840 AF.

Boca Dam (Reservoir):

Within the SE $\frac{1}{4}$ of the SW $\frac{1}{4}$ of Section 21, T. 18N., R. 17E., M.D.M., or from the Dam the Southwest corner of said Section 21 bears South $81^{\circ} 05' 07''$ West a distance of 2,647 feet, more or less. The capacity of Boca Reservoir is approximately 40,870 AF.

Stampede Dam (Reservoir)

Within the NW $\frac{1}{4}$ of the NW $\frac{1}{4}$ of Section 28, T. 19N., R. 17E., M.D.M., or from the Dam the Northwest corner of said Section 28 bears North $36^{\circ} 08' 27''$ West a distance of 636 feet, more or less. The capacity of Stampede Reservoir is approximately 226,500 AF.

Derby Dam:

Within the N $\frac{1}{2}$ of the SW $\frac{1}{4}$ of Section 19, T. 20N., R. 23E., M.D.M.

ATTACHMENT B

PROPOSED PLACE OF USE:

T.20 N., R. 24 E., M.D.B. & M.

Portion of Sections 9 and 10; Sections 11; 12, 13, 14 and 15;
Portion of Sections 16; 17, and 20; Sections 21, 22, 23, 24, 25, 26, 27 and 28;
Portion of Sections 29, 30, and 31; Sections 32, 33, 34, 35 and 36.

T.20 N., R. 25 E., M.D.B. & M.

Sections 1, 2 and 3;
Portion of Sections 4 and 5; Sections 7 through 36.

T.20 N., R. 26 E., M.D.B. & M.

Portion of Section 5; Sections 6 and 7;
Portion of Sections 8 and 17; Sections 18 and 19;
Portion of Sections 20 and 29; Sections 30 and 31;
Portion of Section 32.

T.21 N., R. 25 E., M.D.B. & M.

Portion of Sections 13; 23 and 24; Section 25;
Portion of Sections 26, 27, 28 and 33; Sections 34, 35 and 36.

T.21 N., R. 26 E., M.D.B. & M.

Portion of Sections 5, 7 and 8; Section 17;
Portion of Section 18; Sections 19, 20, 29, 30, 31, and 32.

T.22 N., R. 26 E., M.D.B. & M.

Portion of Sections 28, 32 and 33.

T.19 N., R. 25 E., M.D.B. & M.

All of Sections 1 through 36.

T.19 N., R. 24 E., M.D.B. & M.

Sections 1, 2, 3, 4 and 5;
Portion of Section 6; Sections 7 through 36.

T.19 N., R. 23 E., M.D.B. & M.

Portion of Sections 1, 12, 13, 14 and 23; Sections 24 and 25;
Portion of Sections 26, 27 and 34; Sections 35 and 36.

Attachment "C"

15. Remarks

This application is filed pursuant to the provisions of N.R.S §533.515 in that it seeks to add the reservoirs described in Attachment "A" and as listed in Item 11 above as additional points of diversion for the water rights described herein. This application is also filed as part of the implementation of the operating agreement described in Section 205 (a) of Public Law 101-618. Because of the provisions of California Water Code section 1231 and 1232, California will recognize any permits issued by the Nevada State Engineer based upon this application. Therefore, it is within the jurisdiction of the Nevada State Engineer to approve this application allowing for the storage of the consumptive use component of these Nevada water rights in California.

Water diverted to storage under a permit issued hereunder will be and is the subject of applications for secondary permits for beneficial uses allowed by the Truckee River Operating Agreement at the places allowed by that Agreement. The amount of water diverted to storage under a permit issued hereunder in any one year will not be less than the full permitted duty of 4.5 AF per year. The amount of water under a permit issued hereunder which may be in storage at any one time and which may be released and used from storage in any one year will not exceed the amounts allowed by the Truckee River Operating Agreement.

If the water right described herein is not diverted to storage, the full duty of the water right will continue to be diverted at its allowed points of diversion for its manner of use.

**PRIMARY
APPLICATION FOR PERMISSION TO CHANGE POINT OF DIVERSION, MANNER
OF USE AND PLACE OF USE OF THE PUBLIC WATERS
OF THE STATE OF NEVADA HERETOFORE APPROPRIATED**

THIS SPACE FOR OFFICE USE ONLY

Date of filing in State Engineer's Office..... **APR 20 2009**.....

Returned to applicant for correction.....

Corrected application filed.....Map filed **FEB 26 2009** under
78034

The applicant.....**CITY OF FERNLEY**.....

.....**595 SILVER LACE BLVD**.....of.....**FERNLEY**....., **NEVADA 89408**.....
Street and No. Or P.O. Box No City or Town

hereby makes... application for permission to change the.....

Point of diversion Place of use Manner of use Of a portion

of water heretofore appropriated under **..Permit 67449**.....
Identify existing right by Permit, Certificate, Proof or Claim Nos. If Decreed, give title of Decree identify right in Decree.

1. The source of water is.....**TRUCKEE RIVER**.....
Name of stream, lake, underground, spring or other sources.

2. The amount of water to be changed.....**795 ac-ft**.....
feet, acre-feet. One second foot equals 448.83 gallons per minute.

3. The water to be used for.....**STORAGE WITH SECONDARY PERMITS FOR
BENEFICIAL USES ALLOWED BY THE TRUCKEE RIVER OPERATING
AGREEMENT**
Irrigation, power, mining, commercial, etc. If for stock state number and kind of animals. Must limit to one major use.

4. The water heretofore used for.....**MUNICIPAL & DOMESTIC**.....
If for stock state number and kind of animals.

5. The water is to be diverted at the following **SEE ATTACHMENT "A"**.....
Describe as being within a 40-acre subdivision of public survey and by course and distance to a section corner. If on unsurveyed land, it should be stated.

6. The existing point of diversion is located within... **Derby Dam being located in N1/2
SW1/4, Section 19, T.20N., R.23E., MDB&M**...
If point of diversion is not changed, do not answer.

7. Proposed place of use.....**The beneficial place of use will be set forth in applications for
secondary permits consistent with the Truckee River Operating Agreement. The water
stored under this Primary Application will be in the Lake Tahoe, Boca Reservoir,
Donner Reservoir, Stampede Reservoir, Prosser Creek Reservoir, Derby Dam, and the
City of Fernley Water Treatment Facility**.....
Describe by legal subdivisions. If for irrigation state number of acres to be irrigated.

8. Existing place of use...**See Attachment "B" and map filed with application 67449**
Describe by legal subdivisions. If permit is for irrigation, state number of acres irrigated. If changing place of use and/or manner of use of irrigation permit, describe acreage to be removed from irrigation.

9. Use will be from.....**1/1**.....to.....**12/31**.....of each year.
Month and Day Month and Day

10. Use permitted from.....**1/1 to 12/31**.....

11. Description of proposed works. (Under the provision of NRS 535.010 you may be required to submit plans and specifications of your diversion or storage works.)... **The Reservoirs and Diversion Works for Lake Tahoe, Boca Reservoir, Donner Reservoir, Stampede Reservoir, Prosser Creek Reservoir and Derby Dam are Complete. The City of Fernley Water Treatment Facility is currently under Construction**.....
State manner in which water is to be diverted, i.e. diversion structure, ditches, pipes and flumes or drilled well, pump and motor, etc.

12. Estimated cost of works.....**\$50,000,000**.....

13. Estimated time required to construct works.....**2.0 YEAR**.....
If well completed, describe well.

14. Estimated time required to complete the application of water to beneficial use...**N/A**...

15. Remarks: **SEE REMARKS IN ATTACHMENT "C"**.....

(775) 784-9920

Phone No.

By:.....**Lowell Patton, Director, City of Fernley Public Works Department**.....

Print or type name clearly

.....
Signature, applicant or agent

.....**595 Silver Lace Blvd**.....
Street and No., or P.O. Box No.

.....**Fernley, NV 89408**.....
City, State, Zip Code

APPLICATION MUST BE SIGNED BY THE APPLICANT OR AGENT

RECEIVED
2009 APR 20 PM 1:44
STATE ENGINEERS OFFICE

\$150 FILING FEE MUST ACCOMPANY APPLICATION

Attachment "A"

The Proposed Points of Diversion are shown on the map filed with Application: 78034

Lake Tahoe:

Within the NE $\frac{1}{4}$ of the NW $\frac{1}{4}$ of Section 7, T. 15N., R. 17E., M.D.M., or from the Dam the southwest corner of said Section 7 bears South $29^{\circ} 09' 30''$ West a distance of 5,182 feet, more or less. The capacity of Lake Tahoe is approximately 744,600 AF.

Donner Lake:

Within the SE $\frac{1}{4}$ of the NE $\frac{1}{4}$ of Section 18, T. 17N., R. 16E., M.D.M., or from the Dam the Southeast corner of said Section 18 bears South $04^{\circ} 07' 14''$ East a distance of 2,981 feet, more or less. The capacity of Donner Lake is 9,500 AF.

Prosser Creek Dam (Reservoir):

Within the NW $\frac{1}{4}$ of the SW $\frac{1}{4}$ of Section 30, T. 18N., R. 17E., M.D.M., or from the Dam the Southeast corner of said Section 30 bears South $22^{\circ} 58' 48''$ West a distance of 2,006 feet, more or less. The capacity of Prosser Creek Reservoir is approximately 29,840 AF.

Boca Dam (Reservoir):

Within the SE $\frac{1}{4}$ of the SW $\frac{1}{4}$ of Section 21, T. 18N., R. 17E., M.D.M., or from the Dam the Southwest corner of said Section 21 bears South $81^{\circ} 05' 07''$ West a distance of 2,647 feet, more or less. The capacity of Boca Reservoir is approximately 40,870 AF.

Stampede Dam (Reservoir)

Within the NW $\frac{1}{4}$ of the NW $\frac{1}{4}$ of Section 28, T. 19N., R. 17E., M.D.M., or from the Dam the Northwest corner of said Section 28 bears North $36^{\circ} 08' 27''$ West a distance of 636 feet, more or less. The capacity of Stampede Reservoir is approximately 226,500 AF.

Derby Dam:

Within the N $\frac{1}{2}$ of the SW $\frac{1}{4}$ of Section 19, T. 20N., R. 23E., M.D.M.

ATTACHMENT B**PROPOSED PLACE OF USE:****T.20 N., R. 24 E., M.D.B. & M.**

Portion of Sections 9 and 10, Sections 11, 12, 13, 14 and 15;
Portion of Sections 16, 17, and 20, Sections 21, 22, 23, 24, 25, 26, 27 and 28;
Portion of Sections 29, 30, and 31, Sections 32, 33, 34, 35 and 36.

T.20 N., R. 25 E., M.D.B. & M.

Sections 1, 2 and 3;
Portion of Sections 4 and 5, Sections 7 through 36.

T.20 N., R. 26 E., M.D.B. & M.

Portion of Section 5, Sections 6 and 7;
Portion of Sections 8 and 17, Sections 18 and 19;
Portion of Sections 20 and 29, Sections 30 and 31;
Portion of Section 32.

T.21 N., R. 25 E., M.D.B. & M.

Portion of Sections 13, 23 and 24, Section 25;
Portion of Sections 26, 27, 28 and 33, Sections 34, 35 and 36

T.21 N., R. 26 E., M.D.B. & M.

Portion of Sections 5, 7 and 8, Section 17;
Portion of Section 18, Sections 19, 20, 29, 30, 31, and 32.

T.22 N., R. 26 E., M.D.B. & M.

Portion of Sections 28, 32 and 33.

T.19 N., R. 25 E., M.D.B. & M.

All of Sections 1 through 36.

T.19 N., R. 24 E., M.D.B. & M.

Sections 1, 2, 3, 4 and 5;
Portion of Section 6, Sections 7 through 36.

T.19 N., R. 23 E., M.D.B. & M.

Portion of Sections 1, 12, 13, 14 and 23, Sections 24 and 25;
Portion of Sections 26, 27 and 34, Sections 35 and 36.

Attachment "C"

15. Remarks

This application is filed pursuant to the provisions of N.R.S §533.515 in that it seeks to add the reservoirs described in Attachment "A" and as listed in Item 11 above as additional points of diversion for the water rights described herein. This application is also filed as part of the implementation of the operating agreement described in Section 205 (a) of Public Law 101-618. Because of the provisions of California Water Code section 1231 and 1232, California will recognize any permits issued by the Nevada State Engineer based upon this application. Therefore, it is within the jurisdiction of the Nevada State Engineer to approve this application allowing for the storage of the consumptive use component of these Nevada water rights in California.

Water diverted to storage under a permit issued hereunder will be and is the subject of applications for secondary permits for beneficial uses allowed by the Truckee River Operating Agreement at the places allowed by that Agreement. The amount of water diverted to storage under a permit issued hereunder in any one year will not be less than the full permitted duty of 4.5 AF per year. The amount of water under a permit issued hereunder which may be in storage at any one time and which may be released and used from storage in any one year will not exceed the amounts allowed by the Truckee River Operating Agreement.

If the water right described herein is not diverted to storage, the full duty of the water right will continue to be diverted at its allowed points of diversion for its manner of use.

**PRIMARY
APPLICATION FOR PERMISSION TO CHANGE POINT OF DIVERSION, MANNER
OF USE AND PLACE OF USE OF THE PUBLIC WATERS
OF THE STATE OF NEVADA HERETOFORE APPROPRIATED**

THIS SPACE FOR OFFICE USE ONLY

Date of filing in State Engineer's Office... **APR 20 2009**

Returned to applicant for correction.....

Corrected application filed..... Map filed **FEB 26 2009** under
78034

The applicant.....**CITY OF FERNLEY**.....

.....**595 SILVER LACE BLVD**.....of.....**FERNLEY**..., NEVADA **89408**.....
Street and No. Or P.O. Box No City or Town

hereby makes... application for permission to change the.....

Point of diversion Place of use Manner of use Of a portion

of water heretofore appropriated under **..Permit 63277**.....
Identify existing right by Permit, Certificate, Proof or Claim Nos. If Decreed, give title of Decree identify right in Decree.

1. The source of water is.....**TRUCKEE RIVER**.....
Name of stream, lake, underground, spring or other sources.

2. The amount of water to be changed.....**91.24 ac-ft**.....
feet, acre-feet. One second foot equals 448.83 gallons per minute.

3. The water to be used for.....**STORAGE WITH SECONDARY PERMITS FOR
BENEFICIAL USES ALLOWED BY THE TRUCKEE RIVER OPERATING
AGREEMENT**
Irrigation, power, mining, commercial, etc. If for stock state number and kind of animals. Must limit to one major use.

4. The water heretofore used for.....**MUNICIPAL & DOMESTIC**.....
If for stock state number and kind of animals.

5. The water is to be diverted at the following **SEE ATTACHMENT "A"**.....
Describe as being within a 40-acre subdivision of public survey and by course and distance to a section corner. If on unsurveyed land, it should be stated.

6. The existing point of diversion is located within... **Derby Dam being located in N1/2
SW1/4, Section 19, T.20N., R.23E., MDB&M...**
If point of diversion is not changed, do not answer.

7. Proposed place of use.....**The beneficial place of use will be set forth in applications for
secondary permits consistent with the Truckee River Operating Agreement. The water
stored under this Primary Application will be in the Lake Tahoe, Boca Reservoir,
Donner Reservoir, Stampede Reservoir, Prosser Creek Reservoir, Derby Dam, and the
City of Fernley Water Treatment Facility**.....
Describe by legal subdivisions. If for irrigation state number of acres to be irrigated.

8. Existing place of use...**See Attachment "B" and map filed with application 63277**
Describe by legal subdivisions. If permit is for irrigation, state number of acres irrigated. If changing place of use and/or manner of use of irrigation permit, describe acreage to be removed from irrigation.

9. Use will be from.....**1/1**.....to.....**12/31**.....of each year.
Month and Day Month and Day

10. Use permitted from.....**1/1 to 12/31**.....

11. Description of proposed works. (Under the provision of NRS 535.010 you may be required to submit plans and specifications of your diversion or storage works.).... **The Reservoirs and Diversion Works for Lake Tahoe, Boca Reservoir, Donner Reservoir, Stampede Reservoir, Prosser Creek Reservoir and Derby Dam are Complete. The City of Fernley Water Treatment Facility is currently under Construction**.....
State manner in which water is to be diverted, i.e. diversion structure, ditches, pipes and flumes or drilled well, pump and motor, etc.

12. Estimated cost of works.....**\$50,000,000**.....

13. Estimated time required to construct works.....**2.0 YEAR**.....
If well completed, describe well.

14. Estimated time required to complete the application of water to beneficial use...N/A...

15. Remarks: **SEE REMARKS IN ATTACHMENT "C"**.....

(775) 784-9920

Phone No.

By:.....**Lowell Patton, Director, City of Fernley Public Works Department**.....
Print or type name clearly

.....
Signature, applicant or agent

.....**595 Silver Lace Blvd**.....
Street and No., or P.O. Box No.

.....**Fernley, NV 89408**.....
City, State, Zip Code

APPLICATION MUST BE SIGNED BY THE APPLICANT OR AGENT

RECEIVED
2009 APR 20 PM 1:44
STATE ENGINEERS OFFICE

\$150 FILING FEE MUST ACCOMPANY APPLICATION

Attachment "A"

The Proposed Points of Diversion are shown on the map filed with Application: 78034

Lake Tahoe:

Within the NE $\frac{1}{4}$ of the NW $\frac{1}{4}$ of Section 7, T. 15N., R. 17E., M.D.M., or from the Dam the southwest corner of said Section 7 bears South $29^{\circ} 09' 30''$ West a distance of 5,182 feet, more or less. The capacity of Lake Tahoe is approximately 744,600 AF.

Donner Lake:

Within the SE $\frac{1}{4}$ of the NE $\frac{1}{4}$ of Section 18, T. 17N., R. 16E., M.D.M., or from the Dam the Southeast corner of said Section 18 bears South $04^{\circ} 07' 14''$ East a distance of 2,981 feet, more or less. The capacity of Donner Lake is 9,500 AF.

Prosser Creek Dam (Reservoir):

Within the NW $\frac{1}{4}$ of the SW $\frac{1}{4}$ of Section 30, T. 18N., R. 17E., M.D.M., or from the Dam the Southeast corner of said Section 30 bears South $22^{\circ} 58' 48''$ West a distance of 2,006 feet, more or less. The capacity of Prosser Creek Reservoir is approximately 29,840 AF.

Boca Dam (Reservoir):

Within the SE $\frac{1}{4}$ of the SW $\frac{1}{4}$ of Section 21, T. 18N., R. 17E., M.D.M., or from the Dam the Southwest corner of said Section 21 bears South $81^{\circ} 05' 07''$ West a distance of 2,647 feet, more or less. The capacity of Boca Reservoir is approximately 40,870 AF.

Stampede Dam (Reservoir)

Within the NW $\frac{1}{4}$ of the NW $\frac{1}{4}$ of Section 28, T. 19N., R. 17E., M.D.M., or from the Dam the Northwest corner of said Section 28 bears North $36^{\circ} 08' 27''$ West a distance of 636 feet, more or less. The capacity of Stampede Reservoir is approximately 226,500 AF.

Derby Dam:

Within the N $\frac{1}{2}$ of the SW $\frac{1}{4}$ of Section 19, T. 20N., R. 23E., M.D.M.

Attachment B**Proposed Place of Use****T20N, R24E, M.D.B.&M.**

Portion of Sections 9 and 10, Sections 11, 12, 13, 14 and 15;
Portion of Sections 16, 17 and 20, Sections 21, 22, 23, 24, 25, 26,
27 and 28; Portion of Sections 29, 30 and 31, Sections 32, 33, 34,
35 and 36.

T20N, R25E, M.D.B.&M.

Sections 1, 2 and 3; Portion of Sections 4 and 5, Sections 7
through 36.

T20N, R26E, M.D.B.&M.

Portion of Section 5, Sections 6 and 7; Portion of Sections 8 and
17, Sections 18 and 19; Portion of Sections 20 and 29, Sections 30
and 31; Portion of Section 32.

T21N, R25E, M.D.B.&M.

Portion of Sections 13, 23 and 24, Section 25; Portion of Sections
26, 27, 28 and 33, Sections 34, 35 and 36.

T21N, R26E, M.D.B.&M.

Portion of Sections 5, 7 and 8, Section 17; Portion of Section 18,
Sections 19, 20, 29, 30, 31 and 32.

T22N, R26E, M.D.B.&M.

Portion of Sections 28, 32 and 33.

T19N, R25E, M.D.B.&M.

All of Sections 1 through 36.

T19N, R24E, M.D.B.&M.

Sections 1, 2, 3, 4 and 5; Portion of Section 6, Sections 7 through
36.

T19N, R23E, M.D.B.&M.

Portion of Sections 1, 12, 13, 14 and 23, Sections 24 and 25;
Portion of Sections 26, 27 and 34, Sections 35 and 36.

Attachment "C"

15. Remarks

This application is filed pursuant to the provisions of N.R.S §533.515 in that it seeks to add the reservoirs described in Attachment "A" and as listed in Item 11 above as additional points of diversion for the water rights described herein. This application is also filed as part of the implementation of the operating agreement described in Section 205 (a) of Public Law 101-618. Because of the provisions of California Water Code section 1231 and 1232, California will recognize any permits issued by the Nevada State Engineer based upon this application. Therefore, it is within the jurisdiction of the Nevada State Engineer to approve this application allowing for the storage of the consumptive use component of these Nevada water rights in California.

Water diverted to storage under a permit issued hereunder will be and is the subject of applications for secondary permits for beneficial uses allowed by the Truckee River Operating Agreement at the places allowed by that Agreement. The amount of water diverted to storage under a permit issued hereunder in any one year will not be less than the full permitted duty of 4.5 AF per year. The amount of water under a permit issued hereunder which may be in storage at any one time and which may be released and used from storage in any one year will not exceed the amounts allowed by the Truckee River Operating Agreement.

If the water right described herein is not diverted to storage, the full duty of the water right will continue to be diverted at its allowed points of diversion for its manner of use.

**PRIMARY
APPLICATION FOR PERMISSION TO CHANGE POINT OF DIVERSION, MANNER
OF USE AND PLACE OF USE OF THE PUBLIC WATERS
OF THE STATE OF NEVADA HERETOFORE APPROPRIATED**

THIS SPACE FOR OFFICE USE ONLY	
Date of filing in State Engineer's Office.....	APR 20 2009
Returned to applicant for correction.....	
Corrected application filed.....	Map filed FEB 26 2009 under 78034

The applicant.....**CITY OF FERNLEY**.....

.....**595 SILVER LACE BLVD**.....of.....**FERNLEY**..., NEVADA **89408**.....

Street and No. Or P.O. Box No City or Town

hereby makes... application for permission to change the.....

X Point of diversion Place of use Manner of use Of a portion

of water heretofore appropriated under ..**Permit 61893**.....

Identify existing right by Permit, Certificate, Proof or Claim Nos. If Decreed, give title of Decree identify right in Decree.

1. The source of water is.....**TRUCKEE RIVER**.....
Name of stream, lake, underground, spring or other sources.
2. The amount of water to be changed.....**435.65 ac-ft**.....
foot, acre-feet. One second foot equals 448.83 gallons per minute.
3. The water to be used for.....**STORAGE WITH SECONDARY PERMITS FOR BENEFICIAL USES ALLOWED BY THE TRUCKEE RIVER OPERATING AGREEMENT**
Irrigation, power, mining, commercial, etc. If for stock state number and kind of animals. Must limit to one major use.
4. The water heretofore used for.....**MUNICIPAL & DOMESTIC**.....
If for stock state number and kind of animals.
5. The water is to be diverted at the following **SEE ATTACHMENT "A"**.....
Describe as being within a 40-acre subdivision of public survey and by course and distance to a section corner. If on unsurveyed land, it should be stated.
6. The existing point of diversion is located within... **Derby Dam being located in N1/2 SW1/4, Section 19, T.20N., R.23E., MDB&M...**
If point of diversion is not changed, do not answer.
7. Proposed place of use.....**The beneficial place of use will be set forth in applications for secondary permits consistent with the Truckee River Operating Agreement. The water stored under this Primary Application will be in the Lake Tahoe, Boca Reservoir, Donner Reservoir, Stampede Reservoir, Prosser Creek Reservoir, Derby Dam, and the City of Fernley Water Treatment Facility**.....
Describe by legal subdivisions. If for irrigation state number of acres to be irrigated.

- 8. Existing place of use...**See Attachment "B" and map filed with application 61893**
Describe by legal subdivisions. If permit is for irrigation, state number of acres irrigated. If changing place of use and/or manner of use of irrigation permit, describe acreage to be removed from irrigation.
- 9. Use will be from.....**1/1**.....to.....**12/31**.....of each year.
Month and Day Month and Day
- 10. Use permitted from.....**1/1 to 12/31**.....
- 11. Description of proposed works. (Under the provision of NRS 535.010 you may be required to submit plans and specifications of your diversion or storage works.).... **The Reservoirs and Diversion Works for Lake Tahoe, Boca Reservoir, Donner Reservoir, Stampede Reservoir, Prosser Creek Reservoir and Derby Dam are Complete. The City of Fernley Water Treatment Facility is currently under Construction**.....
State manner in which water is to be diverted, i.e. diversion structure, ditches, pipes and flumes or drilled well, pump and motor, etc.
- 12. Estimated cost of works.....**\$50,000,000**.....
- 13. Estimated time required to construct works.....**2.0 YEAR**.....
If well completed, describe well.
- 14. Estimated time required to complete the application of water to beneficial use...**N/A**...
- 15. Remarks: **SEE REMARKS IN ATTACHMENT "C"**.....

(775) 784-9920

Phone No.

By:.....**Lowell Patton, Director, City of Fernley Public Works Department**.....

Print or type name clearly



Signature, Applicant or agent

.....**595 Silver Lace Blvd**.....

Street and No., or P.O. Box No.

.....**Fernley, NV 89408**.....

City, State, Zip Code

APPLICATION MUST BE SIGNED BY THE APPLICANT OR AGENT

\$150 FILING FEE MUST ACCOMPANY APPLICATION

RECEIVED
2009 APR 20 PM 1:45
STATE ENGINEERS OFFICE

Attachment "A"

The Proposed Points of Diversion are shown on the map filed with Application: 78034

Lake Tahoe:

Within the NE $\frac{1}{4}$ of the NW $\frac{1}{4}$ of Section 7, T. 15N., R. 17E., M.D.M., or from the Dam the southwest corner of said Section 7 bears South $29^{\circ} 09' 30''$ West a distance of 5,182 feet, more or less. The capacity of Lake Tahoe is approximately 744,600 AF.

Donner Lake:

Within the SE $\frac{1}{4}$ of the NE $\frac{1}{4}$ of Section 18, T. 17N., R. 16E., M.D.M., or from the Dam the Southeast corner of said Section 18 bears South $04^{\circ} 07' 14''$ East a distance of 2,981 feet, more or less. The capacity of Donner Lake is 9,500 AF.

Frosser Creek Dam (Reservoir):

Within the NW $\frac{1}{4}$ of the SW $\frac{1}{4}$ of Section 30, T. 18N., R. 17E., M.D.M., or from the Dam the Southeast corner of said Section 30 bears South $22^{\circ} 58' 48''$ West a distance of 2,006 feet, more or less. The capacity of Frosser Creek Reservoir is approximately

.....

Within the SE $\frac{1}{4}$ of the SW $\frac{1}{4}$ of Section 21, T. 18N., R. 17E., M.D.M., or from the Dam the Southwest corner of said Section 21 bears South $81^{\circ} 05' 07''$ West a distance

.....

Within the NW $\frac{1}{4}$ of the NW $\frac{1}{4}$ of Section 28, T. 19N., R. 17E., M.D.M., or from the Dam the Northwest corner of said Section 28 bears North $36^{\circ} 08' 27''$ West a distance of 626 feet, more or less. The capacity of Stampede Reservoir is approximately 226,500

Darby Dam:

Within the N $\frac{1}{2}$ of the SW $\frac{1}{4}$ of Section 19, T. 20N., R. 23E., M.D.M.

Attachment B**Proposed Place of Use****T20N, R24E, M.D.B.&M.**

Portion of Sections 9 and 10, Sections 11, 12, 13, 14 and 15;
 Portion of Sections 16, 17 and 20, Sections 21, 22, 23, 24, 25, 26,
 27 and 28; Portion of Sections 29, 30 and 31, Sections 32, 33, 34,
 35 and 36.

T20N, R25E, M.D.B.&M.

Sections 1, 2 and 3; Portion of Sections 4 and 5, Sections 7
 through 36.

T20N, R26E, M.D.B.&M.

Portion of Section 5, Sections 6 and 7; Portion of Sections 8 and
 17, Sections 18 and 19; Portion of Sections 20 and 29, Sections 30
 and 31; Portion of Section 32.

T21N, R25E, M.D.B.&M.

Portion of Sections 15, 23 and 24, Section 25; Portion of Sections
 26, 27, 28 and 33, Sections 34, 35 and 36.

T22N, R26E, M.D.B.&M.

Portion of Sections 28, 32 and 33.

T19N, R25E, M.D.B.&M.

All of Sections 1 through 36.

T19N, R25E, M.D.B.&M.

All of Sections 1 through 36.

T19N, R25E, M.D.B.&M.

Sections 1, 2, 3, 4 and 5; Portion of Section 6, Sections 7 through
 36.

T19N, R23E, M.D.B.&M.

Portion of Sections 1, 12, 13, 14 and 23, Sections 24 and 25;
 Portion of Sections 26, 27 and 34, Sections 35 and 36.

Attachment "C"**15. Remarks**

This application is filed pursuant to the provisions of N.R.S §533.515 in that it seeks to add the reservoirs described in Attachment "A" and as listed in Item 11 above as additional points of diversion for the water rights described herein. This application is also filed as part of the implementation of the operating agreement described in Section 205 (a) of Public Law 101-618. Because of the provisions of California Water Code section 1231 and 1232, California will recognize any permits issued by the Nevada State Engineer based upon this application. The Nevada State Engineer is requested to approve this application allowing for the storage of the consumptive use component of these Nevada water rights in California.

River Operating Agreement at the places allowed by that Agreement. The amount of water diverted to storage under a permit issued hereunder in any one year will not be less than the full permitted duty of 4.5 AF per year. The amount of water under a permit issued hereunder which may be in storage at any one time and which may be released and used from storage in any one year will not exceed the amounts allowed by the Truckee River Operating Agreement.

If the water right described herein is not diverted to storage, the full duty of the water right will continue to be diverted at its allowed points of diversion for its manner of use.

APPLICATION FOR PERMIT TO APPROPRIATE THE PUBLIC WATERS OF THE STATE OF NEVADA

THIS SPACE FOR OFFICE USE ONLY

Date of filing in State Engineer's Office MAY 13 2009

Returned to applicant for correction _____

Corrected application filed _____ Map filed FEB 26 2009 under 78034

The applicant CITY OF FERNLEY

595 SILVER LACE BLVD of FERNLEY
Street Address or P.O. Box City or Town

NEVADA 89408 hereby make(s) application for permission to appropriate
State and Zip Code

the public waters of the State of Nevada, as hereinafter stated. (If applicant is a corporation, give date and place of incorporation; if a copartnership or association give names of members.)

1. The source of water is Truckee River Water [See Remarks Section - Line Item #13]
Name of stream, lake, underground, spring or other sources.
2. The amount of water applied for is 93.83 ACRE FEET second feet.
One second foot equals 448.83 gallons per minute.
(a) If stored in reservoir give number of acre-feet 93.83 ACRE FEET
3. The water to be used for MUNICIPAL AND DOMESTIC PURPOSES
Irrigation, power, mining, commercial, domestic or other use. Must limit to one major use.
4. If use is for:
 - (a) Irrigation, state number of acres to be irrigated _____
 - (b) Stockwater, state number and kind of animals _____
 - (c) Other use (describe fully in No. 12) _____
 - (d) Power:
 - (1) Horsepower developed _____
 - (2) Point of return of water to stream _____

Handwritten initials/signature

78338501

5. The water is to be diverted from its source at the following point: (Describe as being within a 40-acre subdivision of public survey, and by course and distance to a found section corner. If on unsurveyed land, it should be so stated.)
Derby Dam being located in the N 1/2 SW 1/4, Section 19, T. 20 N., R. 23E, M.D.B.&M. after the water has been released from upstream points of diversion described in Attachment "A".

6. Place of use: (Describe by legal subdivision. If on unsurveyed land, it should be so stated.)
See Attachment "B" and map filed with primary application no. 78034

7. Use will begin about 1/1 and end about 12/31 of each year.
Month and Day Month and Day

8. Description of proposed works. (Under the provisions of NRS 535.010 you may be required to submit plans and specifications of your diversion or storage works.) (State manner in which water is to be diverted, i.e. diversion structure, ditches and flumes, drilled well with pump and motor, etc.)
ALL WORKS REFERENCED IN ATTACHMENT "A" ARE COMPLETED

9. Estimated cost of works: \$0.0 - ALL WORKS COMPLETED

10. Estimated time required to construct works: N/A
(If well completed, describe works.)

11. Estimated time required to complete the application of water to beneficial use: 10 YEARS

12. Provide a detailed description of the proposed project and its water usage (use attachments if necessary):
(Failure to provide a detailed description may cause a delay in processing.)
The Surface water will be diverted to a treatment facility meeting the requirements of the US EPA Surface Water Rule. The finished water will be blended w/groundwater producing a product meeting the Safe Drinking Water Act. Alternately, the surface water may be diverted to a recharge basin for aquifer recharge, storage, and recovery. Alternately, the surface water may be used for municipal purposes from the Truckee Canal after diversion from Derby Dam.

13. Miscellaneous remarks:
The source of the water stored in Lake Tahoe, Boca Reservoir, Prosser Creek Reservoir, Stampede Reservoir, Donner Reservoir, and Derby Dam pursuant to the permit to be issued under Primary Application.

lpatton@CityofFernley.org
E-mail Address

(775) 784-9920
Phone No.

**APPLICATION MUST BE SIGNED
BY THE APPLICANT OR AGENT**

By Lowell Patton
Type or print name clearly

Signature, applicant or agent
Director, City of Fernley Public Works Dept.
Company Name
595 Silver Lace Blvd.
Street Address or P.O. Box
Fernley, Nevada, 89408
City, State, Zip Code

STATE ENGINEERS OFFICE
2009 MAY 13 PM 3:48
RECEIVED

\$250 FILING FEE AND SUPPORTING MAP MUST ACCOMPANY APPLICATION

Attachment "A"

The Proposed Points of Diversion are shown on the map filed with Application No. 78034:

Lake Tahoe:

Within the NE $\frac{1}{4}$ of the NW $\frac{1}{4}$ of Section 7, T. 15N., R. 17E., M.D.M., or from the Dam the southwest corner of said Section 7 bears South $29^{\circ} 09' 30''$ West a distance of 5,182 feet, more or less. The storage capacity of Lake Tahoe is approximately 744,600 AF.

Donner Lake:

Within the SE $\frac{1}{4}$ of the NE $\frac{1}{4}$ of Section 18, T. 17N., R. 16E., M.D.M., or from the Dam the Southeast corner of said Section 18 bears South $04^{\circ} 07' 14''$ East a distance of 2,981 feet, more or less. The storage capacity of Donner Lake is 9,500 AF.

Prosser Creek Dam (Reservoir):

Within the NW $\frac{1}{4}$ of the SW $\frac{1}{4}$ of Section 30, T. 18N., R. 17E., M.D.M., or from the Dam the Southwest corner of said Section 30 bears South $22^{\circ} 58' 48''$ West a distance of 2,006 feet, more or less. The storage capacity of Prosser Creek Reservoir is approximately 29,840 AF.

Boca Dam (Reservoir):

Within the SE $\frac{1}{4}$ of the SW $\frac{1}{4}$ of Section 21, T. 18N., R. 17E., M.D.M., or from the Dam the Southwest corner of said Section 21 bears South $81^{\circ} 05' 07''$ West a distance of 2,647 feet, more or less. The storage capacity of Boca Reservoir is approximately 40,870 AF.

Stampede Dam (Reservoir)

Within the NW $\frac{1}{4}$ of the NW $\frac{1}{4}$ of Section 28, T. 19N., R. 17E., M.D.M., or from the Dam the Northwest corner of said Section 28 bears North $36^{\circ} 08' 27''$ West a distance of 636 feet, more or less. The storage capacity of Stampede Reservoir is approximately 226,500 AF.

Derby Dam:

Within the N $\frac{1}{2}$ of the SW $\frac{1}{4}$ of Section 19, T. 20N., R. 23E., M.D.M.

Attachment "B"

Proposed Place of Use - See the map filed with Application No. 78034:

T. 20 N., R. 24 E., M.D.B.&M.

Portion of Section 9 and 10, Sections 11, 12, 13, 14 and 15;
Portion of Sections 16, 17, and 20, Sections 21, 22, 23, 24, 25, 26, 27, and 28;
Portion of Sections 29, 30 and 31, Sections 32, 33, 34, 35 and 36.

T. 20 N., R. 25 E., M.D.B.&M.

Sections 1, 2, and 3;
Portion of Sections 4 and 5, Sections 7 through 36.

T. 20 N., R. 26 E., M.D.B.&M.

Portion of Section 5, Sections 6 and 7;
Portion of Sections 8 and 17, Section 18 and 19;
Portion of Sections 20 and 29, Sections 30 and 31;
Portion of Section 32.

T. 21 N., R. 25 E., M.D.B.&M.

Portion of Sections 13, 23, and 24, Section 25;
Portion of Sections 26, 27, 28 and 33, Sections 34, 35, and 36.

T. 21 N., R. 26 E., M.D.B.&M.

Portion of Sections 5, 7 and 8, Section 17;
Portion of Section 18, Sections 19, 20, 29, 30, 31, and 32.

T. 22 N., R. 26 E., M.D.B.&M.

Portion of Sections 28, 32, 33.

T. 19 N., R. 25 E., M.D.B.&M.

All of Sections 1 through 36.

T. 19 N., R. 24 E., M.D.B.&M.

Sections 1, 2, 3, 4, and 5;
Portion of Section 6, Sections 7 through 36.

T. 19 N., R. 23 E., M.D.B.&M.

Portion of Sections 1, 12, 13, 14, and 23, Section 24 and 25;
Portion of Sections 26, 27, and 34, Sections 35 and 36.

Note: In addition to the above described Place of Use, it is the intent of these applications to provide water service to the entire City of Fernley utilities service area as determined by the City of Fernley.

APPLICATION FOR PERMIT TO APPROPRIATE THE PUBLIC WATERS OF THE STATE OF NEVADA

THIS SPACE FOR OFFICE USE ONLY

Date of filing in State Engineer's Office MAY 13 2009

Returned to applicant for correction _____

Corrected application filed _____ Map filed FEB 26 2009 under 78034

The applicant CITY OF FERNLEY

595 SILVER LACE BLVD of FERNLEY
Street Address or P.O. Box City or Town

NEVADA 89408 hereby make(s) application for permission to appropriate
State and Zip Code

the public waters of the State of Nevada, as hereinafter stated. (If applicant is a corporation, give date and place of incorporation; if a copartnership or association give names of members.)

1. The source of water is TRUCKEE RIVER WATER [SEE REMARKS SECTION - LINE ITEM #13]
Name of stream, lake, underground, spring or other sources.
2. The amount of water applied for is 93.83 ACRE FEET second feet.
One second foot equals 448.83 gallons per minute.
(a) If stored in reservoir give number of acre-feet 93.83 ACRE FEET
3. The water to be used for Wildlife Purposes
Irrigation, power, mining, commercial, domestic or other use. Must limit to one major use.
4. If use is for:
 - (a) Irrigation, state number of acres to be irrigated _____
 - (b) Stockwater, state number and kind of animals _____
 - (c) Other use (describe fully in No. 12) See Attachment "A"
 - (d) Power:
 - (1) Horsepower developed _____
 - (2) Point of return of water to stream _____

SIGNED

5. The water is to be diverted from its source at the following point: (Describe as being within a 40-acre subdivision of public survey, and by course and distance to a found section corner. If on unsurveyed land, it should be so stated.)

Described in Attachment "B"

6. Place of use: (Describe by legal subdivision. If on unsurveyed land, it should be so stated.)

Within the Truckee River system extending from the reservoirs listed in Attachment "B" to the point of discharge into Pyramid Lake as shown on the map filled under Primary Application No. 78034.

7. Use will begin about 1/1 and end about 12/31 of each year.
Month and Day Month and Day

8. Description of proposed works. (Under the provisions of NRS 535.010 you may be required to submit plans and specifications of your diversion or storage works.) (State manner in which water is to be diverted, i.e. diversion structure, ditches and flumes, drilled well with pump and motor, etc.)

ALL WORKS REFERENCED IN ATTACHMENT "B" ARE COMPLETED

9. Estimated cost of works: \$0.0 - ALL WORKS COMPLETED

10. Estimated time required to construct works: N/A
(If well completed, describe works.)

11. Estimated time required to complete the application of water to beneficial use: 10 YEARS

12. Provide a detailed description of the proposed project and its water usage (use attachments if necessary):
(Failure to provide a detailed description may cause a delay in processing.)

13. Miscellaneous remarks:

The source of the water stored in Lake Tahoe, Boca Reservoir, Prosser Creek Reservoir, Stampede Reservoir, and Donner Lake pursuant to the permit to be issued under Primary Application. Also see attachment "A" for additional remarks.

lpatton@CityofFernley.org
E-mail Address

(775) 784-9920
Phone No.

**APPLICATION MUST BE SIGNED
BY THE APPLICANT OR AGENT**

By

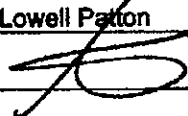
Lowell Patton
Type or print name clearly

Signature, applicant or agent
Director, City of Fernley Public Works Dept.
Company Name
595 Silver Lace Blvd.
Street Address or P.O. Box
Fernley, Nevada, 89408
City, State, Zip Code

STATE ENGINEERS OFFICE
2009 MAY 13 PM 3:40
RECEIVED

\$250 FILING FEE AND SUPPORTING MAP MUST ACCOMPANY APPLICATION

Attachment "A"

Item 4 (a)

This application is filed as part of the implementation of the operating agreement as described in Section 205 (a) of Title II of Public Law 101-618, which is referred to as the Truckee River Operating Agreement. This secondary application is filed for permission to use for wildlife purposes water stored pursuant to the Primary Application at the places of use described herein. It is one of three applications for secondary permits to be issued under the Primary Application. The quantity of water which may be released and used from storage under this and related secondary permits in any one year will not exceed the amounts allowed by the Truckee River Operation Agreement. The water released from one of more of the reservoirs described in Attachment "B" may be used for wildlife purposes within the limits of the natural stream bed and banks of the Truckee River from the existing reservoirs to Pyramid Lake.

Attachment "B"

The Proposed Points of Diversion are shown on the map filed with Application Number 78034:

Lake Tahoe:

Within the NE $\frac{1}{4}$ of the NW $\frac{1}{4}$ of Section 7, T. 15N., R. 17E., M.D.M., or from the Dam the southwest corner of said Section 7 bears South $29^{\circ} 09' 30''$ West a distance of 5,182 feet, more or less. The storage capacity of Lake Tahoe is approximately 744,600 AF.

Donner Lake:

Within the SE $\frac{1}{4}$ of the NE $\frac{1}{4}$ of Section 18, T. 17N., R. 16E., M.D.M., or from the Dam the Southeast corner of said Section 18 bears South $04^{\circ} 07' 14''$ East a distance of 2,981 feet, more or less. The storage capacity of Donner Lake is 9,500 AF.

Prosser Creek Dam (Reservoir):

Within the NW $\frac{1}{4}$ of the SW $\frac{1}{4}$ of Section 30, T. 18N., R. 17E., M.D.M., or from the Dam the Southwest corner of said Section 30 bears South $22^{\circ} 58' 48''$ West a distance of 2,006 feet, more or less. The storage capacity of Prosser Creek Reservoir is approximately 29,840 AF.

Boca Dam (Reservoir):

Within the SE $\frac{1}{4}$ of the SW $\frac{1}{4}$ of Section 21, T. 18N., R. 17E., M.D.M., or from the Dam the Southwest corner of said Section 21 bears South $81^{\circ} 05' 07''$ West a distance of 2,647 feet, more or less. The storage capacity of Boca Reservoir is approximately 40,870 AF.

Stampede Dam (Reservoir)

Within the NW $\frac{1}{4}$ of the NW $\frac{1}{4}$ of Section 28, T. 19N., R. 17E., M.D.M., or from the Dam the Northwest corner of said Section 28 bears North $36^{\circ} 08' 27''$ West a distance of 636 feet, more or less. The storage capacity of Stampede Reservoir is approximately 226,500 AF.

APPLICATION FOR PERMIT TO APPROPRIATE THE PUBLIC WATERS OF THE STATE OF NEVADA

THIS SPACE FOR OFFICE USE ONLY

Date of filing in State Engineer's Office MAY 13 2009

Returned to applicant for correction _____

Corrected application filed _____ Map filed FEB 26 2009 under 78034

The applicant CITY OF FERNLEY

595 SILVER LACE BLVD of FERNLEY
Street Address or P.O. Box City or Town

NEVADA 89408 hereby make(s) application for permission to appropriate
State and Zip Code

the public waters of the State of Nevada, as hereinafter stated. (If applicant is a corporation, give date and place of incorporation; if a copartnership or association give names of members.)

1. The source of water is TRUCKEE RIVER WATER [SEE REMARKS SECTION - LINE ITEM #13]
Name of stream, lake, underground, spring or other sources.
2. The amount of water applied for is 93.83 ACRE FEET second feet.
One second foot equals 448.83 gallons per minute.
 - (a) If stored in reservoir give number of acre-feet _____
3. The water to be used for MUNICIPAL AND DOMESTIC PURPOSES
Irrigation, power, mining, commercial, domestic or other use. Must limit to one major use.
4. If use is for:
 - (a) Irrigation, state number of acres to be irrigated _____
 - (b) Stockwater, state number and kind of animals _____
 - (c) Other use (describe fully in No. 12) _____
 - (d) Power:
 - (1) Horsepower developed _____
 - (2) Point of return of water to stream _____

547-57

5. The water is to be diverted from its source at the following point: (Describe as being within a 40-acre subdivision of public survey, and by course and distance to a found section corner. If on unsurveyed land, it should be so stated.)
Derby Dam, located in the N 1/2 SW 1/4, Section 19, T. 20N., R. 23 E., M.D.B.&M.

6. Place of use: (Describe by legal subdivision. If on unsurveyed land, it should be so stated.)
See Attachment "A" and Map Filed with Primary Application No. 78034

7. Use will begin about 1/1 and end about 12/31 of each year.
Month and Day Month and Day

8. Description of proposed works. (Under the provisions of NRS 535.010 you may be required to submit plans and specifications of your diversion or storage works.) (State manner in which water is to be diverted, i.e. diversion structure, ditches and flumes, drilled well with pump and motor, etc.)
Derby Dam Diversion Works and the Truckee Canal are complete

9. Estimated cost of works: N/A All Works Completed

10. Estimated time required to construct works: N/A
(If well completed, describe works.)

11. Estimated time required to complete the application of water to beneficial use: 10 YEARS

12. Provide a detailed description of the proposed project and its water usage (use attachments if necessary):
(Failure to provide a detailed description may cause a delay in processing.)
The Surface water will be diverted to a treatment facility meeting the requirements of the US EPA Surface Water Rule. The finished water will be blended w/groundwater producing a product meeting the Safe Drinking Water Act. Alternately, the surface water may be diverted to a recharge basin for aquifer recharge, storage, and recovery. Alternately, the surface water may be used for municipal purposes from the Truckee Canal after diversion from Derby Dam.

13. Miscellaneous remarks:
The source of the water stored at Derby Dam is pursuant to the permit to be issued under Primary Application.

lpatton@CityofFernley.org
E-mail Address

(775) 784-9920
Phone No.

**APPLICATION MUST BE SIGNED
BY THE APPLICANT OR AGENT**

By

Lowell Patton
Type or print name clearly

Signature, applicant or agent

Director, City of Fernley Public Works Dept.
Company Name

595 Silver Lace Blvd.
Street Address or P.O. Box

Fernley, Nevada, 89408
City, State, Zip Code

\$250 FILING FEE AND SUPPORTING MAP MUST ACCOMPANY APPLICATION

Attachment "A"

Proposed Place of Use – See the map filed with Application No. 78034:

T. 20 N., R. 24 E., M.D.B.&M.

Portion of Section 9 and 10, Sections 11, 12, 13, 14 and 15;
Portion of Sections 16, 17, and 20, Sections 21, 22, 23, 24, 25, 26, 27, and 28;
Portion of Sections 29, 30 and 31, Sections 32, 33, 34, 35 and 36.

T. 20 N., R. 25 E., M.D.B.&M.

Sections 1, 2, and 3;
Portion of Sections 4 and 5, Sections 7 through 36.

T. 20 N., R. 26 E., M.D.B.&M.

Portion of Section 5, Sections 6 and 7;
Portion of Sections 8 and 17, Section 18 and 19;
Portion of Sections 20 and 29, Sections 30 and 31;
Portion of Section 32.

T. 21 N., R. 25 E., M.D.B.&M.

Portion of Sections 13, 23, and 24, Section 25;
Portion of Sections 26, 27, 28 and 33, Sections 34, 35, and 36.

T. 21 N., R. 26 E., M.D.B.&M.

Portion of Sections 5, 7 and 8, Section 17;
Portion of Section 18, Sections 19, 20, 29, 30, 31, and 32.

T. 22 N., R. 26 E., M.D.B.&M.

Portion of Sections 28, 32, 33.

T. 19 N., R. 25 E., M.D.B.&M.

All of Sections 1 through 36.

T. 19 N., R. 24 E., M.D.B.&M.

Sections 1, 2, 3, 4, and 5;

STATE OF NEVADA
 COUNTY OF CARSON CITY

I, MICHAEL A. STANKA, BEING FIRST DAILY SWORN, DEPOSE AND SAY THAT I AM THE REGISTERED PROFESSIONAL ENGINEER WHO HAS PREPARED AND CORRECTLY DRAWN TO THE DESIGNATED SCALE FROM FIELD NOTES OF A SURVEY MADE BY ME OR UNDER MY SUPERVISION AND DIRECTION ON DECEMBER 31, 2008 AND UPON ANALYSIS OF RECORDED SURVEY DOCUMENTS AND OTHER DOCUMENTS LOCATED AT THE INVOLVED BUREAU OF LAND MANAGEMENT OFFICE LOCATIONS, PROPOSED PORTS OF DIVERSION AND PROPOSED STORAGE LOCATIONS, AND SECONDARY APPLICATIONS TO PERMIT 95226, LOCATED WITHIN SIERRA, NEVADA, AND PLACER COUNTY (CALIFORNIA) AND STOREY AND LYON COUNTY, NEVADA, BY THE CITY OF STONEY FOR STORAGE (PRIMARY) AND WILDLIFE AND MUNICIPAL USE (SECONDARY).



MAS
 MICHAEL A. STANKA SWRS # 1122

SUBSCRIBED AND SWORN TO BEFORE ME
 THIS 11th DAY OF February, 2009



NOTARY PUBLIC IN AND FOR Carson City, COUNTY, Nevada
 MY COMMISSION EXPIRES December 10, 2012.

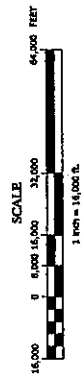
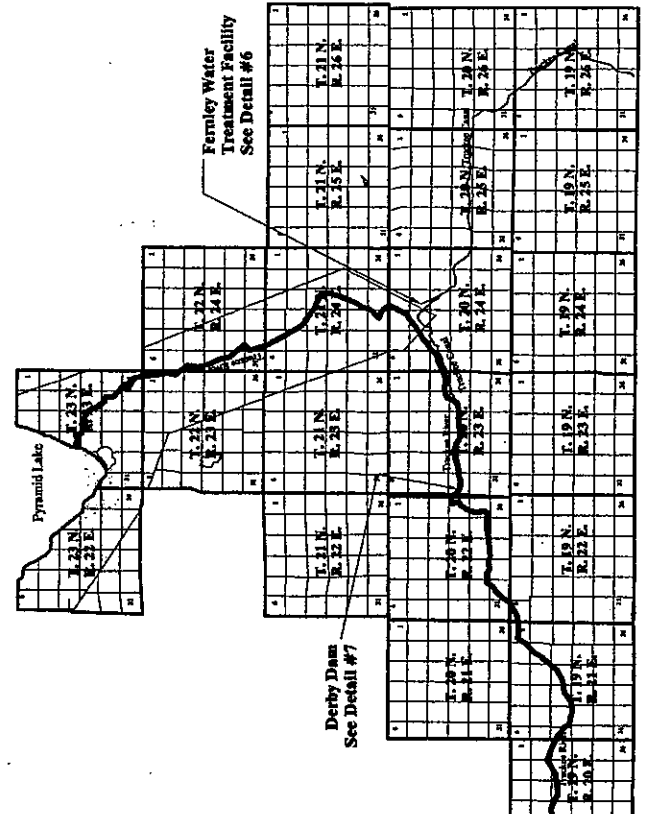

LEGEND
 TOWNSHIP / RANGE LINE
 SECTION LINE
 TRUCKEE RIVER

February 11, 2009 Sheet 1 of 4

MAP TO ACCOMPANY PRIMARY AND SECONDARY APPLICATIONS TO CHANGE PERMIT 95226 TO STORAGE (PRIMARY) AND MUNICIPAL AND WILDLIFE (SECONDARY)

by
 CITY OF STONEY
 TRUCKEE RIVER
 IN SIERRA, NEVADA, AND PLACER COUNTIES
 (CALIFORNIA) AND STOREY AND LYON COUNTY,
 NEVADA

STATE ENGINEER'S USE



801 71 612327

STANKA CONSULTING, LTD
 108 NORTH MINNESOTA
 STREET
 CARSON CITY, NEVADA 89703
 775-841-2266
 STANKACONSULTING@AOL.COM

7835 7834 7833 7832 7831 7830 7829 7828 7827 7826 7825 7824 7823 7822 7821 7820 7819 7818 7817 7816 7815 7814 7813 7812 7811 7810 7809 7808 7807 7806 7805 7804 7803 7802 7801 7800 7799 7798 7797 7796 7795 7794 7793 7792 7791 7790 7789 7788 7787 7786 7785 7784 7783 7782 7781 7780 7779 7778 7777 7776 7775 7774 7773 7772 7771 7770 7769 7768 7767 7766 7765 7764 7763 7762 7761 7760 7759 7758 7757 7756 7755 7754 7753 7752 7751 7750 7749 7748 7747 7746 7745 7744 7743 7742 7741 7740 7739 7738 7737 7736 7735 7734 7733 7732 7731 7730 7729 7728 7727 7726 7725 7724 7723 7722 7721 7720 7719 7718 7717 7716 7715 7714 7713 7712 7711 7710 7709 7708 7707 7706 7705 7704 7703 7702 7701 7700 7699 7698 7697 7696 7695 7694 7693 7692 7691 7690 7689 7688 7687 7686 7685 7684 7683 7682 7681 7680 7679 7678 7677 7676 7675 7674 7673 7672 7671 7670 7669 7668 7667 7666 7665 7664 7663 7662 7661 7660 7659 7658 7657 7656 7655 7654 7653 7652 7651 7650 7649 7648 7647 7646 7645 7644 7643 7642 7641 7640 7639 7638 7637 7636 7635 7634

BASIS OF BEARINGS

DETAILS #1-5: CALIFORNIA
STATE PLANE
ZONE 2 - NAD 83

NOTES

- SECTIONAL BREAKDOWN PROVIDED BY THE BUREAU OF LAND MANAGEMENT LAND RECORDS [HTTP://WWW.BLM.GOV](http://www.blm.gov) REFERENCE MAPS FILED WITH NEVADA DIVISION OF WATER RESOURCES APPLICATIONS NOS. 67182, 67183, 67525, 71534, AND 73783

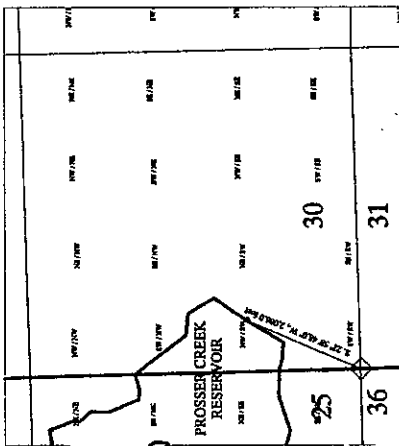

Detail #1 PROSSER CREEK RESERVOIR
POINT OF DIVERSION - NW 1/4 SW 1/4
SECTION 30, T.18N., R.17E., M.D.B. & M.

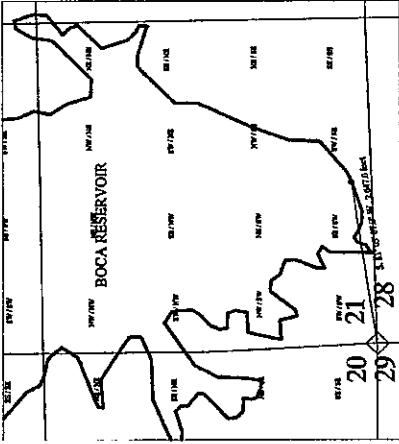

Detail #2 BOCA RESERVOIR
POINT OF DIVERSION - SE 1/4 SW 1/4
SECTION 21, T.18N., R.17E., M.D.B. & M.

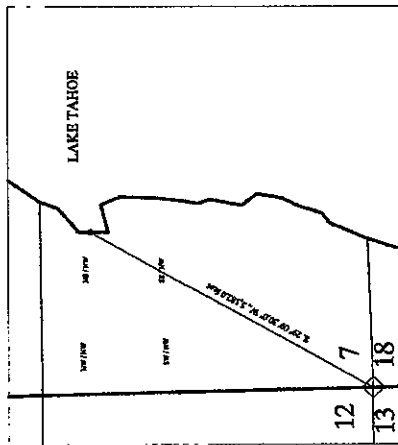

Detail #3 LAKE TAHOE
POINT OF DIVERSION - NE 1/4 NW 1/4
SECTION 7, T.15N., R.17E., M.D.B. & M.

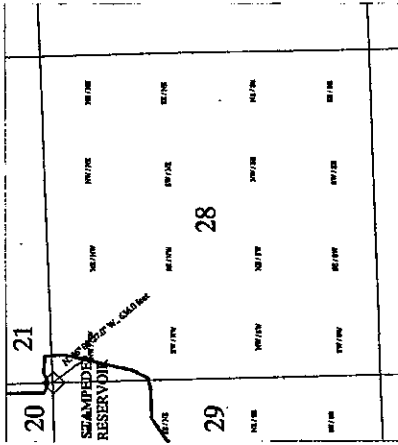

Detail #4 STAMPEDE RESERVOIR
POINT OF DIVERSION - NW 1/4 NW 1/4
SECTION 28, T.19N., R.17E., M.D.B. & M.

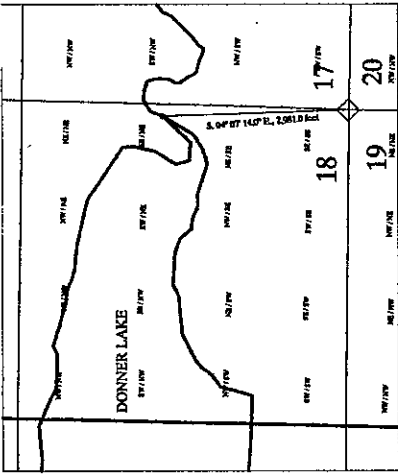

Detail #5 DONNER LAKE
POINT OF DIVERSION - SE 1/4 NE 1/4
SECTION 18, T.17N., R.16E., M.D.B. & M.

NOTES

- INDICATES FOUND SECTION CORNER, AN IRON PIPE WITH FLAG, BRASS CAP
- TOWNSHIP / RANGE LINE
- SECTION LINE
- 1/16 SECTION LINE



FEBRUARY 11, 2009

Sheet 2 of 4

STATE ENGINEER'S USE

MAP TO ACCOMPANY PRIMARY AND SECONDARY APPLICATIONS TO CHANGE PERMIT 85228 TO STORAGE (PRIMARY) AND MUNICIPAL AND WILDLIFE (SECONDARY)



CITY OF FENLEY FROM TRUCKEE RIVER IN SIERRA, NEVADA, AND PLACER COUNTIES (CALIFORNIA) AND STOREY AND LYON COUNTY, NEVADA

STANKA CONSULTING @ AOL.COM

775-841-2266

STANKA CONSULTING, LTD
108 NORTH MINNESOTA STREET
CARSON CITY, NEVADA 89703

801 W. G STREET

7837
7838
7839
7840
7841
7842
7843
7844
7845
7846
7847
7848
7849
7850
7851
7852
7853
7854
7855
7856
7857
7858
7859
7860
7861
7862
7863
7864
7865
7866
7867
7868
7869
7870
7871
7872
7873
7874
7875
7876
7877
7878
7879
7880
7881
7882
7883
7884
7885
7886
7887
7888
7889
7890
7891
7892
7893
7894
7895
7896
7897
7898
7899
7900
7901
7902
7903
7904
7905
7906
7907
7908
7909
7910
7911
7912
7913
7914
7915
7916
7917
7918
7919
7920
7921
7922
7923
7924
7925
7926
7927
7928
7929
7930
7931
7932
7933
7934
7935
7936
7937
7938
7939
7940
7941
7942
7943
7944
7945
7946
7947
7948
7949
7950
7951
7952
7953
7954
7955
7956
7957
7958
7959
7960
7961
7962
7963
7964
7965
7966
7967
7968
7969
7970
7971
7972
7973
7974
7975
7976
7977
7978
7979
7980
7981
7982
7983
7984
7985
7986
7987
7988
7989
7990
7991
7992
7993
7994
7995
7996
7997
7998
7999
8000

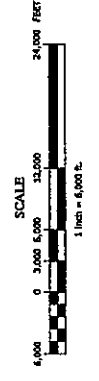

February 11, 2009 Sheet 4 of 4

MAP TO ACCOMPANY PRIMARY AND SECONDARY APPLICATIONS TO CHANGE PERMIT 55235 TO STORAGE [PRIMARY] AND MUNICIPAL AND WILDLIFE STORAGE [SECONDARY]

by
CITY OF RENO
TRUCKEE RIVER
IN SIERRA, NEVADA, AND PLACER COUNTIES
[CALIFORNIA] AND STOREY AND LYON COUNTIES,
NEVADA



801114123132

STATE ENGINEERS USE

—— TOWNSHIP / RANGE LINE
—— SECTION LINE

STANKA CONSULTING, LTD
108 NORTH MINNESOTA
STREET
CARSON CITY, NEVADA 89703
775-841-2266
STANKACONSULTING@GOL.COM

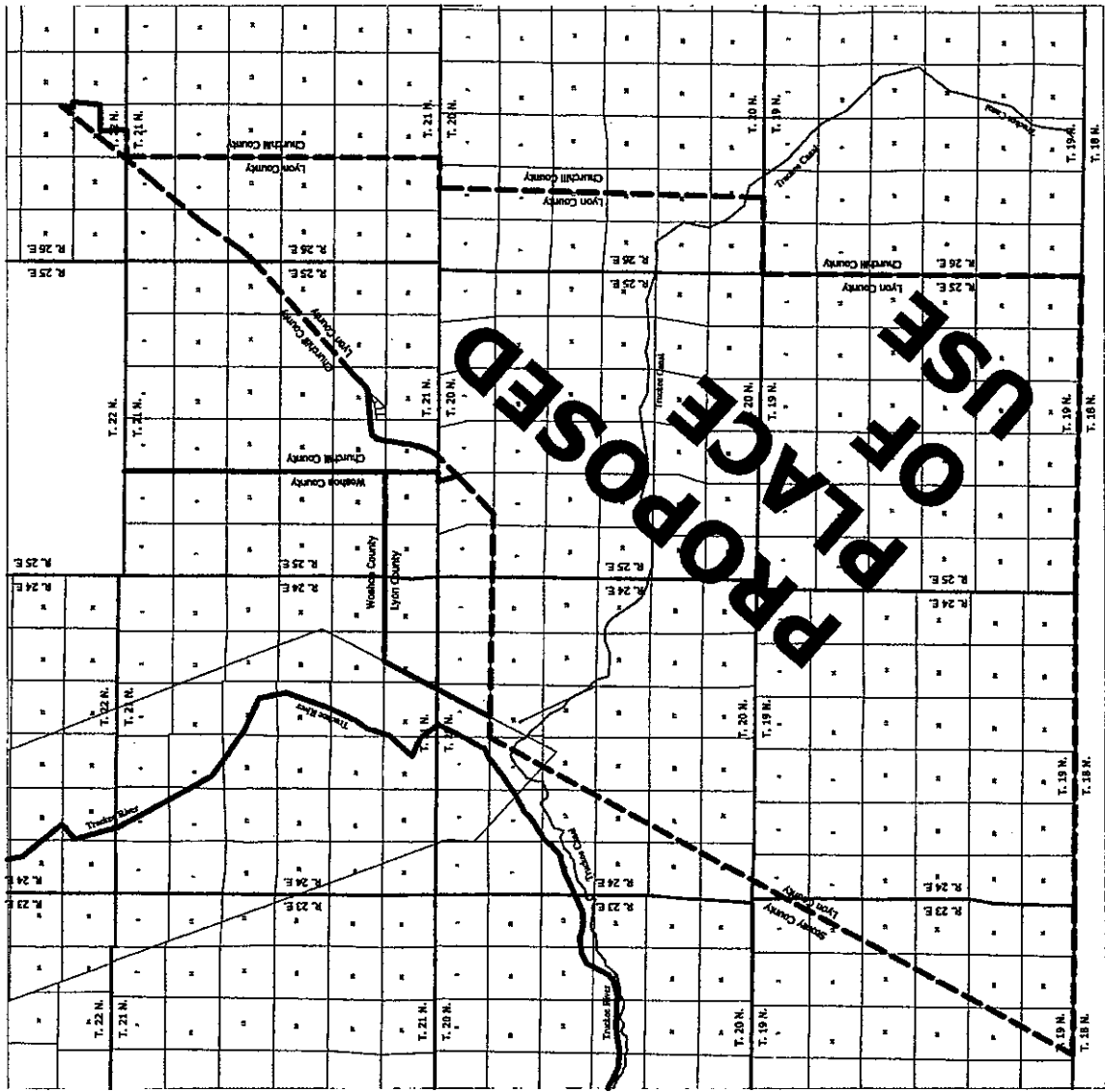

42082
78037
78038
78039
78040
78041
78042
78043
78044
78045
78046
78047
78048
78049
78050
78051
78052
78053
78054
78055
78056
78057
78058
78059
78060
78061
78062
78063
78064
78065
78066
78067
78068
78069
78070
78071
78072
78073
78074
78075
78076
78077
78078
78079
78080
78081
78082
78083
78084
78085
78086
78087
78088
78089
78090
78091
78092
78093
78094
78095
78096
78097
78098
78099
78100