

HORIZONTAL DATUM
HELD BEARING BETWEEN GPS POINTS COINCIDING WITH SET CONTROL POINTS #2 AND #3.
CONTROL POINT #1 LATITUDE/LONGITUDE = N38°52'18.1" / W122°53'30.0" ±44.2'
CONTROL POINT #2 LATITUDE/LONGITUDE = N38°52'17.4" / W122°53'29.3" ±22.0'
CONTROL POINT #3 LATITUDE/LONGITUDE = N38°52'16.6" / W122°53'28.6" ±21.8'
GPS UNIT IS ON NAD 83.

VERTICAL DATUM
ASSUMED ELEVATION = 2337.00' AT CONTROL POINT #3.

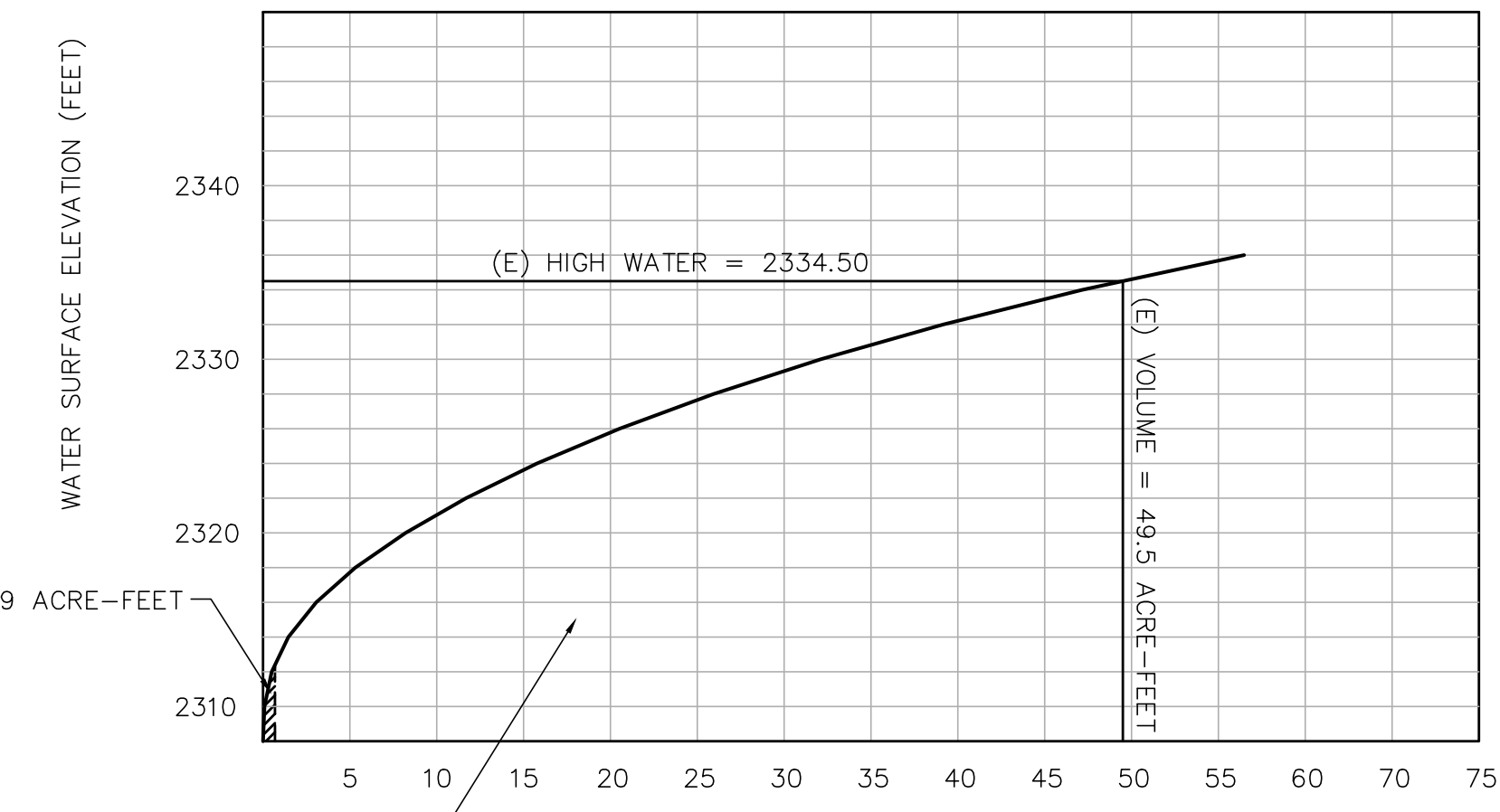

DATE:		REVISION:		BY:	COMPUTER NO. SERVER		OWNER: PRESCOTT		<div><div>RAU</div><div>AND ASSOCIATES INC.</div><div>CIVIL ENGINEERS • LAND SURVEYORS</div><div>100 NORTH PINE STREET • (707) 462-6536 • UKIAH, CA 95482</div></div>		DRAWING:		TOPOGRAPHIC MAP		Date: MAY 2013		SHEET 1 of 2 SHEETS			
					PATH: Z:\P\CIVIL						LOCATION:		36800 PINE MOUNTAIN ROAD CLOVERDALE, CALIFORNIA		Scale: AS SHOWN				Checked: GCR	
					FILE: FILE NAME.DWG										Drawn: JCJ				Reviewed: GCR	
					PSVIEW:										JOB NO. R13023					
					MSVP:															
					MSVIEW:															

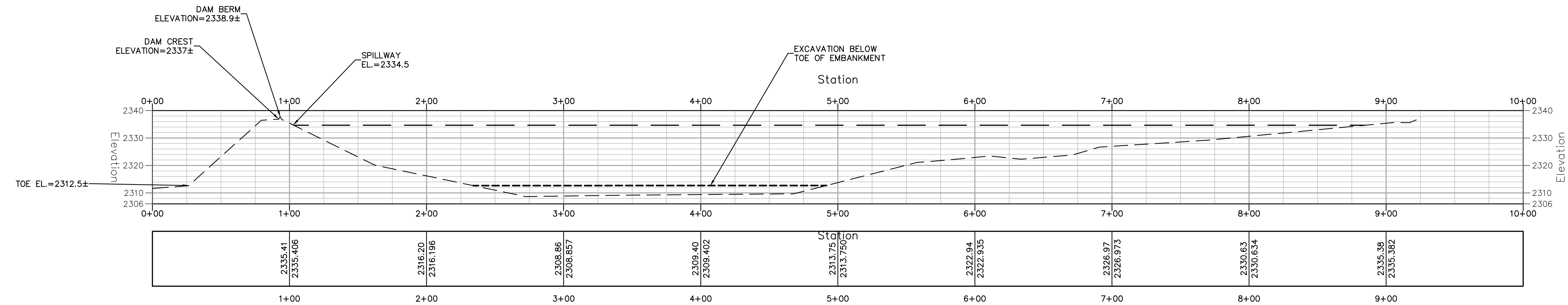
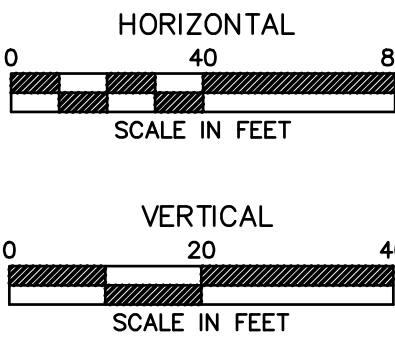

DATE:	REVISION:	BY:	COMPUTER NO. SERVER	OWNER: PRESCOTT	<div><div>RAU</div><div>AND ASSOCIATES INC.</div><div>CIVIL ENGINEERS • LAND SURVEYORS</div><div>100 NORTH PINE STREET • (707) 462-6536 • UKIAH, CA 95482</div></div>	DRAWING:	PROFILE	Date:	MAY 2013	SHEET <div>2</div> of 2 SHEETS	
			PATH: Z:\P\CIVIL			LOCATION: 36800 PINE MOUNTAIN ROAD CLOVERDALE, CALIFORNIA	PROJECT:	TYLER CREEK POND AB2121 RESERVOIR ID# 1679	Scale:		AS SHOWN
			FILE: FILE NAME.DWG				Checked:	GCR	Drawn:		JCJ
			PSVIEW:				Reviewed:	GCR			
			MSVP:				JOB NO.	R13023			
			MSVIEW:								